

**PLUMBING – LOWER LEVEL PLAN – NEW CONSTRUCTION**  
1 : 200 (WM & WI)

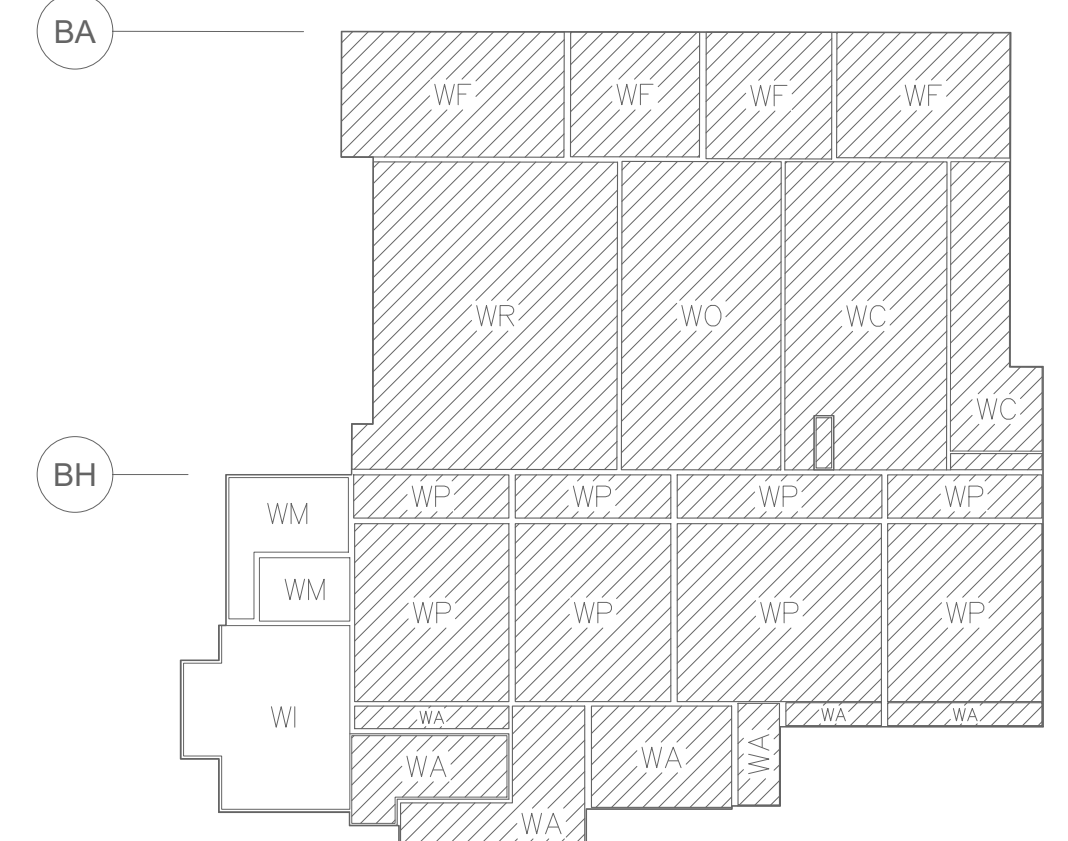

**KEY PLAN**  
NOT TO SCALE

• UNHATCHED AREAS DENOTES EXTENTS SHOWN ON DRAWING

MECHANICAL LEGEND	
	NEW PRIMARY STORM WATER DRAINAGE ABOVE FLOOR OR GRADE
	NEW SECONDARY STORM WATER DRAINAGE ABOVE FLOOR OR GRADE
	EXISTING PRIMARY STORM WATER DRAINAGE ABOVE FLOOR OR GRADE TO REMAIN
	EXISTING PRIMARY STORM WATER DRAINAGE BELOW FLOOR OR GRADE TO REMAIN
	PIPE CAP
	DIRECTION OF FLOW
	CLEANOUT
	ROOF DRAIN
	VENT
	SANITARY VENT
	VENT PIPE WITH METAL FLASHING
	EXHAUST FAN UNIT, CURBED
	FLUE VENT, CURBED
	GOOSE NECK VENTING, CURBED
	LOUVERED VENT HOOD, CURBED
	SCUPPER
	PLUMBING FIXTURE DESIGNATION
	FIRE STANDPIPE
	ROOF LADDER
	PLUMBING RISER REFERENCE - REFER TO DRAWINGS 1-0601B-H0038-001 AND 1-0601B-H0039-001 FOR SCHEMATICS

**GENERAL NOTES**

- ALL EQUIPMENT SHUT DOWN AND NOISY WORK TO BE PERFORMED IN ACCORDANCE WITH WORK HOURS AND NOISE RESTRICTIONS SET FORTH IN THE SPECIFICATION AND COORDINATED WITH CONTRACT ADMINISTRATOR.
- REVIEW ALL CONSTRUCTION DOCUMENTS, VERIFY ROUTING AND EQUIPMENT REMOVAL AND RE-INSTALLATION ETC. PRIOR TO PROCEEDING WITH WORK. REPORT ANY DISCREPANCIES TO CONTRACT ADMINISTRATOR.
- PERFORM COORDINATION BETWEEN ALL TRADES AS REQUIRED FOR REMOVAL AND RE-INSTALLATION OF EQUIPMENT. WHERE ADDITIONAL WORK REASONABLY INCIDENTAL TO THE ORIGINAL DESIGN INTENT IS REQUIRED DUE TO SITE CONDITIONS, IT SHALL BE PERFORMED AT NO ADDITIONAL COST.
- WHERE REMOVAL OF EQUIPMENT REQUIRES RE-INSULATING OR ADDITIONAL PATCHING, PERFORM WORK AT NO ADDITIONAL COST. ALL PATCHING AND RE-INSULATING TO MATCH EXISTING OR MEET THE MINIMUM REQUIREMENTS OF THE SPECIFICATION WHERE THE EXISTING CONDITION IS OF LESS QUALITY THAN THE SPECIFICATION.
- WHEN EQUIPMENT, DUCTING OR OTHER MECHANICAL ITEMS ARE REMOVED FROM ROOF AND REQUIRED TO BE RE-INSTALLED, STORE IN SAFE LOCATION TO PREVENT WEATHER OR PHYSICAL DAMAGE TO EQUIPMENT, DUCTING OR ANY OTHER MECHANICAL ITEMS.

**KEY NOTES**

- EXISTING PRIMARY STORM WATER LEADER DOWN FROM FLOOR ABOVE.
- EXISTING STORM WATER PIPING TO REMAIN.

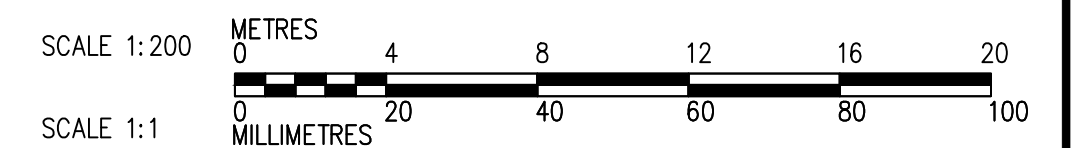

10		
9		
8		
7		
6		
5		
4		
3	1-0601B-H0039-001	PLUMBING SOUTH STORM DRAIN SCHEMATIC ELEVATION
2	1-0601B-H0029-001	PLUMBING WM & WI STORM DRAIN UPGRADES FIRST FLOOR PLAN
1	1-0601B-H0022-001	PLUMBING WF, WR, WO & WC STORM DRAIN UPGRADES LOWER LEVEL PLAN
NO.	DRAWING NUMBER	REFERENCE DRAWING TITLE

 770 Bradford Street Winnipeg, Canada (204) 775-0291 22-284-01 smseng.com	DESIGNED BY GR CHECKED BY GS DRAWN BY GR APPROVED BY GS SCALE: AS NOTED RELEASED FOR CONSTRUCTION BY:		ENGINEER'S SEAL  CONSULTANT DRAWING NO. M2.4
	B.M. ELEV. NO. REVISIONS DATE BY	00 ISSUED FOR TENDER 23/03/21 GS 01 2023/03/21	

 THE CITY OF WINNIPEG WATER AND WASTE DEPARTMENT ENGINEERING DIVISION		CITY FILE NUMBER <b>W-1049</b>
DRINKING WATER TREATMENT PLANT MAIN BUILDING ROOF REPLACEMENT		SHEET 1 OF 1
PLUMBING WM & WI STORM DRAIN UPGRADES LOWER LEVEL PLAN		CITY DRAWING NUMBER 1-0601B-H0025-001