

KEY PLAN  
NOT TO SCALE

**NEW ROOF PLAN KEYNOTES**

- 1 SUPPLY AND INSTALL NEW ROOF SYSTEM AS PER NEW ROOF ASSEMBLY DETAILS AND SPECIFICATIONS.
- 2 SUPPLY AND INSTALL NEW VENT CURB AND PRE-MANUFACTURED STACK FLASHING TO ALLOW 400 ABOVE NEW ROOF SYSTEM, C/W 2-PLY SBS BASE AND GRANULATED CAP FLASHING MEMBRANES, TYPICAL AT ALL VENT, AIR INTAKE, EXHAUST VENT AND EXHAUST FAN LOCATIONS.
- 3 SUPPLY AND INSTALL NEW WOOD BLOCKING AND INSULATED WOOD PARAPET BUILT UP TO ALLOW 152mm ABOVE NEW FINISHED SURFACE OF NEW ROOF SYSTEM, COMPLETE WITH 2-PLY SBS BASE AND GRANULATED CAP FLASHING MEMBRANE, AND 24GA PRE-FINISHED METAL CAP FLASHING IN ACCORDANCE WITH PROJECT DETAILS, TYPICAL. COLOUR TO BE SELECTED BY CONTRACT ADMINISTRATOR.
- 4 SUPPLY AND INSTALL NEW DRAIN ASSEMBLIES, ADJUST DRAIN HEIGHT AS REQUIRED TO ACCOMMODATE NEW ROOF ASSEMBLY, TYPICAL. SUPPLY AND INSTALL NEW PIPING AND TIE-IN TO EXISTING DRAINS AS REQUIRED, TYPICAL. REFER TO MECHANICAL DRAWINGS TO DETERMINE DRAIN ASSEMBLIES.
- 5 SUPPLY AND INSTALL NEW WOOD BLOCKING AND INSULATED WOOD CURB WALL BUILT TO ALLOW 152mm ABOVE NEW FINISHED SURFACE OF NEW ROOF SYSTEM, C/W SBS EXPANSION MEMBRANE AND 2-PLY SBS BASE AND GRANULATED CAP FLASHING MEMBRANE AT ALL EXPANSION JOINT DETAILS. SUPPLY AND INSTALL NEW 24GA PRE-FINISHED METAL CAP FLASHING WITH EXPANSION CAPABILITIES IN ACCORDANCE WITH PROJECT DETAILS, TYPICAL. COLOUR TO BE SELECTED BY CONTRACT ADMINISTRATOR.
- 6 SUPPLY AND INSTALL NEW WOOD BLOCKING CONTROL JOINT C/W 2-PLY SBS BASE AND GRANULATED CAP FLASHING MEMBRANE, TYPICAL.
- 7 SUPPLY AND INSTALL NEW 2-PLY SBS BASE AND GRANULATED CAP FLASHING MEMBRANE ON NEW WOOD CURBS, TO SUIT EXISTING UNITS AND RE-INSTALL MECHANICAL UNITS, TYPICAL. ENSURE MECHANICAL EQUIPMENT IS OPERATIONAL ONCE ROOF WORK IS COMPLETED.
- 8 SUPPLY AND INSTALL NEW 2-PLY SBS BASE AND GRANULATED CAP FLASHING MEMBRANE ON ALL EXISTING SLEEPERS, TYPICAL.
- 9 SUPPLY AND INSTALL NEW 24GA 900mm WIDE PRE-FINISHED METAL OVERFLOW SCUPPERS THROUGH PARAPET, BOTTOM OF SCUPPER TO BE 10mm± ABOVE FINISHED ROOF ASSEMBLY, TYPICAL.
- 10 SUPPLY AND INSTALL NEW PLYWOOD SHEATHING ON EXISTING CURB, C/W 2-PLY SBS BASE AND GRANULATED CAP FLASHING MEMBRANE, TYPICAL. REFER TO MECHANICAL FOR SIZES.
- 11 SUPPLY AND INSTALL NEW 2-PLY SBS BASE AND GRANULATED CAP FLASHING MEMBRANE AT ALL ROOF WALL INTERFACE DETAILS, TYPICAL.
- 12 SUPPLY AND INSTALL NEW PRE MANUFACTURED PITCH POCKET ASSEMBLY AT ELECTRICAL ROOF PENETRATIONS, TYPICAL.
- 13 AS REQUIRED, RE-INSTALL AND ADJUST EXISTING GAS LINES TO ACCOMMODATE NEW ROOF SYSTEM. SUPPLY AND INSTALL NEW C-PORT PEDESTALS AS REQUIRED, TYPICAL.
- 14 RE-INSTALL ANTENNAS AT ORIGINAL LOCATION, REFER TO CONTRACT ADMINISTRATOR FOR PLACEMENT AND CONFIRM SERVICE.
- 15 SUPPLY AND INSTALL NEW SECONDARY OVERFLOW ROOF DRAIN. ENSURE MINIMUM 48" BETWEEN DRAINS AS DRAWN. REFER TO MECHANICAL AND BUILDING DETAILS. REFER TO MECHANICAL. TYPICAL.
- 16 SUPPLY AND INSTALL NEW 300mm WIDE PRIMARY DRAINAGE SCUPPER ASSEMBLIES AT LOW POINT OF ROOF. PROVIDE OPEN-FACED DOWNSPOUT AND CONCRETE SPLASH PAD, TYPICAL.
- 17 RE-INSTALL WINDSOCK AT ORIGINAL LOCATION.
- 18 PROVIDE OPEN-FACED DOWNSPOUT AND CONCRETE SPLASH PAD.
- 19 SUPPLY AND INSTALL NEW SANITARY VENT STACK ASSEMBLIES. TYPICAL.
- 20 SUPPLY AND INSTALL NEW ROOF SYSTEM AS PER NEW ROOF ASSEMBLY DETAILS AND SPECIFICATIONS. RE-INSTALL LOUVERS TO EXISTING CONDITIONS.
- 21 INFILL ROOF AT REMOVED CHIMNEY LOCATION.

**NEW ROOF LEGEND**  
(TYPICAL ALL ROOF TYPES UNLESS NOTED OTHERWISE)

- WI-1** • SBS TRAFFIC CAP SHEET MEMBRANE FOR FIELD SURFACES, HEAT WELDED
  - WM-1** • SBS BASE SHEET MEMBRANE FOR FIELD SURFACES, SEMI-ADHERED
  - POLYISOCYANURATE INSULATION TYPE II, ADHERED
  - TAPERED (SLOPED) INSULATION AND BACKSLOPE, ADHERED
  - THERMOFUSIBLE AIR/VAPOUR BARRIER MEMBRANE
  - C/W EXTRA REINFORCED MEMBRANE.
  - EXISTING CONCRETE DECK
- 
- WM-2** • SBS TRAFFIC CAP SHEET MEMBRANE FOR FIELD SURFACES, HEAT WELDED
  - SBS BASE SHEET MEMBRANE FOR FIELD SURFACES, SEMI-ADHERED
  - POLYISOCYANURATE INSULATION TYPE II, ADHERED
  - TAPERED (SLOPED) INSULATION AND BACKSLOPE, ADHERED
  - THERMOFUSIBLE AIR/VAPOUR BARRIER MEMBRANE
  - C/W EXTRA REINFORCED MEMBRANE.
  - GLASS REINFORCED SUPPORT DECK
  - EXISTING STEEL DECK

**NEW ROOF ASSEMBLIES**  
(TYPICAL ALL ROOF TYPES UNLESS NOTED OTHERWISE)

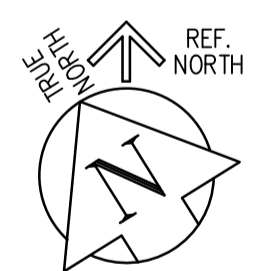
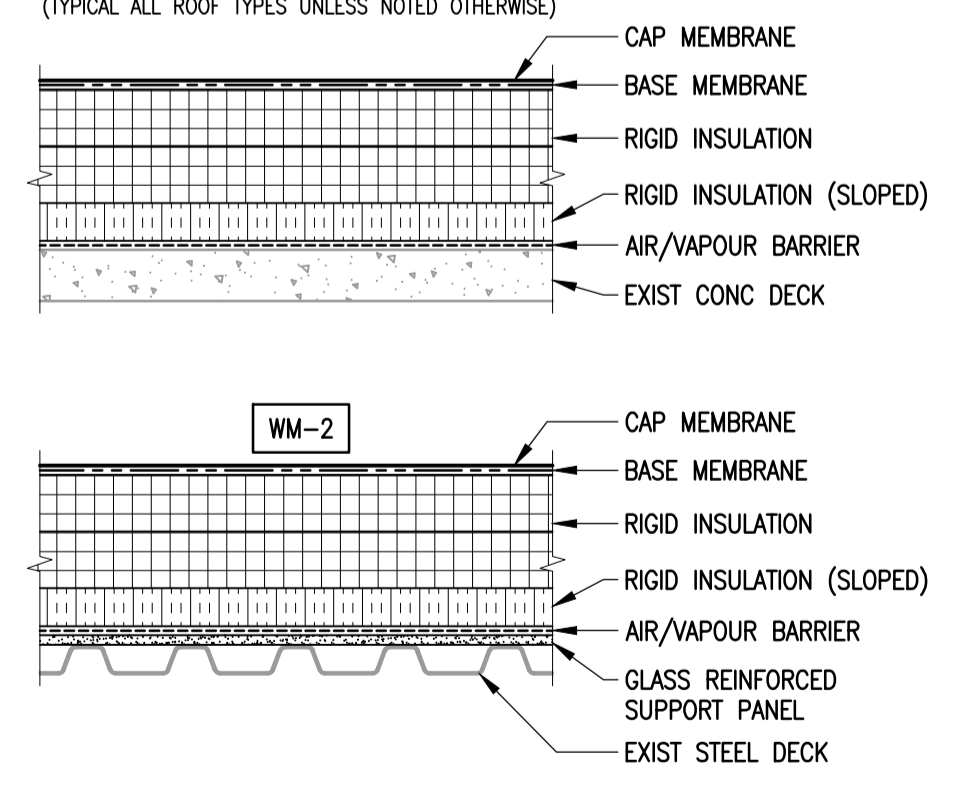

NEW ROOF PLAN  
1 : 200 (WI & WM)

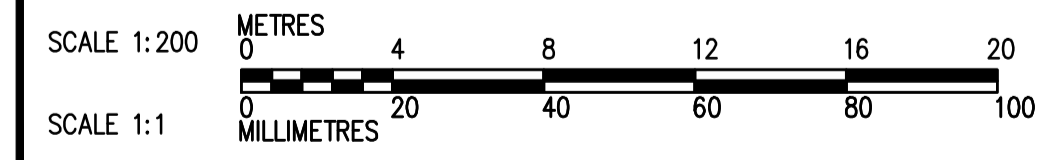

10		
9		
8	1-0601B-M001B-001	MECHANICAL WM & WI ROOF PLAN
7	1-0601B-B0076-009	BUILDING ROOF DETAILS 9 OF 9
6	1-0601B-B0076-005	BUILDING ROOF DETAILS 5 OF 9
5	1-0601B-B0076-002	BUILDING ROOF DETAILS 2 OF 9
4	1-0601B-B0076-001	BUILDING ROOF DETAILS 1 OF 9
3	1-0601B-B0070-001	BUILDING WA ROOF PLAN
2	1-0601B-B0069-001	BUILDING WP ROOF PLAN
1	1-0601B-G0004-001	BUILDING NOTES, SCHEDULE & LEGENDS
NO.	DRAWING NUMBER	REFERENCE DRAWING TITLE
REFERENCE DRAWINGS		

**ENGINEERS  
GEOLOGISTS  
MANITOBA**  
Certificate of Authorization  
Crosier Kilgour & Partners Ltd.  
No. 235

B.M. ELEV.			
NO.	ISSUED FOR TENDER	23/03/21	GJH
NO.	REVISIONS		

300-275 Carlton Street  
Winnipeg, Manitoba R3C 5S6  
T 204. 943. 7501  
F 204. 943. 7507  
2022-1008

**Crosier Kilgour & Partners Ltd.**  
CONSULTING STRUCTURAL ENGINEERS

DESIGNED BY	GJH	CHECKED BY	JAW
DRAWN BY	LOL	APPROVED BY	GJH
SCALE:	1:200	RELEASED FOR CONSTRUCTION BY:	
DATE	2023/03/21	DATE	

ENGINEER'S SEAL  
PROVINCE OF MANITOBA  
**J.A. WELLS**  
23/03/21  
REGISTERED PROFESSIONAL ENGINEER

CONSULTANT DRAWING NO. S2.8

**THE CITY OF WINNIPEG**  
WATER AND WASTE DEPARTMENT  
ENGINEERING DIVISION

DRINKING WATER TREATMENT PLANT  
MAIN BUILDING  
ROOF REPLACEMENT

BUILDING  
WM & WI ROOF  
PLAN

CITY FILE NUMBER  
**W-1049**

SHEET 1 OF 1

CITY DRAWING NUMBER  
1-0601B-B0071-001