

KEY PLAN
NOT TO SCALE

NEW ROOF PLAN KEYNOTES

- 1 SUPPLY AND INSTALL NEW ROOF SYSTEM AS PER NEW ROOF ASSEMBLY DETAILS AND SPECIFICATIONS.
- 2 SUPPLY AND INSTALL NEW VENT CURB AND PRE-MANUFACTURED STACK FLASHING TO ALLOW 400 ABOVE NEW ROOF SYSTEM, C/W 2-PLY SBS BASE AND GRANULATED CAP FLASHING MEMBRANES, TYPICAL AT ALL VENT, AIR INTAKE, EXHAUST VENT AND EXHAUST FAN LOCATIONS.
- 3 SUPPLY AND INSTALL NEW WOOD BLOCKING AND INSULATED WOOD PARAPET BUILT UP TO ALLOW 152mm ABOVE NEW FINISHED SURFACE OF NEW ROOF SYSTEM, COMPLETE WITH 2-PLY SBS BASE AND GRANULATED CAP FLASHING MEMBRANE, AND 24GA PRE-FINISHED METAL CAP FLASHING WITH EXPANSION CAPABILITIES IN ACCORDANCE WITH PROJECT DETAILS, TYPICAL. COLOUR TO BE SELECTED BY CONTRACT ADMINISTRATOR.
- 4 SUPPLY AND INSTALL NEW DRAIN ASSEMBLIES, ADJUST DRAIN HEIGHT AS REQUIRED TO ACCOMMODATE NEW ROOF ASSEMBLY, TYPICAL. SUPPLY AND INSTALL NEW PIPING AND TIE-IN TO EXISTING DRAINS AS REQUIRED, TYPICAL. REFER TO MECHANICAL DRAWINGS TO DETERMINE DRAIN ASSEMBLIES.
- 5 SUPPLY AND INSTALL NEW WOOD BLOCKING AND INSULATED WOOD CURB WALL BUILT TO ALLOW 152mm ABOVE NEW FINISHED SURFACE OF NEW ROOF SYSTEM, C/W SBS EXPANSION MEMBRANE AND 2-PLY SBS BASE AND GRANULATED CAP FLASHING MEMBRANE AT ALL EXPANSION JOINT DETAILS. SUPPLY AND INSTALL NEW 24GA PRE-FINISHED METAL CAP FLASHING WITH EXPANSION CAPABILITIES IN ACCORDANCE WITH PROJECT DETAILS, TYPICAL. COLOUR TO BE SELECTED BY CONTRACT ADMINISTRATOR.
- 6 SUPPLY AND INSTALL NEW WOOD BLOCKING CONTROL JOINT C/W 2-PLY SBS BASE AND GRANULATED CAP FLASHING MEMBRANE, TYPICAL.
- 7 SUPPLY AND INSTALL NEW 2-PLY SBS BASE AND GRANULATED CAP FLASHING MEMBRANE ON NEW WOOD CURBS, TO SUIT EXISTING UNITS AND RE-INSTALL MECHANICAL UNITS, TYPICAL. ENSURE MECHANICAL EQUIPMENT IS OPERATIONAL ONCE ROOF WORK IS COMPLETED.
- 8 SUPPLY AND INSTALL NEW 2-PLY SBS BASE AND GRANULATED CAP FLASHING MEMBRANE ON ALL EXISTING SLEEPERS, TYPICAL.
- 9 SUPPLY AND INSTALL NEW 24GA 900mm WIDE PRE-FINISHED METAL OVERFLOW SCUPPERS THROUGH PARAPET, BOTTOM OF SCUPPER TO BE 10mm± ABOVE FINISHED ROOF ASSEMBLY, TYPICAL.
- 10 SUPPLY AND INSTALL NEW PLYWOOD SHEATHING ON EXISTING CURB, C/W 2-PLY SBS BASE AND GRANULATED CAP FLASHING MEMBRANE, TYPICAL. REFER TO MECHANICAL FOR SIZES.
- 11 SUPPLY AND INSTALL NEW 2-PLY SBS BASE AND GRANULATED CAP FLASHING MEMBRANE AT ALL ROOF WALL INTERFACE DETAILS, TYPICAL.
- 12 SUPPLY AND INSTALL NEW PRE-MANUFACTURED PITCH POCKET ASSEMBLY AT ELECTRICAL ROOF PENETRATIONS, TYPICAL.
- 13 AS REQUIRED, RE-INSTALL AND ADJUST EXISTING GAS LINES TO ACCOMMODATE NEW ROOF SYSTEM. SUPPLY AND INSTALL NEW C-PORT PEDESTALS AS REQUIRED, TYPICAL.
- 14 RE-INSTALL ANTENNAS AT ORIGINAL LOCATION, REFER TO CONTRACT ADMINISTRATOR FOR PLACEMENT AND CONFIRM SERVICE.
- 15 SUPPLY AND INSTALL NEW SECONDARY OVERFLOW ROOF DRAIN. ENSURE MINIMUM 48" BETWEEN DRAINS AS DRAWN. REFER TO MECHANICAL AND BUILDING DETAILS. REFER TO MECHANICAL. TYPICAL.
- 16 SUPPLY AND INSTALL NEW 300mm WIDE PRIMARY DRAINAGE SCUPPER ASSEMBLIES AT LOW POINT OF ROOF. PROVIDE OPEN-FACED DOWNSPOUT AND CONCRETE SPLASH PAD, TYPICAL.
- 17 RE-INSTALL WINDSOCK AT ORIGINAL LOCATION.
- 18 PROVIDE OPEN-FACED DOWNSPOUT AND CONCRETE SPLASH PAD.
- 19 SUPPLY AND INSTALL NEW SANITARY VENT STACK ASSEMBLIES. TYPICAL.
- 20 SUPPLY AND INSTALL NEW ROOF SYSTEM AS PER NEW ROOF ASSEMBLY DETAILS AND SPECIFICATIONS. RE-INSTALL LOUVERS TO EXISTING CONDITIONS.
- 21 INFILL ROOF AT REMOVED CHIMNEY LOCATION.

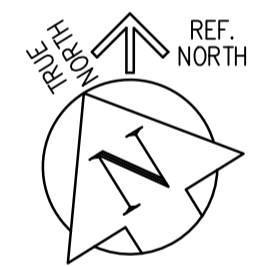

NEW ROOF PLAN
1 : 200 (WP)

NEW ROOF LEGEND

(TYPICAL ALL ROOF TYPES UNLESS NOTED OTHERWISE)

- | | | |
|------|------|--|
| WP-1 | WP-5 | • SBS TRAFFIC CAP SHEET MEMBRANE FOR FIELD SURFACES, HEAT WELDED |
| WP-2 | WP-6 | • SBS BASE SHEET MEMBRANE FOR FIELD SURFACES, SEMI-ADHERED |
| WP-3 | WP-7 | • POLYISOCYANURATE INSULATION TYPE II, ADHERED |
| WP-4 | WP-8 | • TAPERED (SLOPED) INSULATION AND BACKSLOPE, ADHERED |
- THERMOFUSIBLE AIR/VAPOUR BARRIER MEMBRANE
 - C/W EXTRA REINFORCED MEMBRANE.
 - EXISTING CONCRETE DECK

NEW ROOF ASSEMBLIES

(TYPICAL ALL ROOF TYPES UNLESS NOTED OTHERWISE)

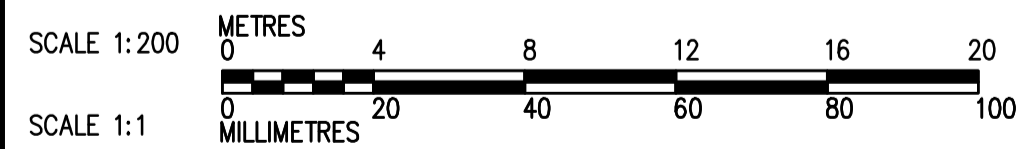
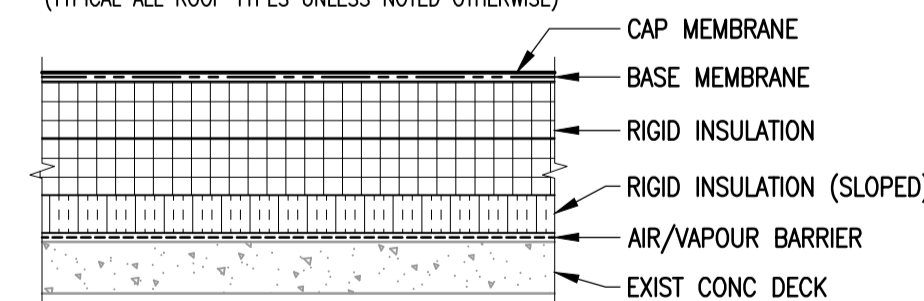

NO.	DRAWING NUMBER	REFERENCE DRAWING TITLE
10	1-0601B-M0016-001	MECHANICAL WP ROOF PLAN
9	1-0601B-B0076-009	BUILDING ROOF DETAILS 9 OF 9
8	1-0601B-B0076-004	BUILDING ROOF DETAILS 4 OF 9
7	1-0601B-B0076-003	BUILDING ROOF DETAILS 3 OF 9
6	1-0601B-B0076-002	BUILDING ROOF DETAILS 2 OF 9
5	1-0601B-B0076-001	BUILDING ROOF DETAILS 1 OF 9
4	1-0601B-B0071-001	BUILDING WM & WI ROOF PLAN
3	1-0601B-B0070-001	BUILDING WA ROOF PLAN
2	1-0601B-B0068-001	BUILDING WF, WR, WO & WC ROOF PLAN
1	1-0601B-G0004-001	BUILDING NOTES, SCHEDULE & LEGENDS

**ENGINEERS
GEOSCIENTISTS
MANITOBA**
Certificate of Authorization
Crosier Kilgour & Partners Ltd.
No. 235

B.M. ELEV.	NO.	ISSUED FOR TENDER	DATE	BY
	00	ISSUED FOR TENDER	23/03/21	GJH
	01	REVISIONS		

300-275 Carlton Street Winnipeg, Manitoba R3C 5S6 T 204. 943. 7501 F 204. 943. 7507 2022-1008		Crosier Kilgour & Partners Ltd. CONSULTING STRUCTURAL ENGINEERS	
DESIGNED BY	GJH	CHECKED BY	JAW
DRAWN BY	LOL	APPROVED BY	GJH
SCALE:	1:200	RELEASED FOR CONSTRUCTION BY:	
		DATE	2023/03/21

ENGINEER'S SEAL
PROVINCE OF MANITOBA
J.A. WELLS
23/03/21
REGISTERED PROFESSIONAL ENGINEER
CONSULTANT DRAWING NO. S2.6

THE CITY OF WINNIPEG
WATER AND WASTE DEPARTMENT
ENGINEERING DIVISION
DRINKING WATER TREATMENT PLANT
MAIN BUILDING
ROOF REPLACEMENT
BUILDING
WP ROOF
PLAN

CITY FILE NUMBER
W-1049
SHEET 1 OF 1
CITY DRAWING NUMBER
1-0601B-B0069-001