

APPENDIX C

FIGURES OF PROPOSED PRIVATE PROPERTY AUTHORIZATION EXTENTS, TRAFFIC MANAGEMENT, AND PEDESTRIAN RE-ROUTING

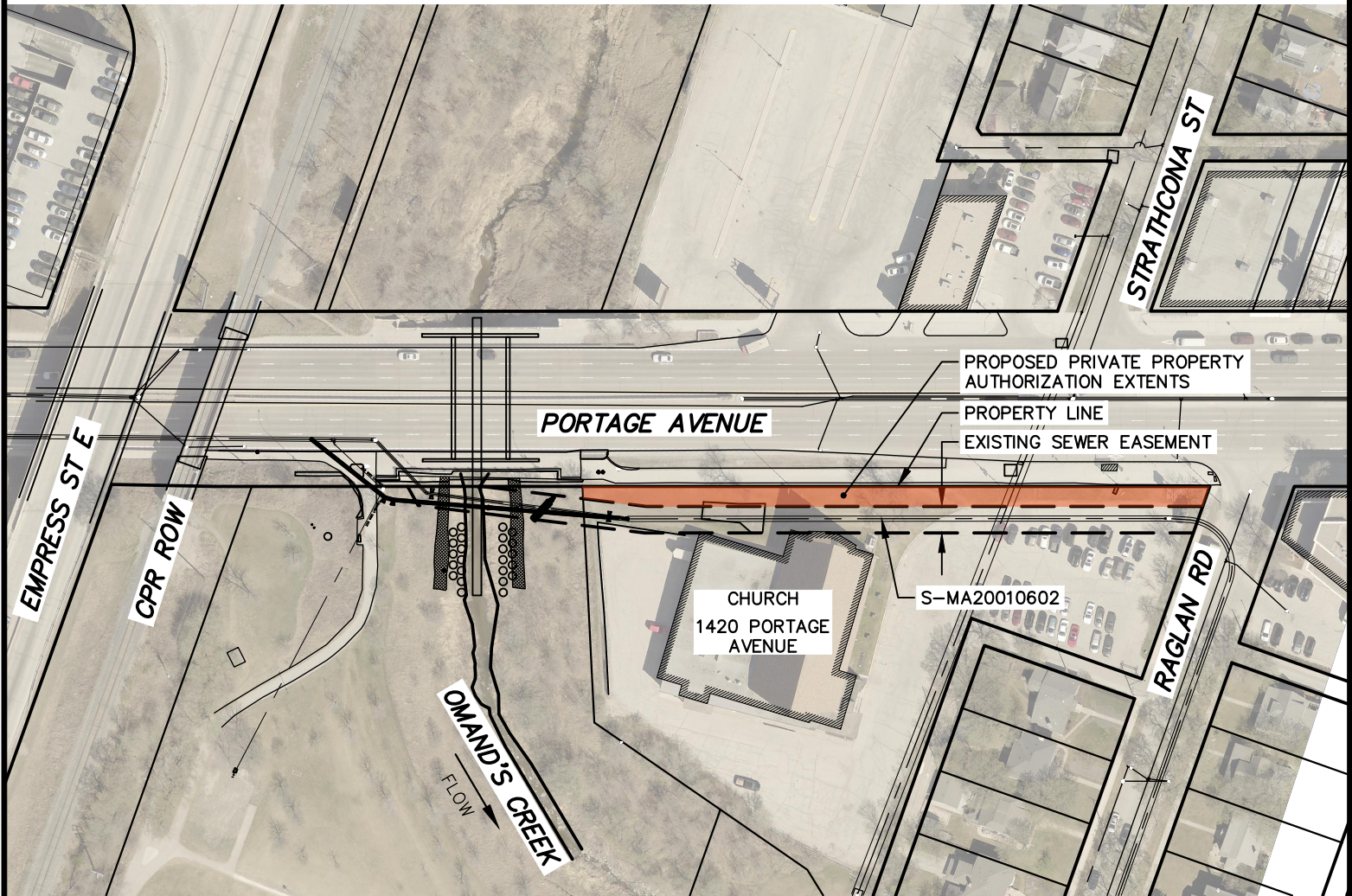
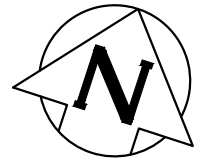

PROPERTY LIMITS DELINEATION

DELINEATION OF PROPERTY LIMITS AS SHOWN ON THIS DWG DOES NOT REPRESENT A "LEGAL SURVEY". KGS GROUP MAKES NO REPRESENTATION OR WARRANTY AS TO THE ACCURACY OF PROPERTY LIMITS DELINEATED ON THIS DWG, NOR ON THE DIMENSIONAL ACCURACY OF DWG FEATURES RELATIVE TO THOSE PROPERTY LIMITS.



METRIC

WHOLE NUMBERS INDICATE MILLIMETRES
DECIMALIZED NUMBERS INDICATE METRES



DESIGNED BY	NGV	CHECKED BY	-
DRAWN BY	GEL	APPROVED BY	-
DRAWING SCALE	1:1500	DRAWING DATE	2021 09 09
0	ISSUED FOR TENDER	2021.11.22	RBO
NO.	REVISIONS	DATE	BY



THE CITY OF WINNIPEG
WATER AND WASTE DEPARTMENT
ENGINEERING DIVISION

PORTAGE AVENUE INTERCEPTOR
SIPHON REPLACEMENT AT OMAND'S CREEK
PORTAGE AVENUE AT OMAND'S CREEK
APPROXIMATE PRIVATE PROPERTY AUTHORIZATION EXTENTS

REFERENCE SPEC. NO. -

DRAWING NUMBER
FIGURE 1

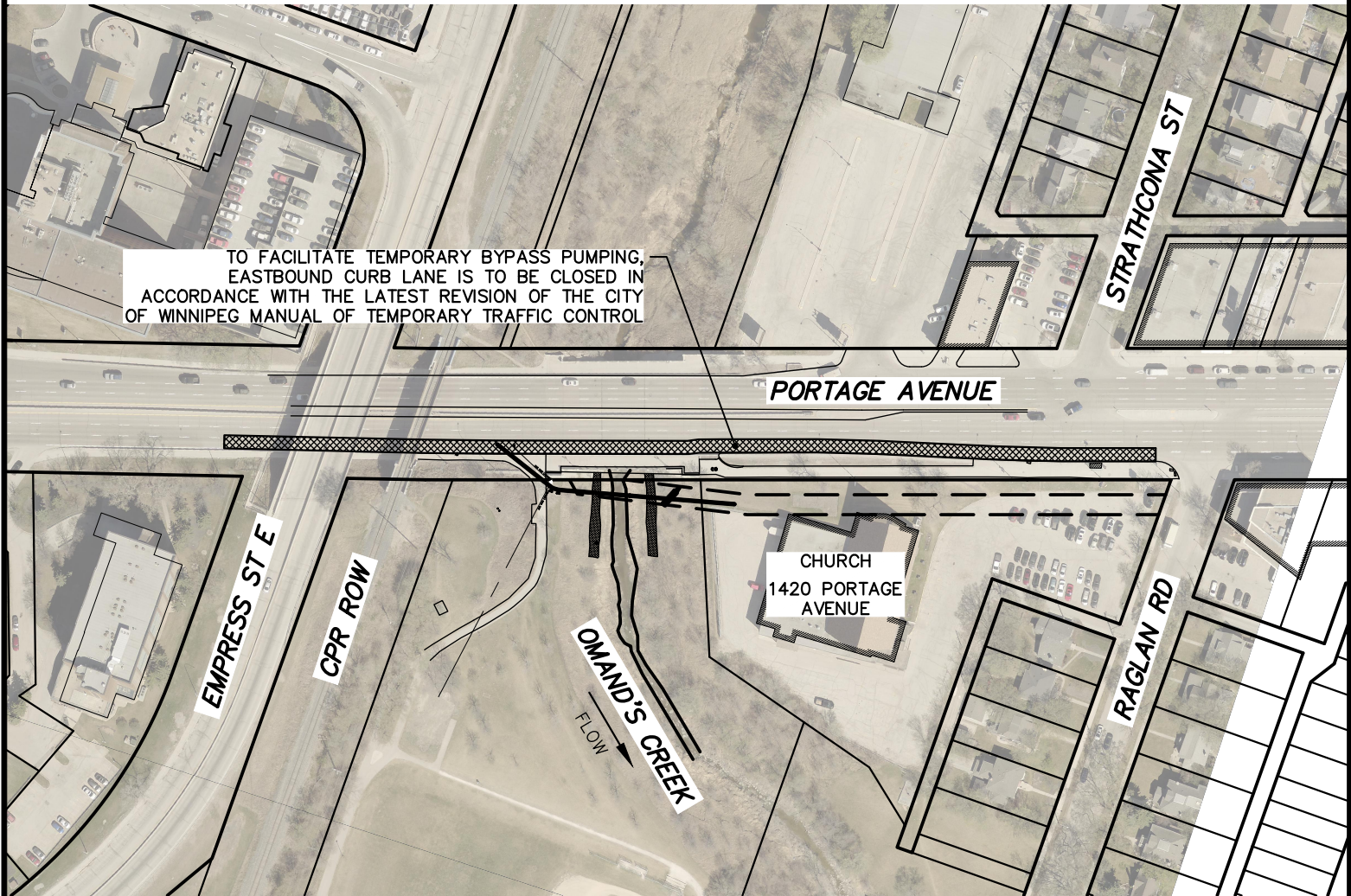
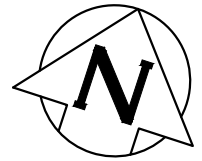

PROPERTY LIMITS DELINEATION

DELINEATION OF PROPERTY LIMITS AS SHOWN ON THIS DWG DOES NOT REPRESENT A "LEGAL SURVEY". KGS GROUP MAKES NO REPRESENTATION OR WARRANTY AS TO THE ACCURACY OF PROPERTY LIMITS DELINEATED ON THIS DWG, NOR ON THE DIMENSIONAL ACCURACY OF DWG FEATURES RELATIVE TO THOSE PROPERTY LIMITS.

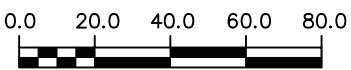

METRIC
 WHOLE NUMBERS INDICATE MILLIMETRES
 DECIMALIZED NUMBERS INDICATE METRES



DESIGNED BY	NGV	CHECKED BY	-
DRAWN BY	GEL	APPROVED BY	-
DRAWING SCALE	1:2000	DRAWING DATE	2021 09 09

THE CITY OF WINNIPEG
WATER AND WASTE DEPARTMENT
ENGINEERING DIVISION

PORTAGE AVENUE INTERCEPTOR
SIPHON REPLACEMENT AT OMAND'S CREEK
PORTAGE AVENUE AT OMAND'S CREEK
TRAFFIC MANAGEMENT PLAN

0	ISSUED FOR TENDER	2021.11.22	RBO
NO.	REVISIONS	DATE	BY

REFERENCE SPEC. NO. -

DRAWING NUMBER
FIGURE 2

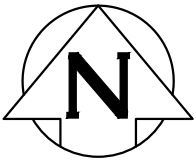

CONTRACTOR TO CLOSE SIDEWALK. CUSTOM WARNING SIGNAGE NOTIFYING OF UPCOMING CONSTRUCTION TO BE INSTALLED.

PORTAGE AVENUE

CONTRACTOR TO CLOSE SIDEWALK

CONTRACTOR TO CLOSE SIDEWALK. CUSTOM WARNING SIGNAGE NOTIFYING OF UPCOMING SIDEWALK CLOSURE TO BE INSTALLED AT TYLEHURST STREET AND ST JOHN AMBULANCE WAY

INSTALL BARRICADES AND WARNING SIGNS

EMPRESS ST E

OMAND'S CREEK

RAGLAN RD

CPR ROW

CONTRACTOR TO CLOSE PATHWAY. INSTALL BARRICADES AND CUSTOM SIGNAGE READING 'TO PORTAGE AVENUE' AS REQUIRED

CONTRACTOR TO CLOSE PATHWAY. INSTALL BARRICADES AND CUSTOM SIGNAGE READING 'TO PORTAGE AVENUE' AS REQUIRED

ASSINIBOINE RIVER



METRIC

WHOLE NUMBERS INDICATE MILLIMETRES
DECIMALIZED NUMBERS INDICATE METRES

KGS
GROUP

DESIGNED BY	NGV	CHECKED BY	-
DRAWN BY	GEL	APPROVED BY	-
DRAWING SCALE	1:2000	DRAWING DATE	2021 09 09



THE CITY OF WINNIPEG
WATER AND WASTE DEPARTMENT
ENGINEERING DIVISION

PORTAGE AVENUE INTERCEPTOR
SIPHON REPLACEMENT AT OMAND'S CREEK
PORTAGE AVENUE AT OMAND'S CREEK
PROPOSED PEDESTRIAN RE-ROUTING PLAN

0	ISSUED FOR TENDER	2021.11.22	RBO
NO.	REVISIONS	DATE	BY

REFERENCE SPEC. NO.

DRAWING NUMBER
FIGURE 3