

PROFILE - LANE PAVEMENT

Scale H=1:250 V=1:10

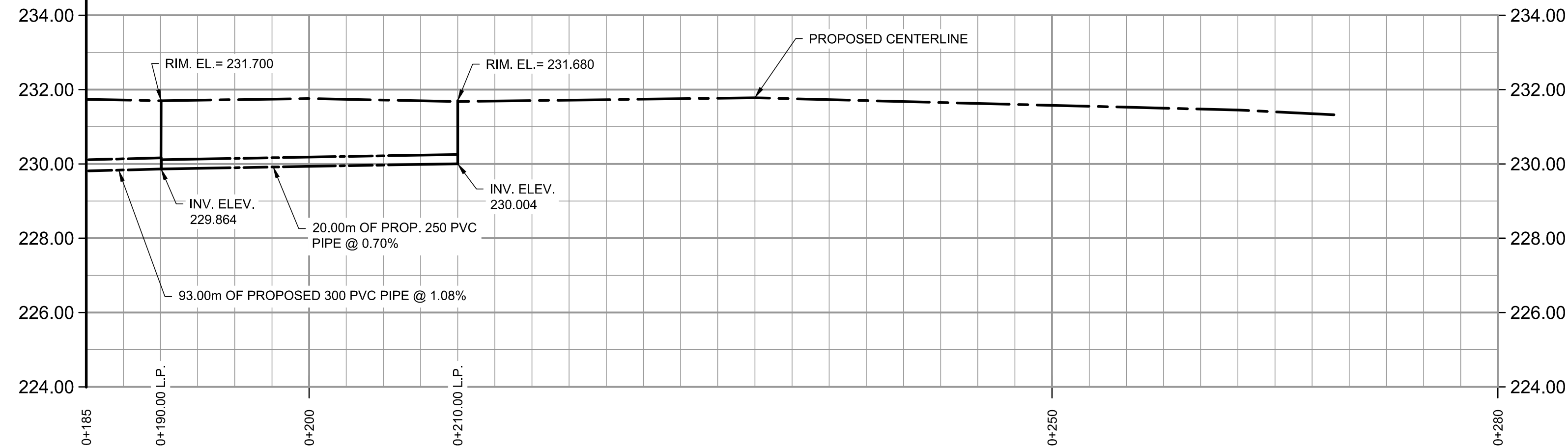

PROFILE - ALLEY DRAINAGE

Scale H=1:250 V=1:100

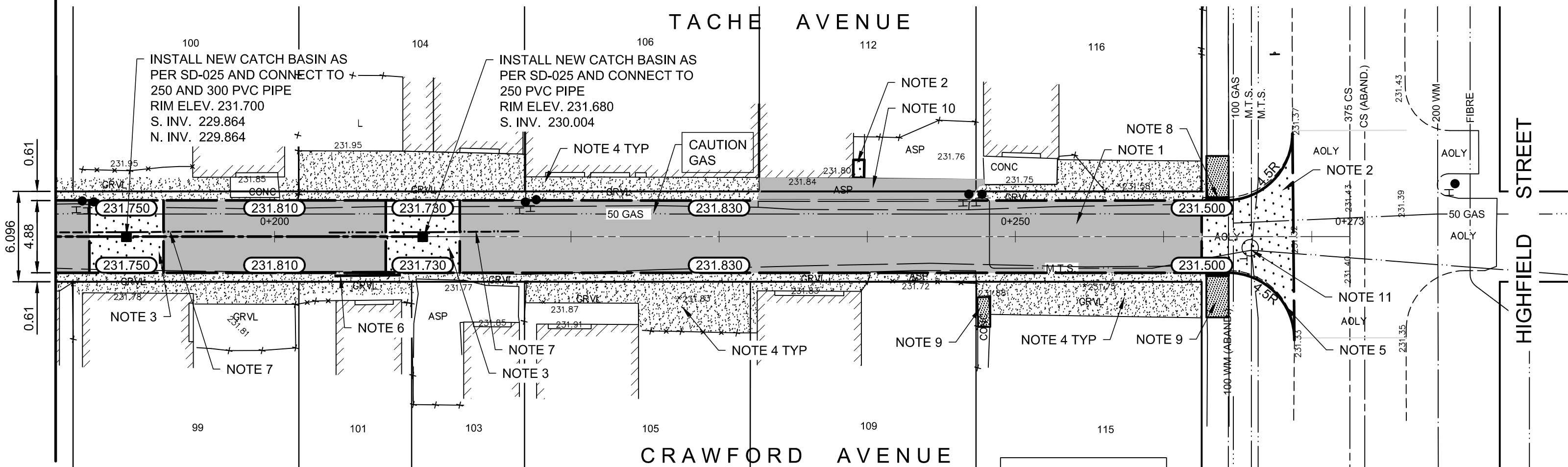

PLAN - ALLEY

Scale 1:250

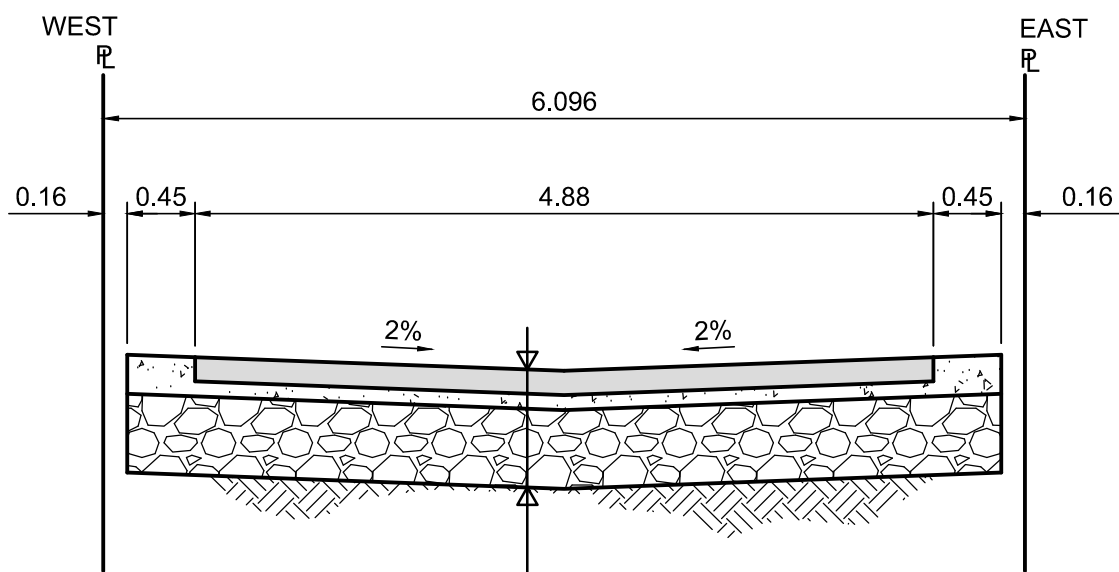

50mm ASPHALT (TYPE I)
75mm ASPHALT (TYPE II)
100mm BASE COURSE (GRANULAR B)
200mm - 50mm SUB-BASE (GRANULAR B)
GEOGRID (CLASS A)
SEPARATION/FILTRATION FABRIC ON PREPARED SUBGRADE

SECTION - TYPICAL

Scale NTS

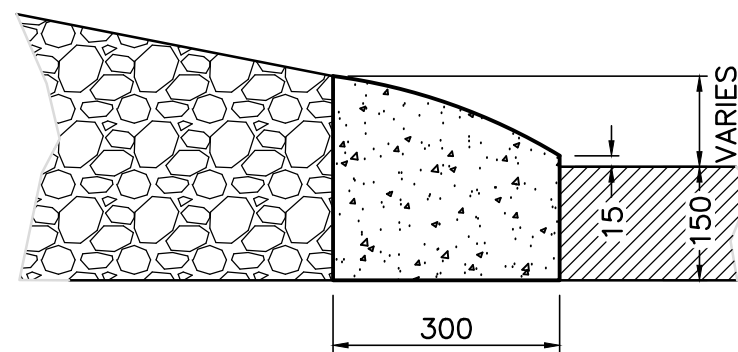

DETAIL - LIP CURB (MONOLITHIC)

Scale NTS

REFERENCE NOTES:

- PAVEMENT DIMENSIONS ARE TO BACK OF CURB
- BASELINE IS CENTRE LINE OF 6.096m WIDE RIGHT OF WAY
- PROPERTY LINES OBTAINED FROM CITY OF WINNIPEG L.B.I.S., AND NO SCALE FACTOR WAS APPLIED
- REFER TO AECOM FIELD BOOK NO. 5097

CONSTRUCTION NOTES:

- CONSTRUCT NEW ASPHALT PAVEMENT AS PER TYPICAL SECTION
- REMOVE EXISTING CONCRETE PAVEMENT AND CONSTRUCT NEW 150mm REINFORCED CONCRETE PAVEMENT
- CONSTRUCT NEW 150mm REINFORCED CONCRETE PAVEMENT
- REGRADE EXISTING GRAVEL SURFACE WITH BASE COURSE
- CONSTRUCT NEW MODIFIED BARRIER CURB (180mm HT. INTEGRAL)
- CONSTRUCT NEW LIP CURB (MONOLITHIC) AS PER DETAIL
- INSTALL 6.0m SUBDRAIN PIPE ON EITHER SIDE OF CATCH BASIN
- CONSTRUCT NEW CURB RAMP (10mm HT. INTEGRAL)
- RENEW EXISTING CONCRETE SIDEWALK
- REMOVE EXISTING ASPHALT PAVEMENT AND CONSTRUCT NEW ASPHALT PAVEMENT
- MATCH EXISTING BELL MTS MANHOLE

ENGINEERS
GEOSCIENTISTS
MANITOBA
Certificate of Authorization
AECOM Canada Ltd.
No. 4671 Date: _____

PRELIMINARY
NOT FOR CONSTRUCTION

Date: 2021/07/20

METRIC

WHOLE NUMBERS INDICATE MILLIMETRES
DECIMALIZED NUMBERS INDICATE METRES

150 mm W.M.	WATERMAIN	150 mm W.M.	HYDRO	150 mm W.M.	HYDRO	150 mm W.M.	HYDRO	150 mm W.M.	HYDRO
◇	HYDRANT	◇	M.T.S.	◇	M.T.S.	◇	M.T.S.	◇	M.T.S.
⊙	VALVE	⊙	CONCRETE	⊙	CONCRETE	⊙	CONCRETE	⊙	CONCRETE
300mm L.D.S.	LAND DRAINAGE SEWER	300mm L.D.S.	ASPHALT	300mm L.D.S.	ASPHALT	300mm L.D.S.	ASPHALT	300mm L.D.S.	ASPHALT
250mm W.W.S.	WASTEWATER SEWER	250mm W.W.S.	GRAVEL	250mm W.W.S.	GRAVEL	250mm W.W.S.	GRAVEL	250mm W.W.S.	GRAVEL
○	MANHOLE	○	SURVEY BAR	○	SURVEY BAR	○	SURVEY BAR	○	SURVEY BAR
□	CATCH BASIN	□	ELEVATION	□	ELEVATION	□	ELEVATION	□	ELEVATION
▽	CATCH PIT	▽	TREE	▽	TREE	▽	TREE	▽	TREE
—	PROPERTYLINE	—	SIDEWALK RAMP	—	SIDEWALK RAMP	—	SIDEWALK RAMP	—	SIDEWALK RAMP
—	CULVERT	—	CONCRETE SIDEWALK	—	CONCRETE SIDEWALK	—	CONCRETE SIDEWALK	—	CONCRETE SIDEWALK
—	GAS	—	FENCE	—	FENCE	—	FENCE	—	FENCE
EXISTING	LEGEND - PLAN	PROPOSED	EXISTING	LEGEND - PLAN	PROPOSED	EXISTING	LEGEND - PROFILE	PROPOSED	EXISTING

LOCATION APPROVED
UNDERGROUND STRUCTURES

SUPV. U/G STRUCTURES
COMMITTEE

NOTE:
LOCATION OF UNDERGROUND STRUCTURES AS SHOWN ARE BASED ON THE BEST INFORMATION AVAILABLE, BUT NO GUARANTEE IS GIVEN THAT ALL EXISTING UTILITIES ARE SHOWN OR THAT THE GIVEN LOCATIONS ARE EXACT. CONFIRMATION OF EXISTENCE AND EXACT LOCATION OF ALL SERVICES MUST BE OBTAINED FROM THE INDIVIDUAL UTILITIES BEFORE PROCEEDING WITH CONSTRUCTION.

B.M. 88R519 - W. SIDE CHAIRING CROSS CRES. S. OF S. LEG OF STRAND CIRCLE. T.B.T. ON TOP OF 0.05m sq. x 2.4m IRON TUBE. 7.5m E. OF E. WALL & 15.8m S. OF S. WALL NO. 119 STRAND CIRCLE. OR 35.38m S. OF S.L. STRAND CIRCLE & 5.9m E. OF W.L. CHAIRING CROSS CRES. ELEVATION: 232.430

0	ISSUED FOR TENDER	07/20/2021	RC
A	ISSUED FOR REVIEW	07/08/2021	BC
NO.	REVISIONS	DATE	BY

DESIGNED BY	BC	CHECKED BY	RC
DRAWN BY	RAM/PAAP	APPROVED BY	RC
HOR. SCALE:	1:250	ORIGINAL SIGNED BY:	
VERTICAL:	AS SHOWN	DATE	2021/06/16

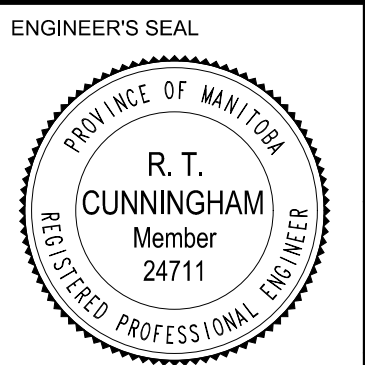

CONSULTANT DRAWING NO.
CT-02

THE CITY OF WINNIPEG
PUBLIC WORKS DEPARTMENT
ENGINEERING DIVISION

2021 LOCAL IMPROVEMENT ALLEYS	CITY DRAWING NUMBER
CRAWFORD AVE. / TACHE AVE. ALLEY - CONISTON ST. TO HIGHFIELD ST.	SHEET 02 OF 04
LOCAL IMPROVEMENT STA. 0+185 TO STA. 0+280	