

NOTE: CHAINAGES SHOWN ARE ALONG S PL WELLINGTON CR

GENERAL NOTES:

- ALL WORKS TO BE IN ACCORDANCE WITH THE LATEST REVISIONS OF THE CITY OF WINNIPEG STANDARD CONSTRUCTION SPECIFICATIONS..
- INSTALL FORCEMAIN AND SEWERMAIN BY TRENCHLESS METHODS.
- CONTRACTOR TO PROVIDE TEMPORARY SHORING WHERE REQUIRED IN ACCORDANCE WITH THE LATEST REVISIONS TO THE "CONSTRUCTION SAFETY ACT" OF THE PROVINCE OF MANITOBA DEPARTMENT OF LABOR AND IN ACCORDANCE WITH THE PROVINCE OF MANITOBA "W210 WORKPLACE SAFETY & HEALTH ACT" AND "GUIDELINES FOR EXCAVATION WORK". WHERE SHORING IS REQUIRED, THE CONTRACTOR SHALL SUPPLY STAMPED ENGINEERING SHORING DESIGN BY ENGINEER REGISTERED IN PROVINCE OF MANITOBA,
- ALL ELEVATIONS SHOWN ON DRAWINGS ARE TAKEN FROM CITY OF WINNIPEG RECORD DRAWINGS.
- CONTRACTOR TO CONFIRM ALL DIMENSIONS BEFORE ASSEMBLING PIPE.
- EXPOSE EXISTING FORCEMAIN AT STA. 1+06.55 & WWS AT ALL PROPOSED MANHOLE LOCATIONS AND CONFIRM INVERTS AND EXISTING PIPE SIZES PRIOR TO CONSTRUCTION.
- CONTRACTOR TO VERIFY ALL EXISTING UNDERGROUND UTILITIES AND EXISTING SERVICES VIA SOFT-DIGGING PRIOR TO CONSTRUCTION.

TEMPORARY BY-PASS PUMPING NOTES:

- CONTRACTOR TO PROVIDE TEMPORARY BY-PASS PUMPING OF FLOWS DURING CONNECTION OF NEW FORCEMAIN TO CHATAWAY PUMP STATION.
- CONTRACTOR TO PROVIDE BY-PASS PUMPING PLAN TO CONTRACT ADMINISTRATOR FOR REVIEW A MINIMUM OF 2 WEEKS PRIOR TO COMMENCEMENT OF ANY WORK ON THE FORCEMAIN.
- PUMPING TO BE FROM WET WELL OF LIFT STATION TO EITHER MH-A (NEW), MH-B (EXISTING) OR BY-PASS MANHOLE DEPENDING ON CONTRACTOR SCHEDULE.
- CONTRACTOR SHALL NOT OPERATE GATES. CONTRACTOR TO CONSTRUCT TEMPORARY WEIR U/S OF STATION AS REQUIRED FOR BY PASS PUMPING.
- TEMPORARY BY-PASS PUMP MUST (AT MINIMUM) BE CAPABLE OF PUMPING THE PDWF = 25 L/S
- REDUNDANT PUMP REQUIRED ON SITE AT ALL TIMES DURING BY-PASS PUMPING.
- SEWAGE LEVEL IN SYSTEM MUST NEVER EXCEED ELEVATION 225.394 m (THE OVERFLOW WEIR). CONTRACTOR TO PROVIDE INSPECTION OF UPSTREAM ELEVATION DURING BY-PASS PUMPING.
- THE CONTRACTOR MAY BE REQUIRED TO WORK EVENINGS, NIGHTS AND WEEKENDS WHERE REQUIRED TO MINIMIZE FORCEMAIN INTERRUPTIONS DURING THIS PROJECT.
- ALL INSTRUMENTATION IN LIFT STATION AND MANHOLES SHALL BE PROTECTED AND AVOIDED AT ALL TIMES.

LAYOUT CONTROL TABLE			
STATION	NORTHING (m)	EASTING (m)	ELEVATION (m)
1+06.55	5526045.86	628525.56	228.57
1+13.72	5526045.29	628543.13	228.52
1+25.67	5526044.80	628545.20	228.50
1+45.00	5526029.00	628567.60	228.45
1+84.87	5526035.78	628606.84	230.12

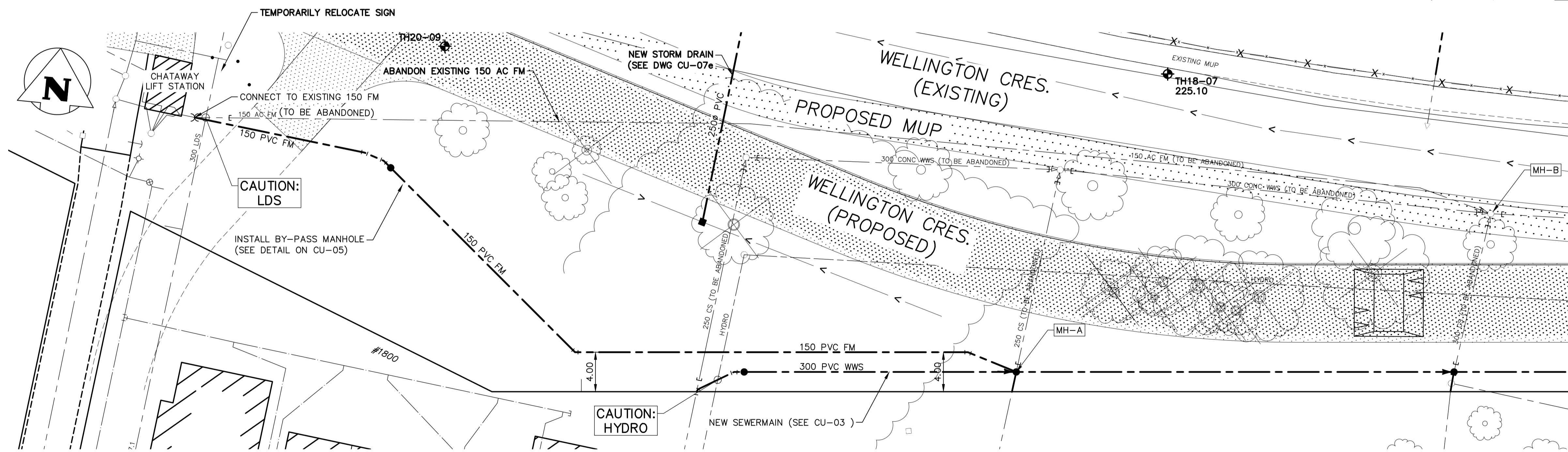

PROPERTY LIMITS DELINEATION

DELINEATION OF PROPERTY LIMITS AS SHOWN ON THIS DWG DOES NOT REPRESENT A "LEGAL SURVEY". KGS GROUP MAKES NO REPRESENTATION OR WARRANTY AS TO THE ACCURACY OF PROPERTY LIMITS DELINEATED ON THIS DWG, NOR ON THE DIMENSIONAL ACCURACY OF DWG FEATURES RELATIVE TO THOSE PROPERTY LIMITS.

FOR INDEX PAGE SEE DWG CU-00

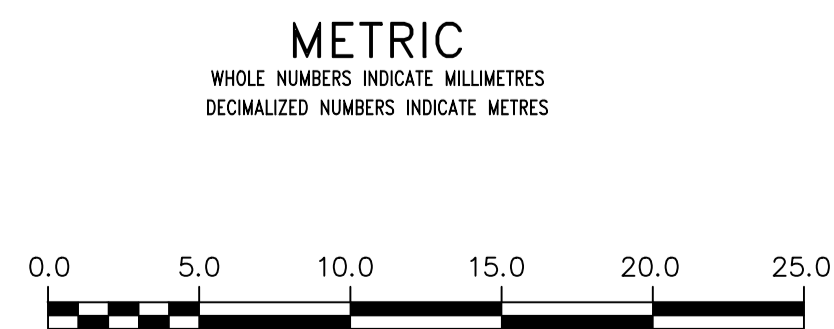

**WARNING**  
IF POWER EQUIPMENT OR EXPLOSIVES ARE TO BE USED FOR EXCAVATION ON THIS PROJECT THE CONTRACTOR MUST:  
1) NOTIFY THE GAS COMPANY OF THE PROPOSED LOCATION OF EXCAVATION.  
2) TAKE PRECAUTION TO AVOID DAMAGE TO GAS COMPANY INSTALLATIONS.  
SEE PROVINCIAL REGULATION 21072 FOR DETAILS

**LOCATION APPROVED**  
UNDERGROUND STRUCTURES  
SUPV. U/G STRUCTURES COMMITTEE DATE  
NOTE:  
LOCATION OF UNDERGROUND STRUCTURES AS SHOWN ARE BASED ON THE BEST INFORMATION AVAILABLE BUT NO GUARANTEE IS GIVEN THAT ALL EXISTING UTILITIES ARE SHOWN OR THAT THE GIVEN LOCATIONS ARE EXACT. CONFIRMATION OF EXISTENCE AND EXACT LOCATION OF ALL SERVICES WAS OBTAINED FROM THE INDIVIDUAL UTILITIES BEFORE PROCEEDING WITH CONSTRUCTION.

B.M.	ELEV.	NO.	REVISIONS	DATE	BY
		1	RE-ISSUED FOR TENDER	20/10/15	RBO
		0	ISSUED FOR TENDER	20/10/05	RBO

**KGS GROUP**

DESIGNED BY	TLE	CHECKED BY	RBO
DRAWN BY	PwD	APPROVED BY	RBO
SCALE:		RELEASED FOR CONSTRUCTION	
HORIZONTAL	1:250	DATE	
VERTICAL	1:50		
DATE	2020 10 15		

PLOT DATE: 2020 10 15

ENGINEER'S SEAL  
CONSULTANT DRAWING NUMBER  
CU-04

**THE CITY OF WINNIPEG**  
WATER AND WASTE DEPARTMENT  
ENGINEERING DIVISION

WELLINGTON CRESCENT  
RIVERBANK, PATH AND ROADWAY PROJECT

**FORCEMAIN**  
PLAN AND PROFILE  
S-MA70018599

SHEET 23 OF 69  
CITY DRAWING NUMBER  
12598

TENDER No.: 1173-2019  
CONTRACT NUMBER: X

FILE PATH: R:\Projects\2018\18-0107-011\Dwg\Mun\  
FILE NAME: 18-0107-011\_CALL\_Ug.dwg