

DUNKIRK DR RIGHT TURN LANE TO ST MARY'S RD

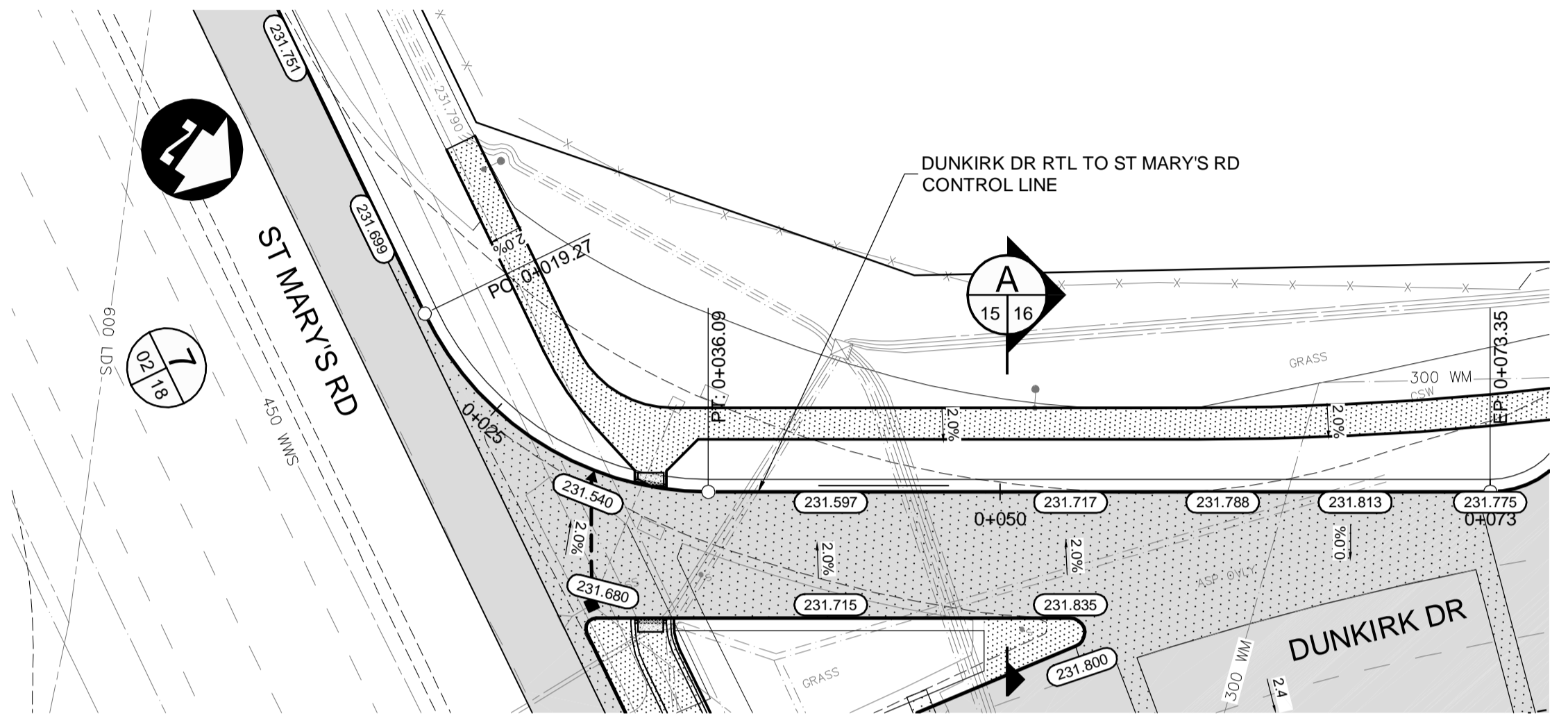

ST MARY'S RD RIGHT TURN LANE TO DUNKIRK DR

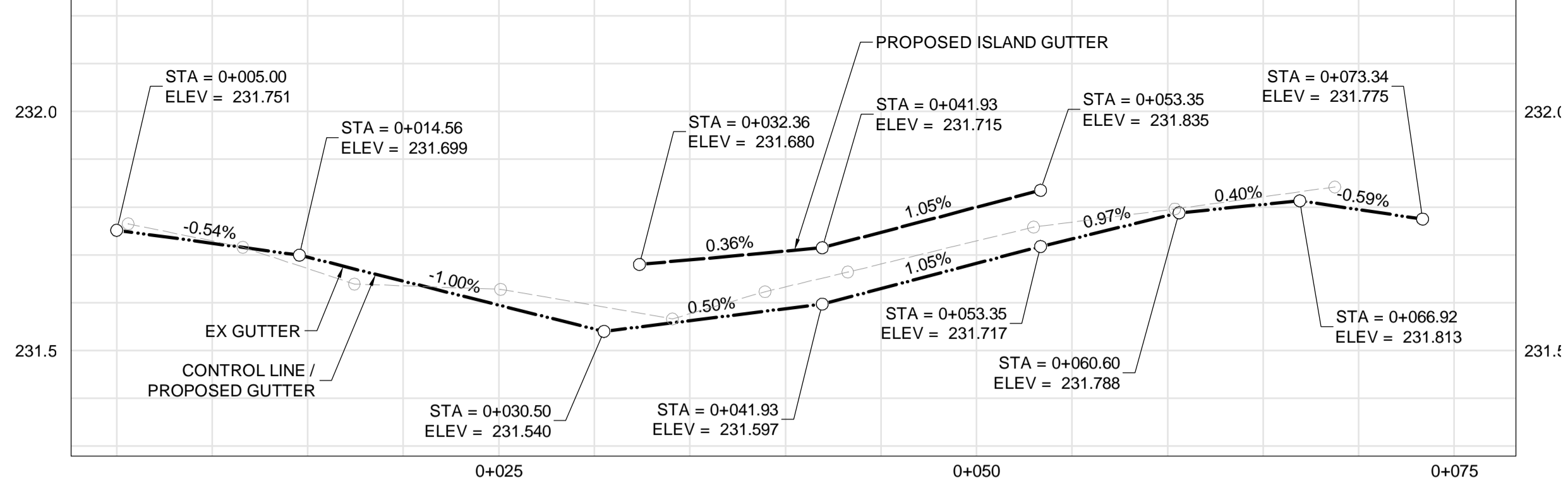
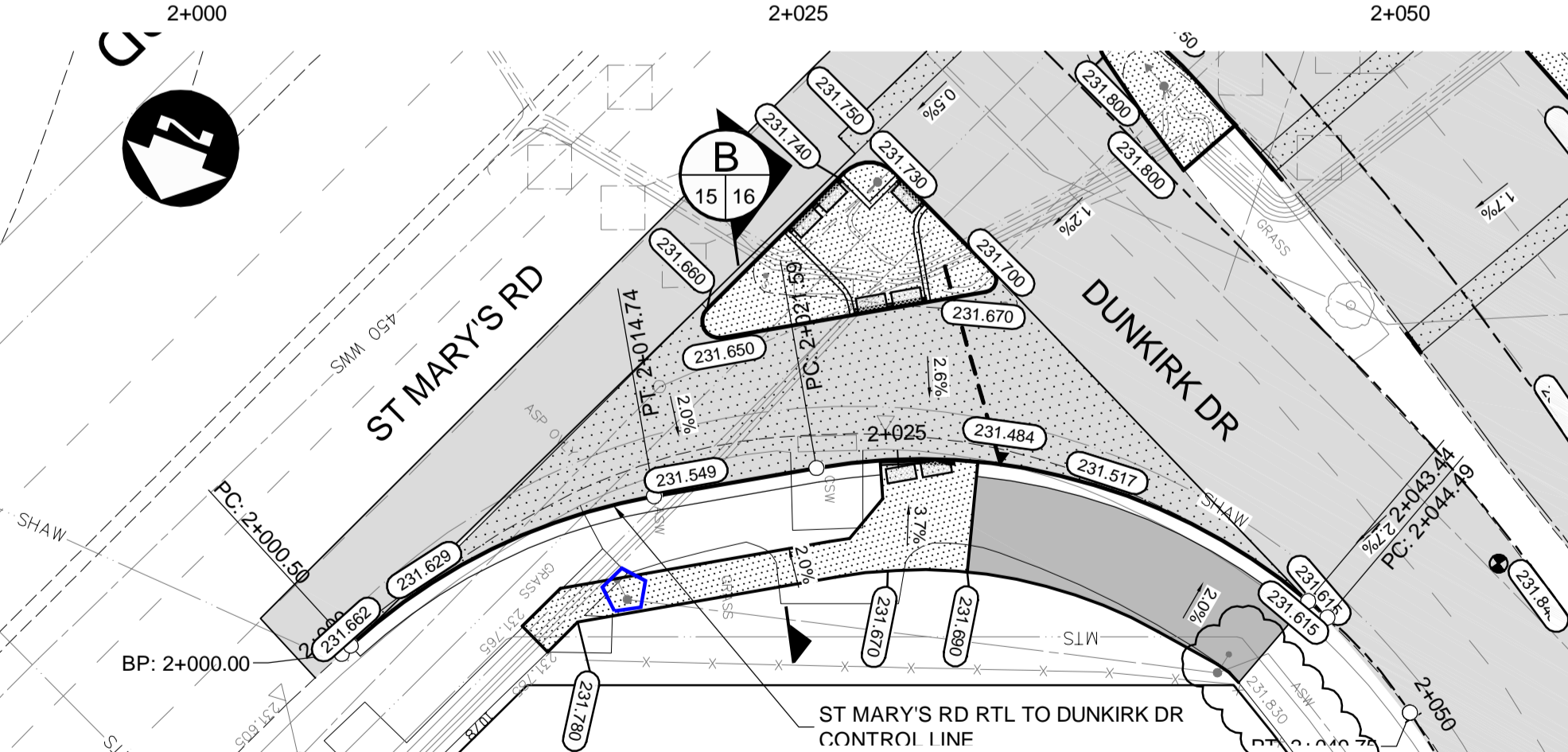
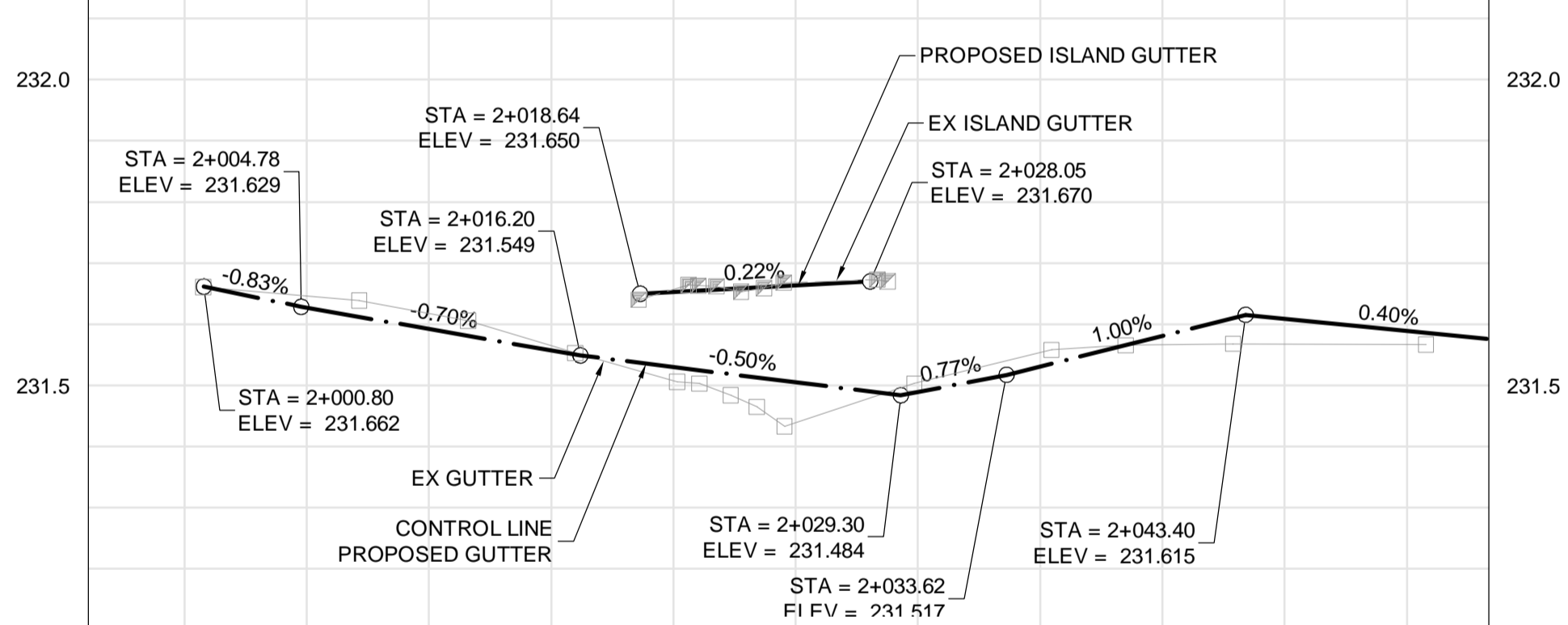

DUNKIRK DR MUP AT RTL TO FERMOR AVE

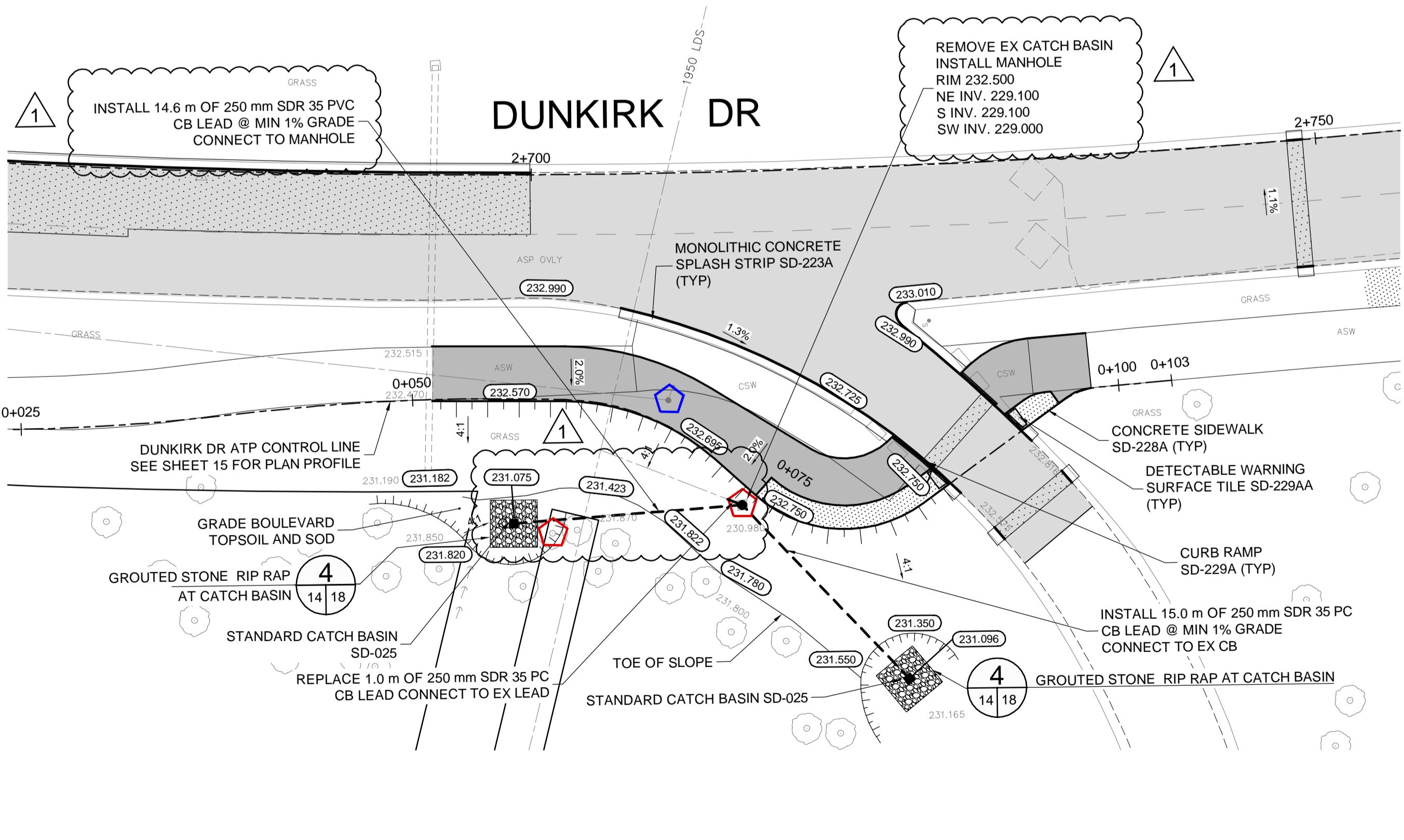
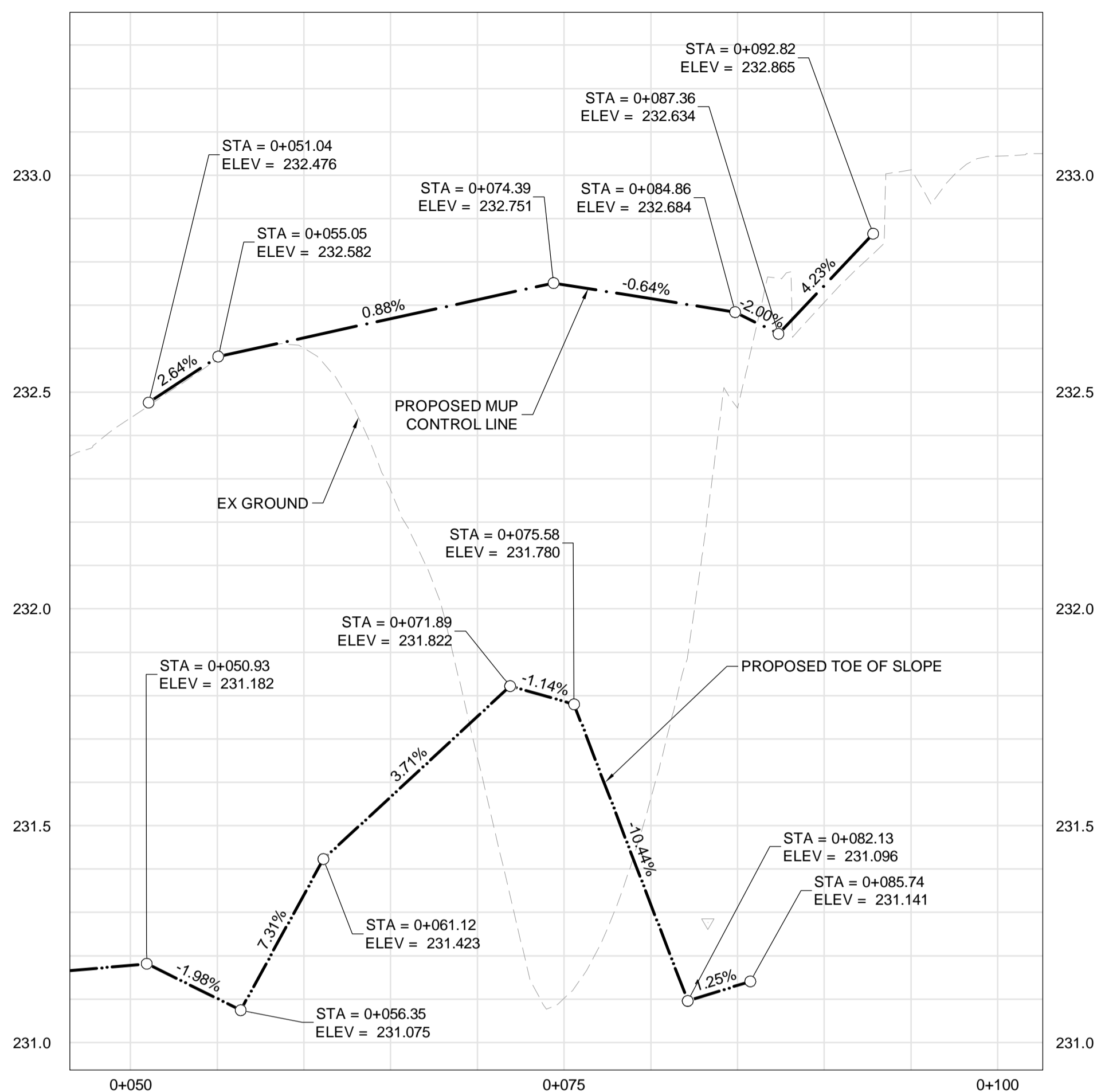

CONSTRUCTION NOTES:

- ALL WORK AND MATERIALS TO BE IN ACCORDANCE WITH LATEST REVISION OF THE CITY OF WINNIPEG STANDARD CONSTRUCTION SPECIFICATIONS.
- LEGAL PLAN AND UNDERGROUND INFORMATION FROM CITY OF WINNIPEG LBIS. CONTRACTOR TO VERIFY ALL UNDERGROUNDS IN THE FIELD.
- CONTRACTOR TO TAKE PRECAUTIONARY STEPS TO AVOID DAMAGE FROM CONSTRUCTION ACTIVITIES TO TREES WITHIN THE LIMITS OF CONSTRUCTION.
- LOCATION OF EXISTING SERVICES TO BE CONFIRMED IN THE FIELD BY THE CONTRACTOR.
- INSTALL CB LEADS AT MIN 1% SLOPE OR AS DIRECTED BY THE CONTRACT ADMINISTRATOR.

LEGEND

	ADJUST
	REMOVE
	REMOVE BY OTHERS
	RELOCATE

BORE HOLE LOCATIONS

TEST HOLE ID	NORTHING	EASTING
01	5523643.200	635139.615
02	5523585.223	635163.019

ABBREVIATIONS:

CONC	CONCRETE ROADWAY
ASP	ASPHALT ROADWAY
ASP OVLY	ASPHALT OVERLAY ROADWAY
GRAN	GRANULAR ROADWAY
PVS	PAVING STONE/BRICK
CSW	CONCRETE SIDEWALK
ASW	ASPHALT SIDEWALK
GSW	GRANULAR SIDEWALK
TYP	TYPICAL
EX	EXISTING
MH	MANHOLE
WV	WATER VALVE
EL	ELEVATION
CB	CATCH BASIN
CP	CATCH PIT
CI	CURB INLET
CL	CONTROL LINE

METRIC

WHOLE NUMBERS INDICATE MILLIMETRES
DECIMALIZED NUMBERS INDICATE METRES

WARNING

IF POWER EQUIPMENT OR EXPLOSIVES ARE TO BE USED FOR EXCAVATION ON THIS PROJECT THE CONTRACTOR MUST:

- NOTIFY THE GAS COMPANY OF THE PROPOSED LOCATION OF EXCAVATION.
- TAKE PRECAUTION TO AVOID DAMAGE TO GAS COMPANY INSTALLATIONS SEE PROVINCIAL REGULATION 210/72 FOR DETAILS.
- OBTAIN EXCAVATION PERMITS PRIOR TO CONSTRUCTION.

APEGM
Certificate of Authorization
Dillon Consulting Limited (MB)
No. 1789 Date: 20/12/03

C:\pwworking\directory\projects\2020_400\p\18155\202434-DUN-CT-CON-PLAN-PROFILE.dwg

EXISTING	LEGEND-PLAN	PROPOSED	EXISTING	LEGEND-PLAN	PROPOSED	EXISTING	LEGEND-PROFILE	PROPOSED
	HYDRANT			CONCRETE			WATERMAIN	
	VALVE			ASPHALT			LAND DRAINAGE SEWER	
	MANHOLE			SIDEWALK			WASTE WATER SEWER	
	CATCH BASIN			PAVING STONES			HYDRANT	
	CATCH PIT			PAVEMENT REPAIR FABRIC			VALVE	
	150 WM			PROPERTY LINE			C PROFILE	
	300 LDS			ELEVATION			NORTH/WEST GUTTER	
	250 WWS			TRAFFIC SIGNAL			SOUTH/EAST GUTTER	
	HYDRO			SURVEY BAR			NORTH/WEST DITCH	
	M.T.S.			CURB RAMP			SOUTH/EAST DITCH	
	100 GAS			DETECTABLE TILE				

UNDERGROUND STRUCTURES

UGS APPROVED - NOVEMBER 20, 2020

LOCATION OF UNDERGROUND STRUCTURES AS SHOWN ARE BASED ON THE BEST INFORMATION AVAILABLE, BUT NO GUARANTEE IS GIVEN THAT ALL EXISTING UTILITIES ARE SHOWN OR THAT THE GIVEN LOCATIONS ARE EXACT. CONFIRMATION OF EXISTENCE AND EXACT LOCATION OF ALL SERVICES MUST BE OBTAINED FROM THE INDIVIDUAL UTILITIES BEFORE PROCEEDING WITH CONSTRUCTION.

NO.	REVISIONS	DATE	BY
1	ISSUED FOR ADDENDUM #2	20/12/16	DBW
0	ISSUED FOR TENDER	20/12/03	DBW

DESIGNED BY	RTP/PMW
DRAWN BY	PMW
CHECKED BY	TCS
APPROVED BY	DBW
HOR. SCALE	1:250
VERTICAL	1:10
RELEASED FOR CONSTRUCTION	DATE
ENGINEER'S SEAL	
TENDER DRAWING	
NOT TO BE USED FOR CONSTRUCTION	
CONSULTANT PROJECT NUMBER	20-2434

THE CITY OF WINNIPEG
PUBLIC WORKS DEPARTMENT

Winnipeg

2021-2023 REGIONAL PAVEMENT RENEWAL PROJECT
DUNKIRK DRIVE REHABILITATION
ST MARY'S ROAD TO FERMOR AVENUE

CITY DRAWING NUMBER
P-3537-2021-15

SHEET 15 OF 28

CONSULTANT DRAWING NUMBER

RTL TURN LANES AND ATP PLAN PROFILE