

SOUTHBOUND

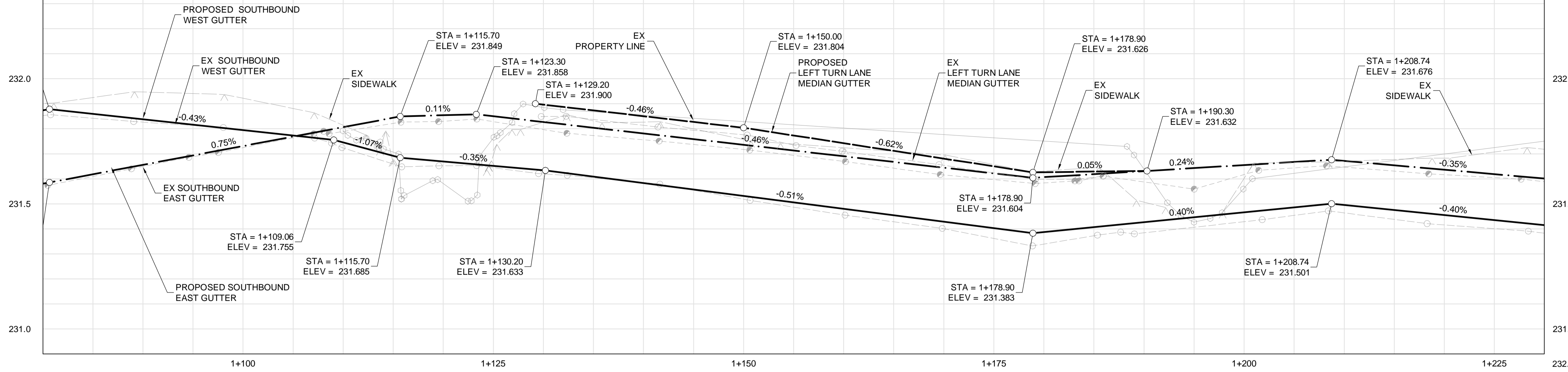

NORTHBOUND

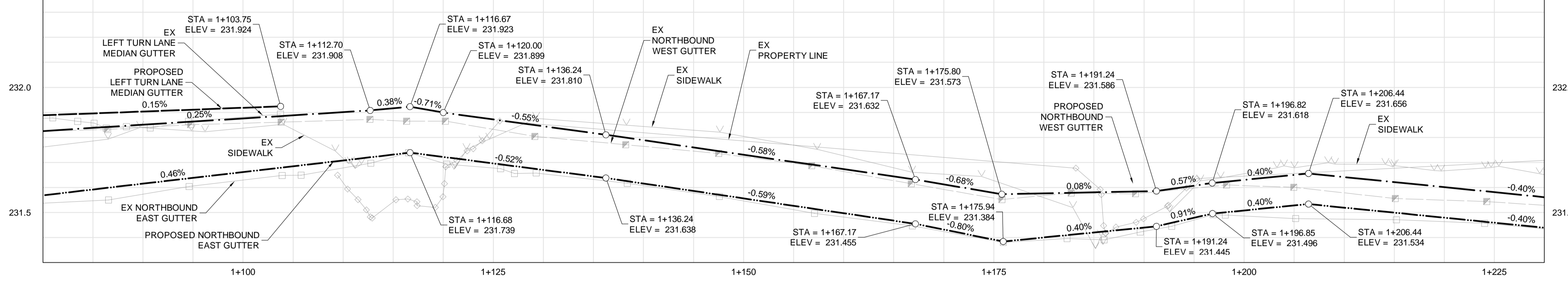

CONSTRUCTION NOTES:

- ALL WORK AND MATERIALS TO BE IN ACCORDANCE WITH LATEST REVISION OF THE CITY OF WINNIPEG STANDARD CONSTRUCTION SPECIFICATIONS.
- LEGAL PLAN AND UNDERGROUND INFORMATION FROM CITY OF WINNIPEG LBIS. CONTRACTOR TO VERIFY ALL UNDERGROUNDS IN THE FIELD.
- CONTRACTOR TO TAKE PRECAUTIONARY STEPS TO AVOID DAMAGE FROM CONSTRUCTION ACTIVITIES TO TREES WITHIN THE LIMITS OF CONSTRUCTION.
- LOCATION OF EXISTING SERVICES TO BE CONFIRMED IN THE FIELD BY THE CONTRACTOR.
- INSTALL CB LEADS AT MIN 1% SLOPE OR AS DIRECTED BY THE CONTRACT ADMINISTRATOR.

LEGEND

- ADJUST
- ◻ REMOVE
- ◻ REMOVE BY OTHERS
- ◻ RELOCATE

BORE HOLE LOCATIONS		
TEST HOLE ID	NORTHING	EASTING
17	552220.744	635570.581

ABBREVIATIONS:

- | | |
|----------|-------------------------|
| CONC | CONCRETE ROADWAY |
| ASP | ASPHALT ROADWAY |
| ASP OVLY | ASPHALT OVERLAY ROADWAY |
| GRAN | GRANULAR ROADWAY |
| PVS | PAVING STONE/BRICK |
| CSW | CONCRETE SIDEWALK |
| ASW | ASPHALT SIDEWALK |
| GSW | GRANULAR SIDEWALK |
| TYP | TYPICAL |
| EX | EXISTING |
| MH | MANHOLE |
| VV | WATER VALVE |
| EL | ELEVATION |
| CB | CATCH BASIN |
| CP | CATCH PIT |
| CI | CURB INLET |
| CL | CONTROL LINE |

METRIC

WHOLE NUMBERS INDICATE MILLIMETRES
DECIMALIZED NUMBERS INDICATE METRES

WARNING

IF POWER EQUIPMENT OR EXPLOSIVES ARE TO BE USED FOR EXCAVATION ON THIS PROJECT THE CONTRACTOR MUST:

- NOTIFY THE GAS COMPANY OF THE PROPOSED LOCATION OF EXCAVATION.
- TAKE PRECAUTION TO AVOID DAMAGE TO GAS COMPANY INSTALLATIONS SEE PROVINCIAL REGULATION 210/72 FOR DETAILS.
- OBTAIN EXCAVATION PERMITS PRIOR TO CONSTRUCTION.

APEGM
Certificate of Authorization
Dillon Consulting Limited (MB)
No. 1789 Date: 20/12/03

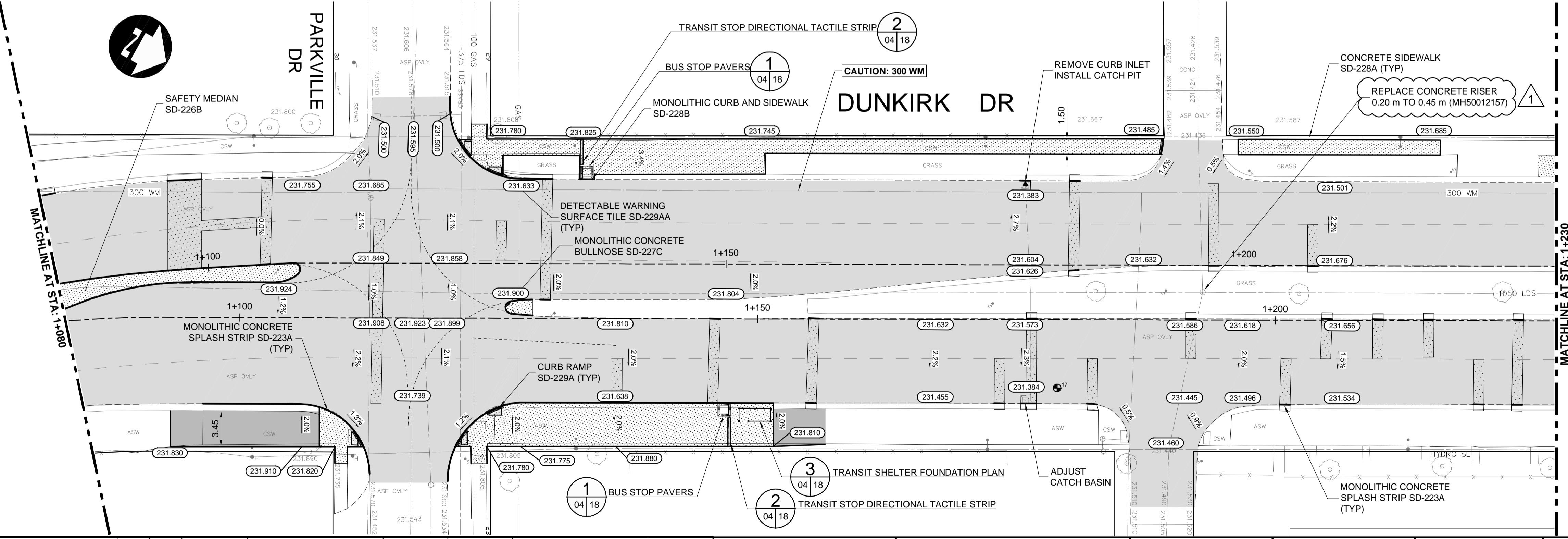

C:\w\working\directory\projects\2020_400\p\18155\202434-DUN-CT-CON-PLAN-PROFILE.dwg

EXISTING	LEGEND-PLAN	PROPOSED	EXISTING	LEGEND-PLAN	PROPOSED	EXISTING	LEGEND-PROFILE	PROPOSED
	HYDRANT			CONCRETE			WATERMAIN	
	VALVE			ASPHALT			LAND DRAINAGE SEWER	
	MANHOLE			SIDEWALK			WASTE WATER SEWER	
	CATCH BASIN			PAVING STONES			HYDRANT	
	CATCH PIT			PAVEMENT REPAIR FABRIC			VALVE	
	150 WM			PROPERTY LINE			PROFILE	
	300 LDS			ELEVATION			NORTH/WEST GUTTER	
	250 WWS			TRAFFIC SIGNAL			SOUTH/EAST GUTTER	
	HYDRO			SURVEY BAR			NORTH/WEST DITCH	
	M.T.S.			CURB RAMP			SOUTH/EAST DITCH	
	100 GAS			DETECTABLE TILE				
	EXISTING			PROPOSED				

UNDERGROUND STRUCTURES
UGS APPROVED - NOVEMBER 20, 2020

LOCATION OF UNDERGROUND STRUCTURES AS SHOWN ARE BASED ON THE BEST INFORMATION AVAILABLE, BUT NO GUARANTEE IS GIVEN THAT ALL EXISTING UTILITIES ARE SHOWN OR THAT THE GIVEN LOCATIONS ARE EXACT. CONFIRMATION OF EXISTENCE AND EXACT LOCATION OF ALL SERVICES MUST BE OBTAINED FROM THE INDIVIDUAL UTILITIES BEFORE PROCEEDING WITH CONSTRUCTION.

B.M. ELEV.	DESIGNED BY	CHECKED BY	APPROVED BY	DATE	BY
	RTP/PMW	PMW	TCS		DBW
			DBW	20/12/16	DBW
			DBW	20/12/03	DBW

NO.	REVISIONS	DATE	BY
1	ISSUED FOR ADDENDUM #2	20/12/16	DBW
0	ISSUED FOR TENDER	20/12/03	DBW

DILLON CONSULTING

RELEASED FOR CONSTRUCTION

ENGINEER'S SEAL
TENDER DRAWING
NOT TO BE USED FOR CONSTRUCTION

THE CITY OF WINNIPEG
PUBLIC WORKS DEPARTMENT

2021-2023 REGIONAL PAVEMENT RENEWAL PROJECT
DUNKIRK DRIVE REHABILITATION
ST MARY'S ROAD TO FERMOR AVENUE

PLAN PROFILE (STA 1+085 TO 1+230)

CITY DRAWING NUMBER: P-3537-2021-04
SHEET 04 OF 28
CONSULTANT DRAWING NUMBER

CONSULTANT PROJECT NUMBER: 20-2434