

WAVERLEY STREET

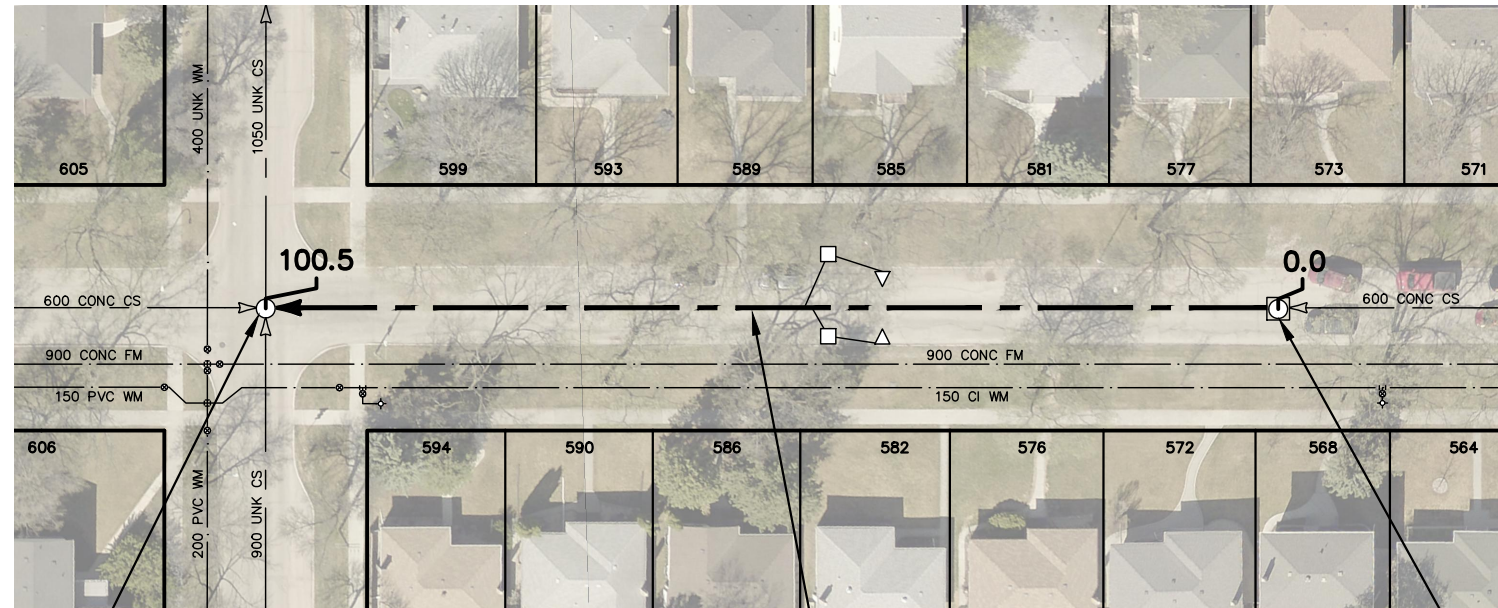

SEWER JUNCTION INFORMATION FROM SEWER VIDEO INSPECTION		
SEWER ID S-MA60005834		
DISTANCE FROM MH ID S-MH60004509		
DISTANCE	DIAMETER	CLOCK
3.8	150	10
7.6	150	02
15.3	150	10
16.0	150	02
25.4	150	02
27.7	150	10
34.6	150	02
39.9	150	10
43.0	150	02
47.6	150	11
48.4	150	02
52.3	150	10
52.9	150	02
62.1	150	02
64.4	150	10
71.2	150	02
76.7	150	10
80.4	150	02
88.7	150	11
89.5	150	02
92	150	11



S-MH60004495
RIM 232.95
INV N 227.80
INV S 228.08
INV E 227.78
INV W 227.70

100.5 OF 600 CLAY CS TO BE LINED
S-MA60005834
(FULLY DETERIORATED)

S-MH60004509
RIM 232.84
INV N 228.32
INV S 228.32



WARNING

IF POWER EQUIPMENT OR EXPLOSIVES ARE TO BE USED FOR EXCAVATION ON THIS PROJECT THE CONTRACTOR MUST:

- 1) NOTIFY THE GAS COMPANY OF THE PROPOSED LOCATION OF EXCAVATION.
- 2) TAKE PRECAUTION TO AVOID DAMAGE TO GAS COMPANY INSTALLATIONS.

SEE PROVINCIAL REGULATION 210/72 FOR DETAILS

FOR INDEX SEE
12361

METRIC

WHOLE NUMBERS INDICATE MILLIMETRES
DECIMALIZED NUMBERS INDICATE METRES

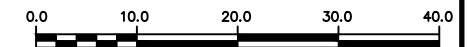

LOCATION APPROVED
UNDERGROUND STRUCTURES

SUPV. U/G STRUCTURES COMMITTEE DATE

NOTE:

LOCATION OF UNDERGROUND STRUCTURES AS SHOWN ARE BASED ON THE BEST INFORMATION AVAILABLE BUT NO GUARANTEE IS GIVEN THAT ALL EXISTING UTILITIES ARE SHOWN OR THAT THE GIVEN LOCATIONS ARE EXACT. CONFIRMATION OF EXISTENCE AND EXACT LOCATION OF ALL SERVICES MUST BE OBTAINED FROM THE INDIVIDUAL UTILITIES BEFORE PROCEEDING WITH CONSTRUCTION.

B.M.
ELEV.

NO.	REVISIONS	YY/MM/DD	BY



DESIGNED BY	JKH	CHECKED BY	HAK
DRAWN BY	DML	APPROVED BY	BWB
SCALE:		RELEASED FOR CONSTRUCTION	STACY COURNOYER
HORIZONTAL	1:750	DATE	2020/03/02
VERTICAL			

ENGINEER'S SEAL

ORIGINAL SIGNED
BY H.A. KATZ
2020 03 02

CONSULTANT DRAWING NUMBER



THE CITY OF WINNIPEG
WATER AND WASTE DEPARTMENT
ENGINEERING DIVISION

2020 SEWER RENEWALS BY CIPP LINING (LARGE DIAMETER)

CONTRACT 3

WAVERLEY STREET

3RD MH S OF CORYDON AVENUE TO
MH AT FLEET AVENUE

SHEET 17 OF 17

CITY DRAWING NUMBER

12376