

Plotfile: M:\2020_05_23_2020.ctb, 2020, at 10:18:55 AM, Last saved by: Barry K. Underpass Maintenance\WSP Drawings\20M-00233-00 St. Vital Ped Underpass DD_03-04 - general arrangement.dwg | Layout: 3 Proposed General Arrangement Plan and Scope of Work | A1 SIZE (594 mm x 841 mm)

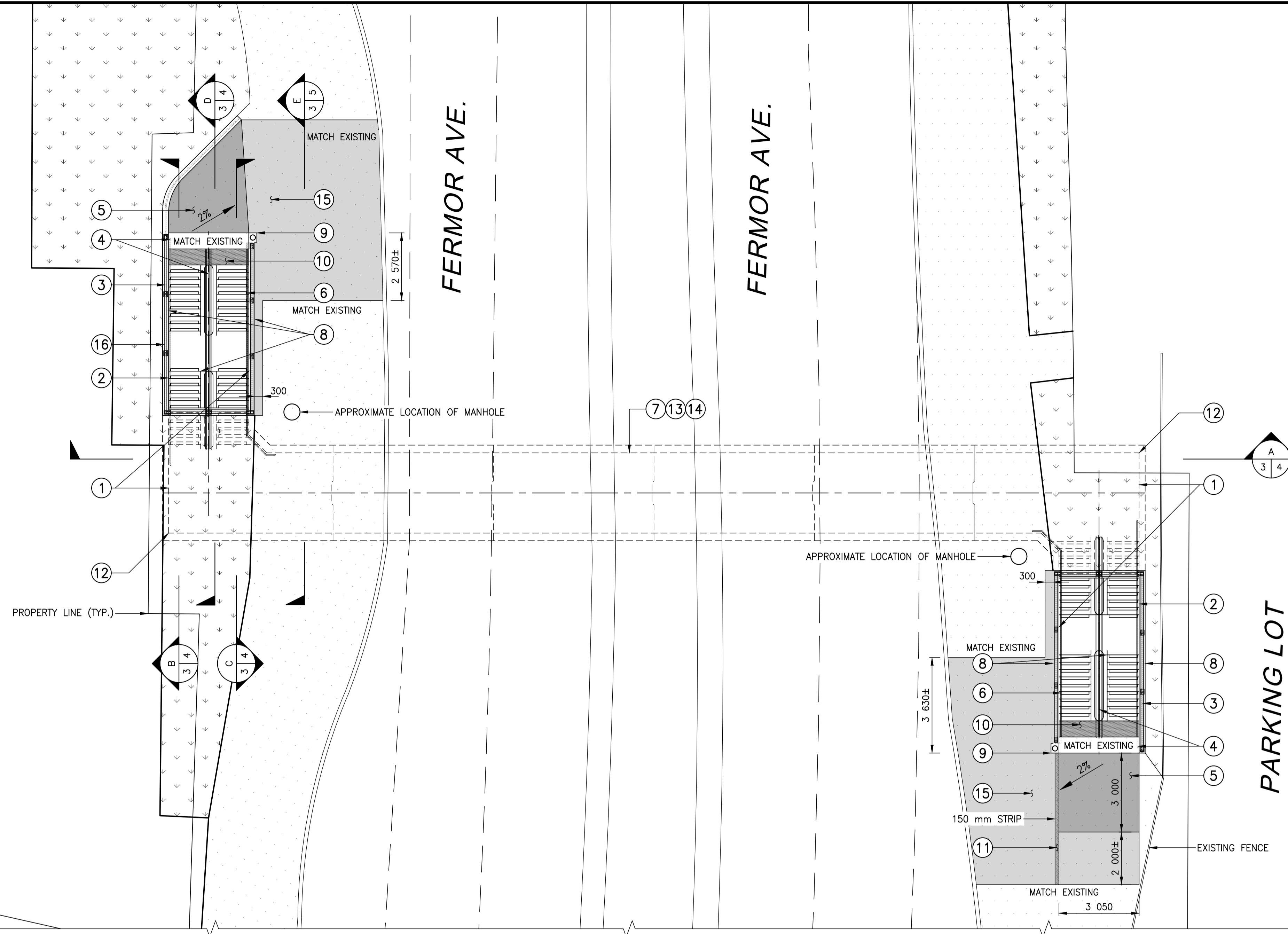

GENERAL ARRANGEMENT PLAN

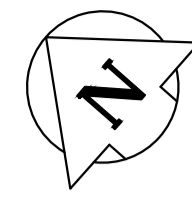

MAJOR ITEMS OF WORK

ITEM	DESCRIPTION
1	REMOVE 50 x 50 TILES AND GROUT, CLEAN CONCRETE SUBSTRATE, AND PLACE PAINT (TYP.)
2	REMOVE AND REPLACE SEAL AT EXISTING CONSTRUCTION JOINT - QUANTITY: 4 (TYP.)
3	REMOVE AND REPLACE GUARDRAILS (TYP.) (REMOVAL ONLY ON NORTH CURVED CURB WALL)
4	REMOVE AND REPLACE HANDRAILS - QUANTITY: 6 (TYP.)
5	REMOVE CONCRETE SIDEWALK AND PLACE 150 mm REINFORCED CONCRETE SLAB TO MATCH EXISTING TOP STAIR LANDING AND SIDEWALK GRADE. REINFORCED CONCRETE SLAB TO TIE-IN INTO CONCRETE STAIR LANDING WITH 10M TIE-IN REINFORCING BARS @ 300 mm O/C E/W
6	REPAIR CONCRETE STAIR NOSING AND REPLACE STAIR TREAD - QUANTITY: 11 (TYP.)
7	TYPE 1 - CONCRETE PATCH REPAIR (TYP.)
8	TYPE 2 - CONCRETE REPAIRS (TYP.)
9	TYPE 3 - CONCRETE REPAIR (TYP.)
10	PLACE SURFACE MOUNTED DETECTABLE WARNING TILES AT TOP OF STAIRWELL
11	INSTALL CAST IN PLACE 150 mm x 5000 mm DETECTABLE WARNING TILE STRIP ALONG NORTH EDGE OF SOUTH REINFORCED CONCRETE SLAB
12	INSTALL QUARTER DOME ACRYLIC SAFETY MIRRORS
13	SANDBLAST, PRIME AND PAINT ALL UNDERPASS AND STAIR WALL SURFACES
14	SANDBLAST, PRIME AND PAINT CEILING SURFACES
15	100 mm CONCRETE SIDEWALK RENEWAL TO MATCH EXISTING SIDEWALK AND GRADE TO MATCH REINFORCED CONCRETE SLAB WITH 12 mm FOAM BOARD AGAINST EXISTING CURB WALL AND CAULKED JOINT
16	REMOVE VEGETATION TO FACILITATE WORK

TRAFFIC CONTROL NOTES

- INSTALL PEDESTRIAN CONTROL SIGNS AND BARRIERS.
- SINGLE LANE CLOSURES ON FERMOR AVENUE ARE PERMITTED TO STAGE THE WORK, EXCEPT DURING PEAK HOURS 7:00 AM TO 9:00 AM AND 3:30 PM TO 5:30 PM MONDAY THROUGH FRIDAY.

NOTE

- THE "MAJOR ITEMS OF WORK" LIST IS NOT A COMPREHENSIVE SCOPE OF WORK. REFER TO THE SPECIFICATION AND DRAWINGS FOR FURTHER DETAILS.
- SEE SHEET 2 FOR DESIGN DATA AND GENERAL NOTES.
- SEE SHEET 5 FOR GUARDRAIL LAYOUT.

LOCATIONS APPROVED UNDERGROUND STRUCTURES

SIGNED BY: _____ DATE: _____
 SUPV U/G STRUCTURES

LOCATION OF UNDERGROUND STRUCTURES AS SHOWN ARE BASED ON THE BEST INFORMATION AVAILABLE BUT NO GUARANTEE IS GIVEN THAT ALL EXISTING UTILITIES ARE SHOWN OR THAT THE GIVEN LOCATIONS ARE EXACT CONFIRMATION OF EXISTENCE AND EXACT LOCATION OF ALL SERVICES MUST BE OBTAINED FROM THE INDIVIDUAL UTILITIES BEFORE PROCEEDING

DESIGNED BY	MM	CHECKED BY	MLW
DRAWN BY	KP	APPROVED BY	JL
HOR. SCALE	AS SHOWN	RELEASED FOR CONSTRUCTION	
VERTICAL	AS SHOWN		
0 ISSUED FOR TENDER	20.05.22	JL	
No. REVISIONS	DATE	BY	DATE
			20.05.22



WSP Canada Group Limited
 93 Lombard Avenue, Suite 111
 Winnipeg MB R3B 3B1
 T+ 1 204-943-3178
 F+ 1 204-943-4948
 www.wsp.com

ENGINEER'S SEAL

CONSULTANT PROJECT No.
 20M-00233-00



NOTE:
 These design documents are prepared solely for the use by the party with whom the design professional has entered into a contract and there are no representations of any kind made by the design professional to any party with whom the design professional has not entered into a contract.

METRIC
 WHOLE NUMBERS INDICATE MILLIMETRES
 DECIMALIZED NUMBERS INDICATE METRES



FERMOR AVENUE PEDESTRIAN UNDERPASS NEAR ST. MARY'S ROAD - MAINTENANCE WORKS
PROPOSED GENERAL ARRANGEMENT PLAN AND SCOPE OF WORK

CITY DRAWING NUMBER	U218-20-03
BID OPPORTUNITY NUMBER	372-2020
SHEET OF	3 7
REV	0