

MATCHLINE STATION 0+210

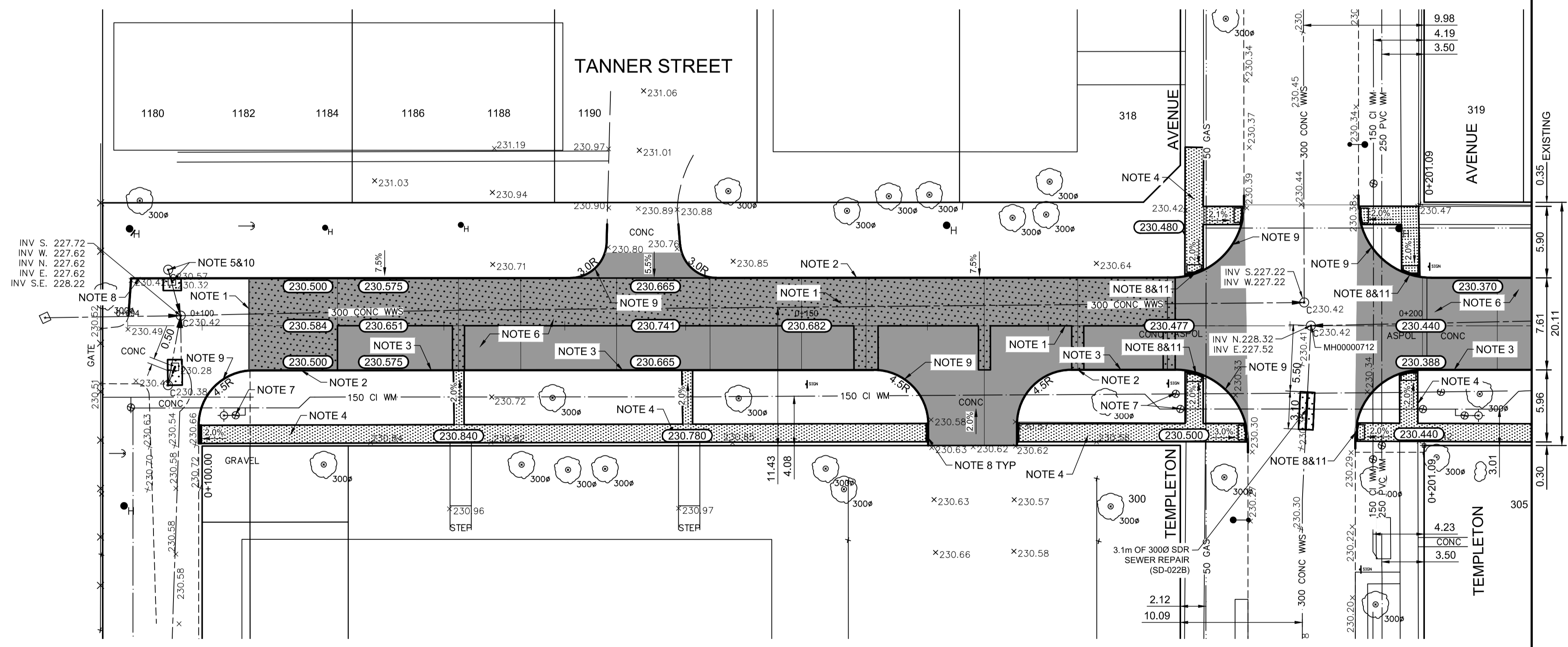
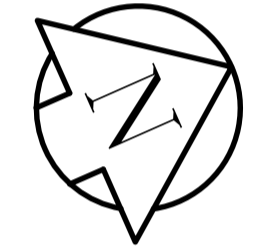

- REFERENCE NOTES:**
- PAVEMENT DIMENSIONS ARE TO BACK OF CURB
 - BASELINE IS CENTRE LINE ROADWAY
 - PROPERTY LINES OBTAINED FROM CITY OF WINNIPEG L.B.I.S., AND NO SCALE FACTOR WAS APPLIED
 - REFER TO AECOM FIELD BOOK NO. 5057
- CONSTRUCTION NOTES:**
- REMOVE EXISTING PAVEMENT AND CONSTRUCT NEW 150mm REINFORCED CONCRETE PAVEMENT *c/w* ASPHALTIC OVERLAY (55mm AVG. THICKNESS)
 - CONSTRUCT NEW CONCRETE BARRIER CURB (100mm REVEAL HT. SEPARATE)
 - CONSTRUCT NEW CONCRETE BARRIER CURB (100mm REVEAL HT. DOWELED)
 - RENEW NEW 100mm CONCRETE SIDEWALK
 - ADJUST EXISTING CATCH BASIN / MANHOLE TO GRADE
 - CONSTRUCT NEW ASPHALTIC PAVEMENT TYPE 1A (95mm AVG. THICKNESS)
 - ADJUST EXISTING WATER VALVE TO GRADE
 - CONSTRUCT NEW CURB RAMP (10-12mm HT. MONOLITHIC)
 - CONSTRUCT NEW MODIFIED BARRIER CURB (150mm HT. DOWELED)
 - REMOVE EXIST FRAME AND COVER AND PLACE NEW FRAME AND COVER (AP-007 / AP-008)
 - PLACE NEW DETECTIBLE WARNING TILE

**ENGINEERS
GEOSCIENTISTS
MANITOBA**
Certificate of Authorization
AECOM Canada Ltd.
No. 4671 Date: _____

METRIC
WHOLE NUMBERS INDICATE MILLIMETRES
DECIMALIZED NUMBERS INDICATE METRES

EXISTING	LEGEND - PLAN	PROPOSED	EXISTING	LEGEND - PLAN	PROPOSED	EXISTING	LEGEND - PROFILE	PROPOSED
150 mm W.M.	WATERMAIN	150 mm W.M.	HYDRO	M.T.S.	— x —	—	PROFILE	—
—	HYDRANT	—	—	CONCRETE	—	—	WEST GUTTER	—
—	VALVE	—	—	ASPHALT	—	—	EAST GUTTER	—
300mm L.D.S.	LAND DRAINAGE SEWER	300mm L.D.S.	—	PROPERTY LINE	—	—	W PROPERTY LINE	—
250mm W.W.S.	WASTEWATER SEWER	250mm W.W.S.	—	SURVEY BAR	—	—	E PROPERTY LINE	—
—	MANHOLE	—	—	ELEVATION	(235.750)	—	—	—
—	CATCH BASIN	—	—	TREE	—	—	—	—
—	CATCH PIT	—	—	SIDEWALK RAMP	—	—	—	—
—	JUNCTIONS	—	—	CONCRETE SIDEWALK	—	—	—	—
—	CULVERT	—	—	FENCE	—	—	—	—
—	GAS	—	—	—	—	—	—	—

LOCATION APPROVED UNDERGROUND STRUCTURES

SUPV. U/G STRUCTURES COMMITTEE DATE _____

NOTE:
LOCATION OF UNDERGROUND STRUCTURES AS SHOWN ARE BASED ON THE BEST INFORMATION AVAILABLE. BUT NO GUARANTEE IS GIVEN THAT ALL EXISTING UTILITIES ARE SHOWN OR THAT THE GIVEN LOCATIONS ARE EXACT. CONFIRMATION OF EXISTENCE AND EXACT LOCATION OF ALL SERVICES MUST BE OBTAINED FROM THE INDIVIDUAL UTILITIES BEFORE PROCEEDING WITH CONSTRUCTION.

B.M. 24 - S-W COR. TEMPLETON AVE. & TANNER ELEV. ST., TBLT. IN N. CONC. FOUNDATION NO. 318 TEMPLETON AVE., 2m W. & 0.2m BELOW BRICK OF N.E. COR. OF APARTMENT BLOCK. ELEVATION: 231.002

NO.	REVISIONS	DATE	BY
0	ISSUED FOR TENDER	04/24/20	BC
A	ISSUED FOR 100% REVIEW	03/17/20	BC

AECOM

DESIGNED BY	JT	CHECKED BY	BC/RC
DRAWN BY	DA	APPROVED BY	
HOR. SCALE:	1:250	ORIGINAL SIGNED BY:	
VERTICAL:	1:10	DATE	02/14/20

ENGINEER'S SEAL
PROVINCE OF MANITOBA
R. T. CUNNINGHAM
Member 24711
REGISTERED PROFESSIONAL ENGINEER

THE CITY OF WINNIPEG
PUBLIC WORKS DEPARTMENT
ENGINEERING DIVISION

2020 RESIDENTIAL STREET RENEWAL PROGRAM

TANNER ST. - END SOUTH OF TEMPLETON TO MARGARET AVE.
ASPHALT PAVEMENT REHABILITATION
STATION 0+094 TO STATION 0+210

CITY DRAWING NUMBER
SHEET 01 OF 16

CONSULTANT DRAWING NO. CT-01