

NOTE: CHAINAGES SHOWN ARE ALONG W.P. OF PANET RD

NOTE: NOTIFY CONSTRUCTION SERVICES COORDINATOR (CITY OF WINNIPEG) AT 986-4289, 48 HOURS PRIOR TO EXCAVATION NEAR FEEDERMAIN

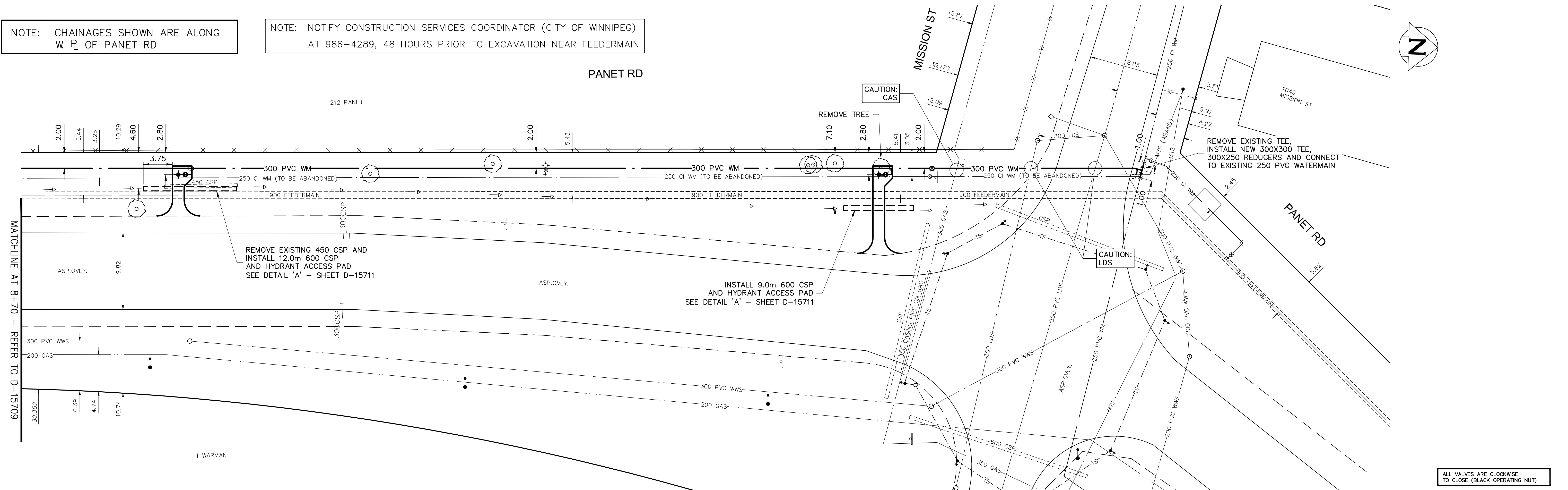

ALL VALVES ARE CLOCKWISE TO CLOSE (BLACK OPERATING NUT)

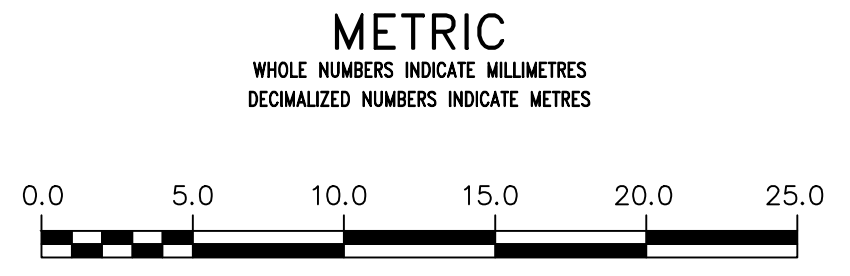

ENGINEERS GEOSCIENTISTS MANITOBA
 Certificate of Authorization
 AECOM Canada Ltd.
 No. 4671 Date *April 15/20*

REFER TO DRAWING D-15700 FOR CONSTRUCTION NOTES

WARNING
 IF POWER EQUIPMENT OR EXPLOSIVES ARE TO BE USED FOR EXCAVATION ON THIS PROJECT THE CONTRACTOR MUST:
 1) NOTIFY THE GAS COMPANY OF THE PROPOSED LOCATION OF EXCAVATION.
 2) TAKE PRECAUTION TO AVOID DAMAGE TO GAS COMPANY INSTALLATIONS.
 SEE PROVINCIAL REGULATION 210/72 FOR DETAILS

LOCATION APPROVED UNDERGROUND STRUCTURES
 SUPV. U/G STRUCTURES COMMITTEE DATE
 NOTE:
 LOCATION OF UNDERGROUND STRUCTURES AS SHOWN ARE BASED ON THE BEST INFORMATION AVAILABLE BUT NO GUARANTEE IS GIVEN THAT ALL EXISTING UTILITIES ARE SHOWN OR THAT THE GIVEN LOCATIONS ARE EXACT. CONFIRMATION OF EXISTENCE AND EXACT LOCATION OF ALL SERVICES MUST BE OBTAINED FROM THE INDIVIDUAL UTILITIES BEFORE PROCEEDING WITH CONSTRUCTION.

B.M. 33-014 ELEV. 231.421 m	360 (654360) - S.W. Cor. Mission St. & Panet Rd., Tabl. in 7.6 m Conc. pile, beneath Valve Box, 12.7 mm I.B. on N. side of pile for location purposes only.
DESIGNED BY	JP
CHECKED BY	GSK
DRAWN BY	JP
APPROVED BY	
RELEASED FOR CONSTRUCTION	
DATE	2020/04/03
DATE	2020 04 03

AECOM

DESIGNED BY: JP
 CHECKED BY: GSK
 DRAWN BY: JP
 APPROVED BY:
 RELEASED FOR CONSTRUCTION:
 DATE: 2020/04/03

ENGINEER'S SEAL
 PROVINCE OF MANITOBA
 K.W. FITCHETT
 REGISTERED PROFESSIONAL ENGINEER
 CONSULTANT DRAWING NUMBER
 C-0010

THE CITY OF WINNIPEG
 WATER AND WASTE DEPARTMENT
 ENGINEERING DIVISION

2020 WATER MAIN RENEWALS
 CONTRACT 6

PANET ROAD
 FROM 119m S OF MISSION STREET TO MISSION STREET

SHEET 12 OF 13
 CITY DRAWING NUMBER
 D-15710