

UNIVERSITY CRESCENT

CAUTION: WM

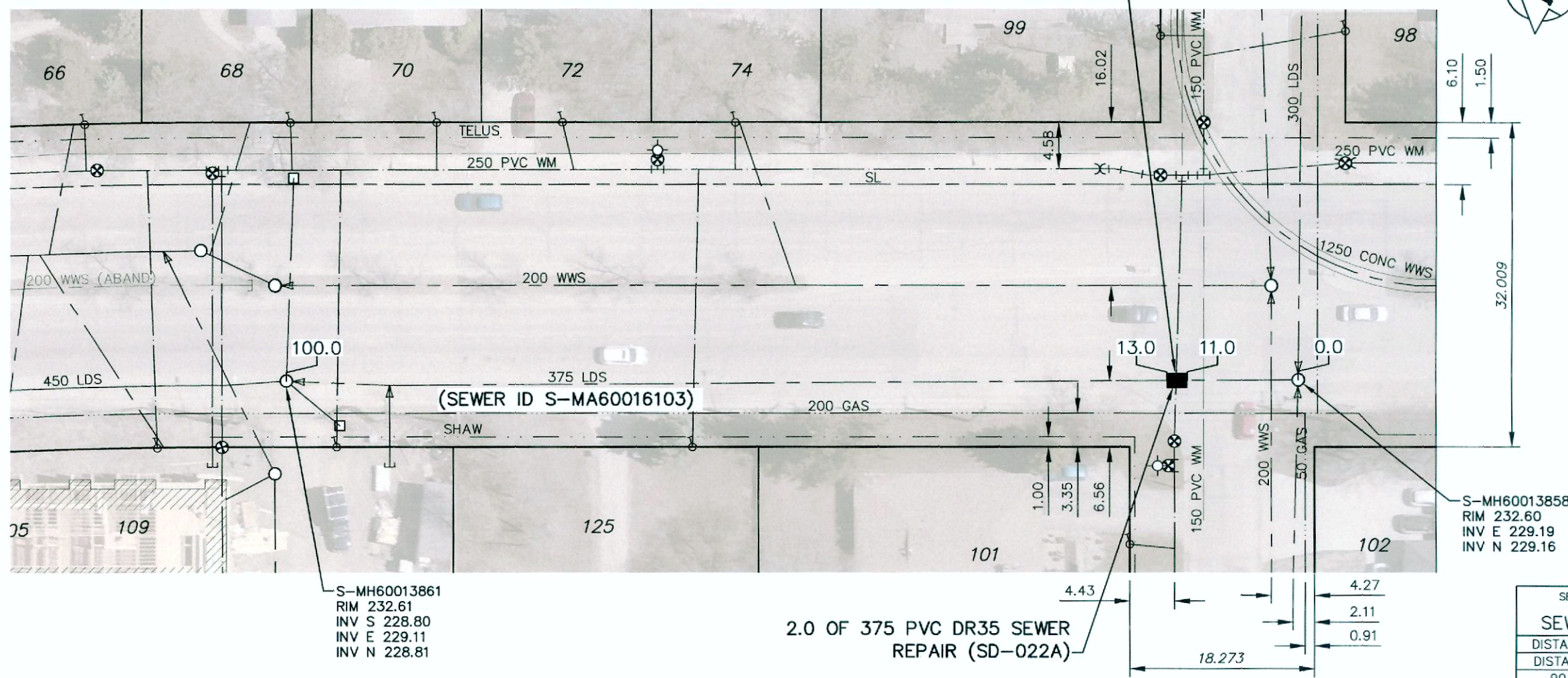

S-MH60013861
RIM 232.61
INV S 228.80
INV E 229.11
INV N 228.81

S-MH60013858
RIM 232.60
INV E 229.19
INV N 229.16

2.0 OF 375 PVC DR35 SEWER
REPAIR (SD-022A)

SEWER JUNCTION INFORMATION FROM SEWER VIDEO INSPECTION		
SEWER ID S-MA60016103		
DISTANCE FROM MH ID S-MH60013858		
DISTANCE	DIAMETER	CLOCK
90.0	150	10

FOR INDEX SEE
DWG D-12503

**ENGINEERS
GEOSCIENTISTS
MANITOBA**

Certificate of Authorization
KGS Group
No. 245

WARNING
IF POWER EQUIPMENT OR EXPLOSIVES ARE TO BE USED FOR EXCAVATION ON THIS PROJECT THE CONTRACTOR MUST:

- 1) NOTIFY THE GAS COMPANY OF THE PROPOSED LOCATION OF EXCAVATION.
- 2) TAKE PRECAUTION TO AVOID DAMAGE TO GAS COMPANY INSTALLATIONS.

SEE PROVINCIAL REGULATION 210/72 FOR DETAILS

PROPERTY LIMITS DELINEATION
DELINEATION OF PROPERTY LIMITS AS SHOWN ON THIS DWG DOES NOT REPRESENT A "LEGAL SURVEY". KGS GROUP MAKES NO REPRESENTATION OR WARRANTY AS TO THE ACCURACY OF PROPERTY LIMITS DELINEATED ON THIS DWG, NOR ON THE DIMENSIONAL ACCURACY OF DWG FEATURES RELATIVE TO THOSE PROPERTY LIMITS.

METRIC
WHOLE NUMBERS INDICATE MILLIMETRES
DECIMALIZED NUMBERS INDICATE METRES

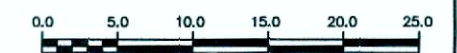

LOCATION APPROVED
UNDERGROUND STRUCTURES

SUPV. U/G STRUCTURES COMMITTEE	DATE

NOTE:
LOCATION OF UNDERGROUND STRUCTURES AS SHOWN ARE BASED ON THE BEST INFORMATION AVAILABLE BUT NO GUARANTEE IS GIVEN THAT ALL EXISTING UTILITIES ARE SHOWN OR THAT THE GIVEN LOCATIONS ARE EXACT. CONFIRMATION OF EXISTENCE AND EXACT LOCATION OF ALL SERVICES MUST BE OBTAINED FROM THE INDIVIDUAL UTILITIES BEFORE PROCEEDING WITH CONSTRUCTION.

B.M.	ELEV.

NO.	ISSUED FOR TENDER	DATE	BY
0	ISSUED FOR TENDER	20/04/08	MED

KGS GROUP

DESIGNED BY	MID	CHECKED BY	SM
DRAWN BY	GEL	APPROVED BY	RBO
SCALE:	HORIZONTAL 1:500	RELEASED FOR CONSTRUCTION	
	VERTICAL		

DATE 2020 04 06
DATE

ENGINEER'S SEAL

CONSULTANT DRAWING NUMBER
D-12526

THE CITY OF WINNIPEG
WATER AND WASTE DEPARTMENT
ENGINEERING DIVISION

2020 SEWER MAIN RENEWALS
BY EXTERNAL POINT REPAIR
UNIVERSITY CRESCENT
1ST MH NORTH OF THATCHER DRIVE TO
MH AT THATCHER DRIVE

SHEET 25 OF 29
CITY DRAWING NUMBER
D-12526