

PALLISER AVENUE (SOUTH LEG)

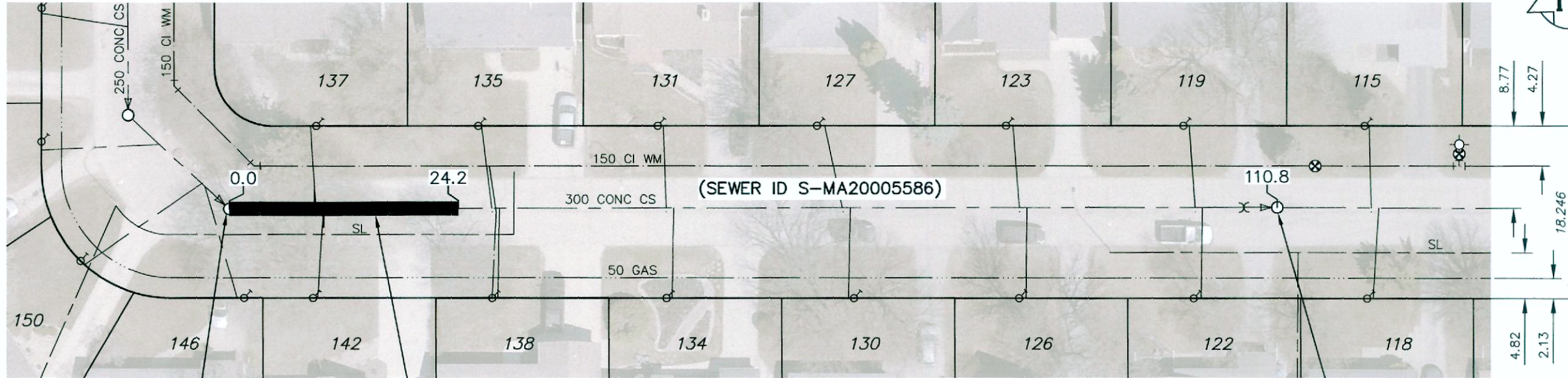

S-MH20005112
RIM 237.15
INV NW 233.80
INV E 233.80

24.2 OF 300 PVC DR35 SEWER REPAIR
(SD-022B) INCLUDING 2 SERVICE
CONNECTIONS

S-MH20005111
RIM 2336.72
INV W 233.43
INV E 234.22

DISTANCE FROM MH ID S-MH20005112		
DISTANCE	DIAMETER	CLOCK
9.0	150	10
10.0	150	2
27.6	150	11
28.6	150	2
46.2	150	10
47.1	150	2
64.8	150	10
65.7	150	2
83.9	150	10
84.2	150	2
102.0	150	10
102.4	150	2

WARNING

IF POWER EQUIPMENT OR EXPLOSIVES ARE TO BE USED FOR EXCAVATION ON THIS PROJECT THE CONTRACTOR MUST:

- 1) NOTIFY THE GAS COMPANY OF THE PROPOSED LOCATION OF EXCAVATION.
- 2) TAKE PRECAUTION TO AVOID DAMAGE TO GAS COMPANY INSTALLATIONS.

SEE PROVINCIAL REGULATION 210/72 FOR DETAILS

PROPERTY LIMITS DELINEATION

DELINEATION OF PROPERTY LIMITS AS SHOWN ON THIS DWG DOES NOT REPRESENT A "LEGAL SURVEY". KGS GROUP MAKES NO REPRESENTATION OR WARRANTY AS TO THE ACCURACY OF PROPERTY LIMITS DELINEATED ON THIS DWG, NOR ON THE DIMENSIONAL ACCURACY OF DWG FEATURES RELATIVE TO THOSE PROPERTY LIMITS.

ES ENGINEERS
GEOSCIENTISTS
MANITOBA

Certificate of Authorization

KGS Group

No. 245

FOR INDEX SEE
DWG D-12503

METRIC

WHOLE NUMBERS INDICATE MILLIMETRES
DECIMALIZED NUMBERS INDICATE METRES

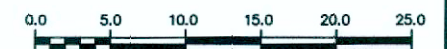

LOCATION APPROVED UNDERGROUND STRUCTURES

SUPV. U/G STRUCTURES COMMITTEE DATE

NOTE:

LOCATION OF UNDERGROUND STRUCTURES AS SHOWN ARE BASED ON THE BEST INFORMATION AVAILABLE BUT NO GUARANTEE IS GIVEN THAT ALL EXISTING UTILITIES ARE SHOWN OR THAT THE GIVEN LOCATIONS ARE EXACT. CONFIRMATION OF EXISTENCE AND EXACT LOCATION OF ALL SERVICES MUST BE OBTAINED FROM THE INDIVIDUAL UTILITIES BEFORE PROCEEDING WITH CONSTRUCTION.

B.M.
ELEV.

NO.	ISSUED FOR TENDER	DATE	BY
0	ISSUED FOR TENDER	20/04/08	MID

KGS
GROUP

DESIGNED BY	MID	CHECKED BY	JR
DRAWN BY	GEL	APPROVED BY	RBO
SCALE: HORIZONTAL	1:500	RELEASED FOR CONSTRUCTION	
VERTICAL			
DATE	2020 04 06	DATE	

ENGINEER'S SEAL



CONSULTANT DRAWING NUMBER

D-12517



THE CITY OF WINNIPEG
WATER AND WASTE DEPARTMENT
ENGINEERING DIVISION

2020 SEWER MAIN RENEWALS
BY EXTERNAL POINT REPAIR
PALLIASER AVENUE (SOUTH LEG)
2ND MH WEST OF MOUNT ROYAL ROAD TO
1ST MH WEST OF MOUNT ROYAL ROAD

SHEET 16 OF 29

CITY DRAWING NUMBER

D-12517