

**LANARK STREET**

**72.7 OF 450 CS TO BE LINED  
S-MA60006752**

**LANARK ST**

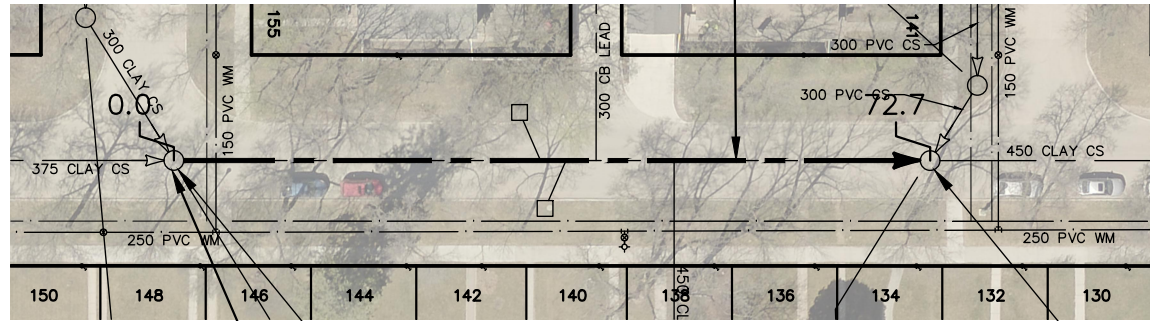

S-MH60006530  
RIM 233.18  
INV N 228.77  
INV S 229.74  
INV W 230.52

S-MH60005380  
RIM 233.21  
INV N 228.34  
INV S 228.32  
INV W 228.31

← KINGSWAY

**REPLACE TOP RISER**

SEWER JUNCTION INFORMATION FROM SEWER VIDEO INSPECTION		
SEWER ID S-MA60006752		
DISTANCE FROM MH ID S-MH60006530		
DISTANCE	DIAMETER	CLOCK
4.5	150	2
8.0	150	1
14.6	150	1
22.6	150	10
23.4	150	1
33.6	150	1
37.1	250	1
38.1	250	11
39.6	150	11
43.3	150	1
53.2	150	2
63.2	150	1
68.1	150	11

**WARNING**

IF POWER EQUIPMENT OR EXPLOSIVES ARE TO BE USED FOR EXCAVATION ON THIS PROJECT THE CONTRACTOR MUST:

- 1) NOTIFY THE GAS COMPANY OF THE PROPOSED LOCATION OF EXCAVATION.
- 2) TAKE PRECAUTION TO AVOID DAMAGE TO GAS COMPANY INSTALLATIONS.

SEE PROVINCIAL REGULATION 210/72 FOR DETAILS

**FOR INDEX SEE  
12443**

**METRIC**

WHOLE NUMBERS INDICATE MILLIMETRES  
DECIMALIZED NUMBERS INDICATE METRES



**LOCATION APPROVED  
UNDERGROUND STRUCTURES**

SUPV. U/G STRUCTURES COMMITTEE      DATE

NOTE:  
LOCATION OF UNDERGROUND STRUCTURES AS SHOWN ARE BASED ON THE BEST INFORMATION AVAILABLE BUT NO GUARANTEE IS GIVEN THAT ALL EXISTING UTILITIES ARE SHOWN OR THAT THE GIVEN LOCATIONS ARE EXACT. CONFIRMATION OF EXISTENCE AND EXACT LOCATION OF ALL SERVICES MUST BE OBTAINED FROM THE INDIVIDUAL UTILITIES BEFORE PROCEEDING WITH CONSTRUCTION.

B.M. ELEV.			
NO.	REVISIONS	DATE	BY

DESIGNED BY	SC	CHECKED BY	SC
DRAWN BY	RS	APPROVED BY	KZ
SCALE:		RELEASED FOR CONSTRUCTION	
HORIZONTAL	1:750	K. ZUREK	
VERTICAL			
DATE	2020 04 23	DATE	2020-04-22

ENGINEER'S SEAL

**ORIGINAL  
SIGNED BY  
S.R.J.  
COURNOYER  
2020/04/17**

CONSULTANT DRAWING NUMBER  
-



**THE CITY OF WINNIPEG**  
WATER AND WASTE DEPARTMENT  
ENGINEERING DIVISION

**2020 SEWER MAIN RENEWALS  
BY CIPP LINING  
LANARK STREET  
2ND MH S OF KINGSWAY TO  
3RD MH S OF KINGSWAY**

SHEET **27** OF **60**  
CITY DRAWING NUMBER  
**12468**