

# GIRTON BOULEVARD

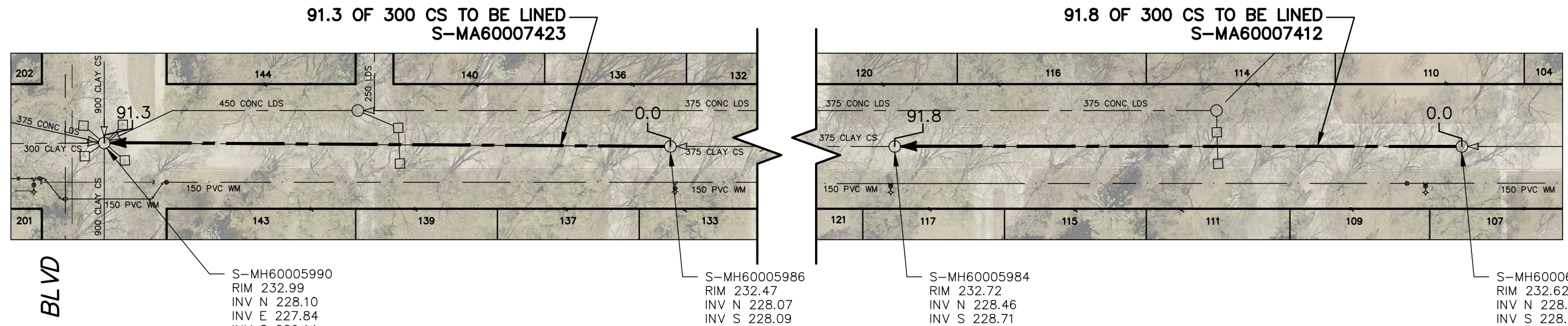

NANTON BLVD

S-MH60005990  
RIM 232.99  
INV N 228.10  
INV E 227.84  
INV S 229.14  
INV S 231.43  
INV W 227.84  
INV N 230.55

S-MH60005986  
RIM 232.47  
INV N 228.07  
INV S 228.09

S-MH60005984  
RIM 232.72  
INV N 228.46  
INV S 228.71

S-MH60006002  
RIM 232.62  
INV N 228.68  
INV S 228.71

SEWER JUNCTION INFORMATION FROM  
SEWER VIDEO INSPECTION  
SEWER ID S-MA60007423

DISTANCE FROM MH ID S-MH60005986

DISTANCE	DIAMETER	CLOCK
2.3	150	10
5.6	150	1
14.2	150	10
33.7	150	2
41.6	150	11
47.1	150	10
48.3	150	2
50.9	150	1
56.4	150	10
66.7	150	2

SEWER JUNCTION INFORMATION FROM  
SEWER VIDEO INSPECTION  
SEWER ID S-MA60007412

DISTANCE FROM MH ID S-MH60006002

DISTANCE	DIAMETER	CLOCK
2.2	150	2
3.0	150	10
18.0	150	10
33.5	150	2
39.7	150	9
40.2	150	2
48.2	150	10
51.9	150	1
62.2	150	10
74.9	150	2
78.9	150	10
79.5	150	2
86.0	150	10

WELLINGTON CRES →

**WARNING**

IF POWER EQUIPMENT OR EXPLOSIVES ARE TO BE USED FOR EXCAVATION ON THIS PROJECT THE CONTRACTOR MUST:

- 1) NOTIFY THE GAS COMPANY OF THE PROPOSED LOCATION OF EXCAVATION.
- 2) TAKE PRECAUTION TO AVOID DAMAGE TO GAS COMPANY INSTALLATIONS.

SEE PROVINCIAL REGULATION 210/72 FOR DETAILS

FOR INDEX SEE  
12443

**METRIC**

WHOLE NUMBERS INDICATE MILLIMETRES  
DECIMALIZED NUMBERS INDICATE METRES

LOCATION APPROVED  
UNDERGROUND STRUCTURES

SUPV. U/G STRUCTURES COMMITTEE \_\_\_\_\_ DATE \_\_\_\_\_

NOTE:  
LOCATION OF UNDERGROUND STRUCTURES AS SHOWN ARE BASED ON THE BEST INFORMATION AVAILABLE BUT NO GUARANTEE IS GIVEN THAT ALL EXISTING UTILITIES ARE SHOWN OR THAT THE GIVEN LOCATIONS ARE EXACT. CONFIRMATION OF EXISTENCE AND EXACT LOCATION OF ALL SERVICES MUST BE OBTAINED FROM THE INDIVIDUAL UTILITIES BEFORE PROCEEDING WITH CONSTRUCTION.

NO.	REVISIONS	DATE	BY

DESIGNED BY	SC	CHECKED BY	SC
DRAWN BY	RS	APPROVED BY	KZ
SCALE:		RELEASED FOR CONSTRUCTION	
HORIZONTAL	1:750	<b>K. ZUREK</b>	
VERTICAL		DATE	2020-04-22
DATE	2020 04 23		

ENGINEER'S SEAL

ORIGINAL  
SIGNED BY  
**S.R.J. COURNOYER**  
2020/04/17

CONSULTANT DRAWING NUMBER \_\_\_\_\_

**THE CITY OF WINNIPEG**  
WATER AND WASTE DEPARTMENT  
ENGINEERING DIVISION

2020 SEWER MAIN RENEWALS  
BY CIPP LINING  
**GIRTON BOULEVARD**  
1ST MH S OF WELLINGTON CRESCENT TO  
MH AT NANTON BOULEVARD

SHEET **23** OF **60**  
CITY DRAWING NUMBER  
**12464**