

LINE TABLE: WATT ST ALIGNMENT

LINE #	LENGTH	START STATION	END STATION	START POINT	END POINT
L1	37.99	0+55.15	0+93.14	N 5530471.408, E 636183.347	N 5530505.618, E 636199.866
L2	281.87	0+93.14	3+75.01	N 5530505.618, E 636199.866	N 5530759.444, E 636322.424
L3	136.70	3+75.01	5+11.71	N 5530759.444, E 636322.424	N 5530882.188, E 636382.605
L4	90.54	5+11.71	6+02.26	N 5530882.188, E 636382.605	N 5530963.037, E 636423.369
L5	113.92	6+02.26	7+16.17	N 5530963.037, E 636423.369	N 5531065.618, E 636472.909
L6	80.82	7+16.17	7+96.99	N 5531065.618, E 636472.909	N 5531137.353, E 636510.143
L7	146.58	7+96.99	9+43.58	N 5531137.353, E 636510.143	N 5531269.341, E 636573.908

FOR CONTINUATION SEE  
DWG 19M-00985-00-07

MATCHLINE 5+05  
SEE DWG BELOW

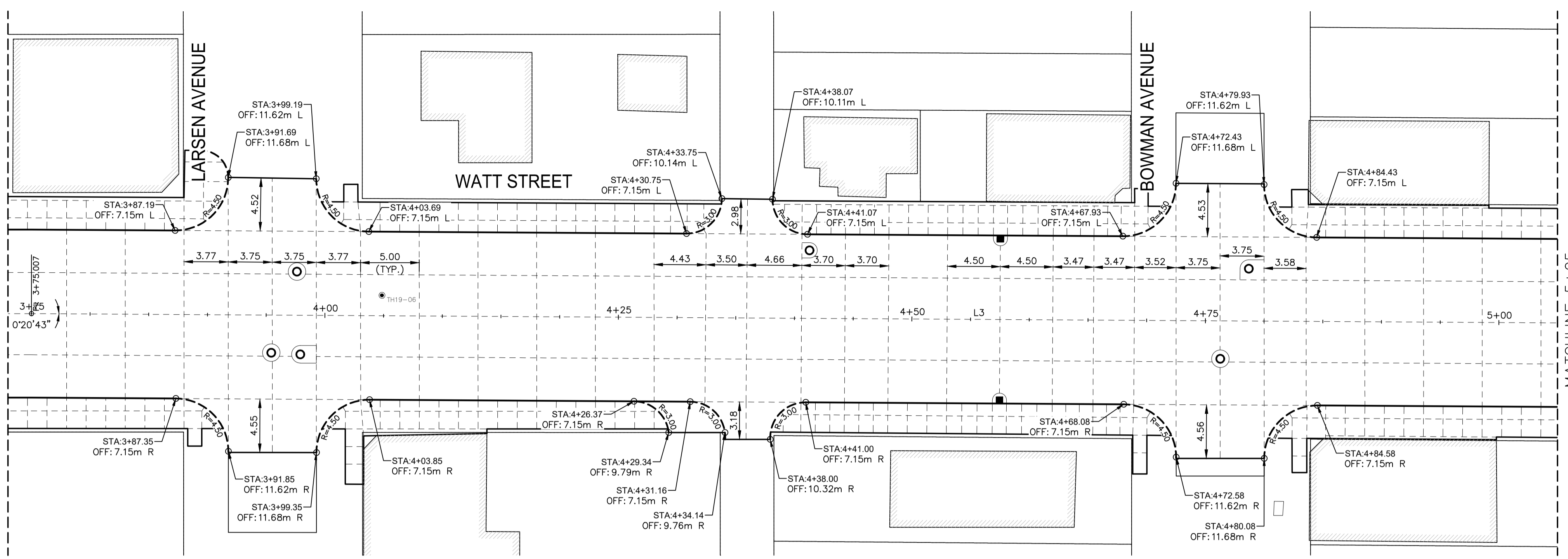

MATCHLINE 5+05  
SEE DWG ABOVE

MATCHLINE 6+65  
FOR CONTINUATION SEE  
DWG 19M-00985-00-09

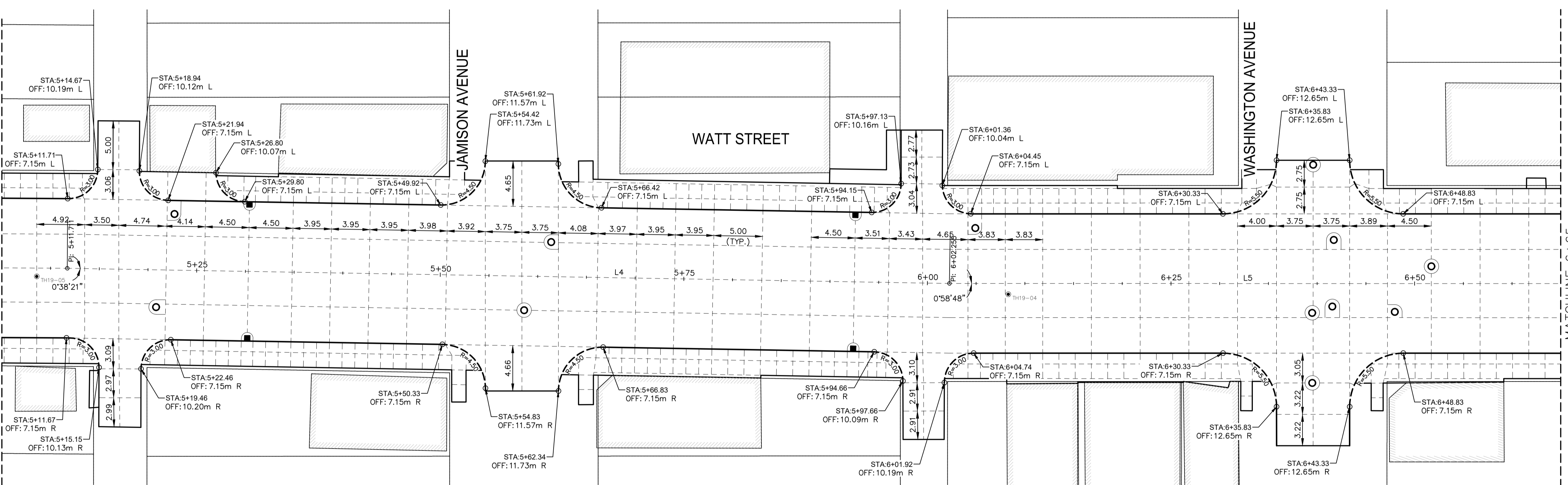

EXISTING	PROPOSED	EXISTING	LEGEND-PLAN	PROPOSED	EXISTING	LEGEND-PROFILE	PROPOSED
---	---	⊕	WATER MAIN	⊕	---	---	IRON BAR
---	---	⊕	LAND DRAINAGE SEWER	⊕	---	---	HYDRO POLE & LIGHT STANDARD
---	---	⊕	WASTE WATER SEWER	⊕	---	---	LIGHT STANDARD OR TRAFFIC SIGNAL
---	---	⊕	HYDRO	⊕	---	---	HYDRO POLE
---	---	⊕	BELL/MTS	⊕	---	---	CURB RAMP
---	---	⊕	GAS	⊕	---	---	DETECTABLE WARNING SURFACE TILE
---	---	⊕	SIGNALS	⊕	---	---	EDGE OF SIDEWALK
○	○	⊕	MANHOLE	⊕	---	---	FENCE
□	□	⊕	CATCH BASIN	⊕	---	---	PROPERTY LINE
△	△	⊕	CURB INLET	⊕	---	---	EDGE OF ASPHALT
⊕	⊕	⊕	UTILITIES ADJUSTED	⊕	---	---	EDGE OF CONCRETE
⊕	⊕	⊕	PLUG	⊕	---	---	MODIFIED BARRIER CURB
⊕	⊕	⊕	HYDRANT	⊕	---	---	BARRIER CURB
⊕	⊕	⊕	VALVE	⊕	---	---	SAFETY CURB
⊕	⊕	⊕	CURB STOP	⊕	---	---	JOINT
---	---	---	GROUND GRADE	---	---	---	WEST PROPERTY LINE
(231.00)	(231.00)	---	PAVEMENT GRADE	---	---	---	EAST PROPERTY LINE
---	---	---	ANCHOR	---	---	---	WEST SIDEWALK
#111	---	---	CIVIC ADDRESS	---	---	---	EAST SIDEWALK
---	---	---	LEGEND-PLAN	---	---	---	ROADWAY CENTRELINE
---	---	---	PROPOSED	---	---	---	WEST GUTTER
---	---	---	EXISTING	---	---	---	EAST GUTTER
---	---	---	PROPOSED	---	---	---	LEGEND-PROFILE
---	---	---	EXISTING	---	---	---	PROPOSED

LOCATIONS APPROVED UNDERGROUND STRUCTURES

SIGNED BY: \_\_\_\_\_ DATE: \_\_\_\_\_

SUPV U/G STRUCTURES

LOCATION OF UNDERGROUND STRUCTURES AS SHOWN ARE BASED ON THE BEST INFORMATION AVAILABLE BUT NO GUARANTEE IS GIVEN THAT ALL EXISTING UTILITIES ARE SHOWN OR THAT THE GIVEN LOCATIONS ARE EXACT CONFIRMATION OF EXISTENCE AND EXACT LOCATION OF ALL SERVICES MUST BE OBTAINED FROM THE INDIVIDUAL UTILITIES BEFORE PROCEEDING

G.B.M.	ELEV.	DESCRIPTION	DATE	BY
H	-	-	-	-
G	-	-	-	-
F	-	-	-	-
E	-	-	-	-
D	-	-	-	-
C	-	-	-	-
B	-	-	-	-
A	-	-	-	-
NO.	REVISIONS	DATE	BY	

WSP Canada Group Limited  
Suite 111 - 93 Lombard Ave  
Winnipeg, MB R3B 3B1  
t. 204.943.3178  
f. 204.943.4948  
www.wsp.com

**PRELIMINARY**  
**NOT FOR CONSTRUCTION**

**ENGINEERS GEOSCIENTISTS MANITOBA**  
Certificate of Authorization  
**WSP Canada Group Limited**  
No. 6657

**THE CITY OF WINNIPEG**  
PUBLIC WORKS DEPARTMENT  
ENGINEERING SERVICES DIVISION

**2020 WATT STREET PAVEMENT RENEWAL**  
WATT STREET  
CHALMERS AVENUE TO 40M S OF MUNROE AVENUE

CITY DRAWING NUMBER: P-3521-02  
SHEET 08 OF 18  
TENDER NO. 147-2020

CONSULTANT ACAD DWG. NO. 19M-00985-00-08

2019-SEPT-18

**METRIC**  
WHOLE NUMBERS INDICATE MILLIMETRES  
DECIMALIZED NUMBERS INDICATE METRES