

NOTE: CHAINAGES SHOWN ARE ALONG CENTRE LINE OF ROW

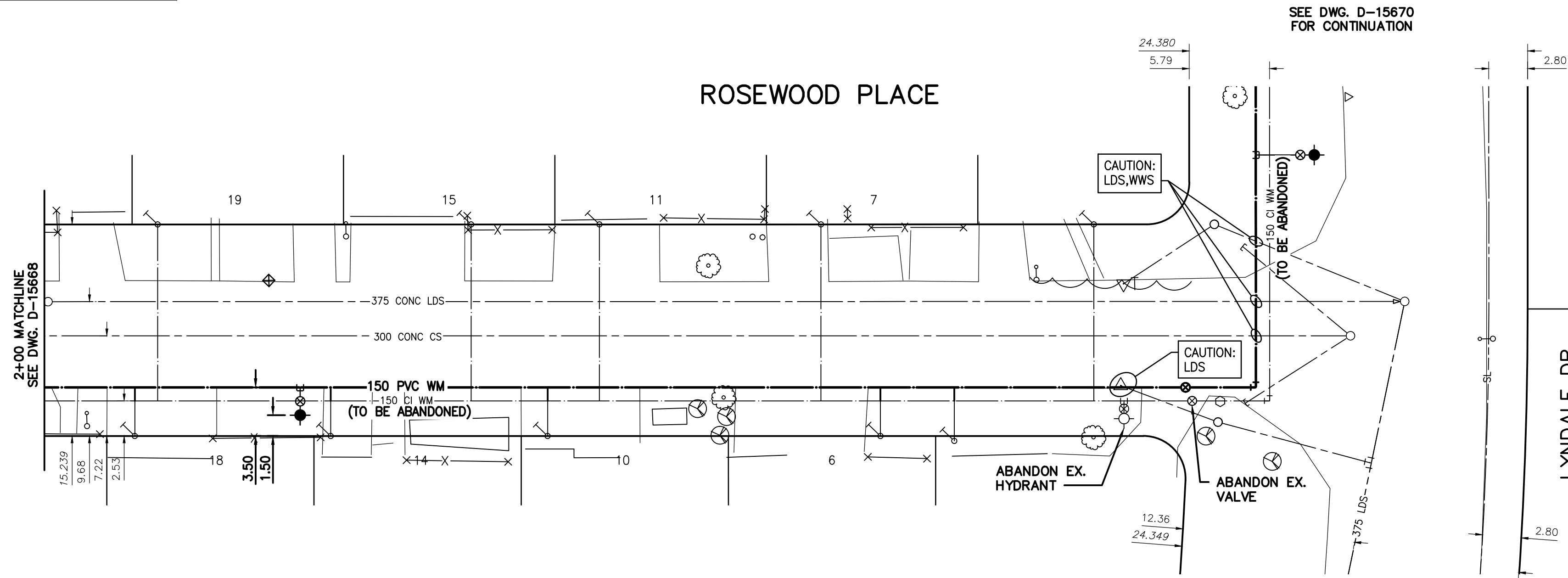

WATER SERVICE INFORMATION

ADDRESS	PIPE SIZE & MATERIAL (STREET)	PIPE SIZE & MATERIAL (PROP.)	SHORT & LONG MEASUREMENT	CORP. LOCATION	REMARKS
7 ROSEWOOD PL	-	20	26.00 LR CR OF HSE	-	RECONNECT SERVICE
RESIDENTIAL	-	CU	35.00 NSPL #7 N/LYNDALE	-	RECONNECT SERVICE
11 ROSEWOOD PL	-	20	2.00 S N/BL	-	RECONNECT SERVICE
RESIDENTIAL	-	CU	2.50 S N/PL	-	RECONNECT SERVICE
15 ROSEWOOD PL	-	12	6.00 LR CR OF GARAGE	-	RECONNECT SERVICE
RESIDENTIAL	-	LEAD	141.00 NSPL #7 N/LYNDALE	-	RECONNECT SERVICE
19 ROSEWOOD PL	-	20	1.00 RL CR OF HSE	-	RECONNECT SERVICE
RESIDENTIAL	-	CU	192.00 NSPL #7 N/LYNDALE	-	RECONNECT SERVICE
6 LARCHWOOD PL	-	20	3.00 RL CR OF HSE	-	RECONNECT SERVICE
RESIDENTIAL	-	CU	43.00 NSPL OF 6 LARCHWOOD	-	RECONNECT SERVICE
10 LARCHWOOD PL	-	20	2.00 RR CR OF GARAGE	-	RECONNECT SERVICE
RESIDENTIAL	-	CU	96.00 NSPL OF 6 LARCHWOOD	-	RECONNECT SERVICE
14 LARCHWOOD PL	-	20	2.00 RR CR /HSE UNDER DR/WY	-	RECONNECT SERVICE
RESIDENTIAL	-	CU	149.00 NSPL OF 6 LARCHWOOD	-	RECONNECT SERVICE
18 LARCHWOOD PL	-	20	0.30 L/R	-	RECONNECT SERVICE
RESIDENTIAL	-	CU	-	-	RECONNECT SERVICE
375 LYNDALE DR	-	20	21.00 N OF S HL	-	RECONNECT SERVICE
RESIDENTIAL	-	LEAD	-	-	RECONNECT SERVICE
355 LYNDALE DR	-	20	R/H/L	-	RECONNECT SERVICE
RESIDENTIAL	-	CU	3.96 CURB	-	RECONNECT SERVICE

\* SERVICES TO BE RENEWED TO R

NOTE: VALVES TO BE INSTALLED CLOCKWISE TO CLOSE

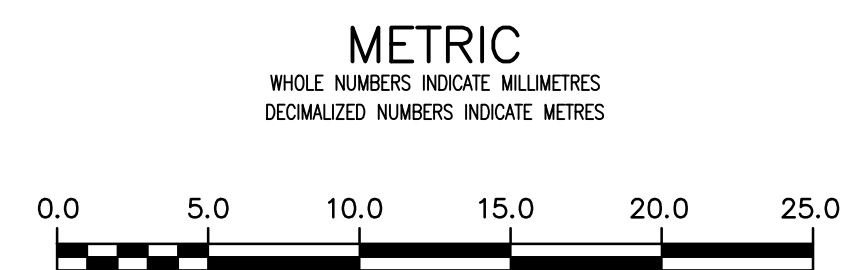

LOCATION APPROVED UNDERGROUND STRUCTURES

SUPV. U/G STRUCTURES COMMITTEE DATE

NOTE: LOCATION OF UNDERGROUND STRUCTURES AS SHOWN ARE BASED ON THE BEST INFORMATION AVAILABLE BUT NO GUARANTEE IS GIVEN THAT ALL EXISTING UTILITIES ARE SHOWN OR THAT THE GIVEN LOCATIONS ARE EXACT. CONFIRMATION OF EXISTENCE AND EXACT LOCATION OF ALL SERVICES MUST BE OBTAINED FROM THE INDIVIDUAL UTILITIES BEFORE PROCEEDING WITH CONSTRUCTION.

B.M. 85R416 S. side Lyndale Dr. @ Birchdale Av., Tblt. top of 0.05m dia. x 2.4m iron pipe, 7.3 m S. of C.L. asphalt Pav't. of Lyndale Dr. produced from the E. & 3.7m E. of C.L. Conc. Pav't. of Birchdale Av.

NO.	REVISIONS	DATE	BY
02	ISSUED FOR TENDER	2020.04.01	RS
01	ISSUED FOR 60% REVIEW	2020.03.09	RS



DESIGNED BY	RS	CHECKED BY	RS
DRAWN BY	SC	APPROVED BY	RS
SCALE:	HORIZONTAL 1:250 VERTICAL 1:50		
DATE	2019.01.15	RELEASED FOR CONSTRUCTION	DATE

ENGINEER'S SEAL

ORIGINAL SEALED BY R.M. SHERLOCK P. ENG. 2020/04/01

CONSULTANT DRAWING NUMBER C-210

**THE CITY OF WINNIPEG**  
WATER AND WASTE DEPARTMENT  
ENGINEERING DIVISION

2020 WATERMAIN RENEWALS  
CONTRACT 4  
ROSEWOOD PLACE  
STA. 2+00 TO LYNDALE DR

SHEET 12 OF 22  
CITY DRAWING NUMBER D-15669