

NOTE: CHAINAGES SHOWN ARE ALONG CENTRE LINE OF ROW

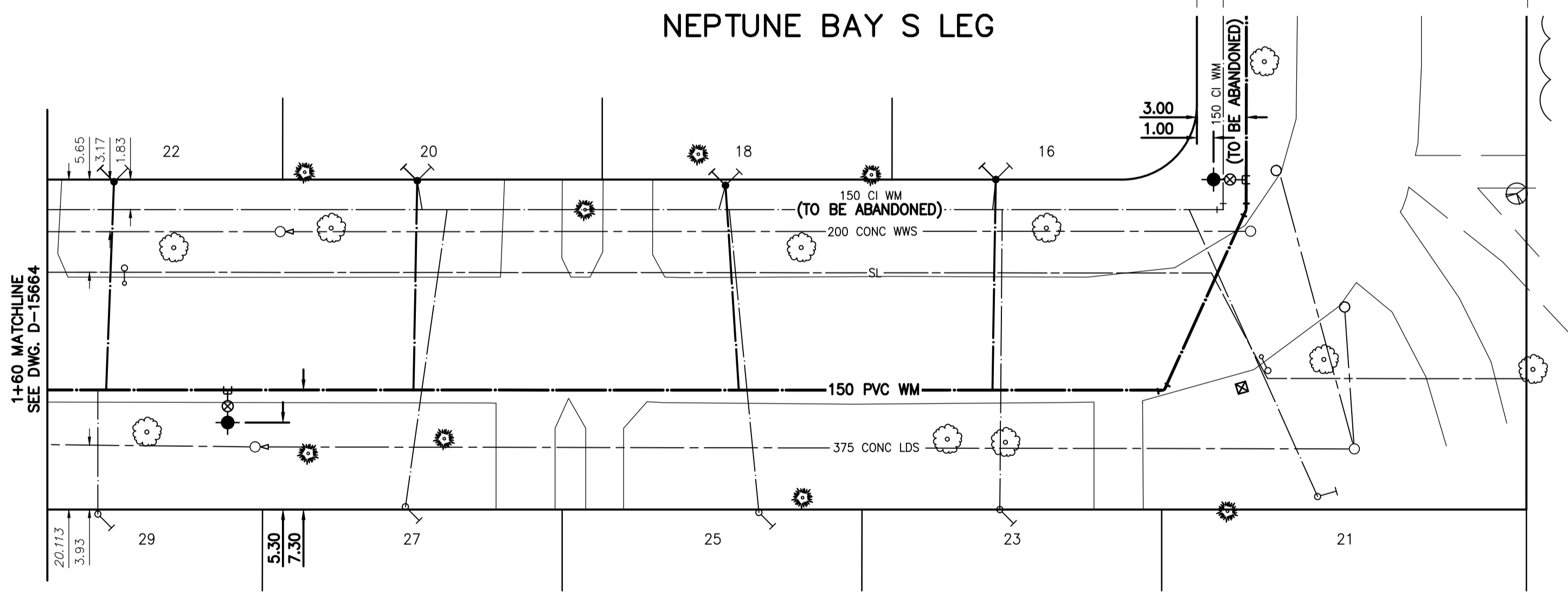

SEE DWG. D-15666 FOR CONTINUATION

WATER SERVICE INFORMATION

ADDRESS	PIPE SIZE & MATERIAL (STREET)	PIPE SIZE & MATERIAL (PROP.)	SHORT & LONG MEASUREMENT	CORP. LOCATION	REMARKS
* 16 NEPTUNE BAY RESIDENTIAL	-	-	21.20 E W P/L	373.00 E HYD	RENEW SERVICE
* 18 NEPTUNE BAY RESIDENTIAL	-	-	7.50 EWLL 101.30 EEL PLANET ST	318.20 E HYD	RENEW SERVICE
* 20 NEPTUNE BAY RESIDENTIAL	20 CU	-	8.20 EWLL 82.40 EEL PLANET ST	0.30 E OF S/C	RENEW SERVICE
* 21 NEPTUNE BAY RESIDENTIAL	-	-	9.50 EWLL 137.20 EEL PLANET ST	412.40 E HYD	RECONNECT SERVICE
* 22 NEPTUNE BAY RESIDENTIAL	-	-	8.30 EWLL 64.30 EEL PLANET ST	-	RENEW SERVICE
* 23 NEPTUNE BAY RESIDENTIAL	-	-	6.50 M E/WBL / 8.60 E/WLL	375.00 E HYD	RECONNECT SERVICE
* 25 NEPTUNE BAY RESIDENTIAL	-	-	6.30 WELL 103.20 EEL PLANET ST	320.40 E HYD	RECONNECT SERVICE
* 27 NEPTUNE BAY RESIDENTIAL	20 CU	-	8.70 EWLL 81.60 EEL PLANET ST	2.30 E OF S/C	RECONNECT SERVICE
* 29 NEPTUNE BAY RESIDENTIAL	-	-	8.20 EWLL 62.80 EEL PLANET ST	-	RECONNECT SERVICE

* SERVICES TO BE RENEWED TO P

NOTE: VALVES TO BE INSTALLED CLOCKWISE TO CLOSE

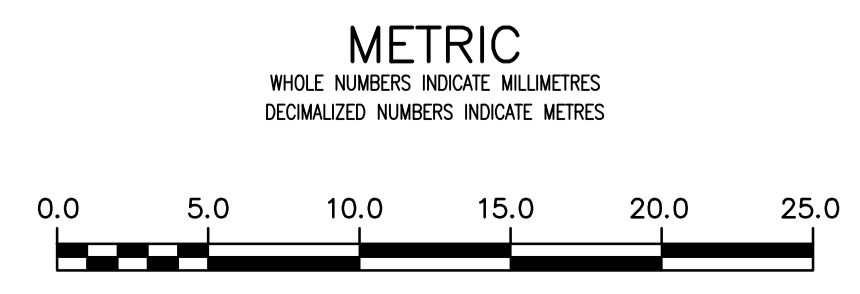

LOCATION APPROVED UNDERGROUND STRUCTURES

SUPV. U/G STRUCTURES COMMITTEE DATE

NOTE:
LOCATION OF UNDERGROUND STRUCTURES AS SHOWN ARE BASED ON THE BEST INFORMATION AVAILABLE BUT NO GUARANTEE IS GIVEN THAT ALL EXISTING UTILITIES ARE SHOWN OR THAT THE GIVEN LOCATIONS ARE EXACT. CONFIRMATION OF EXISTENCE AND EXACT LOCATION OF ALL SERVICES MUST BE OBTAINED FROM THE INDIVIDUAL UTILITIES BEFORE PROCEEDING WITH CONSTRUCTION.

B.M. 84R551 ELEV. 232.293	S.W. Cor. Parker Ave. & Planet St., Brass plug in 12.5 m Conc. pile, 2.6 m E. of W.L. Planet		
02	ISSUED FOR TENDER	2020.04.01	RS
01	ISSUED FOR 60% REVIEW	2020.03.09	RS
NO.	REVISIONS	DATE	BY



DESIGNED BY	RS	CHECKED BY	RS
DRAWN BY	SC	APPROVED BY	RS
SCALE:	HORIZONTAL 1:250	RELEASED FOR CONSTRUCTION	DATE
	VERTICAL 1:50		
DATE	2019.01.15		

ENGINEER'S SEAL

ORIGINAL SEALED BY
R.M. SHERLOCK
P. ENG.
2020/04/01

CONSULTANT DRAWING NUMBER
C-206

TENDER NUMBER: 119-2020

THE CITY OF WINNIPEG
WATER AND WASTE DEPARTMENT
ENGINEERING DIVISION

2020 WATERMAIN RENEWALS
CONTRACT 4
NEPTUNE BAY S LEG
STA. 1+60 TO
NEPTUNE BAY E LEG

SHEET 08 OF 22
CITY DRAWING NUMBER
D-15665

FILE PATH: V:\1112\active\111219000\0300_drawing\0302_sheet_files\02_civil\