

NOTE: CHAINAGES SHOWN ARE ALONG CENTRE LINE OF ROW

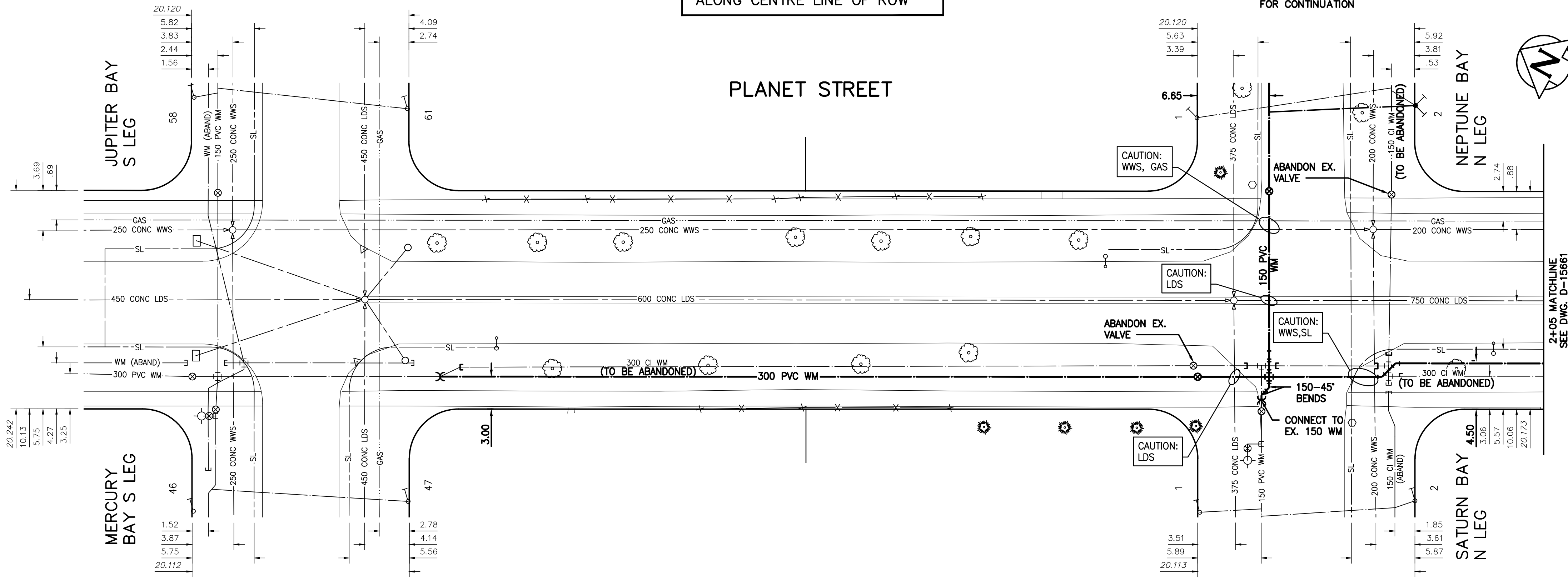

NOTE: VALVES TO BE INSTALLED CLOCKWISE TO CLOSE

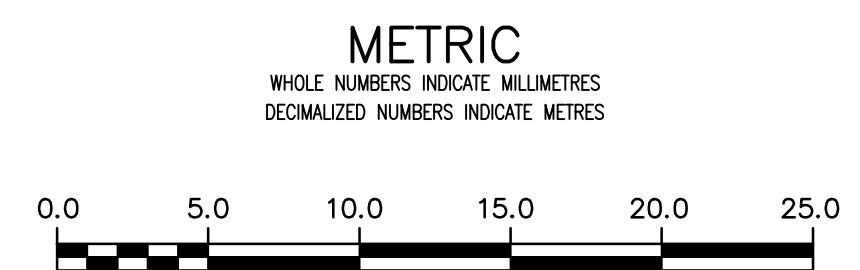

LOCATION APPROVED UNDERGROUND STRUCTURES		B.M. 84R551 S.W. Cor. Parker Ave. & Planet St., Brass ELEV. 232.293	
SUPV. U/G STRUCTURES COMMITTEE	DATE	plug in 12.5 m Conc. pile, 2.6 m E. of W.L. Planet	
NOTE: LOCATION OF UNDERGROUND STRUCTURES AS SHOWN ARE BASED ON THE BEST INFORMATION AVAILABLE BUT NO GUARANTEE IS GIVEN THAT ALL EXISTING UTILITIES ARE SHOWN OR THAT THE GIVEN LOCATIONS ARE EXACT. CONFIRMATION OF EXISTENCE AND EXACT LOCATION OF ALL SERVICES MUST BE OBTAINED FROM THE INDIVIDUAL UTILITIES BEFORE PROCEEDING WITH CONSTRUCTION.			
NO.	ISSUED FOR TENDER	2020.04.01	RS
01	ISSUED FOR 60% REVIEW	2020.03.09	RS
REVISIONS		DATE	BY

**Stantec**

DESIGNED BY	RS	CHECKED BY	RS
DRAWN BY	SC	APPROVED BY	RS
SCALE:		RELEASED FOR CONSTRUCTION	
HORIZONTAL	1: 250	DATE	
VERTICAL	1: 50	DATE	
DATE		2019.01.15	

PLOT DATE: 2020 04 01

ENGINEER'S SEAL

ORIGINAL SEALED BY  
R.M. SHERLOCK  
P. ENG.  
2020/04/01

CONSULTANT DRAWING NUMBER  
C-201

**THE CITY OF WINNIPEG**  
WATER AND WASTE DEPARTMENT  
ENGINEERING DIVISION

2020 WATERMAIN RENEWALS  
CONTRACT 4  
PLANET STREET  
JUPITER BAY S LEG TO  
NEPTUNE BAY N LEG

SHEET **03** OF **22**  
CITY DRAWING NUMBER  
D-15660

TENDER NUMBER: 119-2020  
FILE PATH: V:\1112\active\111219000\0300\_drawing\0302\_sheet\_files\02\_civil\