

**SEWER JUNCTION INFORMATION FROM SEWER VIDEO INSPECTION**

SEWER ID S-MA20011692		
DISTANCE FROM MH20010648		
DISTANCE	DIAMETER	CLOCK
2.9	200	9
16.6	150	10
24.7	200	3
25.9	200	3
26.8	200	10
35.8	150	3
60.9	200	9
96.4	200	3

**DUBLIN AVENUE**

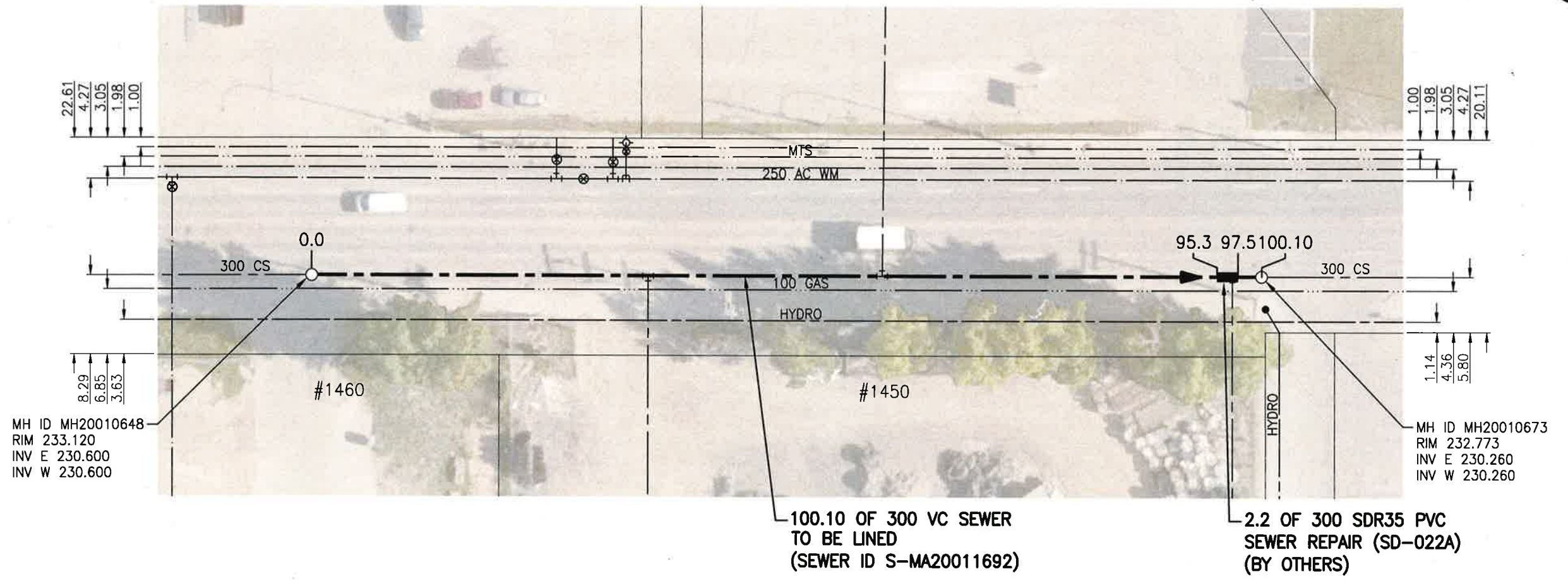

100.10 OF 300 VC SEWER TO BE LINED (SEWER ID S-MA20011692)

2.2 OF 300 SDR35 PVC SEWER REPAIR (SD-022A) (BY OTHERS)

**WARNING**

IF POWER EQUIPMENT OR EXPLOSIVES ARE TO BE USED FOR EXCAVATION ON THIS PROJECT THE CONTRACTOR MUST:  
 1) NOTIFY THE GAS COMPANY OF THE PROPOSED LOCATION OF EXCAVATION.  
 2) TAKE PRECAUTION TO AVOID DAMAGE TO GAS COMPANY INSTALLATIONS.  
 SEE PROVINCIAL REGULATION 140/92 FOR DETAILS

**EG ENGINEERS GEOSCIENTISTS MANITOBA**  
 Certificate of Authorization  
 Stantec Consulting Ltd.  
 No. 1301

**METRIC**  
 WHOLE NUMBERS INDICATE MILLIMETRES  
 DECIMALIZED NUMBERS INDICATE METRES  
 1:500   
 TENDER NO. 117-2020

LOCATION APPROVED UNDERGROUND STRUCTURES		B.M. ELEV.	
SUPV. U/G STRUCTURES COMMITTEE	DATE		
NOTE: LOCATION OF UNDERGROUND STRUCTURES AS SHOWN ARE BASED ON THE BEST INFORMATION AVAILABLE BUT NO GUARANTEE IS GIVEN THAT ALL EXISTING UTILITIES ARE SHOWN OR THAT THE GIVEN LOCATIONS ARE EXACT. CONFIRMATION OF EXISTENCE AND EXACT LOCATION OF ALL SERVICES MUST BE OBTAINED FROM THE INDIVIDUAL UTILITIES BEFORE PROCEEDING WITH CONSTRUCTION.			
2	ISSUED FOR TENDER	20.03.20	RS
1	ISSUED FOR REVIEW	20.03.09	RS
NO.	REVISIONS	DATE	BY

**Stantec**  
 905 Waverley Street, Winnipeg, Manitoba  
 Tel 204-489-5900 Fax 204-453-9012

DESIGNED BY	RS	CHECKED BY	RS
DRAWN BY	SC	APPROVED BY	RS
HOR. SCALE:	1:500	RELEASED FOR CONSTRUCTION	
VERTICAL:		DATE	11/17/20

ENGINEER'S SEAL: R.M. SHEPLOCK, MEMBER 24045, REGISTERED PROFESSIONAL ENGINEER, PROVINCE OF MANITOBA

CONSULTANT DRAWING NO. C-124

**THE CITY OF WINNIPEG WATER AND WASTE DEPARTMENT**

2019 SEWER RENEWALS BY CIPP LINING  
 CONTRACT 7  
**DUBLIN AVENUE**  
 2ND MH W OF NOTRE DAME AVE TO  
 1ST MH W OF NOTRE DAME AVE

2019 SEWER RENEWALS BY CIPP LINING  
 CONTRACT 7  
**DUBLIN AVENUE**  
 2ND MH W OF NOTRE DAME AVE TO  
 1ST MH W OF NOTRE DAME AVE

SHEET	OF
26	50
CAD FILE DRAWING NUMBER	
18920c-121-934.dwg	
CITY DRAWING NUMBER	
12417	

V:\112\active\11218920\0302\_drawing\0302\_sheet\_files\02\_civil\18920c-121-934.dwg