

- NOTES:**
- MILL ALL ASPHALT TO CONCRETE SURFACE.
  - THE CONTRACT ADMINISTRATOR TO MARK OUT ALL MILLING, PAVEMENT, CURB AND SIDEWALK TIE-IN LOCATIONS.
  - ALL MAINLINE CURBING TO BE RENEWED AS BARRIER CURB OR MONOLITHIC CONCRETE SPLASH STRIP (AS IDENTIFIED ON PLAN). CURB REVEAL TO BE 125mm UNLESS OTHERWISE NOTED.
  - ADJUST ALL WATER VALVES, MANHOLES, AND CATCH BASINS TO GRADE.
  - ADJUST ALL WATER SERVICE VALVES TO GRADE. EXISTING SERVICE VALVES ARE NOT SHOWN BUT ARE WITHIN THE SIDEWALK RENEWAL AREA.
  - THE CONTRACTOR IS RESPONSIBLE FOR ALL UTILITY LOCATES.
  - THE CONTRACTOR IS TO PROTECT ANY GEOMATIC MONUMENTS WITHIN THE PROJECT LIMITS. IF MONUMENTS CANNOT BE AVOIDED, THE CONTRACTOR IS RESPONSIBLE FOR NOTIFYING THE CITY OF WINNIPEG GEOMATICS AND LAND INFORMATION SERVICES BRANCH PRIOR TO ANY REMOVAL OR ADJUSTMENT TO THE PROPERTY BAR.
  - MATCH EXISTING RADII ON PRIVATE APPROACHES.
  - SIDEWALK WITH SEPARATE SPLASH STRIP AS SHOWN OR WHERE MINIMUM GRASSED BOULEVARD IS GREATER THAN 1.0m WIDE.
  - SIDEWALK COMPLETE WITH PAVING BANDS AS SHOWN OR WHERE BOULEVARD IS LESS THAN 1.0m WIDE.
  - AVERAGE ASPHALT THICKNESS TO BE 80mm.
  - GRADE BREAKS WITHIN PRIVATE APPROACHES TO BE DIRECTED BY THE CONTRACT ADMINISTRATOR TO ACCOMPLISH 2-4% ACROSS THE SIDEWALK.
  - PRIVATE APPROACH CONSTRUCTION TO BE 200mm EXPOSED REINFORCED CONCRETE WITH 75mm BASE COURSE, 225mm-50mm SUB-BASE AND NON-WOVEN GEOTEXTILE.
  - RENEW PRIVATE APPROACHES TO MATCH EXISTING SURFACE.

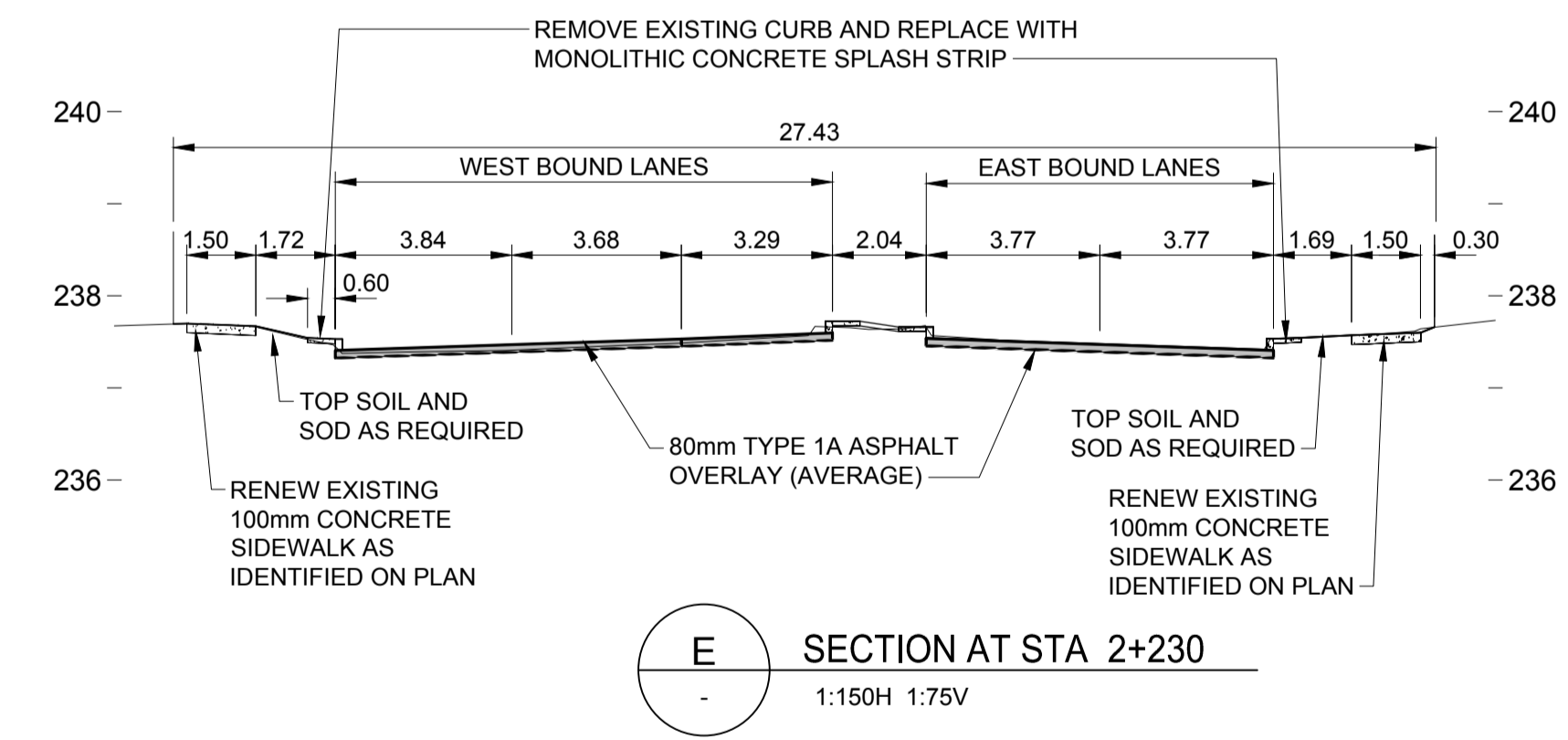
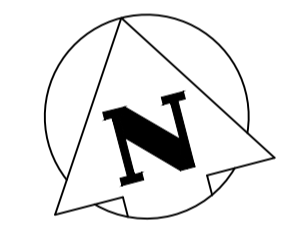
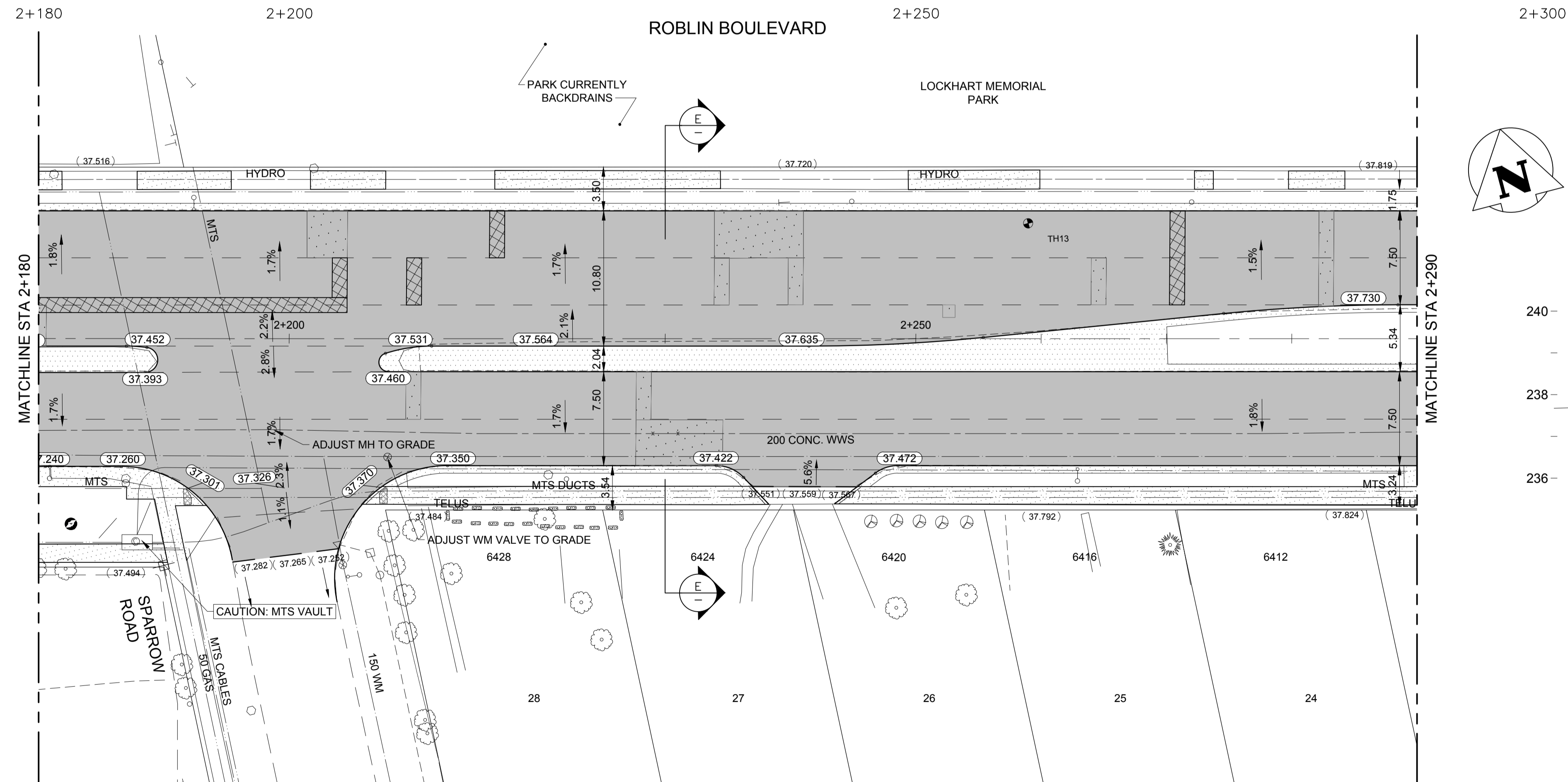

**METRIC**

WHOLE NUMBERS INDICATE MILLIMETRES  
DECIMALIZED NUMBERS INDICATE METRES

**WARNING**

IF POWER EQUIPMENT OR EXPLOSIVES ARE TO BE USED FOR EXCAVATION ON THIS PROJECT THE CONTRACTOR MUST:

- NOTIFY THE GAS COMPANY OF THE PROPOSED LOCATION OF EXCAVATION.
- TAKE PRECAUTION TO AVOID DAMAGE TO GAS COMPANY INSTALLATIONS.

SEE PROVINCIAL REGULATION 140/92 FOR DETAILS

150 WM	WATERMAIN	150 WM	GLASS GRID
HYDRANT	HYDRANT	GLASS GRID	CONCRETE
VALVE	VALVE	CONCRETE	ASPHALT
300 LDS	LAND DRAINAGE SEWER	300 LDS	ASPHALT MILL & FILL
250 WWS	WASTE WATER SEWER	250 WWS	STREET LIGHT
MANHOLE	MANHOLE	MANHOLE	HYDRO POLE
CATCH BASIN	CATCH BASIN	CATCH BASIN	SURVEY BAR
HYDRO	HYDRO	HYDRO	ELEVATION
GAS	GAS	GAS	SIDEWALK RAMP
TRANSIT STOP	TRANSIT STOP	TRANSIT STOP	
PROPERTY LINE	PROPERTY LINE	PROPERTY LINE	
EXISTING	LEGEND-PLAN	PROPOSED	EXISTING
	LEGEND-PLAN	PROPOSED	EXISTING
	LEGEND-PROFILE	PROPOSED	EXISTING
	LEGEND-PROFILE	PROPOSED	EXISTING

150 WM	WATERMAIN	150 WM	GLASS GRID
HYDRANT	HYDRANT	GLASS GRID	CONCRETE
VALVE	VALVE	CONCRETE	ASPHALT
300 LDS	LAND DRAINAGE SEWER	300 LDS	ASPHALT MILL & FILL
250 WWS	WASTE WATER SEWER	250 WWS	STREET LIGHT
MANHOLE	MANHOLE	MANHOLE	HYDRO POLE
CATCH BASIN	CATCH BASIN	CATCH BASIN	SURVEY BAR
HYDRO	HYDRO	HYDRO	ELEVATION
GAS	GAS	GAS	SIDEWALK RAMP
TRANSIT STOP	TRANSIT STOP	TRANSIT STOP	
PROPERTY LINE	PROPERTY LINE	PROPERTY LINE	
EXISTING	LEGEND-PLAN	PROPOSED	EXISTING
	LEGEND-PLAN	PROPOSED	EXISTING
	LEGEND-PROFILE	PROPOSED	EXISTING
	LEGEND-PROFILE	PROPOSED	EXISTING

**LOCATION APPROVED UNDERGROUND STRUCTURES**

SUPV. U/G STRUCTURES COMMITTEE DATE

**NOTE:**  
LOCATION OF UNDERGROUND STRUCTURES AS SHOWN ARE BASED ON THE BEST INFORMATION AVAILABLE BUT NO GUARANTEE IS GIVEN THAT ALL EXISTING UTILITIES ARE SHOWN OR THAT THE GIVEN LOCATIONS ARE EXACT. CONFIRMATION OF EXISTENCE AND EXACT LOCATION OF ALL SERVICES MUST BE OBTAINED FROM THE INDIVIDUAL UTILITIES BEFORE PROCEEDING WITH CONSTRUCTION.

B.M. ELEV.	
NO.	REVISIONS
DATE	BY
20.04.03	R.K.H.
2019/11/05	

**Stantec**  
500 - 311 Portage Avenue, Winnipeg MB Canada  
www.stantec.com

DESIGNED BY: J.D., T.G.  
CHECKED BY: S.R.S.

DRAWN BY: V.K.  
APPROVED BY: R.K.H.

HOR. SCALE: 1:250  
VERTICAL: 1:10

RELEASED FOR CONSTRUCTION:

DATE: 2019/11/05

ENGINEER'S SEAL

**PRELIMINARY DRAWING**

NOT TO BE USED FOR CONSTRUCTION

CONSULTANT DRAWING NO. C-205

**THE CITY OF WINNIPEG**  
PUBLIC WORKS DEPARTMENT  
ENGINEERING DIVISION

**ROBLIN BOULEVARD PAVEMENT RENEWAL**

ROBLIN BOULEVARD  
STA 2+180 TO STA 2+290  
ROADWORKS - RENEWAL

SHEET 12 OF 50  
CAD FILE DRAWING NUMBER 08080c-205-xxx.dwg  
CITY DRAWING NUMBER P-3528-12