

P:\2018\160379200-2019-2023 Erin-Hill-Sargent Sheet108 - CAD\09 Staging\Sargent\1603792 - Sargent Staging.dwg Last Saved: 2/26/2020 10:09 AM by diane Plotlet: 2/26/2020 10:09 AM by Dave Lane A1 SIZE 994mm x 647mm

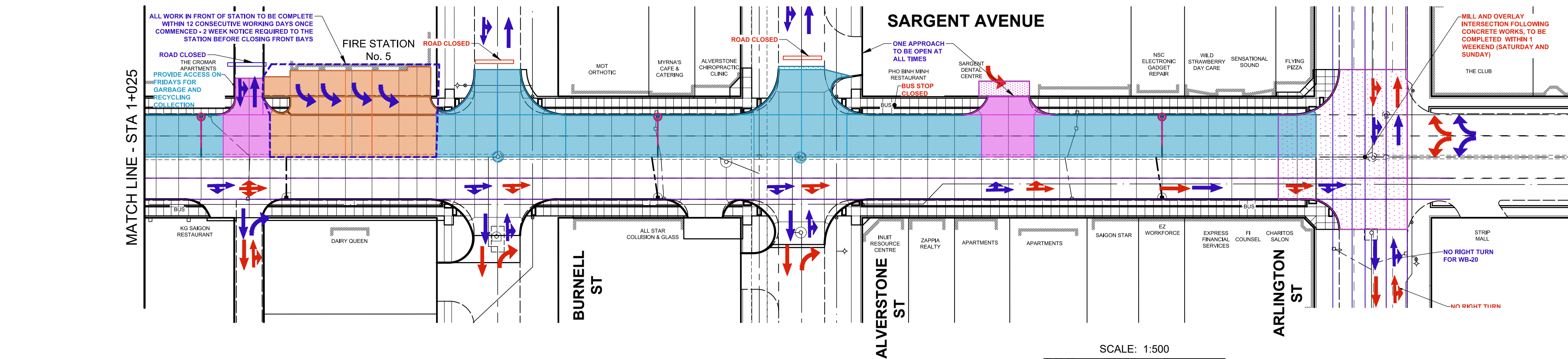
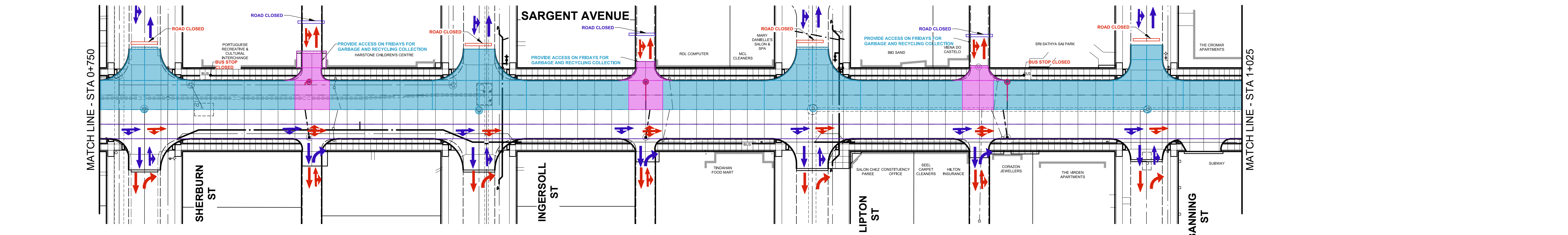
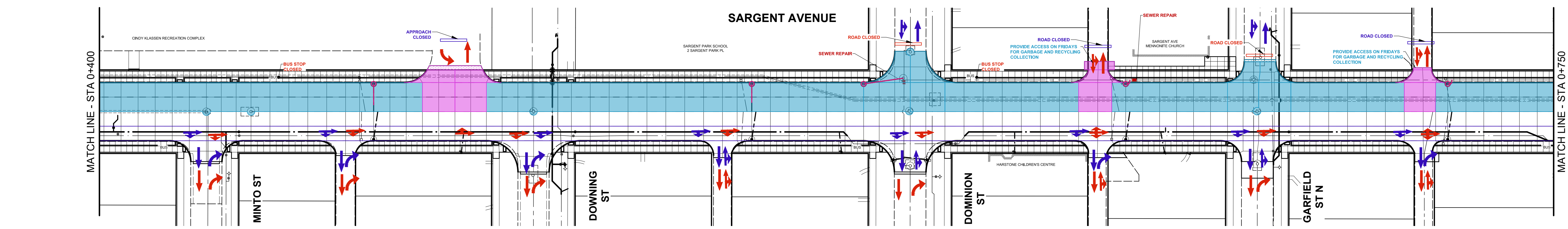
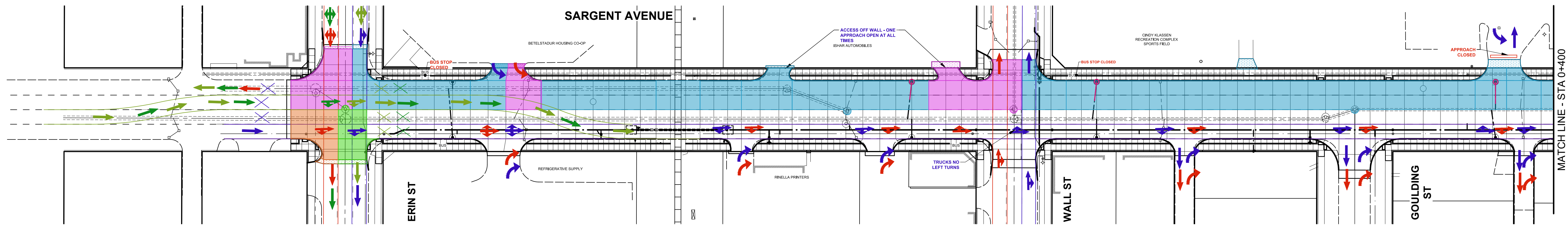

NOTES

- SARGENT AVENUE - MAINTAIN A MINIMUM OF ONE LANE OF TRAFFIC IN DIRECTION SHOWN FOR EACH PHASE ON PLAN, MAINTAIN PEDESTRIAN ACCESS AT ALL TIMES DURING CONSTRUCTION
- ARLINGTON STREET - MAINTAIN A MINIMUM OF ONE LANE OF TRAFFIC EACH DIRECTION AND PEDESTRIAN ACCESS AT ALL TIMES DURING CONSTRUCTION
- ERIN AND WALL STREET - ONE LANE MUST BE MAINTAINED AT ALL TIMES, MAINTAIN PEDESTRIAN ACCESS AT ALL TIMES DURING CONSTRUCTION
- PRIVATE APPROACH ACCESS SHALL BE MAINTAINED AT ALL TIMES
- CONSTRUCTION STAGING IN ACCORDANCE WITH THE LATEST EDITION OF THE CITY OF WINNIPEG "MANUAL OF TEMPORARY TRAFFIC CONTROL ON CITY STREETS"
- MAINTAIN EXISTING DRAINAGE AND INSTALL PROPOSED DRAINAGE APPURTENANCES AND CARRY OUT SEWER REPAIRS AS REQUIRED DURING THE APPROPRIATE STAGES AND AS DIRECTED BY THE CONTRACT ADMINISTRATOR
- TO FACILITATE LIDS INSTALLATION, SAWCUT EXISTING PAVEMENT (FULL DEPTH) PRIOR TO REMOVAL, PATCH AS NECESSARY.
- CONSTRUCT TEMPORARY ASPHALT PAVEMENT AND RAMPS AS REQUIRED TO FACILITATE THE CONSTRUCTION STAGING. THE TEMPORARY ASPHALT PAVEMENT SHALL CONSIST OF 100 mm - TYPE 1A ASPHALTIC CONCRETE PAVEMENT, 75 mm BASE COURSE
- SOUTH CENTRE LANE AT ERIN STREET TO BE PARTIALLY EXCAVATED AND PERMANENT SUB-BASE / BASE STRUCTURE INSTALLED DURING PHASE 2, WHILE MAINTAINING REQUIRED TRAFFIC (TO AVOID UNDERMINING OF PAVEMENT IN SUBSEQUENT STAGES).
- SAWCUT EXISTING PAVEMENT FULL DEPTH PRIOR TO REMOVAL TO ENSURE INTEGRITY OF REMAINING PAVEMENT LEFT OPEN TO TRAFFIC.
- PROPOSED SIDEWALKS TO BE CONSTRUCTED FOLLOWING CONSTRUCTION OF MAIN LANES. ENSURING ONE NORTH/SOUTH CROSSING AND ONE EAST/WEST CROSSING ARE MAINTAINED AT ALL INTERSECTING STREETS AT ALL TIMES.

LEGEND

- PHASE 2**
- | | |
|---------------------------|---------------------------|
| STAGE 3 - TRAFFIC | STAGE 5 - TRAFFIC |
| STAGE 3 - CONSTRUCTION | STAGE 5 - CONSTRUCTION |
| STAGE 3 - ASPHALT OVERLAY | STAGE 5 - ASPHALT OVERLAY |
| STAGE 3 - LAND DRAINAGE | STAGE 6 - TRAFFIC |
| STAGE 3 - EPRS | STAGE 6 - CONSTRUCTION |
| STAGE 4 - TRAFFIC | STAGE 6 - ASPHALT OVERLAY |
| STAGE 4 - CONSTRUCTION | |
| STAGE 4 - ASPHALT OVERLAY | |

