

PLAN
SCALE: 1:250

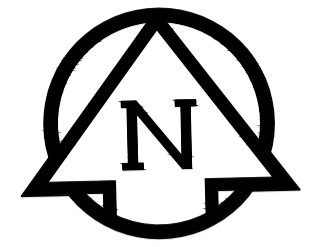

CURVE TABLE				
CURVE	RADIUS	LENGTH	DELTA	TANGENT
C14	7.500	11.796	90°06'40"	7.515
C15	7.500	11.766	89°53'20"	7.485
C16	4.500	5.601	71°18'56"	3.229
C17	4.500	5.601	71°18'56"	3.229
C18	5.000	7.864	90°06'40"	5.010
C19	5.000	7.844	89°53'20"	4.990
C20	4.500	5.601	71°18'56"	3.229
C21	4.500	5.601	71°18'56"	3.229
C22	7.500	11.796	90°06'40"	7.515
C23	7.500	11.766	89°53'20"	7.485
C24	3.500	5.504	90°06'20"	3.506
C25	4.500	5.601	71°18'56"	3.229

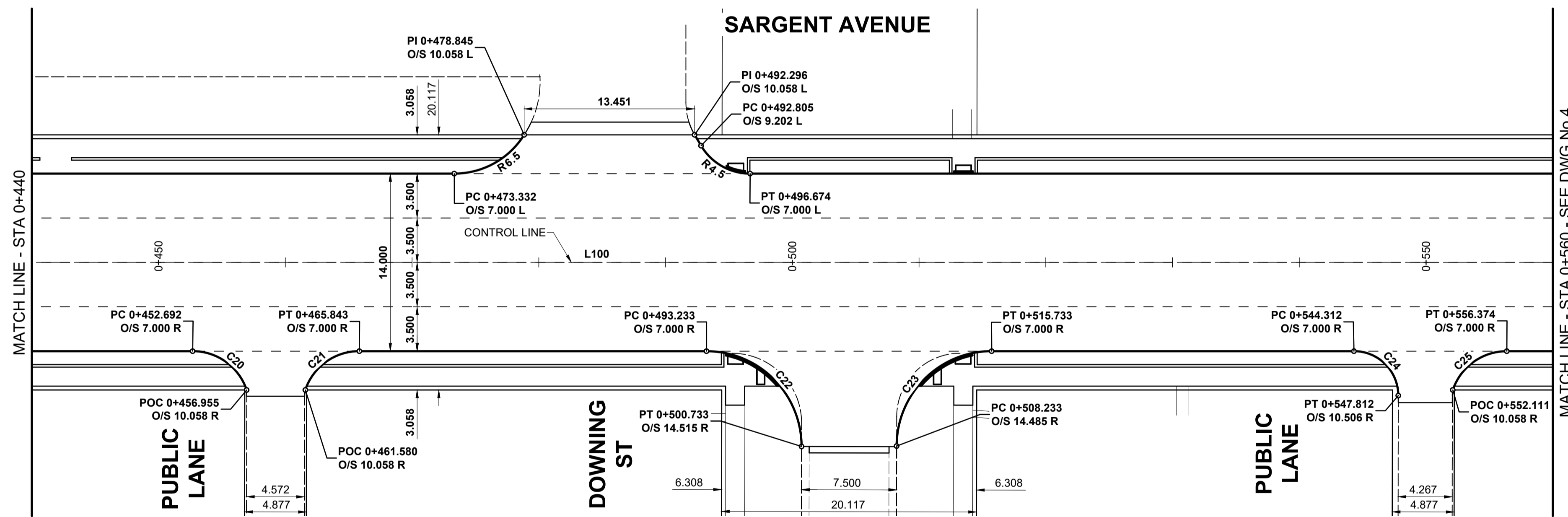

PLAN
SCALE: 1:250



SARGENT AVENUE - CONTROL LINE GEOMETRY										
NUMBER	LENGTH	RADIUS	DELTA	TANGENT	START STATION	NORTHING	EASTING	END STATION	NORTHING	EASTING
L100	1307.095				0+000.000	10007.610	9973.954	1+307.095	9977.040	11280.691



TENDER No. 10-2020

LOCATION APPROVED
UNDERGROUND STRUCTURES

SUPR. U/G STRUCTURES COMMITTEE DATE

NOTE:
LOCATION OF UNDERGROUND STRUCTURES AS SHOWN ARE BASED ON THE BEST INFORMATION AVAILABLE BUT NO GUARANTEE IS GIVEN THAT ALL EXISTING UTILITIES ARE SHOWN OR THAT THE GIVEN LOCATIONS ARE EXACT. CONFIRMATION OF EXISTENCE AND EXACT LOCATION OF ALL SERVICES MUST BE OBTAINED FROM THE INDIVIDUAL UTILITIES BEFORE PROCEEDING WITH CONSTRUCTION.

BM 37-59 ELEV 233.277 m	NE Cor. Erin St. & Richard Ave., Tab. in W. Conc. Foundation No. 1525 Erin St., 1 m N. & 0.7 m below back of S.W. Cor. of Blg.			
B	ISSUED FOR TENDER	20/02/27	RPB	
A	ISSUED FOR REVIEW	20/02/03	RPB	
No.	REVISIONS	YYMMDD	BY	DATE



DESIGNED BY	WRJ	CHECKED BY	RPB
DRAWN BY	DML	APPROVED BY	BWB
HOR SCALE		RELEASED FOR CONSTRUCTION	
VERT SCALE			
DATE		DATE	

PROFESSIONAL'S SEAL

PRELIMINARY DRAWING

NOT TO BE USED FOR CONSTRUCTION

CONSULTANT FILE NAME
1903792-Sargent-HG-02.dwg

THE CITY OF WINNIPEG
PUBLIC WORKS DEPARTMENT
ENGINEERING DIVISION

2020 PAVEMENT RENEWALS PROJECT
SARGENT AVENUE RECONSTRUCTION
ERIN STREET TO ARLINGTON STREET

SARGENT AVENUE
HORIZONTAL GEOMETRY
STA 0+320 TO STA 0+560

CITY DRAWING NUMBER
P-3519-03

SHEET 3 OF 26

DRAWING NUMBER
3

METRIC
WHOLE NUMBERS INDICATE MILLIMETRES
DECIMALIZED NUMBERS INDICATE METRES