

CHAINAGE ALONG NORTH MEDIAN LINE

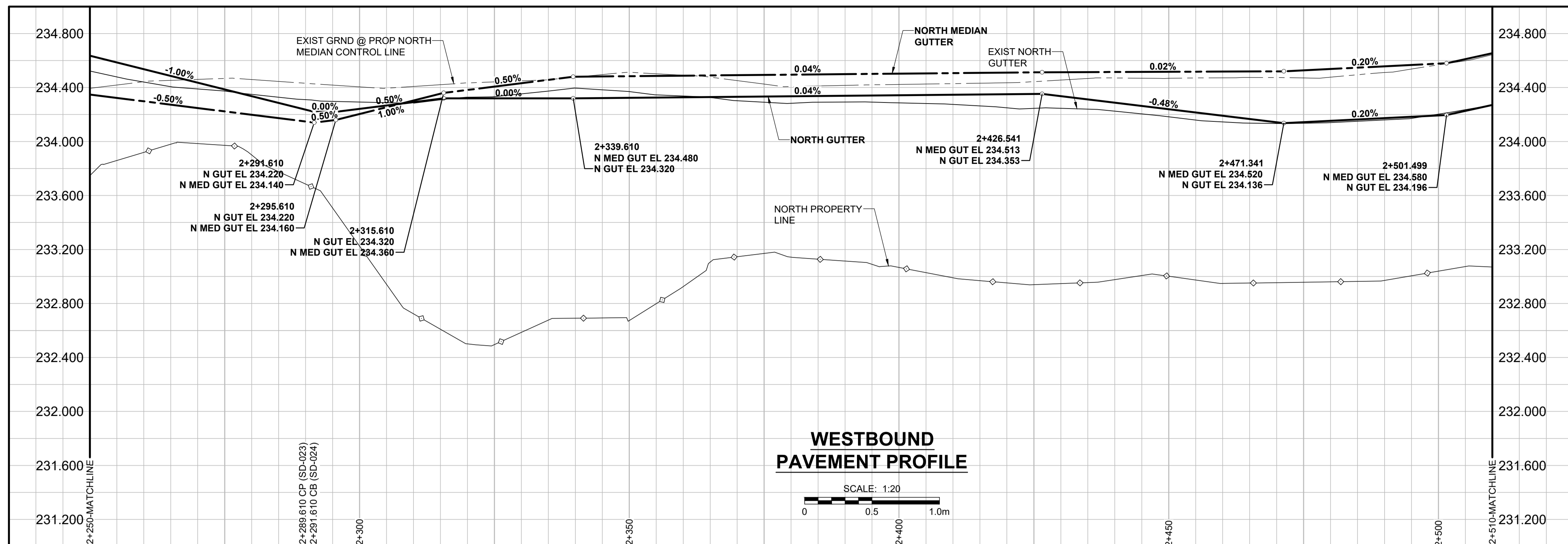

CHAINAGE ALONG SOUTH MEDIAN LINE

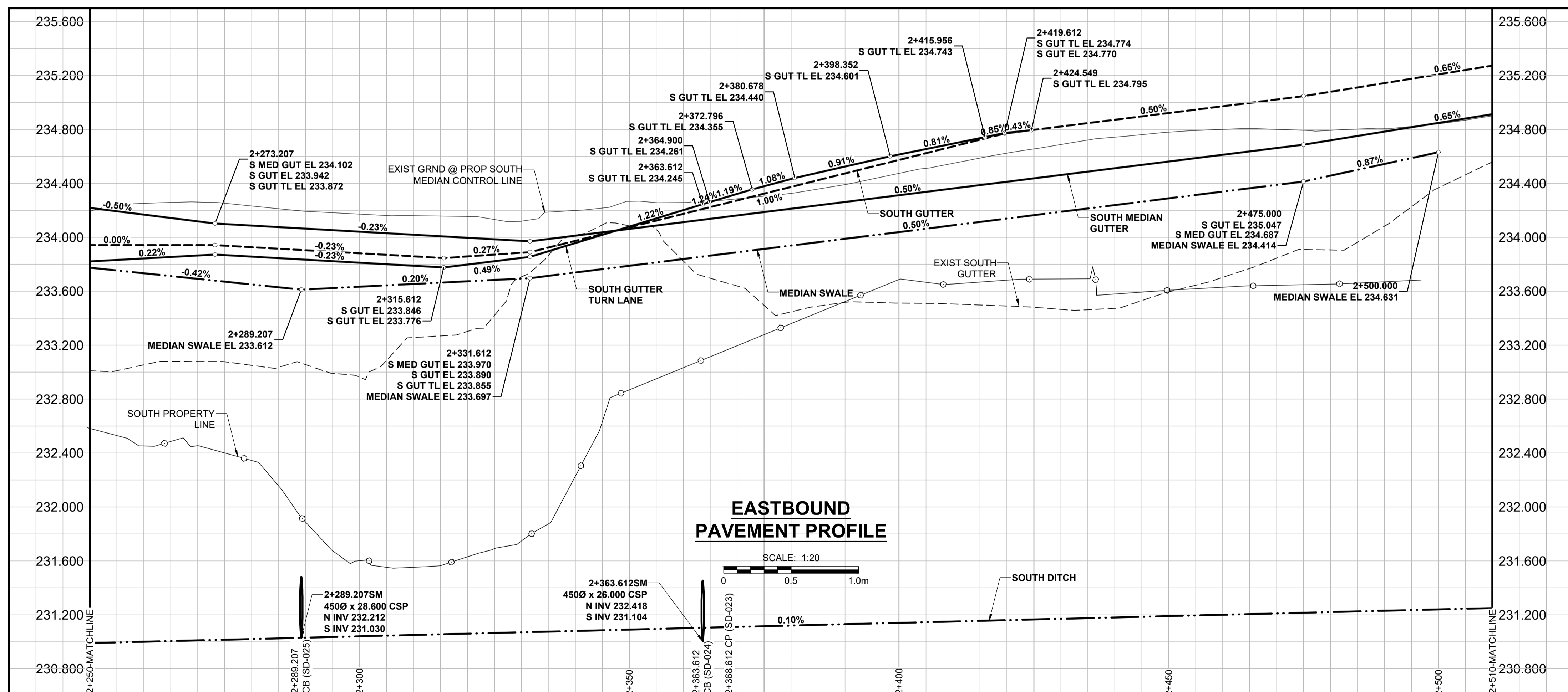

**METRIC**  
 WHOLE NUMBERS INDICATE MILLIMETRES  
 DECIMALIZED NUMBERS INDICATE METRES

**REFERENCE LEGEND**  
 -SEE DRAWING 16 FOR PAVING  
 -SEE DRAWING 32 FOR PAVING

---	GAS	○	MANHOLE	●	CONCRETE PAVEMENT
---	MTS / PEDESTAL	△	CATCH BASIN / CATCH PIT	■	CONC SIDEWALK / MEDIAN
---	HYDRO / CABINET	□	CURB INLET WITH BOX	▨	ASPHALT PAVEMENT
---	CATV / FIBRE OPTIC	○	TREE	▨	ASPHALT PAVT WIDENING
---	TRAFFIC SIGNALS / PIT	⊕	TEST HOLE	▨	PAVING STONE
---	LAND DRAINAGE SEWER	⊕	PROPERTY LINE	▨	GRAVEL
---	SANITARY/COMBINED SEWER	⊕	SURVEY BAR	▨	RAMP CURB
---	CB LEAD / SSP / DCP	⊕	FENCE	▨	PLANING / REMOVAL
---	WATER MAIN	---	BOC / EDGE OF PAVEMENT	---	
---	SUBDRAIN	33.000	ELEVATION	(33.333)	
---	DITCH	---	TRAFFIC SIGN		
---	EXISTING	---	LEGEND - PLAN	---	NEW

**LOCATION APPROVED**  
 UNDERGROUND STRUCTURES

DATE: \_\_\_\_\_  
 SUPR. U/G STRUCTURES COMMITTEE  
**NOTE:** LOCATION OF UNDERGROUND STRUCTURES AS SHOWN ARE BASED ON THE BEST INFORMATION AVAILABLE BUT NO GUARANTEE IS GIVEN THAT ALL EXISTING UTILITIES ARE SHOWN OR THAT THE GIVEN LOCATIONS ARE EXACT. CONFIRMATION OF EXISTENCE AND EXACT LOCATION OF ALL SERVICES MUST BE OBTAINED FROM THE INDIVIDUAL UTILITIES BEFORE PROCEEDING WITH CONSTRUCTION.

GBM - 55-015			
ELEV - 233.170			
C	ISSUED FOR TENDER	19/03/22	RPB
B	ISSUED FOR CLIENT REVIEW	19/02/15	RPB
A	ISSUED FOR 66% CLIENT REVIEW	18/12/21	RPB
No.	REVISIONS	Y/M/MDD	BY



DESIGNED BY	WRJ	CHECKED BY	RPB
DRAWN BY	DID	APPROVED BY	BWB
DATE	19/03/22	RELEASED FOR CONSTRUCTION	N/A

PROFESSIONAL'S SEAL  
 PROVINCE OF MANITOBA  
**R.P. BRUCE**  
 REGISTERED PROFESSIONAL ENGINEER  
 CONSULTANT FILE NAME  
 1804191-42-Ferraor-PR-42.dwg

**THE CITY OF WINNIPEG**  
 PUBLIC WORKS DEPARTMENT  
 ENGINEERING DIVISION

2019/2020 REGIONAL STREET RENEWAL PROGRAM  
**FERROR AVENUE**  
 FROM LAGIMODIERE BOULEVARD  
 TO PLESSIS ROAD (CITY BOUNDARY)

PROFILES  
**FERROR AVENUE**  
 STA 2+250 SM/MM TO STA 2+510 SM/MM

CITY DRAWING NUMBER  
 P-3501-42  
 SHEET 42 OF 63  
 DRAWING No. **42**

TENDER No. 8-2019