

CHAINAGE ALONG NORTH PATH EDGE

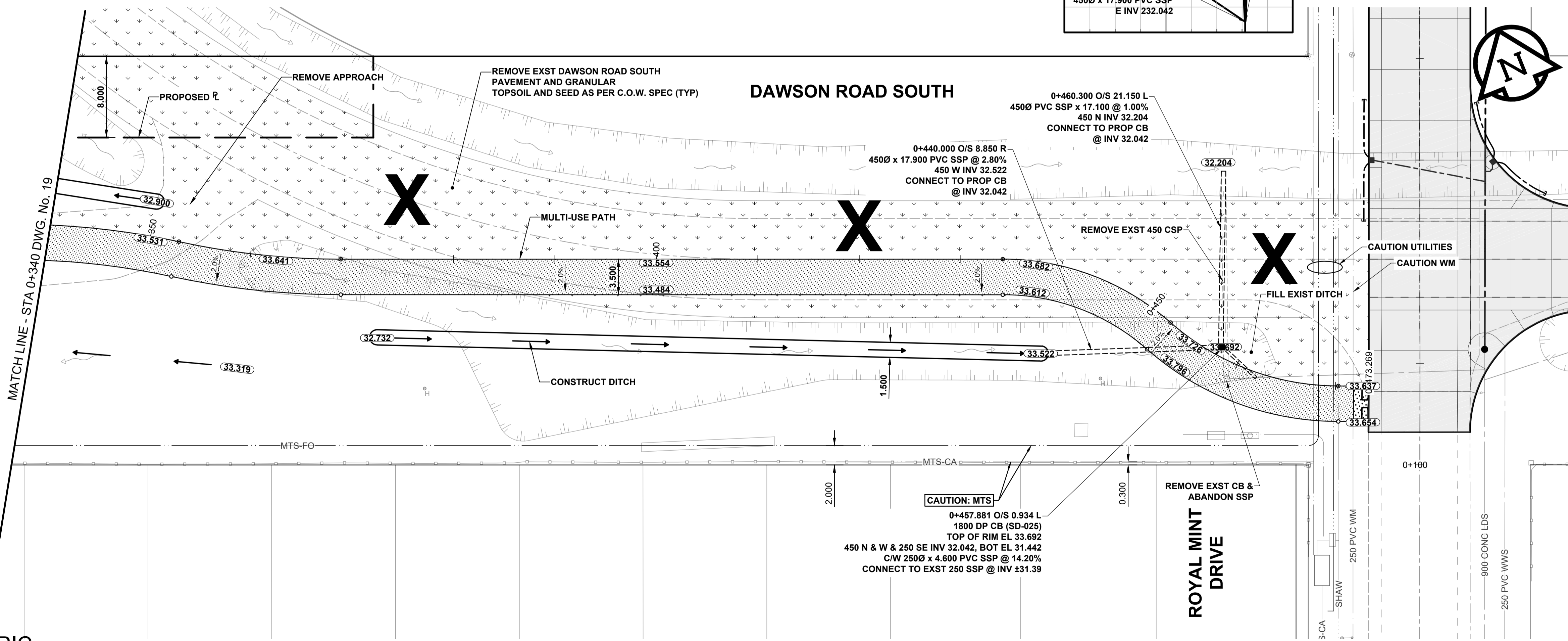

SEE DWG No's 21 & 22 FOR CONTINUATION OF ROYAL MINT DRIVE PAVEMENT WORKS

- NOTES
- ADJUST MH'S, CB RIMS, WV'S AND HYD'S TO NEW GRADES.
  - MODIFIED BARRIER CURB TO BE CONSTRUCTED AT ALL INTERSECTION RADI, BACK LANE RADI AND BULLNOSES.
  - CONTRACTOR TO CONFIRM THE LOCATION OF ALL UTILITIES/SERVICES IN THE FIELD PRIOR TO CONSTRUCTION.
  - ADD 200.000m TO ABBREVIATED ELEVATIONS TO OBTAIN GEODETIC ELEVATIONS.
  - CB SD-024 OFFSETS ARE DIMENSIONED TO BOC. CB SD-025 OFFSETS ARE DIMENSIONED OIC.
  - ALL DIMENSIONS TO BACK OF CURB AND THEORETICAL BACK OF CURB.
  - ALL WORK AND MATERIALS TO BE IN ACCORDANCE WITH LATEST REVISION OF THE CITY OF WINNIPEG STANDARD CONSTRUCTION SPECIFICATIONS.
  - ALL BOULEVARDS TO BE SEEDED UNLESS NOTED OTHERWISE. LIMITS TO BE IDENTIFIED IN THE FIELD BY THE CONTRACT ADMINISTRATOR.
  - INSTALL 6.000m OF 150mm SUBDRAIN TO CATCH BASINS IN BOTH DIRECTIONS PARALLEL TO ROADWAY AS PER SD-045 AND CAP ENDS.
  - CB LEADS TO BE INSTALLED AT MIN 1.0% SLOPE OR AS DIRECTED BY THE CONTRACT ADMINISTRATOR.
  - ISOLATE MISCELLANEOUS ITEMS IN NEW CONCRETE WORKS AS PER SD-228C.
  - LEGAL PLAN AND UNDERGROUND INFORMATION FROM CITY OF WINNIPEG LBIS.

SECTION LEGEND

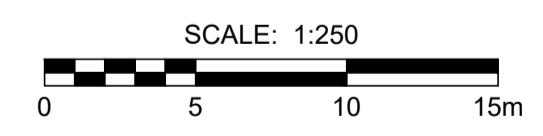
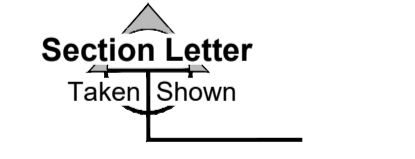

**ENGINEERS GEOSCIENTISTS MANITOBA**  
Certificate of Authorization  
MORRISON HERSHFIELD  
No. 1736

TENDER No. 8-2019

**METRIC**  
WHOLE NUMBERS INDICATE MILLIMETRES  
DECIMALIZED NUMBERS INDICATE METRES

---	GAS	○	MANHOLE	●	CONCRETE PAVEMENT	---	LOCATION APPROVED
- - -	MTS / PEDESTAL	□	CATCH BASIN / CATCH PIT	■	CONC SIDEWALK / MEDIAN	---	UNDERGROUND STRUCTURES
- - -	HYDRO / CABINET	△	CURB INLET WITH BOX	▲	ASPHALT PAVEMENT	---	DATE
- - -	CATV / FIBRE OPTIC	⊙	TREE		ASPHALT PAVT WIDENING	---	SUPR. UIG STRUCTURES COMMITTEE
- - -	TRAFFIC SIGNALS / PIT	⊕	TEST HOLE		PAVING STONE	---	NOTE:
- - -	LAND DRAINAGE SEWER	⊕	PROPERTY LINE		GRAVEL	---	LOCATION OF UNDERGROUND STRUCTURES AS SHOWN ARE BASED ON THE BEST INFORMATION AVAILABLE BUT NO GUARANTEE IS GIVEN THAT ALL EXISTING UTILITIES ARE SHOWN OR THAT THE GIVEN LOCATIONS ARE EXACT. CONFIRMATION OF EXISTENCE AND EXACT LOCATION OF ALL SERVICES MUST BE OBTAINED FROM THE INDIVIDUAL UTILITIES BEFORE PROCEEDING WITH CONSTRUCTION.
- - -	SANITARY/COMBINED SEWER	⊕	SURVEY BAR		RAMP CURB	---	
- - -	CB LEAD / SSP / DCP	⊕	FENCE		PLANING / REMOVAL	---	
- - -	WATER MAIN	⊕	BOC / EDGE OF PAVEMENT			---	
- - -	SUBDRAIN	⊕	ELEVATION	(33.333)		---	
- - -	DITCH	⊕	TRAFFIC SIGN			---	
---	EXISTING	---	LEGEND - PLAN	---	EXISTING	---	LEGEND - PLAN
---	NEW	---	EXISTING	---	NEW	---	LEGEND - PLAN

---	CONCRETE PAVEMENT	---	NEW
---	CONC SIDEWALK / MEDIAN	---	NEW
---	ASPHALT PAVEMENT	---	NEW
---	ASPHALT PAVT WIDENING	---	NEW
---	PAVING STONE	---	NEW
---	GRAVEL	---	NEW
---	RAMP CURB	---	NEW
---	PLANING / REMOVAL	---	NEW

---	ISSUED FOR TENDER	19/03/22	JGK
---	ISSUED FOR CLIENT REVIEW	19/02/15	JGK
---	ISSUED FOR 66% CLIENT REVIEW	18/12/21	JGK
---	REVISIONS	YY/MM/DD	BY

**MORRISON HERSHFIELD**

DESIGNED BY: JGK  
CHECKED BY: RPB  
DRAWN BY: DID  
APPROVED BY: BWB  
BY: DATE: 19/03/22

HOR SCALE: 1:250  
VERT SCALE: 1:10  
RELEASED FOR CONSTRUCTION: N/A

PROFESSIONAL'S SEAL  
PROVINCE OF MANITOBA  
**J.G. KENNEDY**  
Member  
22326  
REGISTERED PROFESSIONAL ENGINEER  
CONSULTANT FILE NAME  
1804191-20-Fermor-PP-20.dwg

**THE CITY OF WINNIPEG**  
PUBLIC WORKS DEPARTMENT  
ENGINEERING DIVISION

2019/2020 REGIONAL STREET RENEWAL PROGRAM  
**FERMOR AVENUE**  
FROM LAGIMODIERE BOULEVARD TO PLESSIS ROAD (CITY BOUNDARY)  
PLAN AND PROFILES  
DAWSON ROAD SOUTH/MULTI-USE PATH  
STA 0+340 TO ROYAL MINT DRIVE

CITY DRAWING NUMBER: P-3501-20  
SHEET 20 OF 63  
DRAWING No. 20