

NOTES:
CONSTRUCTION STANDARDS
TO BE CONSTRUCTED IN ACCORDANCE WITH MANITOBA HYDRO DISTRIBUTION AND SUBTRANSMISSION STANDARDS. LATEST REVISION. NO MAJOR CHANGE SHALL BE MADE WITHOUT APPROVAL OF THE DESIGN ENGINEER OR DELEGATE.
SITE GRADING
THE DEVELOPER IS RESPONSIBLE FOR GRADING OF THE SITE TO WITHIN +1.0 15M OF FINISHED GRADE PRIOR TO CONSTRUCTION COMMENCEMENT. BENCHMARKS ARE TO BE OBTAINED FROM THE DEVELOPER OR CONSULTANT.

| AUTHORITY | NOTIFIED | NOT REQ'D | OBTAINED |
|-------------------|------------|-----------|----------|
| DISTRICT | 2019-03-12 | | |
| C.O.W MUNICIPAL | 2019-03-12 | | |
| M.T.S. | 2019-03-12 | | |
| GAS | | X | |
| SHAW | | X | |
| EASEMENTS | | X | |
| COMMUNICATIONS | | X | |
| S.C.C. | | X | |
| DEPT. OF HIGHWAYS | | X | |

| CONTACT | NAME | PHONE NUMBER | E-MAIL ADDRESS |
|------------------------|-----------------|--------------|------------------------|
| DESIGN | IAN MCCALLUM | 470-3154 | IMCCALLUM@HYDRO.MB.CA |
| DESIGN ENGINEER | ERIC WICKSTROM | 770-2410 | EWICKSTROM@HYDRO.MB.CA |
| PORTFOLIO PM | DARIN WACH | 451-2917 | DWACH@HYDRO.MB.CA |
| ENERGY SERVICE ADVISOR | DARRYL STOCKI | 918-0341 | DSTOCKI@HYDRO.MB.CA |
| UIG CONSTRUCTION | BILL AMMETER | 360-7019 | BAMMETER@HYDRO.MB.CA |
| OH CONSTRUCTION | WAYNE IRELAND | 771-6212 | WIRELAND@HYDRO.MB.CA |
| HYDRO GAS | | | |
| SHAW | | | |
| MTS | | | |
| HYDRO REPRESENTATIVE | MARK HILDEBRAND | 391-6332 | MHILDEBRAND@WNNPEG.CA |
| DISTRICT ENG TECH | ROB DENEKA | 360-6987 | RDENEKA@HYDRO.MB.CA |

| LOCATION | LUMINAIRE | TYPE | MOUNTING HEIGHT | AVG. LUM. OUTPUT | LUM. RATIO | AVG. SPACING |
|------------|-------------|------|-----------------|------------------|------------|--------------|
| FERMOR AVE | 160-24W LED | B | 13.8m | 9,09 | 3.40 | 82.5 |

| INSTALLED | | | |
|-----------|--------------|---------|-----------|
| Quantity | Fixture Type | Wattage | Pole Type |
| 3 | LED | 150 | EXCLUSIVE |
| 52 | LED | 240 | EXCLUSIVE |
| 2 | HPS | 1000 | EXCLUSIVE |
| 8 | LED | 60 | EXCLUSIVE |

| REMOVED | | | |
|----------|--------------|---------|-----------|
| Quantity | Fixture Type | Wattage | Pole Type |
| 39 | LED | 150 | EXCLUSIVE |
| 4 | HPS | 250 | EXCLUSIVE |
| 1 | HPS | 400 | EXCLUSIVE |
| 2 | HPS | 1000 | EXCLUSIVE |

| REEL NUMBER | MANUFACTURER | MANUFACTURE DATE |
|-------------|--------------|------------------|
| | | |
| | | |
| | | |

PRELIMINARY NOT TO BE USED FOR CONSTRUCTION

INFORMATION PERTAINING TO THE SIZE, TYPE AND LOCATION OF MANITOBA HYDRO FACILITIES AND INSTALLATIONS IS ILLUSTRATIVE AND SHOULD NOT BE RELIED ON FOR THE PURPOSES OF ANY ACTIVITY BEING CONDUCTED AT OR NEAR THE IDENTIFIED HYDRO INSTALLATIONS. ALL LOCATIONS AND EQUIPMENT MUST BE VERIFIED BY APPROPRIATE HYDRO DISTRICT OFFICES PRIOR TO ANY PHYSICAL ACTIVITY BEING UNDERTAKEN AT OR NEAR HYDRO INSTALLATIONS.

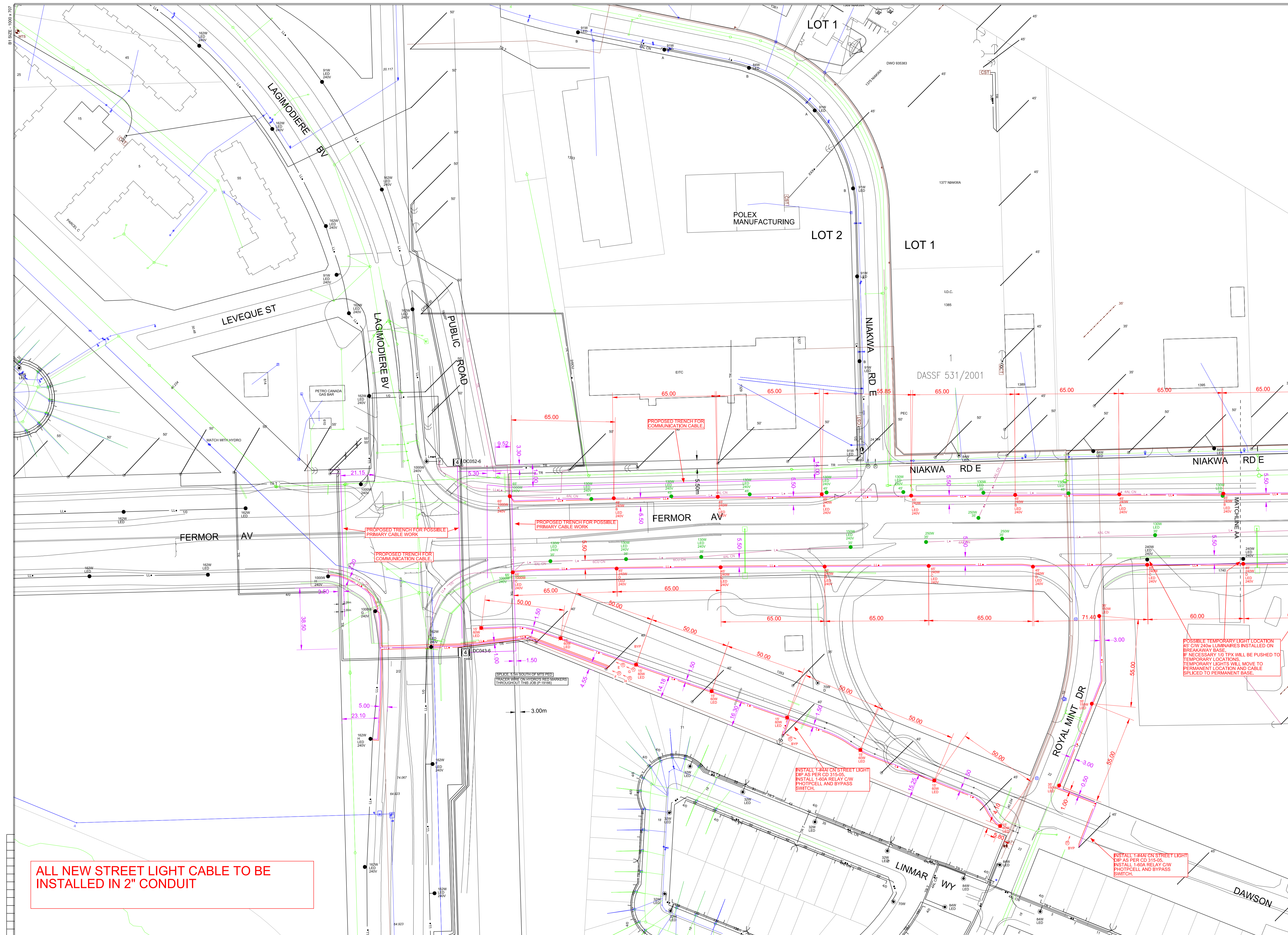

ALL NEW STREET LIGHT CABLE TO BE INSTALLED IN 2" CONDUIT

CONTACT "CLICK BEFORE YOU DIG MANITOBA" AT ClickBeforeYouDigMB.com
THREE FULL WORKING DAYS
PRIOR TO CONSTRUCTION FOR LOCATION OF EXISTING WATER, WASTEWATER, LAND DRAINAGE UTILITIES AND MANITOBA HYDRO UTILITIES

THIS IS A PRINT OF A DOCUMENT THAT HAS BEEN ELECTRONICALLY AUTHENTICATED WITH TECHNOLOGY AUTHORIZED BY THE EGM. THE ORIGINAL IS IN ELECTRONIC FORM.

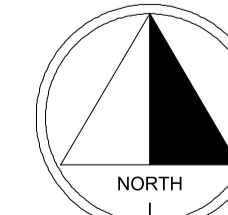

| NO. | DATE | REVISIONS | BY | CHKD. | APP. |
|-----|------|-----------|----|-------|------|
| | | | | | |

| DRAWING NUMBER | REFERENCE DRAWINGS |
|----------------|--------------------|
| | |

| AREA NUMBER | MANITOBA HYDRO DISTRIBUTION PLANNING & DESIGN |
|----------------|--|
| 5401 | WO # P-31565 NETWORK # 4305687 |
| STATION NUMBER | DISTRICT: TRANSCONA |
| 1436 | FERMOR AVE |
| FEEDER NUMBER | NEW ROADWAY LIGHTING BETWEEN LAGIMODIERE BLVD AND THE CNR TRACKS |
| P78 | |
| SYSTEM VOLTAGE | 13.8/24KV |
| SCALE | 1:1000 |
| CHECK | IM |
| DATE | 2019-01-18 |