

NOTE: ALL VERTICAL CURVES SHOWN TO BE 5.0m

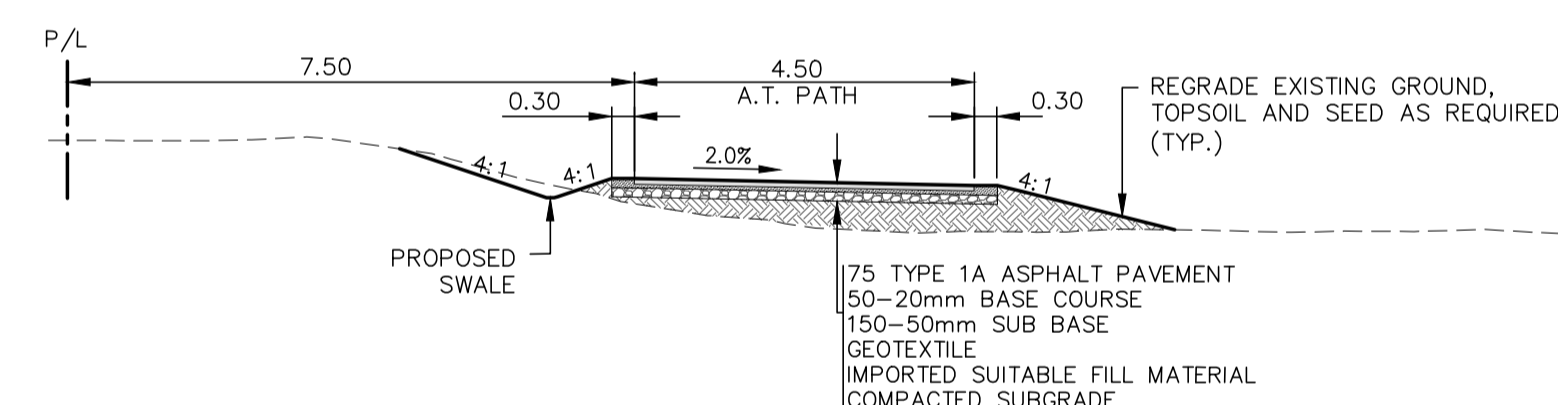

SECTION G-G
SCALE 1:100

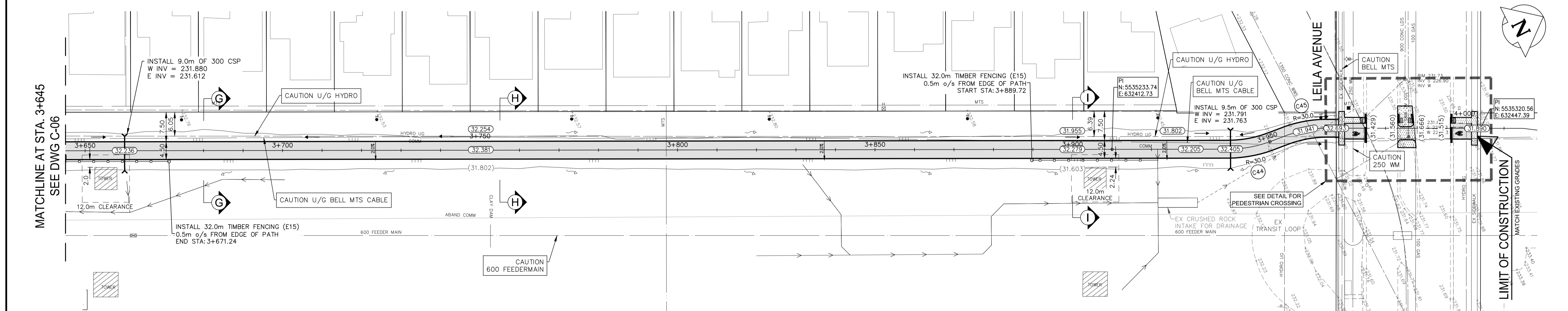
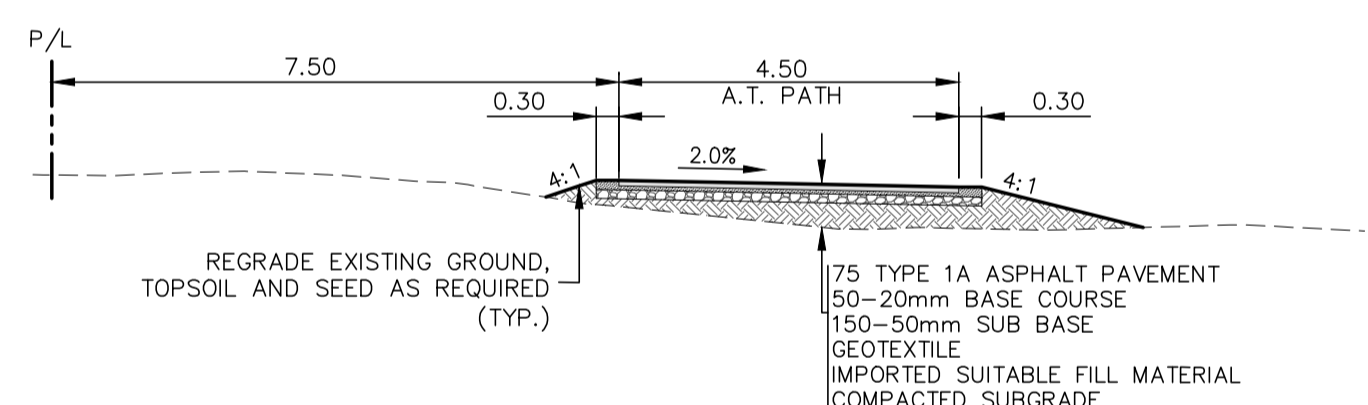

SECTION H-H
SCALE 1:100

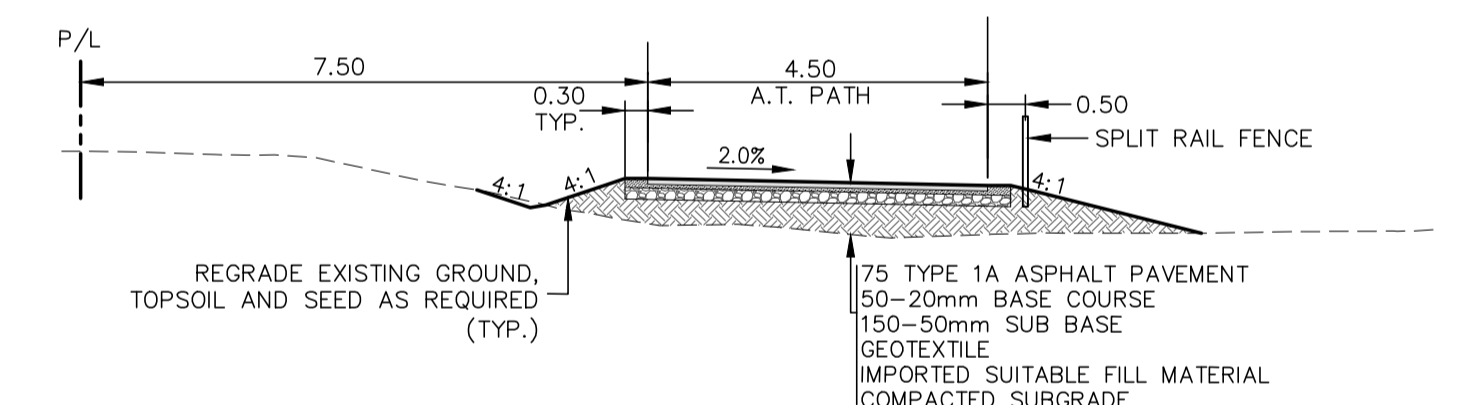

SECTION I-I
SCALE 1:100

- NOTES:
1. ALL WORK AND MATERIALS TO BE IN ACCORDANCE WITH THE LATEST REVISION OF THE CITY OF WINNIPEG STANDARD CONSTRUCTION SPECIFICATIONS.
 2. CONTRACTOR TO CONFIRM THE LOCATION OF ALL UTILITIES/SERVICES IN THE FIELD PRIOR TO CONSTRUCTION.
 3. ADD 200.00 TO ABBREVIATED ELEVATIONS TO OBTAIN GEODETIC ELEVATION.
 4. CONTRACTORS TO TAKE PRECAUTIONARY STEPS TO PROTECT EXISTING TREES WITHIN THE LIMITS OF CONSTRUCTION FROM DAMAGE FROM CONSTRUCTION ACTIVITIES AS OUTLINED IN THE SPECIFICATIONS.
 5. LAMP STANDARDS, HYDRO POLES, AND ANCHORS THAT REQUIRE TEMPORARY SUPPORT, REMOVAL OR REPLACEMENT, TO BE DONE SO AT THE EXPENSE OF THE CONTRACTOR AS NECESSARY.
 6. ALL BOULEVARDS TO BE SEEDED UNLESS OTHERWISE NOTED. LIMITS TO BE IDENTIFIED IN THE FIELD BY THE CONTRACT ADMINISTRATOR.
 7. ADJUST ALL WATER VALVES, HYDRANTS, MANHOLES, AND CATCH BASINS IN WORK AREA TO GRADE.
 8. PEDESTRIAN CROSSING AND HALF SIGNAL AT THE PROPOSED CROSSING TO BE INSTALLED BY THE CITY.
 9. PAVEMENT MARKING AND SIGNAGE TO BE COMPLETED BY THE CITY.
 10. CONSTRUCTION VEHICLES SHALL ONLY CROSS THE FEEDERMAIN AT EXISTING ROADWAYS. CROSSING OF THE FEEDERMAIN IN GRASS AREAS SHALL NOT BE PERMITTED.
 11. REMOVE ORGANIC MATERIAL AS DIRECTED BY THE CONTRACT ADMINISTRATOR.
 12. SUITABLE SITE MATERIAL TO BE COMPACTED MIN. TO 90% OF STANDARD PROCTOR OR AS DIRECTED BY THE CONTRACT ADMINISTRATOR.

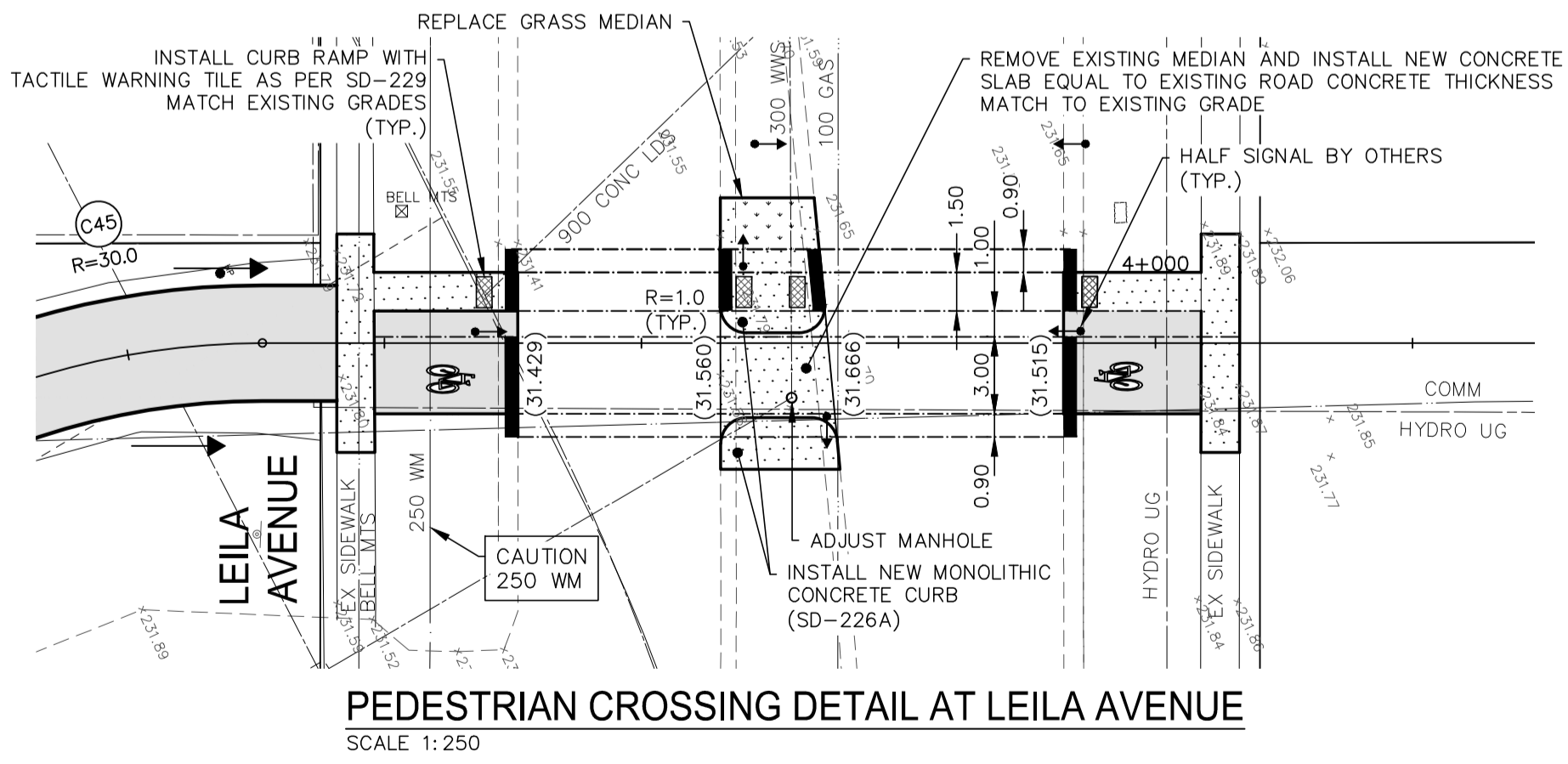

PEDESTRIAN CROSSING DETAIL AT LEILA AVENUE
SCALE 1:250

EXISTING	LEGEND-PLAN	PROPOSED	EXISTING	LEGEND-PLAN	PROPOSED	EXISTING	LEGEND-PROFILE	PROPOSED
---	WATER MAIN	---	---	IRON BAR	---	---	---	---
---	LAND DRAINAGE SEWER	---	---	HYDRO POLE & LIGHT STANDARD	---	---	---	---
---	WASTE WATER SEWER	---	---	LIGHT STANDARD OR TRAFFIC SIGNAL	---	---	---	---
---	HYDRO	---	---	HYDRO POLE	---	---	---	---
---	M.T.S.	---	---	HYDRO LIDS	---	---	---	---
---	GAS	---	---	HYDRO SWALE	---	---	---	---
---	SIGNALS	---	---	CULVERT	---	---	---	---
○	MANHOLE	○	○	DITCH FLOW	---	---	---	---
□	CATCH BASIN	□	□	CURB RAMP	---	---	---	---
△	CURB INLET	△	△	DETECTABLE WARNING SURFACE TILE	---	---	---	---
▽	UTILITIES ADJUSTED	▽	▽	EDGE OF SIDEWALK	---	---	---	---
└	PLUG	└	└	FENCE	---	---	---	---
◇	HYDRANT	◇	◇	PROPERTY LINE	---	---	---	---
⊗	VALVE	⊗	⊗	EDGE OF ASPHALT	---	---	---	---
⊙	CURB STOP	⊙	⊙	EDGE OF ROAD	---	---	---	---
---	GROUND GRADE	---	---	CONC SIDEWALK	---	---	---	---
(31.00)	GRADE	(31.00)	(31.00)	ASPHALT	---	---	---	---
---	ANCHOR	---	---	HEAVY DUTY ASPHALT	---	---	---	---
#111	CIVIC ADDRESS	#111	#111	GRASS	---	---	---	---
---	EXISTING	---	---	WEST SWALE	---	---	---	---
---	LEGEND-PLAN	---	---	EAST SWALE	---	---	---	---
---	PROPOSED	---	---	A.T. PATH CENTRELINE	---	---	---	---
---	EXISTING	---	---	LEGEND-PROFILE	---	---	---	---
---	PROPOSED	---	---	---	---	---	---	---

LOCATIONS APPROVED UNDERGROUND STRUCTURES

SIGNED BY: _____ DATE: _____

SUPV UG STRUCTURES

LOCATION OF UNDERGROUND STRUCTURES AS SHOWN ARE BASED ON THE BEST INFORMATION AVAILABLE BUT NO GUARANTEE IS GIVEN THAT ALL EXISTING UTILITIES ARE SHOWN OR THAT THE GIVEN LOCATIONS ARE EXACT CONFIRMATION OF EXISTENCE AND EXACT LOCATION OF ALL SERVICES MUST BE OBTAINED FROM THE INDIVIDUAL UTILITIES BEFORE PROCEEDING

G.M.M. - N/A. EXISTING GROUND ELEVATIONS OBTAINED BY GPS AND LIDAR INFORMATION PROVIDED BY THE CITY OF WINNIPEG

ELEV. - N/A

NO.	REVISIONS	DATE	BY
H	-	-	-
G	-	-	-
F	-	-	-
E	ISSUED FOR TENDER	27-JAN-19	RW
D	REVISED FOR REVIEW	11-MAR-19	VM
C	REVISED PER CITY COMMENTS	20-MAR-19	VM
B	ISSUED FOR UNDERGROUND STRUCTURES REVIEW	16-APR-18	VM
A	ISSUED FOR CITY REVIEW	30-JAN-18	VM

wsp

WSP Canada Inc
Suite 111 - 93 Lombard Ave
Winnipeg, MB R3B 3B1
t. 204.943.3178
f. 204.943.4948
www.wsp.com

DESIGNED BY: TP
CHECKED BY: VM/TP
DRAWN BY: ED
APPROVED BY: VM

HOR. SCALE: 1:500
VERTICAL: 1:20

NO. 2018-03-20

ENGINEER'S SEAL

NOT FOR CONSTRUCTION

CONSULTANT ACAD DWG. NO. 5515081-C-07

ENGINEERS GEOSCIENTISTS MANITOBA

Certificate of Authorization

WSP Canada Group Limited

No. 6657

THE CITY OF WINNIPEG

PUBLIC WORKS DEPARTMENT

ENGINEERING SERVICES DIVISION

Winnipeg

WINNIPEG BIKE PROJECTS

NORTHWEST HYDRO CORRIDOR PATHWAY

CHURCH AVENUE TO LEILA AVENUE
STA. 3+645 TO STA. 4+001.8

CITY DRAWING NUMBER: ---
SHEET 7 OF 8

BID NO. 656-2019