

# MATHESON AVE EAST

COCHRANE ST

JONES ST

101.4 OF 375 WWS TO BE LINED  
S-MA00009417

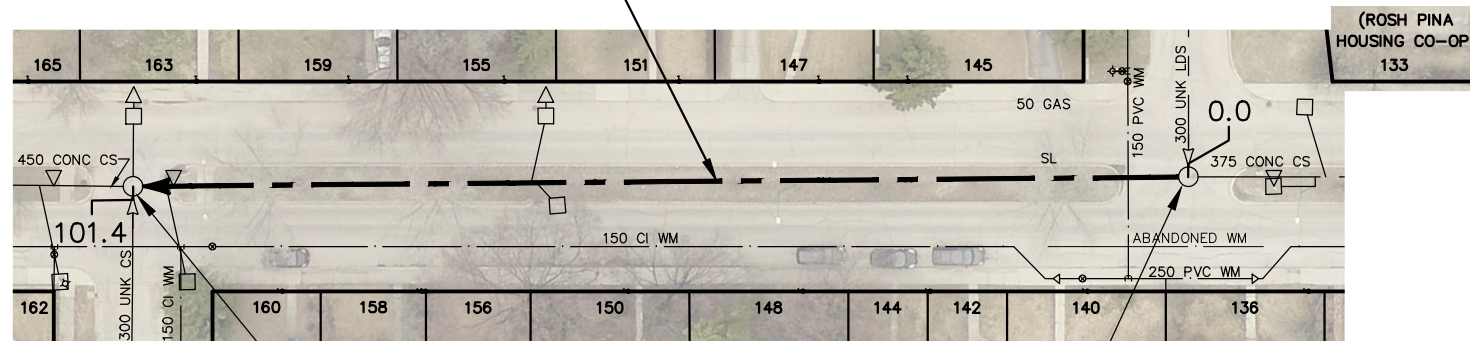

S-MH00011096  
RIM 229.42  
INV E 225.99  
INV S 227.45  
INV W 225.89

S-MH00011097  
RIM 230.86  
INV N 226.80  
INV E 227.02  
INV W 227.02

SEWER JUNCTION INFORMATION FROM SEWER VIDEO INSPECTION		
SEWER ID S-MA00009417		
DISTANCE FROM MH ID S-MH00011097		
DISTANCE	DIAMETER	CLOCK
5.6	150	11
27.0	150	11
27.8	150	2
36.2	150	11
36.9	150	2
51.7	150	1
57.0	150	11
63.3	250	11
64.0	250	2
67.0	150	1
73.2	150	11
80.9	150	1
87.9	150	11
93.5	150	11
96.6	150	1
97.3	250	11
98.0	250	11
98.7	250	1

## WARNING

IF POWER EQUIPMENT OR EXPLOSIVES ARE TO BE USED FOR EXCAVATION ON THIS PROJECT THE CONTRACTOR MUST:

- 1) NOTIFY THE GAS COMPANY OF THE PROPOSED LOCATION OF EXCAVATION.
- 2) TAKE PRECAUTION TO AVOID DAMAGE TO GAS COMPANY INSTALLATIONS.

SEE PROVINCIAL REGULATION 210/72 FOR DETAILS

FOR INDEX SEE 12202

## METRIC

WHOLE NUMBERS INDICATE MILLIMETRES  
DECIMALIZED NUMBERS INDICATE METRES

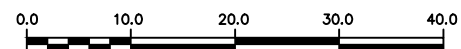

LOCATION APPROVED  
UNDERGROUND STRUCTURES

SUPV. U/G STRUCTURES COMMITTEE DATE

NOTE:

LOCATION OF UNDERGROUND STRUCTURES AS SHOWN ARE BASED ON THE BEST INFORMATION AVAILABLE BUT NO GUARANTEE IS GIVEN THAT ALL EXISTING UTILITIES ARE SHOWN OR THAT THE GIVEN LOCATIONS ARE EXACT. CONFIRMATION OF EXISTENCE AND EXACT LOCATION OF ALL SERVICES MUST BE OBTAINED FROM THE INDIVIDUAL UTILITIES BEFORE PROCEEDING WITH CONSTRUCTION.

B.M. ELEV.			
NO.	REVISIONS	DATE	BY

DESIGNED BY	SC	CHECKED BY	SC
DRAWN BY	BL	APPROVED BY	KZ
SCALE:		RELEASED FOR CONSTRUCTION	
HORIZONTAL	1:750	<b>S. COURNOYER</b>	
VERTICAL			
DATE	2019 07 12	DATE	2019 07 12

ENGINEER'S SEAL  
**ORIGINAL SIGNED BY S.R.J. COURNOYER 19/07/12**

CONSULTANT DRAWING NUMBER  
-



**THE CITY OF WINNIPEG**  
WATER AND WASTE DEPARTMENT  
ENGINEERING DIVISION

2018 SEWER MAIN RENEWALS  
BY CIPP LINNING  
**MATHESON AVENUE EAST**  
MH AT COCHRANE STREET TO  
MH AT JONES STREET

SHEET **43** OF **57**  
CITY DRAWING NUMBER  
**12242**