

LENORE STREET

62m N OF N/R
WOLSELEY AVE

62m S OF S/R
WESTMINSTER AVE

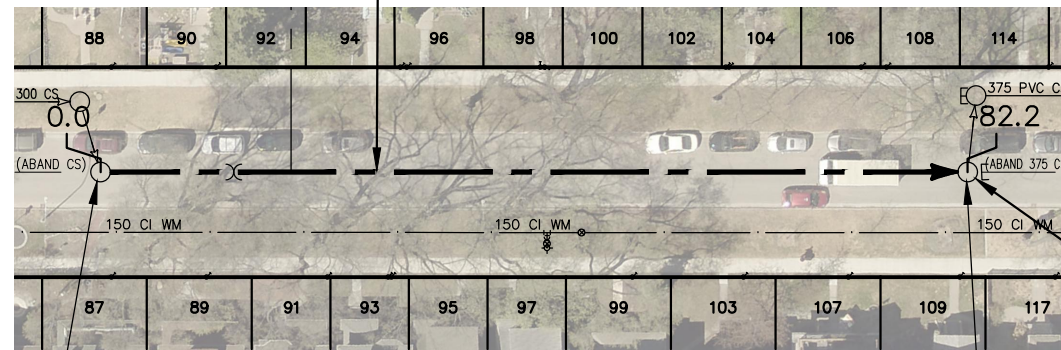

82.2 OF 375 CS TO BE LINED
S-MA20013840

REPLACE TOP RISER AND
REPAIR BENCHING
(TO BE DONE BY OTHERS)

S-MH20012539
RIM 232.35
INV N 227.33
INV W 227.26

S-MH20012550
RIM 232.28
INV S 227.04
INV W 226.85

SEWER JUNCTION INFORMATION FROM SEWER VIDEO INSPECTION		
SEWER ID S-MA20013840		
DISTANCE FROM MH ID S-MH20012539		
DISTANCE	DIAMETER	CLOCK
1.3	150	2
1.9	150	11
4.6	150	11
11.4	150	1
18.0	150	11
21.8	150	1
32.0	150	12
42.1	150	1
42.6	150	11
50.4	150	1
62.8	150	1
63.4	150	11
72.1	150	1
72.7	150	11

WARNING

IF POWER EQUIPMENT OR EXPLOSIVES
ARE TO BE USED FOR EXCAVATION ON
THIS PROJECT THE CONTRACTOR MUST:

- 1) NOTIFY THE GAS COMPANY OF THE PROPOSED LOCATION OF EXCAVATION.
- 2) TAKE PRECAUTION TO AVOID DAMAGE TO GAS COMPANY INSTALLATIONS.

SEE PROVINCIAL REGULATION 210/72 FOR DETAILS

FOR INDEX SEE
12202

METRIC

WHOLE NUMBERS INDICATE MILLIMETRES
DECIMALIZED NUMBERS INDICATE METRES

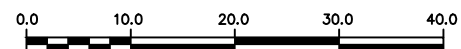

LOCATION APPROVED
UNDERGROUND STRUCTURES

SUPV. U/G STRUCTURES COMMITTEE DATE

NOTE:

LOCATION OF UNDERGROUND STRUCTURES AS SHOWN ARE BASED ON THE BEST INFORMATION AVAILABLE BUT NO GUARANTEE IS GIVEN THAT ALL EXISTING UTILITIES ARE SHOWN OR THAT THE GIVEN LOCATIONS ARE EXACT. CONFIRMATION OF EXISTENCE AND EXACT LOCATION OF ALL SERVICES MUST BE OBTAINED FROM THE INDIVIDUAL UTILITIES BEFORE PROCEEDING WITH CONSTRUCTION.

B.M. ELEV.			
NO.	REVISIONS	DATE	BY

DESIGNED BY	SC	CHECKED BY	SC
DRAWN BY	AJ	APPROVED BY	KZ
SCALE:		RELEASED FOR CONSTRUCTION	
HORIZONTAL	1:750	S. COURNOYER	
VERTICAL			
DATE	2019 07 12	DATE	2019 07 12

ENGINEER'S SEAL
ORIGINAL SIGNED BY S.R.J. COURNOYER 19/07/12
CONSULTANT DRAWING NUMBER -



THE CITY OF WINNIPEG
WATER AND WASTE DEPARTMENT
ENGINEERING DIVISION

2018 SEWER MAIN RENEWALS
BY CIPP LINING
LENORE STREET
2ND MH S OF WESTMINSTER AVENUE (C) TO
1ST MH S OF WESTMINSTER AVENUE

SHEET **39** OF **57**
CITY DRAWING NUMBER
12238