

# BORDER STREET

79.3 OF 375 WWS TO BE LINED  
S-MA20011735

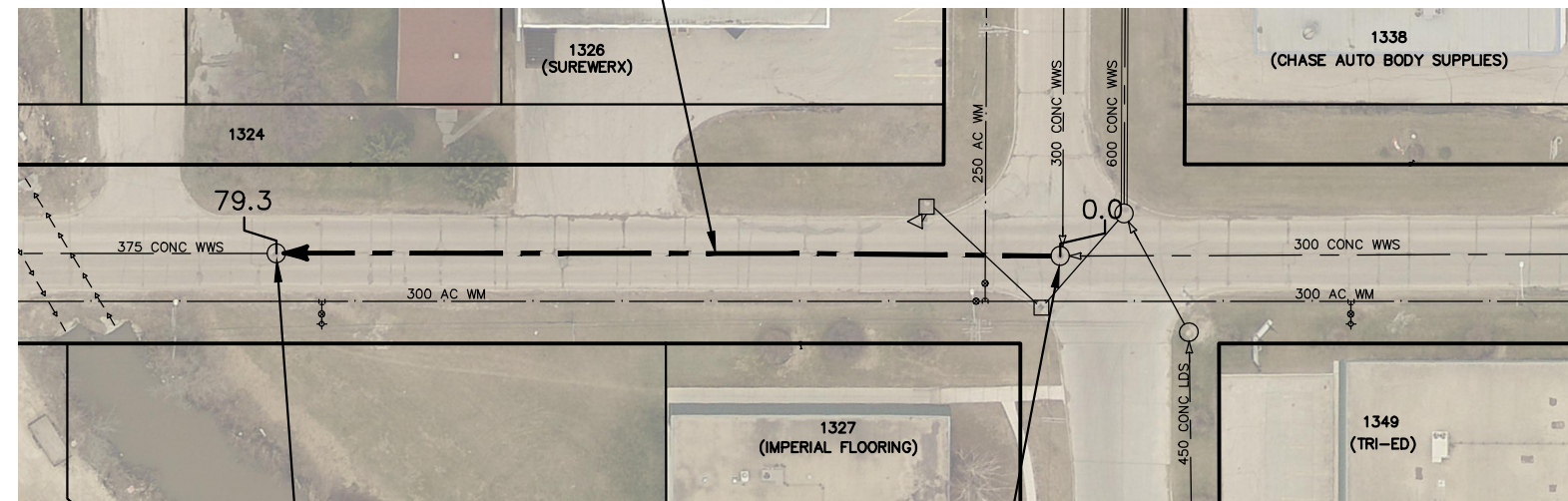

S-MH20010680  
RIM 233.99  
INV N 228.73  
INV S 228.73

S-MH20010681  
RIM 233.76  
INV N 229.03  
INV S 229.03  
INV W 230.38

POWELL AVE

SEWER JUNCTION INFORMATION FROM SEWER VIDEO INSPECTION		
SEWER ID S-MA20011735		
DISTANCE FROM MH ID S-MH20010681		
DISTANCE	DIAMETER	CLOCK
72.7	150	1

### WARNING

IF POWER EQUIPMENT OR EXPLOSIVES ARE TO BE USED FOR EXCAVATION ON THIS PROJECT THE CONTRACTOR MUST:

- 1) NOTIFY THE GAS COMPANY OF THE PROPOSED LOCATION OF EXCAVATION.
- 2) TAKE PRECAUTION TO AVOID DAMAGE TO GAS COMPANY INSTALLATIONS.

SEE PROVINCIAL REGULATION 210/72 FOR DETAILS

FOR INDEX SEE  
11987

### METRIC

WHOLE NUMBERS INDICATE MILLIMETRES  
DECIMALIZED NUMBERS INDICATE METRES

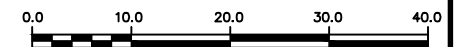

LOCATION APPROVED  
UNDERGROUND STRUCTURES

SUPV. U/G STRUCTURES COMMITTEE DATE

NOTE:

LOCATION OF UNDERGROUND STRUCTURES AS SHOWN ARE BASED ON THE BEST INFORMATION AVAILABLE BUT NO GUARANTEE IS GIVEN THAT ALL EXISTING UTILITIES ARE SHOWN OR THAT THE GIVEN LOCATIONS ARE EXACT. CONFIRMATION OF EXISTENCE AND EXACT LOCATION OF ALL SERVICES MUST BE OBTAINED FROM THE INDIVIDUAL UTILITIES BEFORE PROCEEDING WITH CONSTRUCTION.

B.M.  
ELEV.

NO.	REVISIONS	DATE	BY

DESIGNED BY	SC	CHECKED BY	SC	
DRAWN BY	AJ	APPROVED BY	KZ	
SCALE:	1:750	RELEASED FOR CONSTRUCTION	K.ZUREK	
HORIZONTAL		DATE		2019-01-23
VERTICAL	DATE	2019 01 24	DATE	2019-01-23

ENGINEER'S SEAL  
**ORIGINAL**  
SIGNED BY  
**S.R.J. COURNOYER**  
19/01/22  
CONSULTANT DRAWING NUMBER  
-



**THE CITY OF WINNIPEG**  
WATER AND WASTE DEPARTMENT  
ENGINEERING DIVISION

2018 SEWER MAIN RENEWALS  
BY CIPP LINING  
**BORDER STREET**  
MH AT POWELL AVENUE TO  
1ST MH S OF POWELL AVENUE

SHEET 10 OF 52  
CITY DRAWING NUMBER  
11995

PLOT DATE: 2019 01 24

BID OPPORTUNITY: 58-2019  
CONTRACT NUMBER: 4

FILE PATH: R:\DRAWINGS\SEWER\2018 RENEWALS\RENEWALS & ASSOCIATED WORKS\CONTRACT 4\CONSTRUCTION DWGS\  
FILE NAME: BORDER STREET.dwg