

CORAL CRESCENT (W-LEG)

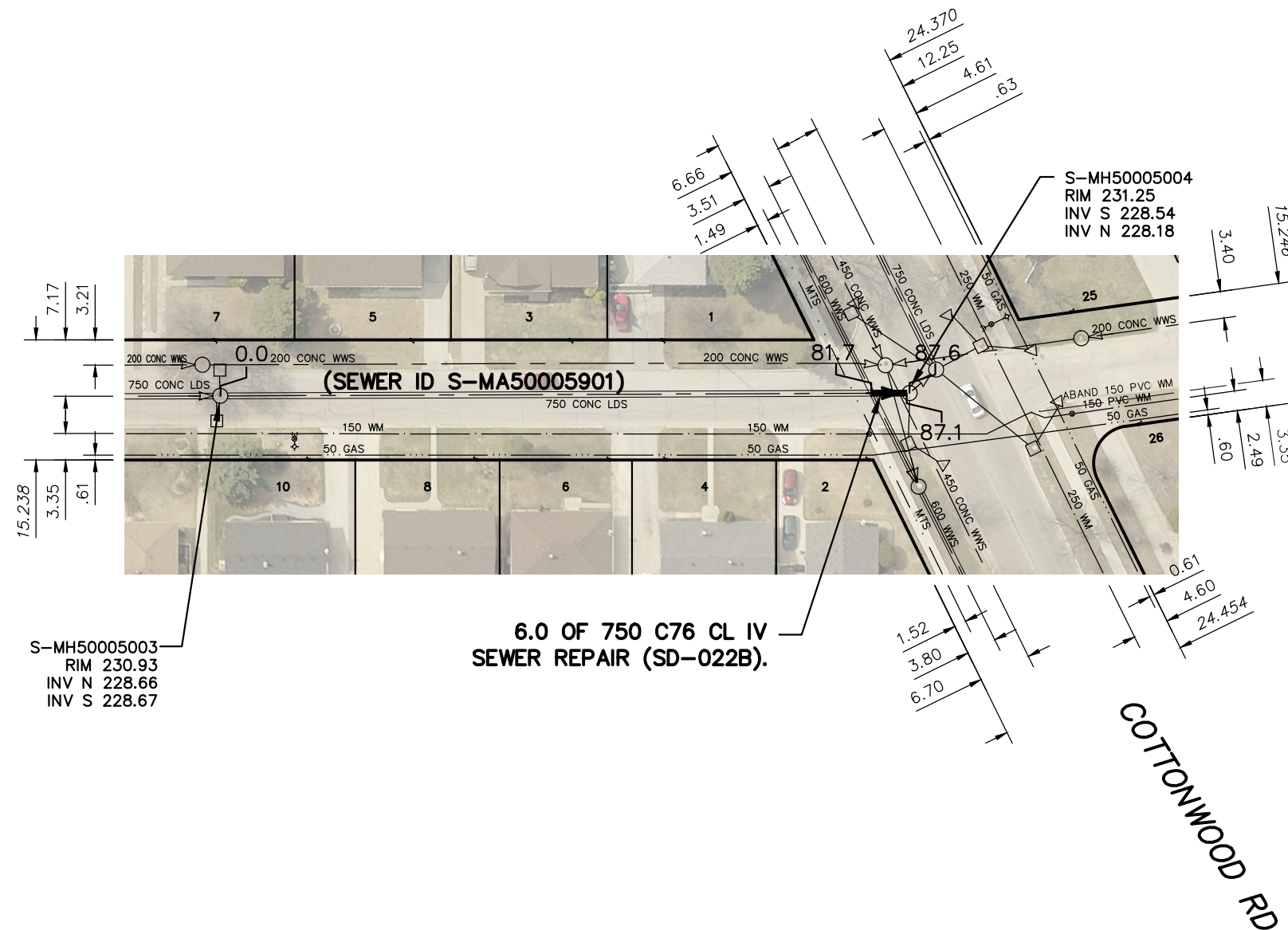

FOR INDEX SEE
12039

METRIC
WHOLE NUMBERS INDICATE MILLIMETRES
DECIMALIZED NUMBERS INDICATE METRES

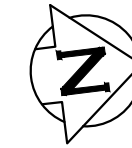

WARNING

IF POWER EQUIPMENT OR EXPLOSIVES ARE TO BE USED FOR EXCAVATION ON THIS PROJECT THE CONTRACTOR MUST:

- 1) NOTIFY THE GAS COMPANY OF THE PROPOSED LOCATION OF EXCAVATION.
- 2) TAKE PRECAUTION TO AVOID DAMAGE TO GAS COMPANY INSTALLATIONS.

SEE PROVINCIAL REGULATION 210/72 FOR DETAILS

LOCATION APPROVED UNDERGROUND STRUCTURES SUPV. U/G STRUCTURES COMMITTEE _____ DATE _____ NOTE: LOCATION OF UNDERGROUND STRUCTURES AS SHOWN ARE BASED ON THE BEST INFORMATION AVAILABLE BUT NO GUARANTEE IS GIVEN THAT ALL EXISTING UTILITIES ARE SHOWN OR THAT THE GIVEN LOCATIONS ARE EXACT. CONFIRMATION OF EXISTENCE AND EXACT LOCATION OF ALL SERVICES MUST BE OBTAINED FROM THE INDIVIDUAL UTILITIES BEFORE PROCEEDING WITH CONSTRUCTION.	B.M. ELEV.	DESIGNED BY MJK CHECKED BY SC		ENGINEER'S SEAL ORIGINAL SIGNED BY S.R.J. COURNOYER 19/01/24 CONSULTANT DRAWING NUMBER -	THE CITY OF WINNIPEG WATER AND WASTE DEPARTMENT ENGINEERING DIVISION	2018 SEWER MAIN RENEWALS BY EXTERNAL POINT REPAIR CORAL CRESCENT (W-LEG) 2ND MH N OF CORAL CRESCENT (S-LEG) TO MH AT COTTONWOOD ROAD	SHEET 7 OF 24
		DRAWN BY AJ APPROVED BY KZ					CITY DRAWING NUMBER 12044
NO. REVISIONS DATE BY		SCALE: HORIZONTAL 1:750 VERTICAL		RELEASED FOR CONSTRUCTION K.ZUREK		DATE 2019-01-25	
DATE 2019 01 25		DATE 2019-01-25		PLOT DATE: 2019 01 25		FILE PATH: R:\DRAWINGS\SEWER 2018 RENEWALS\RENEWALS & ASSOCIATED WORKS\CONTRACT 9\Construction Dwg\	