

NOTE: CHAINAGES SHOWN ARE ALONG N. P. OF POINT DOUGLAS AVE

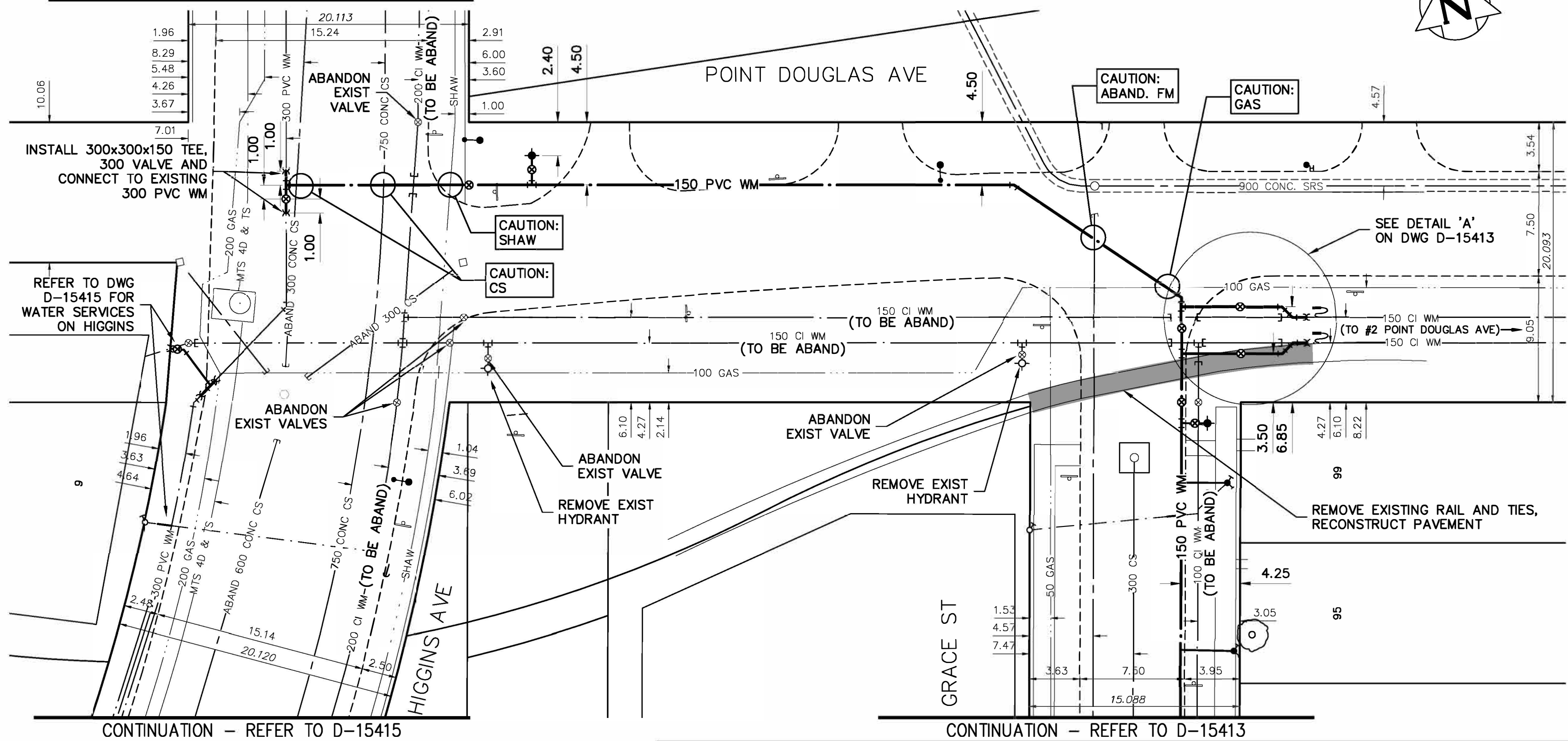

ALL VALVES TO BE COUNTER-CLOCKWISE TO CLOSE (RED OPERATING NUT)

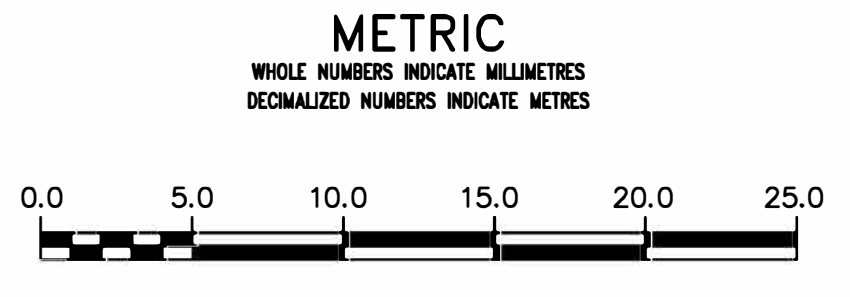

ENGINEERS
GEO-SCIENTISTS
MANITOBA
 Certificate of Authorization
 AECOM Canada Ltd.
 No. 4671 Date: 3/29/2019

REFER TO DRAWING D-15408 FOR CONSTRUCTION NOTES

WARNING
 IF POWER EQUIPMENT OR EXPLOSIVES ARE TO BE USED FOR EXCAVATION ON THIS PROJECT THE CONTRACTOR MUST:
 1) NOTIFY THE GAS COMPANY OF THE PROPOSED LOCATION OF EXCAVATION.
 2) TAKE PRECAUTION TO AVOID DAMAGE TO GAS COMPANY INSTALLATIONS.
 SEE PROVINCIAL REGULATION 210/72 FOR DETAILS

LOCATION APPROVED
 UNDERGROUND STRUCTURES
 SUPV. U/G STRUCTURES COMMITTEE DATE
 NOTE:
 LOCATION OF UNDERGROUND STRUCTURES AS SHOWN ARE BASED ON THE BEST INFORMATION AVAILABLE BUT NO GUARANTEE IS GIVEN THAT ALL EXISTING UTILITIES ARE SHOWN OR THAT THE GIVEN LOCATIONS ARE EXACT. CONFIRMATION OF EXISTENCE AND EXACT LOCATION OF ALL SERVICES MUST BE OBTAINED FROM THE INDIVIDUAL UTILITIES BEFORE PROCEEDING WITH CONSTRUCTION.

B.M. 35-017 ELEV. 230.730m	N.W. Cor. Higgins Ave. & Gomez St., Tbt. in S. Conc. foundation No. 109 Higgins Ave., 1.3 m W. & 1 m below brick of S.E. Cor. of Bldg.												
<table border="1"> <thead> <tr> <th>NO.</th> <th>REVISIONS</th> <th>DATE</th> <th>BY</th> </tr> </thead> <tbody> <tr> <td>0</td> <td>ISSUED FOR TENDER</td> <td>19/03/29</td> <td>GSK</td> </tr> <tr> <td>A</td> <td>ISSUED FOR REVIEW</td> <td>19/03/15</td> <td>GSK</td> </tr> </tbody> </table>		NO.	REVISIONS	DATE	BY	0	ISSUED FOR TENDER	19/03/29	GSK	A	ISSUED FOR REVIEW	19/03/15	GSK
NO.	REVISIONS	DATE	BY										
0	ISSUED FOR TENDER	19/03/29	GSK										
A	ISSUED FOR REVIEW	19/03/15	GSK										

		DESIGNED BY	JP	CHECKED BY	GSK
		DRAWN BY	JP	APPROVED BY	
SCALE:		HORIZONTAL		1:250	
		VERTICAL		1:50	
DATE	2019/03/15		DATE		
PLOT DATE:	2019 03 29		DATE		

ENGINEER'S SEAL

 CONSULTANT DRAWING NUMBER
C-0006

THE CITY OF WINNIPEG
 WATER AND WASTE DEPARTMENT
 ENGINEERING DIVISION
 2019 WATER MAIN RENEWALS
 CONTRACT 7
 POINT DOUGLAS AVENUE
 HIGGINS AVENUE TO
 GRACE STREET
 SHEET 8 OF 19
 CITY DRAWING NUMBER
D-15414