



# WEDGEWOOD DRIVE

84.5 OF 300 LDS TO BE LINED  
S-MA60016812

S-MH60014468  
RIM 231.83  
INV E 229.82

S-MH60014467  
RIM 231.96  
INV E 228.82

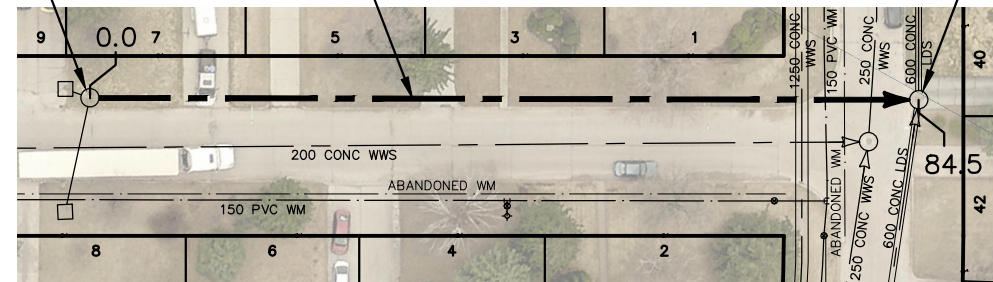

SEWER JUNCTION INFORMATION FROM SEWER VIDEO INSPECTION		
SEWER ID S-MA60016812		
DISTANCE FROM MH ID S-MH60014468		
DISTANCE	DIAMETER	CLOCK
**** NO SERVICE JUNCTIONS ****		

FOR INDEX SEE  
12125

## METRIC

WHOLE NUMBERS INDICATE MILLIMETRES  
DECIMALIZED NUMBERS INDICATE METRES

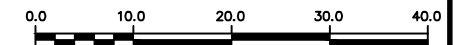

### WARNING

IF POWER EQUIPMENT OR EXPLOSIVES ARE TO BE USED FOR EXCAVATION ON THIS PROJECT THE CONTRACTOR MUST:

- 1) NOTIFY THE GAS COMPANY OF THE PROPOSED LOCATION OF EXCAVATION.
- 2) TAKE PRECAUTION TO AVOID DAMAGE TO GAS COMPANY INSTALLATIONS.

SEE PROVINCIAL REGULATION 210/72 FOR DETAILS

THATCHER DR

### LOCATION APPROVED UNDERGROUND STRUCTURES

SUPV. U/G STRUCTURES COMMITTEE DATE

NOTE:

LOCATION OF UNDERGROUND STRUCTURES AS SHOWN ARE BASED ON THE BEST INFORMATION AVAILABLE BUT NO GUARANTEE IS GIVEN THAT ALL EXISTING UTILITIES ARE SHOWN OR THAT THE GIVEN LOCATIONS ARE EXACT. CONFIRMATION OF EXISTENCE AND EXACT LOCATION OF ALL SERVICES MUST BE OBTAINED FROM THE INDIVIDUAL UTILITIES BEFORE PROCEEDING WITH CONSTRUCTION.

NO.	REVISIONS	DATE	BY

DESIGNED BY	SC	CHECKED BY	SC
DRAWN BY	BL	APPROVED BY	KZ
SCALE:	1:750	RELEASED FOR CONSTRUCTION	K.ZUREK
HORIZONTAL		DATE	2019 03 06
VERTICAL		DATE	2019 03 06

ENGINEER'S SEAL
ORIGINAL SIGNED BY S.R.J. COURNOYER 19/03/05
CONSULTANT DRAWING NUMBER -



## THE CITY OF WINNIPEG WATER AND WASTE DEPARTMENT ENGINEERING DIVISION

2018 SEWER MAIN RENEWALS  
BY CIPP LINING  
**WEDGEWOOD DRIVE**  
1ST MH W THATCHER DRIVE TO  
MH AT THATCHER DRIVE

SHEET **64** OF **69**  
CITY DRAWING NUMBER  
**12186**

PLOT DATE: 2019 03 06

BID OPPORTUNITY: 146-2019  
CONTRACT NUMBER: 3

FILE PATH: R:\DRAWINGS\SEWER\2018 RENEWALS\RENEWALS & ASSOCIATED WORKS\CONTRACT 3\CONSTRUCTION DWGS\  
FILE NAME: WEDGEWOOD DR NPL.dwg