

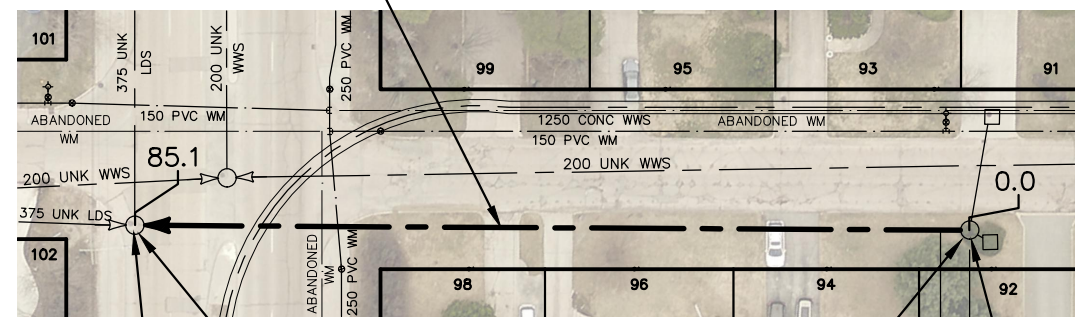

THATCHER DRIVE

85.1 OF 300 LDS TO BE LINED
S-MA60016100



SEWER JUNCTION INFORMATION FROM SEWER VIDEO INSPECTION		
SEWER ID S-MA60016100		
DISTANCE FROM MH ID S-MH60013891		
DISTANCE	DIAMETER	CLOCK
61.9	150	10
67.2	150	2

UNIVERSITY CRES

S-MH60013858
RIM 232.48
INV E 229.31
INV W 229.34
INV N 229.24

S-MH60013891
RIM 232.20
INV W 229.46

GROUT TOP RISER
(TO BE DONE BY OTHERS)

GROUT CRACKS UNDER FRAME
(TO BE DONE BY OTHERS)

FOR INDEX SEE
12125

METRIC

WHOLE NUMBERS INDICATE MILLIMETRES
DECIMALIZED NUMBERS INDICATE METRES

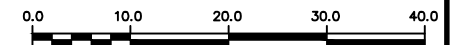

WARNING

IF POWER EQUIPMENT OR EXPLOSIVES ARE TO BE USED FOR EXCAVATION ON THIS PROJECT THE CONTRACTOR MUST:

- 1) NOTIFY THE GAS COMPANY OF THE PROPOSED LOCATION OF EXCAVATION.
- 2) TAKE PRECAUTION TO AVOID DAMAGE TO GAS COMPANY INSTALLATIONS.

SEE PROVINCIAL REGULATION 210/72 FOR DETAILS

LOCATION APPROVED
UNDERGROUND STRUCTURES

SUPV. U/G STRUCTURES COMMITTEE DATE

NOTE:

LOCATION OF UNDERGROUND STRUCTURES AS SHOWN ARE BASED ON THE BEST INFORMATION AVAILABLE BUT NO GUARANTEE IS GIVEN THAT ALL EXISTING UTILITIES ARE SHOWN OR THAT THE GIVEN LOCATIONS ARE EXACT. CONFIRMATION OF EXISTENCE AND EXACT LOCATION OF ALL SERVICES MUST BE OBTAINED FROM THE INDIVIDUAL UTILITIES BEFORE PROCEEDING WITH CONSTRUCTION.

B.M. ELEV.	NO.	REVISIONS	DATE	BY

DESIGNED BY	SC	CHECKED BY	SC
DRAWN BY	BL	APPROVED BY	KZ
SCALE:	1:750	RELEASED FOR CONSTRUCTION	K.ZUREK
HORIZONTAL		DATE	2019 03 06
VERTICAL		DATE	2019 03 06

ENGINEER'S SEAL

ORIGINAL
SIGNED BY
S.R.J.
COURNOYER
19/03/05

CONSULTANT DRAWING NUMBER

BID OPPORTUNITY: 146-2019
CONTRACT NUMBER: 3



THE CITY OF WINNIPEG
WATER AND WASTE DEPARTMENT
ENGINEERING DIVISION

2018 SEWER MAIN RENEWALS
BY CIPP LINING

THATCHER DRIVE

1ST MH E OF UNIVERSITY CRESCENT TO
MH AT UNIVERSITY CRESCENT (W OF C)

SHEET 59 OF 69

CITY DRAWING NUMBER

12181

FILE PATH: R:\DRAWINGS\SEWER\2018 RENEWALS\RENEWALS & ASSOCIATED WORKS\CONTRACT 3\CONSTRUCTION DWGS\
FILE NAME: THATCHER DR (S PL)(W OF CL).dwg