

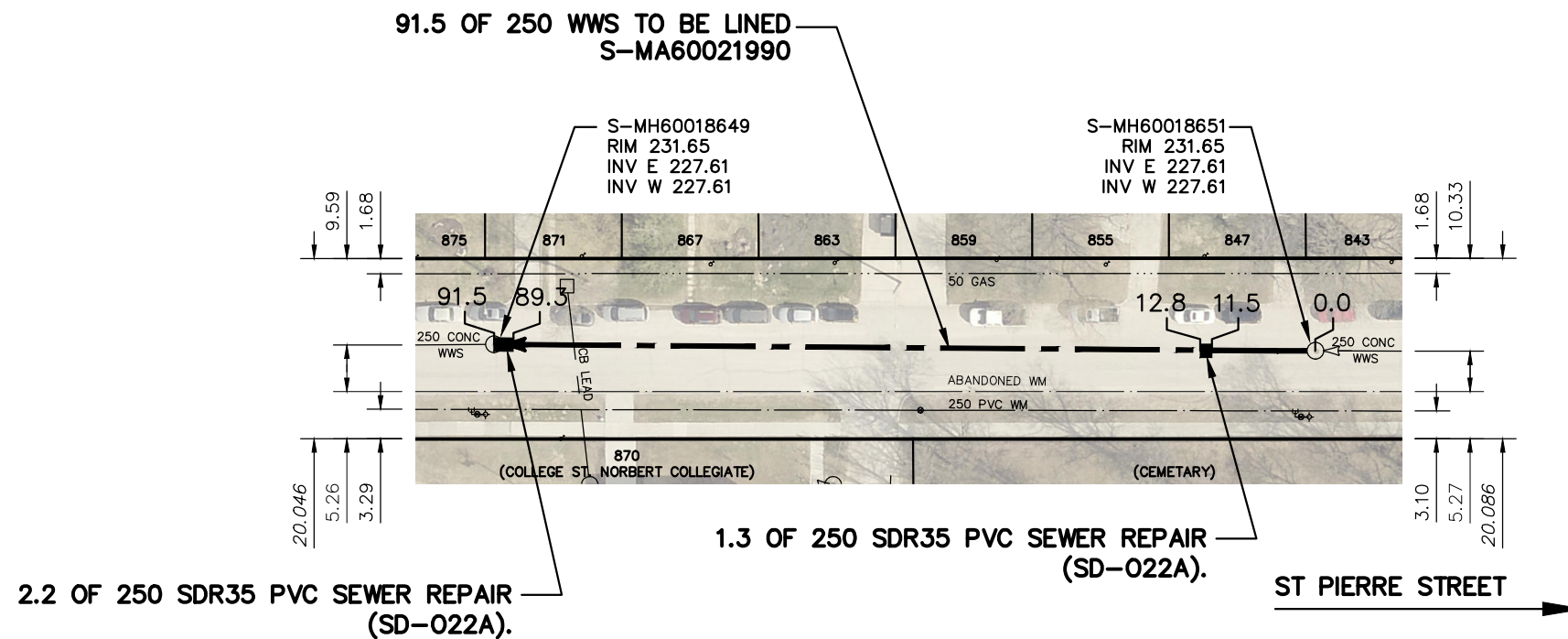

ST THERESE AVENUE



SEWER JUNCTION INFORMATION FROM SEWER VIDEO INSPECTION		
SEWER ID S-MA60021990		
DISTANCE FROM MH ID S-MH60018651		
DISTANCE	DIAMETER	CLOCK
10.5	100	12
23.9	100	2
25.2	100	12
37.7	100	12
53.5	100	2
68.0	100	12
69.0	100	10
80.9	100	10
84.6	100	10

WARNING

IF POWER EQUIPMENT OR EXPLOSIVES ARE TO BE USED FOR EXCAVATION ON THIS PROJECT THE CONTRACTOR MUST:

- 1) NOTIFY THE GAS COMPANY OF THE PROPOSED LOCATION OF EXCAVATION.
- 2) TAKE PRECAUTION TO AVOID DAMAGE TO GAS COMPANY INSTALLATIONS.

SEE PROVINCIAL REGULATION 210/72 FOR DETAILS

FOR INDEX SEE
12125

METRIC

WHOLE NUMBERS INDICATE MILLIMETRES
DECIMALIZED NUMBERS INDICATE METRES

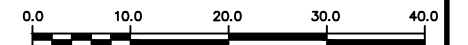

LOCATION APPROVED UNDERGROUND STRUCTURES

SUPV. U/G STRUCTURES COMMITTEE DATE

NOTE:

LOCATION OF UNDERGROUND STRUCTURES AS SHOWN ARE BASED ON THE BEST INFORMATION AVAILABLE BUT NO GUARANTEE IS GIVEN THAT ALL EXISTING UTILITIES ARE SHOWN OR THAT THE GIVEN LOCATIONS ARE EXACT. CONFIRMATION OF EXISTENCE AND EXACT LOCATION OF ALL SERVICES MUST BE OBTAINED FROM THE INDIVIDUAL UTILITIES BEFORE PROCEEDING WITH CONSTRUCTION.

NO.	REVISIONS	DATE	BY

DESIGNED BY	SC	CHECKED BY	SC
DRAWN BY	BL	APPROVED BY	KZ
SCALE:		RELEASED FOR CONSTRUCTION	
HORIZONTAL	1:750	K.ZUREK	
VERTICAL			
DATE	2019 03 06	DATE	2019 03 06

ENGINEER'S SEAL

ORIGINAL
SIGNED BY
S.R.J.
COURNOYER
19/03/05

CONSULTANT DRAWING NUMBER

BID OPPORTUNITY: 146-2019
CONTRACT NUMBER: 3



THE CITY OF WINNIPEG WATER AND WASTE DEPARTMENT ENGINEERING DIVISION

2018 SEWER MAIN RENEWALS
BY AUGMENTATION
ST THERESE AVENUE
2ND MH W OF ST PIERRE STREET TO
3RD MH W OF ST PIERRE STREET

SHEET 56 OF 69
CITY DRAWING NUMBER

12178

FILE PATH: R:\DRAWINGS\SEWER\2018 RENEWALS\RENEWALS & ASSOCIATED WORKS\CONTRACT 3\CONSTRUCTION DWGS\
FILE NAME: ST THERESE AV.dwg