

SANDRA BAY

63.1 OF 200 WWS TO BE LINED
S-MA60017579

SANDRA BAY
(N-LEG)

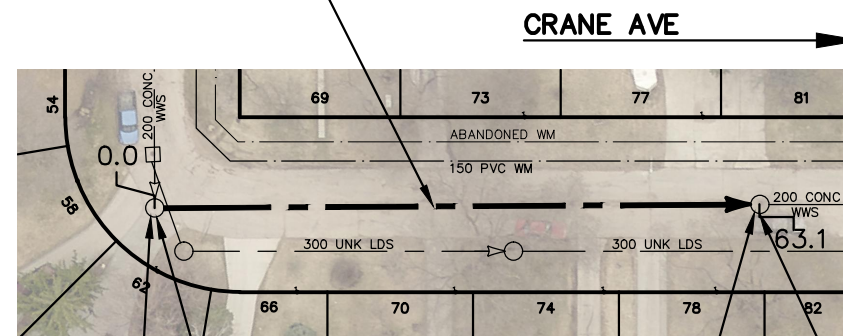

S-MH60015193
RIM 231.78
INV E 228.56
INV S 230.48

S-MH60015195
RIM 231.67
INV S 230.30
INV N 230.30

GROUT RISER 0.3-1.5, REPLACE BENCHING
(TO BE DONE BY OTHERS)

GROUT RISER 0.3-2.4
(TO BE DONE BY OTHERS)

SEWER JUNCTION INFORMATION FROM SEWER VIDEO INSPECTION		
SEWER ID S-MA60017579		
DISTANCE FROM MH ID S-MH60015193		
DISTANCE	DIAMETER	CLOCK
3.6	150	2
18.4	150	1
31.5	150	2
41.4	150	10
44.5	150	10
60.9	150	2
61.5	150	10

FOR INDEX SEE
12125

METRIC

WHOLE NUMBERS INDICATE MILLIMETRES
DECIMALIZED NUMBERS INDICATE METRES

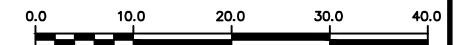

WARNING

IF POWER EQUIPMENT OR EXPLOSIVES ARE TO BE USED FOR EXCAVATION ON THIS PROJECT THE CONTRACTOR MUST:

- 1) NOTIFY THE GAS COMPANY OF THE PROPOSED LOCATION OF EXCAVATION.
- 2) TAKE PRECAUTION TO AVOID DAMAGE TO GAS COMPANY INSTALLATIONS.

SEE PROVINCIAL REGULATION 210/72 FOR DETAILS

LOCATION APPROVED UNDERGROUND STRUCTURES

SUPV. U/G STRUCTURES COMMITTEE DATE

NOTE:

LOCATION OF UNDERGROUND STRUCTURES AS SHOWN ARE BASED ON THE BEST INFORMATION AVAILABLE BUT NO GUARANTEE IS GIVEN THAT ALL EXISTING UTILITIES ARE SHOWN OR THAT THE GIVEN LOCATIONS ARE EXACT. CONFIRMATION OF EXISTENCE AND EXACT LOCATION OF ALL SERVICES MUST BE OBTAINED FROM THE INDIVIDUAL UTILITIES BEFORE PROCEEDING WITH CONSTRUCTION.

B.M. ELEV.

NO.	REVISIONS	DATE	BY

DESIGNED BY	SC	CHECKED BY	SC
DRAWN BY	BL	APPROVED BY	KZ
SCALE:	1:750	RELEASED FOR CONSTRUCTION	K.ZUREK
HORIZONTAL		DATE	2019 03 06
VERTICAL		DATE	2019 03 06

ENGINEER'S SEAL

ORIGINAL SIGNED BY
S.R.J. COURNOYER
19/03/05

CONSULTANT DRAWING NUMBER

BID OPPORTUNITY: 146-2019
CONTRACT NUMBER: 3



THE CITY OF WINNIPEG WATER AND WASTE DEPARTMENT ENGINEERING DIVISION

2018 SEWER MAIN RENEWALS
BY CIPP LINING

SANDRA BAY
MH AT SANDRA BAY (N-LEG) TO
1ST MH N OF CRANE AVENUE

SHEET 52 OF 69

CITY DRAWING NUMBER

12174

FILE PATH: R:\DRAWINGS\SEWER\2018 RENEWALS\RENEWALS & ASSOCIATED WORKS\CONTRACT 3\CONSTRUCTION DWGS\
FILE NAME: SANDRA BAY.dwg