

EVENWOOD CRESCENT

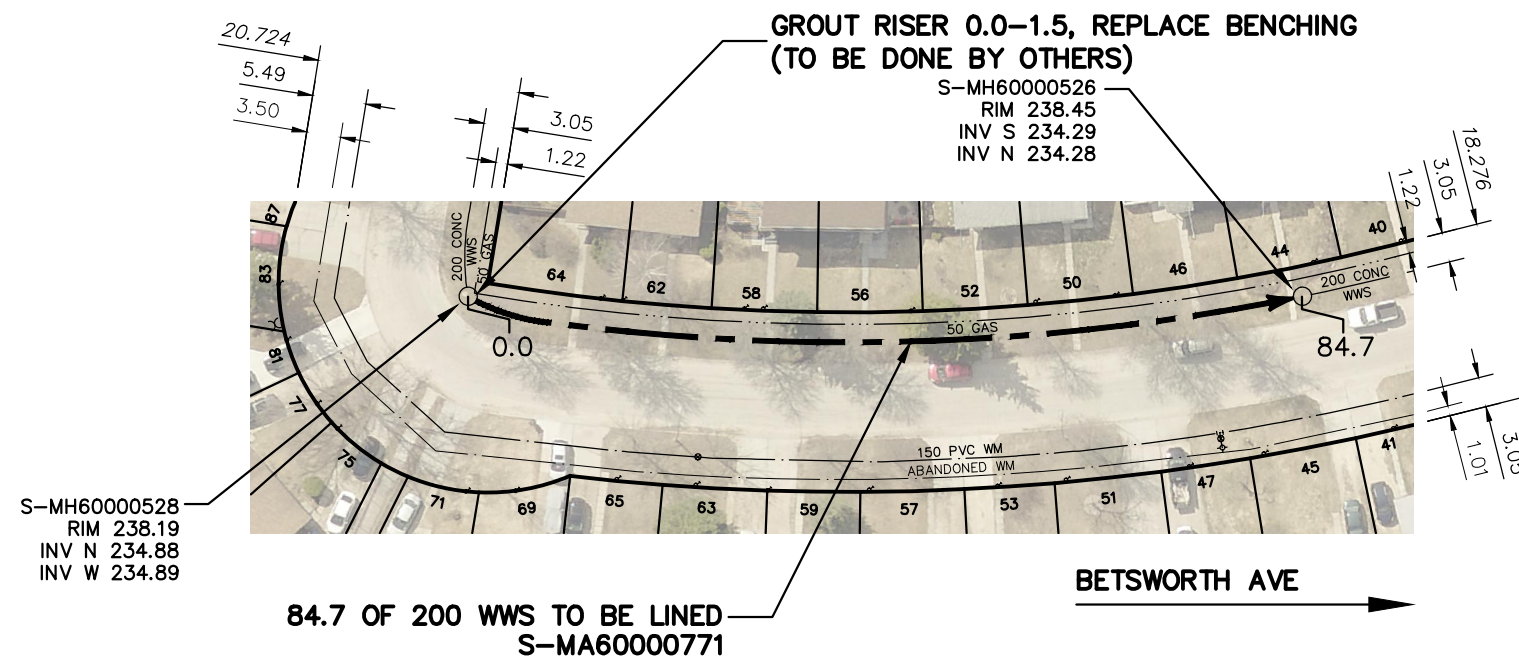

SEWER JUNCTION INFORMATION FROM SEWER VIDEO INSPECTION		
SEWER ID S-MA60000771		
DISTANCE FROM MH ID S-MH60000528		
DISTANCE	DIAMETER	CLOCK
3.2	150	2
4.0	150	2
6.3	150	1
11.6	100	11
13.7	150	12
14.4	150	9
28.1	100	3
35.7	150	3
37.1	150	10
46.3	150	2
47.8	150	11
55.5	150	11
56.9	150	9
60.5	150	10
68.0	150	11
69.1	150	2
75.4	150	2

FOR INDEX SEE
12124

METRIC

WHOLE NUMBERS INDICATE MILLIMETRES
DECIMALIZED NUMBERS INDICATE METRES

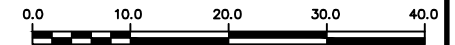

WARNING

IF POWER EQUIPMENT OR EXPLOSIVES ARE TO BE USED FOR EXCAVATION ON THIS PROJECT THE CONTRACTOR MUST:

- 1) NOTIFY THE GAS COMPANY OF THE PROPOSED LOCATION OF EXCAVATION.
- 2) TAKE PRECAUTION TO AVOID DAMAGE TO GAS COMPANY INSTALLATIONS.

SEE PROVINCIAL REGULATION 210/72 FOR DETAILS

LOCATION APPROVED UNDERGROUND STRUCTURES

SUPV. U/G STRUCTURES COMMITTEE DATE

NOTE:

LOCATION OF UNDERGROUND STRUCTURES AS SHOWN ARE BASED ON THE BEST INFORMATION AVAILABLE BUT NO GUARANTEE IS GIVEN THAT ALL EXISTING UTILITIES ARE SHOWN OR THAT THE GIVEN LOCATIONS ARE EXACT. CONFIRMATION OF EXISTENCE AND EXACT LOCATION OF ALL SERVICES MUST BE OBTAINED FROM THE INDIVIDUAL UTILITIES BEFORE PROCEEDING WITH CONSTRUCTION.

B.M. ELEV.	NO.	REVISIONS	DATE	BY

DESIGNED BY	SC	CHECKED BY	SC
DRAWN BY	BL	APPROVED BY	KZ
SCALE:	1:750	RELEASED FOR CONSTRUCTION	K.ZUREK
HORIZONTAL		DATE	2019 03 06
VERTICAL		DATE	2019 03 06

ENGINEER'S SEAL
ORIGINAL SIGNED BY S.R.J. COURNOYER 19/03/05
CONSULTANT DRAWING NUMBER: -

THE CITY OF WINNIPEG
WATER AND WASTE DEPARTMENT
ENGINEERING DIVISION

2018 SEWER MAIN RENEWALS
BY CIPP LINING
EVENWOOD CRESCENT
3RD MH S OF BETSWORTH AVENUE TO
2ND MH S BETSWORTH AVENUE

SHEET **25** OF **69**
CITY DRAWING NUMBER
12147

PLOT DATE: 2019 03 06

BID OPPORTUNITY: 146-2019
CONTRACT NUMBER: 3

FILE PATH: R:\DRAWINGS\SEWER\2018 RENEWALS\RENEWALS & ASSOCIATED WORKS\CONTRACT 3\CONSTRUCTION DWGS\
FILE NAME: EVENWOOD CR.dwg