

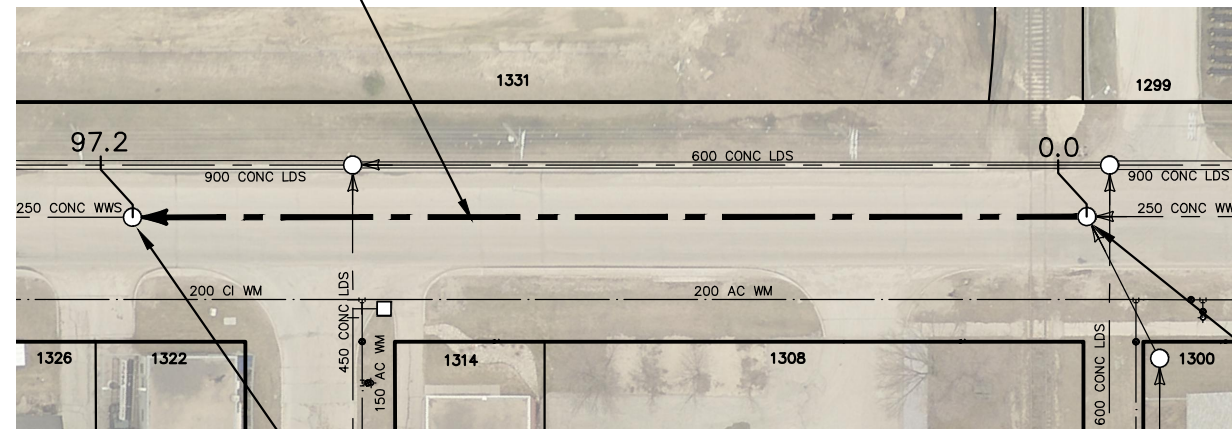

# CHEVRIER BOULEVARD

97.2 OF 250 WWS TO BE LINED  
S-MA60017939



S-MH60015531  
RIM 231.92  
INV E  
INV W

S-MH60015540  
RIM 232.68  
INV E 219.26  
INV E 228.51  
INV W

TROTIER BY

SEWER JUNCTION INFORMATION FROM SEWER VIDEO INSPECTION SEWER ID S-MA60017939		
DISTANCE FROM MH ID S-MH60015540		
DISTANCE	DIAMETER	CLOCK
12.6	100	2
12.7	100	11
60.6	100	10
89.8	100	10

FOR INDEX SEE  
12124

**METRIC**

WHOLE NUMBERS INDICATE MILLIMETRES  
DECIMALIZED NUMBERS INDICATE METRES



**WARNING**

IF POWER EQUIPMENT OR EXPLOSIVES ARE TO BE USED FOR EXCAVATION ON THIS PROJECT THE CONTRACTOR MUST:

- 1) NOTIFY THE GAS COMPANY OF THE PROPOSED LOCATION OF EXCAVATION.
- 2) TAKE PRECAUTION TO AVOID DAMAGE TO GAS COMPANY INSTALLATIONS.

SEE PROVINCIAL REGULATION 210/72 FOR DETAILS

<p>LOCATION APPROVED UNDERGROUND STRUCTURES</p> <p>SUPV. U/G STRUCTURES COMMITTEE _____ DATE _____</p> <p>NOTE: LOCATION OF UNDERGROUND STRUCTURES AS SHOWN ARE BASED ON THE BEST INFORMATION AVAILABLE BUT NO GUARANTEE IS GIVEN THAT ALL EXISTING UTILITIES ARE SHOWN OR THAT THE GIVEN LOCATIONS ARE EXACT. CONFIRMATION OF EXISTENCE AND EXACT LOCATION OF ALL SERVICES MUST BE OBTAINED FROM THE INDIVIDUAL UTILITIES BEFORE PROCEEDING WITH CONSTRUCTION.</p>	<p>B.M. ELEV.</p> <table border="1" style="width: 100%; height: 100px;"> <tr><td> </td><td> </td><td> </td><td> </td></tr> <tr><td> </td><td> </td><td> </td><td> </td></tr> <tr><td> </td><td> </td><td> </td><td> </td></tr> <tr><td> </td><td> </td><td> </td><td> </td></tr> <tr><td> </td><td> </td><td> </td><td> </td></tr> <tr><td> </td><td> </td><td> </td><td> </td></tr> <tr><td> </td><td> </td><td> </td><td> </td></tr> <tr><td> </td><td> </td><td> </td><td> </td></tr> <tr><td> </td><td> </td><td> </td><td> </td></tr> <tr><td> </td><td> </td><td> </td><td> </td></tr> <tr><td> </td><td> </td><td> </td><td> </td></tr> </table>																																													<table border="1" style="width: 100%;"> <tr> <td>DESIGNED BY</td> <td>SC</td> <td>CHECKED BY</td> <td>SC</td> </tr> <tr> <td>DRAWN BY</td> <td>BL</td> <td>APPROVED BY</td> <td>KZ</td> </tr> <tr> <td>SCALE:</td> <td colspan="3">HORIZONTAL 1:750 VERTICAL</td> </tr> <tr> <td>RELEASED FOR CONSTRUCTION</td> <td colspan="3" style="text-align: center;"><b>K.ZUREK</b></td> </tr> <tr> <td>DATE</td> <td>2019 03 06</td> <td>DATE</td> <td>2019 03 06</td> </tr> </table>	DESIGNED BY	SC	CHECKED BY	SC	DRAWN BY	BL	APPROVED BY	KZ	SCALE:	HORIZONTAL 1:750 VERTICAL			RELEASED FOR CONSTRUCTION	<b>K.ZUREK</b>			DATE	2019 03 06	DATE	2019 03 06	<p>ENGINEER'S SEAL</p> <p style="text-align: center;"><b>ORIGINAL SIGNED BY S.R.J. COURNOYER 19/03/05</b></p> <p>CONSULTANT DRAWING NUMBER -</p>	<p><b>THE CITY OF WINNIPEG</b> WATER AND WASTE DEPARTMENT ENGINEERING DIVISION</p> <p>2018 SEWER MAIN RENEWALS BY CIPP LINING <b>CHEVRIER BOULEVARD</b> 1ST MH SW OF TROTIER BAY (E-LEG) TO 1ST MH NE OF TROTIER BAY (E-LEG)</p>	<p>SHEET <b>15</b> OF <b>69</b></p> <p>CITY DRAWING NUMBER <b>12137</b></p>
DESIGNED BY	SC	CHECKED BY	SC																																																																		
DRAWN BY	BL	APPROVED BY	KZ																																																																		
SCALE:	HORIZONTAL 1:750 VERTICAL																																																																				
RELEASED FOR CONSTRUCTION	<b>K.ZUREK</b>																																																																				
DATE	2019 03 06	DATE	2019 03 06																																																																		

PLOT DATE: 2019 03 06

BID OPPORTUNITY: 146-2019  
CONTRACT NUMBER: 3

FILE PATH: R:\DRAWINGS\SEWER\2018 RENEWALS\RENEWALS & ASSOCIATED WORKS\CONTRACT 3\CONSTRUCTION DWGS\  
FILE NAME: CHEVRIER BV - TROTIER.dwg