

BRIAR CLIFF BAY (W-LEG)

16.9 OF 200 WWS TO BE LINED
S-MA60019678

KILLARNEY AVE

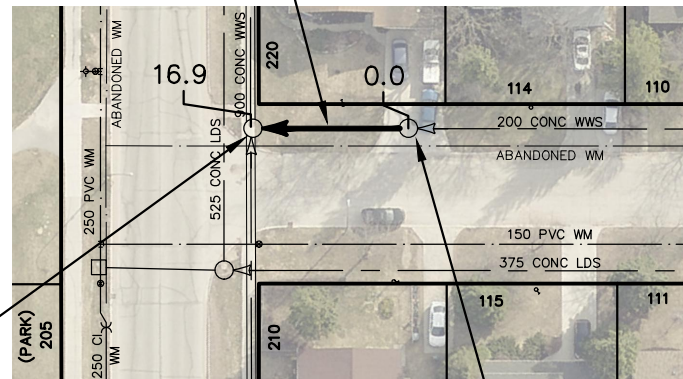

S-MH60017080
RIM 232.50
INV E 225.21
INV S 225.90
INV W 225.19

S-MH60017081
RIM 232.54
INV S 229.07
INV N 229.07

SEWER JUNCTION INFORMATION FROM SEWER VIDEO INSPECTION		
SEWER ID S-MA60019678		
DISTANCE FROM MH ID S-MH60017081		
DISTANCE	DIAMETER	CLOCK
6.8	100	10
7.2	100	2

FOR INDEX SEE
12124

METRIC

WHOLE NUMBERS INDICATE MILLIMETRES
DECIMALIZED NUMBERS INDICATE METRES

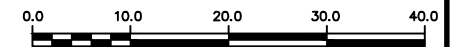

WARNING

IF POWER EQUIPMENT OR EXPLOSIVES ARE TO BE USED FOR EXCAVATION ON THIS PROJECT THE CONTRACTOR MUST:

- 1) NOTIFY THE GAS COMPANY OF THE PROPOSED LOCATION OF EXCAVATION.
- 2) TAKE PRECAUTION TO AVOID DAMAGE TO GAS COMPANY INSTALLATIONS.

SEE PROVINCIAL REGULATION 210/72 FOR DETAILS

LOCATION APPROVED
UNDERGROUND STRUCTURES

SUPV. U/G STRUCTURES COMMITTEE DATE

NOTE:

LOCATION OF UNDERGROUND STRUCTURES AS SHOWN ARE BASED ON THE BEST INFORMATION AVAILABLE BUT NO GUARANTEE IS GIVEN THAT ALL EXISTING UTILITIES ARE SHOWN OR THAT THE GIVEN LOCATIONS ARE EXACT. CONFIRMATION OF EXISTENCE AND EXACT LOCATION OF ALL SERVICES MUST BE OBTAINED FROM THE INDIVIDUAL UTILITIES BEFORE PROCEEDING WITH CONSTRUCTION.

B.M.
ELEV.

NO.	REVISIONS	DATE	BY

DESIGNED BY	SC	CHECKED BY	SC
DRAWN BY	BL	APPROVED BY	KZ
SCALE:	1:750	RELEASED FOR CONSTRUCTION	K.ZUREK
HORIZONTAL		DATE	2019 03 06
VERTICAL		DATE	2019 03 06

ENGINEER'S SEAL

ORIGINAL
SIGNED BY
S.R.J.
COURNOYER
19/03/05

CONSULTANT DRAWING NUMBER

-



THE CITY OF WINNIPEG
WATER AND WASTE DEPARTMENT
ENGINEERING DIVISION

2018 SEWER MAIN RENEWALS
BY CIPP LINING

BRIAR CLIFF BAY
1ST MH S OF KILLARNEY AVENUE TO
MH AT KILLARNEY AVENUE

SHEET 10 OF 72

CITY DRAWING NUMBER

12132

PLOT DATE: 2019 03 06

BID OPPORTUNITY: 146-2019
CONTRACT NUMBER: 3

FILE PATH: R:\DRAWINGS\SEWER\2018 RENEWALS\RENEWALS & ASSOCIATED WORKS\CONTRACT 3\CONSTRUCTION DWGS\
FILE NAME: BRIAR CLIFF BAY (W LEG).dwg