

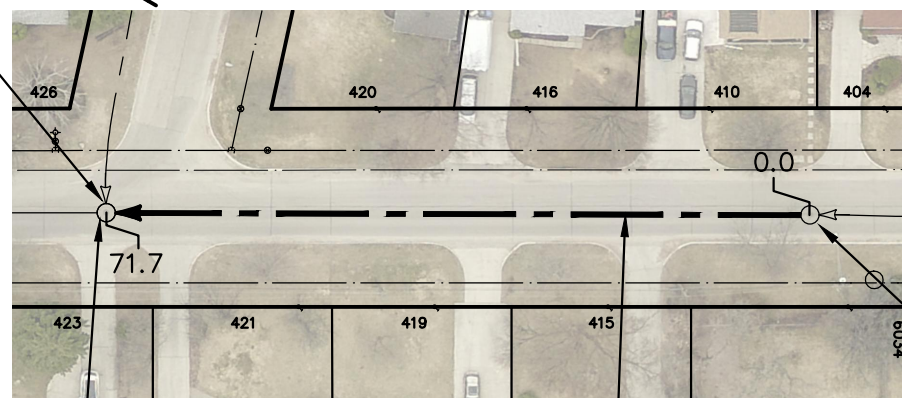

KINKORA DR BERKLEY STREET

S-MH60001049
RIM 235.91
INV N 232.45
INV S 232.45
INV W 232.49



S-MH60001045
RIM 236.95
INV N 232.73
INV S 232.69

71.7 OF 200 WWS TO BE LINED
S-MA60001419

GROUT RISER Ⓞ 0.3.
(TO BE DONE BY OTHERS)

| SEWER JUNCTION INFORMATION FROM SEWER VIDEO INSPECTION SEWER ID S-MA60001419 | | |
|--|----------|-------|
| DISTANCE FROM MH ID S-MH60001045 | | |
| DISTANCE | DIAMETER | CLOCK |
| 1.3 | 150 | 12 |
| 9.1 | 150 | 2 |
| 22.7 | 150 | 9 |
| 26.5 | 150 | 2 |
| 41.7 | 150 | 10 |
| 44.3 | 150 | 12 |
| 45.0 | 150 | 1 |
| 56.6 | 150 | 10 |

FOR INDEX SEE
12124

METRIC

WHOLE NUMBERS INDICATE MILLIMETRES
DECIMALIZED NUMBERS INDICATE METRES

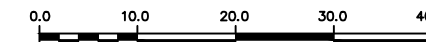

WARNING

IF POWER EQUIPMENT OR EXPLOSIVES
ARE TO BE USED FOR EXCAVATION ON
THIS PROJECT THE CONTRACTOR MUST:

- 1) NOTIFY THE GAS COMPANY OF THE
PROPOSED LOCATION OF EXCAVATION.
- 2) TAKE PRECAUTION TO AVOID DAMAGE
TO GAS COMPANY INSTALLATIONS.

SEE PROVINCIAL REGULATION 210/72 FOR DETAILS

LOCATION APPROVED
UNDERGROUND STRUCTURES

SUPV. U/G STRUCTURES COMMITTEE DATE

NOTE:

LOCATION OF UNDERGROUND STRUCTURES AS
SHOWN ARE BASED ON THE BEST INFORMATION
AVAILABLE BUT NO GUARANTEE IS GIVEN THAT ALL
EXISTING UTILITIES ARE SHOWN OR THAT THE GIVEN
LOCATIONS ARE EXACT. CONFIRMATION OF
EXISTENCE AND EXACT LOCATION OF ALL
SERVICES MUST BE OBTAINED FROM THE INDIVIDUAL
UTILITIES BEFORE PROCEEDING WITH CONSTRUCTION.

B.M.
ELEV.

| NO. | REVISIONS | DATE | BY |
|-----|-----------|------|----|
| | | | |
| | | | |
| | | | |
| | | | |
| | | | |
| | | | |

| | | | |
|-------------|-------|---------------------------|------------|
| DESIGNED BY | SC | CHECKED BY | SC |
| DRAWN BY | BL | APPROVED BY | KZ |
| SCALE: | 1:750 | RELEASED FOR CONSTRUCTION | K.ZUREK |
| HORIZONTAL | | DATE | 2019 03 06 |
| VERTICAL | | DATE | 2019 03 06 |

ENGINEER'S SEAL

ORIGINAL
SIGNED BY
S.R.J.
COURNOYER
19/03/05

CONSULTANT DRAWING NUMBER

BID OPPORTUNITY: 146-2019
CONTRACT NUMBER: 3



THE CITY OF WINNIPEG
WATER AND WASTE DEPARTMENT
ENGINEERING DIVISION

2018 SEWER MAIN RENEWALS
BY CIPP LINING
BERKLEY STREET
1ST MH N OF KINKORA DRIVE TO
MH AT KINKORA DRIVE

SHEET 9 OF 69

CITY DRAWING NUMBER

12131

FILE PATH: R:\DRAWINGS\SEWER\2018 RENEWALS\RENEWALS & ASSOCIATED WORKS\CONTRACT 3\CONSTRUCTION DWGS\
FILE NAME: BERKELY ST N.dwg