

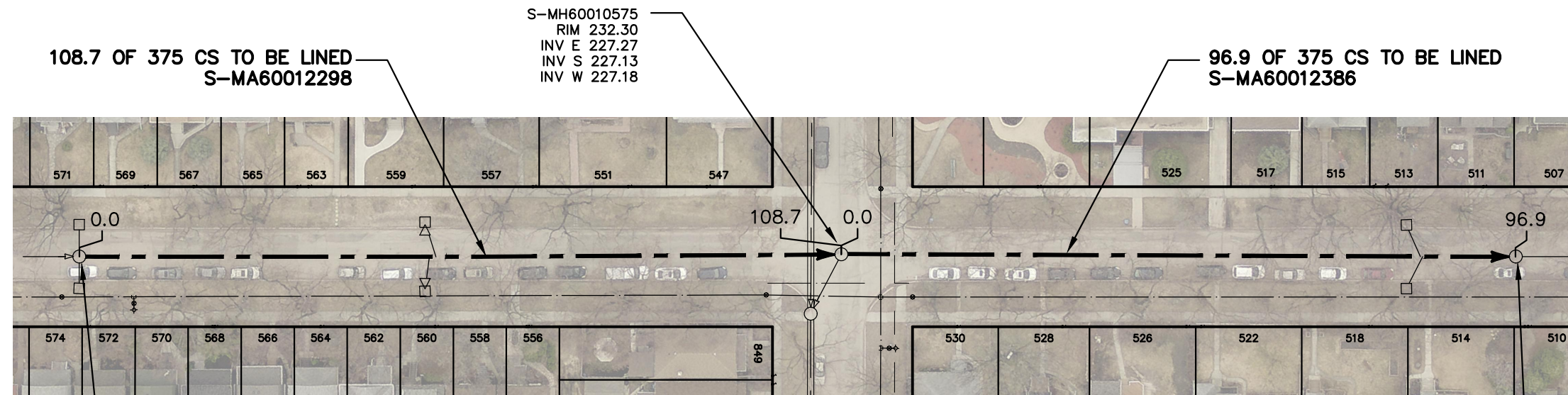

BERESFORD AVENUE



108.7 OF 375 CS TO BE LINED
S-MA60012298

S-MH60010575
RIM 232.30
INV E 227.27
INV S 227.13
INV W 227.18

96.9 OF 375 CS TO BE LINED
S-MA60012386

S-MH60010498
RIM 231.76
INV E 227.54
INV W 227.54

S-MH60010573
RIM 231.92
INV E 226.88
INV W 226.88

SEWER JUNCTION INFORMATION FROM SEWER VIDEO INSPECTION SEWER ID S-MA60012298		
DISTANCE FROM MH ID S-MH60010498		
DISTANCE	DIAMETER	CLOCK
6.0	150	1
7.0	150	10
21.6	150	1
36.8	150	2
50.6	250	12
51.7	250	12
53.3	150	2
53.9	150	11
67.0	150	11
68.5	150	2
82.8	150	10
98.5	150	2
99.2	150	11

NASSAU ST S

SEWER JUNCTION INFORMATION FROM SEWER VIDEO INSPECTION SEWER ID S-MA60012386		
DISTANCE FROM MH ID S-MH60010575		
DISTANCE	DIAMETER	CLOCK
20.2	150	1
29.8	150	10
37.9	150	10
50.6	150	2
79.8	150	11
80.5	150	1
81.8	250	12
82.5	250	12
94.1	150	2
94.3	150	11

FOR INDEX SEE
12124

METRIC

WHOLE NUMBERS INDICATE MILLIMETRES
DECIMALIZED NUMBERS INDICATE METRES

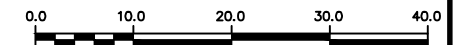

WARNING

IF POWER EQUIPMENT OR EXPLOSIVES ARE TO BE USED FOR EXCAVATION ON THIS PROJECT THE CONTRACTOR MUST:

- 1) NOTIFY THE GAS COMPANY OF THE PROPOSED LOCATION OF EXCAVATION.
- 2) TAKE PRECAUTION TO AVOID DAMAGE TO GAS COMPANY INSTALLATIONS.

SEE PROVINCIAL REGULATION 210/72 FOR DETAILS

<p>LOCATION APPROVED UNDERGROUND STRUCTURES</p> <p>SUPV. U/G STRUCTURES COMMITTEE _____ DATE _____</p> <p>NOTE: LOCATION OF UNDERGROUND STRUCTURES AS SHOWN ARE BASED ON THE BEST INFORMATION AVAILABLE BUT NO GUARANTEE IS GIVEN THAT ALL EXISTING UTILITIES ARE SHOWN OR THAT THE GIVEN LOCATIONS ARE EXACT. CONFIRMATION OF EXISTENCE AND EXACT LOCATION OF ALL SERVICES MUST BE OBTAINED FROM THE INDIVIDUAL UTILITIES BEFORE PROCEEDING WITH CONSTRUCTION.</p>	<p>B.M. ELEV.</p> <table border="1" style="width: 100%; height: 40px;"> <tr><td> </td><td> </td><td> </td><td> </td></tr> </table>					<table border="1" style="width: 100%;"> <tr> <td>DESIGNED BY</td> <td>SC</td> <td>CHECKED BY</td> <td>SC</td> </tr> <tr> <td>DRAWN BY</td> <td>BL</td> <td>APPROVED BY</td> <td>KZ</td> </tr> <tr> <td>SCALE:</td> <td>1:750</td> <td>RELEASED FOR CONSTRUCTION</td> <td>K.ZUREK</td> </tr> <tr> <td>HORIZONTAL</td> <td></td> <td>DATE</td> <td>2019 03 06</td> </tr> <tr> <td>VERTICAL</td> <td></td> <td>DATE</td> <td>2019 03 06</td> </tr> </table>	DESIGNED BY	SC	CHECKED BY	SC	DRAWN BY	BL	APPROVED BY	KZ	SCALE:	1:750	RELEASED FOR CONSTRUCTION	K.ZUREK	HORIZONTAL		DATE	2019 03 06	VERTICAL		DATE	2019 03 06	<p>ENGINEER'S SEAL</p> <p>ORIGINAL SIGNED BY S.R.J. COURNOYER 19/03/05</p> <p>CONSULTANT DRAWING NUMBER -</p>	<p>THE CITY OF WINNIPEG WATER AND WASTE DEPARTMENT ENGINEERING DIVISION</p> <p>2018 SEWER MAIN RENEWALS BY CIPP LINING BERESFORD AVENUE 1ST MH W OF NASSAU STREET SOUTH TO 1ST MH E OF NASSAU STREET SOUTH</p>	<p>SHEET 8 OF 69</p> <p>CITY DRAWING NUMBER 12130</p>
DESIGNED BY	SC	CHECKED BY	SC																										
DRAWN BY	BL	APPROVED BY	KZ																										
SCALE:	1:750	RELEASED FOR CONSTRUCTION	K.ZUREK																										
HORIZONTAL		DATE	2019 03 06																										
VERTICAL		DATE	2019 03 06																										

PLOT DATE: 2019 03 06

BID OPPORTUNITY: 146-2019
CONTRACT NUMBER: 3

FILE PATH: R:\DRAWINGS\SEWER\2018 RENEWALS\RENEWALS & ASSOCIATED WORKS\CONTRACT 3\CONSTRUCTION DWGS\
FILE NAME: BERESFORD AV.dwg