

- CONSTRUCTION NOTES:**
1. ALL WORK AND MATERIALS TO BE IN ACCORDANCE WITH LATEST REVISION OF THE CITY OF WINNIPEG STANDARD CONSTRUCTION SPECIFICATIONS.
 2. LEGAL PLAN AND UNDERGROUND INFORMATION FROM CITY OF WINNIPEG LBIS. CONTRACTOR TO VERIFY ALL UNDERGROUNDS IN THE FIELD.
 3. CONTRACTOR TO TAKE PRECAUTIONARY STEPS TO AVOID DAMAGE FROM CONSTRUCTION ACTIVITIES TO TREES WITHIN THE LIMITS OF CONSTRUCTION.
 4. LOCATION OF EXISTING SERVICES TO BE CONFIRMED IN THE FIELD BY THE CONTRACTOR.
 5. HYDRO POLES AND ANCHORS THAT REQUIRE TEMPORARY SUPPORT, REMOVAL OR REPLACEMENT, TO BE DONE SO AT THE EXPENSE OF THE CONTRACTOR, AS NECESSARY.
 6. CONTRACTOR TO TAKE PRECAUTIONARY STEPS WHEN WORKING IN PROXIMITY TO THE TRANSCANADA PIPELINE. CONTRACTOR IS RESPONSIBLE TO FOLLOW ALL TRANSCANADA PIPELINE REQUIREMENTS INCLUDING SAFETY WATCH AS REQUIRED.
 7. LIMITS OF WORK FOR CLEARING AND GRUBBING, ROESTORATION OF APPROACHES, AND LANDSCAPING AS DIRECTED BY THE CONTRACT ADMINISTRATOR.

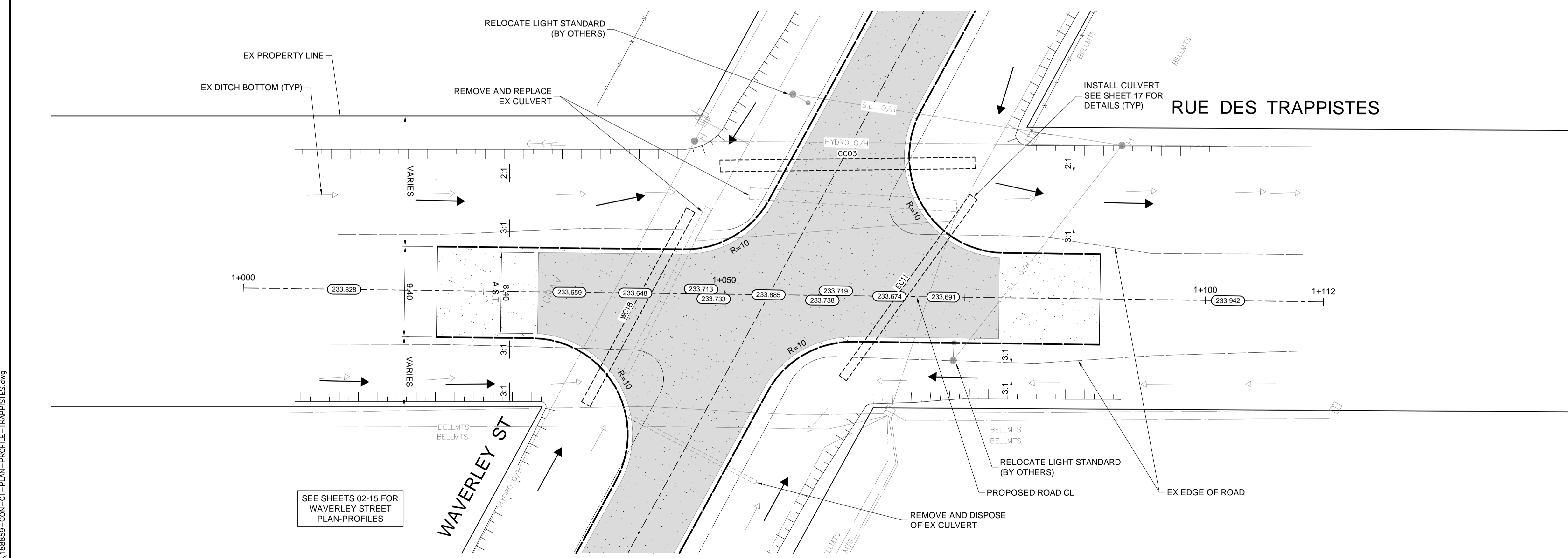

METRIC
WHOLE NUMBERS INDICATE MILLIMETRES
DECIMALIZED NUMBERS INDICATE METRES

- WARNING**
- IF POWER EQUIPMENT OR EXPLOSIVES ARE TO BE USED FOR EXCAVATION ON THIS PROJECT THE CONTRACTOR MUST:
1. NOTIFY THE GAS COMPANY OF THE PROPOSED LOCATION OF EXCAVATION.
 2. TAKE PRECAUTION TO AVOID DAMAGE TO GAS COMPANY INSTALLATIONS SEE PROVINCIAL REGULATION 210/72 FOR DETAILS.
 3. OBTAIN EXCAVATION PERMITS PRIOR TO CONSTRUCTION.

APEGM
Certificate of Authorization
Dillon Consulting Limited (MB)
No. 1789 Date: 2019/05/28

**PRELIMINARY ONLY
NOT FOR CONSTRUCTION**

| | | | | | | | | | | |
|----------|-------------|----------|---------------|-------------|------------|---------------------|-------------------|--------------|--------------|-----|
| HYDRANT | VALVE | MANHOLE | CATCH BASIN | CATCH PIT | WATERMAIN | LAND DRAINAGE SEWER | WASTE WATER SEWER | HYDRO | BELLMTS | GAS |
| CONCRETE | C.S.T. | SIDEWALK | PROPERTY LINE | ELEVATION | HYDRO POLE | SURVEY BAR | BELLMTS PEDESTAL | DITCH ARROWS | SWALE ARROWS | |
| EXISTING | LEGEND-PLAN | PROPOSED | EXISTING | LEGEND-PLAN | PROPOSED | EXISTING | LEGEND-PROFILE | PROPOSED | | |

| | | | | | |
|----------|---------|----------|---------------|-----------|------------|
| 150 WM | 300 LDS | 250 WWS | HYDRO | BELLMTS | 100 GAS |
| 150 WM | 300 LDS | 250 WWS | HYDRO | BELLMTS | 100 GAS |
| CONCRETE | C.S.T. | SIDEWALK | PROPERTY LINE | ELEVATION | HYDRO POLE |
| CONCRETE | C.S.T. | SIDEWALK | PROPERTY LINE | ELEVATION | HYDRO POLE |
| CONCRETE | C.S.T. | SIDEWALK | PROPERTY LINE | ELEVATION | HYDRO POLE |

| | | | | | |
|----------|---------|----------|---------------|-----------|------------|
| 150 WM | 300 LDS | 250 WWS | HYDRO | BELLMTS | 100 GAS |
| 150 WM | 300 LDS | 250 WWS | HYDRO | BELLMTS | 100 GAS |
| CONCRETE | C.S.T. | SIDEWALK | PROPERTY LINE | ELEVATION | HYDRO POLE |
| CONCRETE | C.S.T. | SIDEWALK | PROPERTY LINE | ELEVATION | HYDRO POLE |
| CONCRETE | C.S.T. | SIDEWALK | PROPERTY LINE | ELEVATION | HYDRO POLE |

| | |
|-------------------|-------------|
| DESIGNED BY | RTP |
| DRAWN BY | TJH |
| CHECKED BY | TS |
| APPROVED BY | BC |
| HOR. SCALE | 1:250 |
| VERTICAL | 1:10 |
| ISSUED FOR TENDER | 19/05/28 BC |
| NO. REVISIONS | DATE BY |

| | |
|-------------------|-------------|
| DESIGNED BY | RTP |
| DRAWN BY | TJH |
| CHECKED BY | TS |
| APPROVED BY | BC |
| HOR. SCALE | 1:250 |
| VERTICAL | 1:10 |
| ISSUED FOR TENDER | 19/05/28 BC |
| NO. REVISIONS | DATE BY |

ENGINEER'S SEAL
PROVINCE OF MANITOBA
REGISTERED PROFESSIONAL ENGINEER
S.B. COOK
2019/05/28

THE CITY OF WINNIPEG
PUBLIC WORKS DEPARTMENT

2019 GRANULAR ROAD PROGRAM
WAVERLEY STREET
(GRANDMONT BOULEVARD TO CITY LIMIT)

CITY DRAWING NUMBER
P-3506-2019-16
SHEET 16 OF 18
CONSULTANT DRAWING NUMBER

RUE DES TRAPPISTES -
PLAN-PROFILE

CONSULTANT PROJECT NUMBER
18-8859

G:\CAD\188859\Drawings\Roadworks\Contract\188859-CON-CT-PLAN-PROFILE-TRAPPISTES.dwg