

NOTE: CHAINAGES SHOWN ARE ALONG ϕ OF 450 HDPE LDS

FOR INDEX PAGE SEE DWG LD-9566

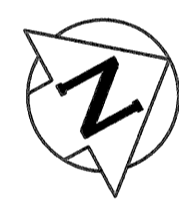

ASSINIBOINE RIVER

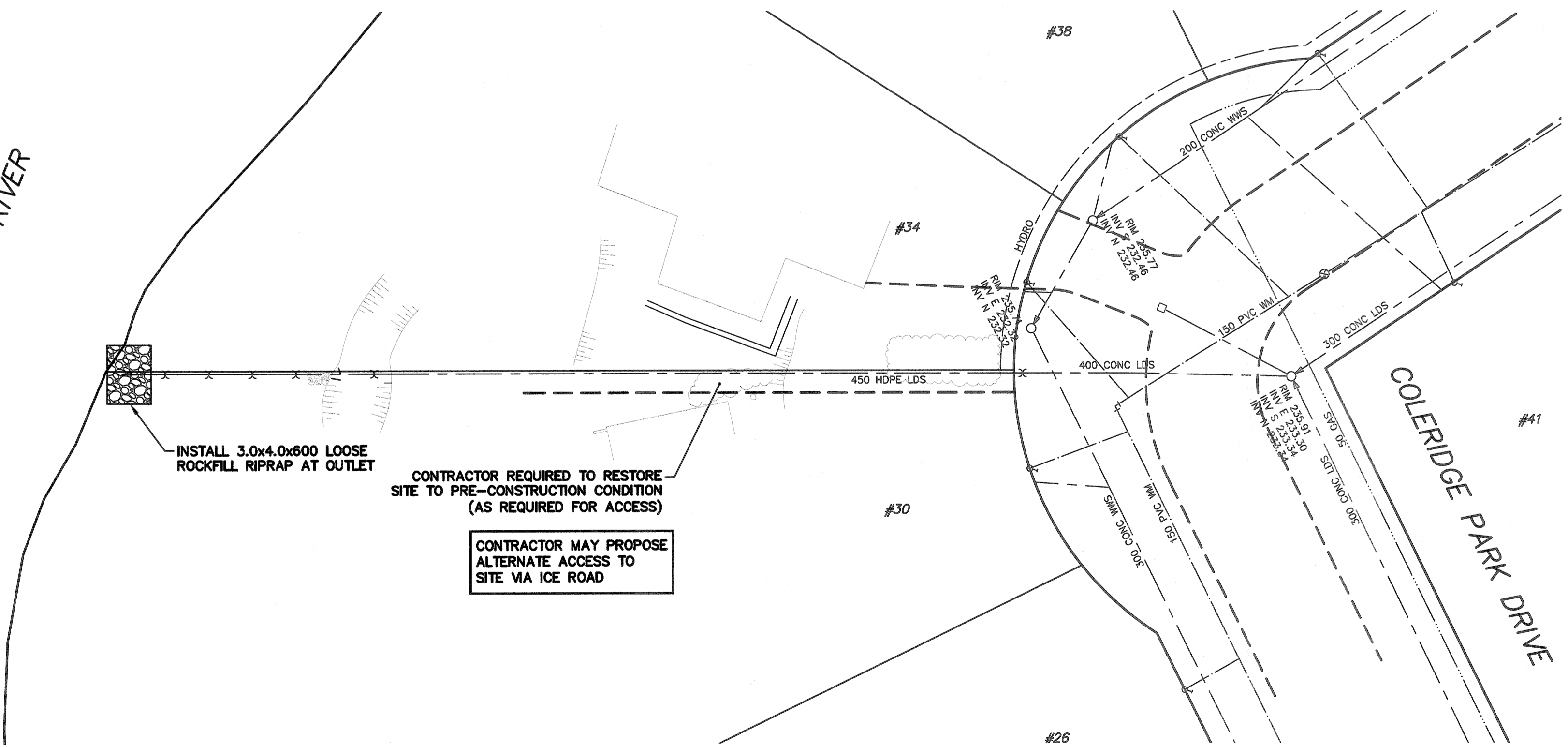

- NOTES:
1. ALL EXCAVATED MATERIAL WITHIN 106.7 (350ft) OF THE REGULATED SUMMER RIVER LEVEL (RSRL) MUST BE REMOVED FROM SITE (NO STOCKPILING).
 2. CONSTRUCT CLAY COFFERDAM AT CREEK AS REQUIRED (SEE DWG LD-9569).
 3. REMOVE AND INSTALL NEW TREES AS DIRECTED BY THE CONTRACT ADMINISTRATOR.
 4. CONTRACTOR TO PROTECT ADJACENT PROPERTIES AND RESTORE SITE TO PRE-CONSTRUCTION CONDITION.

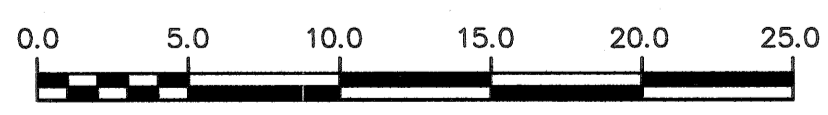

METRIC
WHOLE NUMBERS INDICATE MILLIMETRES
DECIMALIZED NUMBERS INDICATE METRES

PROPERTY LIMITS DELINEATION
DELINEATION OF PROPERTY LIMITS AS SHOWN ON THIS DWG DOES NOT REPRESENT A "LEGAL SURVEY". KGS GROUP MAKES NO REPRESENTATION OR WARRANTY AS TO THE ACCURACY OF PROPERTY LIMITS DELINEATED ON THIS DWG, NOR ON THE DIMENSIONAL ACCURACY OF DWG FEATURES RELATIVE TO THOSE PROPERTY LIMITS.

WARNING
IF POWER EQUIPMENT OR EXPLOSIVES ARE TO BE USED FOR EXCAVATION ON THIS PROJECT THE CONTRACTOR MUST:
1) NOTIFY THE GAS COMPANY OF THE PROPOSED LOCATION OF EXCAVATION.
2) TAKE PRECAUTION TO AVOID DAMAGE TO GAS COMPANY INSTALLATIONS.
SEE PROVINCIAL REGULATION 210/72 FOR DETAILS

LOCATION APPROVED UNDERGROUND STRUCTURES
SUPV. U/G STRUCTURES COMMITTEE _____ DATE _____
NOTE:
LOCATION OF UNDERGROUND STRUCTURES AS SHOWN ARE BASED ON THE BEST INFORMATION AVAILABLE BUT NO GUARANTEE IS GIVEN THAT ALL EXISTING UTILITIES ARE SHOWN OR THAT THE GIVEN LOCATIONS ARE EXACT. CONFIRMATION OF EXISTENCE AND EXACT LOCATION OF ALL SERVICES MUST BE OBTAINED FROM THE INDIVIDUAL UTILITIES BEFORE PROCEEDING WITH CONSTRUCTION.

B.M. ELEV.

KGS GROUP

DESIGNED BY	NGV	CHECKED BY	RBO
DRAWN BY	GEL	APPROVED BY	RBO
SCALE:		RELEASED FOR CONSTRUCTION	
HORIZONTAL	1:250	DATE	11/14/19
VERTICAL	1:50		
ISSUED FOR TENDER	2019 11 15	DATE	2019 11 14
NO.		DATE	

PLOT DATE: 2019 11 14

ENGINEERS GEOSCIENTISTS MANITOBA
Certificate of Authorization
KGS Group
No. 245

ENGINEER'S SEAL
THE CITY OF WINNIPEG
WATER AND WASTE DEPARTMENT
ENGINEERING DIVISION
CONSULTANT DRAWING NUMBER LD-9573

THE CITY OF WINNIPEG WATER AND WASTE DEPARTMENT ENGINEERING DIVISION
2019 OUTFALL RENEWAL REHABILITATION PROGRAM
COLERIDGE PARK DRIVE OUTFALL PLAN AND PROFILE
S-MA70011167

SHEET **6** OF **7**
CITY DRAWING NUMBER **LD-9573**