

LEGEND:

- EXISTING
- - - NEW WORK
- EX = WALL MOUNTED BATTERY/EXIT COMBINATION UNIT (PLAN VIEW) TYPE (REFER TO SCHEDULE) ARROW AS INDICATED ON DRAWING
- EA = REMOTE FIXTURE
- EX = [Symbol]
- EX > = [Symbol]
- X = HIGH BAY LUMINAIRE X = TYPE (REFER TO SCHEDULE)
- X = LUMINAIRE, 610MM LENGTH X = TYPE (REFER TO SCHEDULE)
- X = LUMINAIRE, 1220MM LENGTH X = TYPE (REFER TO SCHEDULE)
- M712-Y(x) DENOTES SWITCHED CIRCUIT (IF APPLICABLE) DENOTES CIRCUIT # PANELBOARD FEED
- ⊕ = 220V RECEPTACLE
- ⊖ = 120V RECEPTACLE

CONSTRUCTION NOTES:

- 1 PROVIDE NEW MOTOR CONTROL CENTRE MCC-M710.
- 2 PROVIDE NEW TEMPERATURE TRANSMITTER, TT-M6000. REFER TO DRAWING 1-0660M-A0001.
- 3 PROVIDE NEW 1φ, 3W, 120/240V PANEL BOARD PNL-M712. REFER TO PANEL SCHEDULE DWG. 1-0660M-E0009.
- 4 PROVIDE NEW INTERIOR LIGHTING. LIGHTS TO BE POWERED FROM PANEL PNL-M712. REFER TO LUMINAIRE SCHEDULE DWG. 1-0660M-E0009.
- 5 PROVIDE NEW EXTERIOR LIGHTING. PROVIDE ALL NECESSARY ACCESSORIES TO MOUNT OUTSIDE. LIGHTS TO BE POWERED FROM PANEL PNL-M712. REFER TO LUMINAIRE SCHEDULE DWG. 1-0660M-E0009.
- 6 PROVIDE NEW HOUSE KEEPING PAD 89mm IN HEIGHT, EXTENDED 100mm ON EACH SIDE OF THE EQUIPMENT WITH 20mm CHAMFERED EDGES. PROVIDE REINFORCEMENT AND ANCHOR PAD TO FLOOR SLAB. SEE DWG. 1-0660M-E0010.
- 7 PROVIDE NEW TEMPORARY GENERATOR CONNECTION ENCLOSURE, JB-M702. REFER TO DWG. 1-0660M-E0017.
- 8 PROVIDE NEW CUSTOMER SERVICE TERMINATION ENCLOSURE CSTE-M701 COMPLETE WITH SAND BEDDING & FIBERGLASS PAD. SEE DRAWING 1-0660M-E0007 FOR MORE DETAILS.
- 9 PROVIDE NEW EMERGENCY LIGHTS AND EXIT SIGN. REFER TO LUMINAIRE SCHEDULE DWG. 1-0660M-E0009.
- 10 PROVIDE NEW CABLE IN CONDUIT TO INSTALL EXISTING WELDING RECEPTACLE AND EXISTING FUSED DISCONNECT SWITCH IN THE SPECIFIED NEW LOCATION.
- 11 PROVIDE NEW RECEPTACLE, WIRING AND CONDUIT. ALL WIRING TO BE RUN IN CONDUIT AND FED FROM PANEL PNL-M712.
- 12 PROVIDE NEW EMERGENCY LIGHTING REMOTE FIXTURE. MOUNT FIXTURE WITH THE BOTTOM OF THE ENCLOSURE NOT LESS THAN 2.0m ABOVE FINISHED FLOOR.
- 13 PROVIDE NEW LIGHT SWITCHES FOR CONTROL OF LUMINAIRES.
- 14 PROVIDE 3-CONDUCTOR WIRING (IN CONDUIT) BETWEEN LIGHTS AND LIGHT SWITCHES FOR 3-WAY SWITCH OPERATION. TYPICAL FOR ALL 3-WAY SWITCHES FOR ALL DRAWINGS.

NOTES:

1. SEE LUMINAIRE SCHEDULE FOR LIGHT FIXTURE TYPE AND MODEL ON DRAWING 1-0660M-E0009-001. ONLY ROOM AND EXTERIOR LIGHTING ARE SHOWN IN THIS DRAWING. REFER TO DRAWING 1-0660M-E0014 FOR MAIN FLOOR CEILING LIGHTS.
2. ALL EQUIPMENT LISTED IN CONSTRUCTION NOTES ARE NEW AND SHALL BE PROVIDED AND INSTALLED BY CONTRACTOR UNLESS OTHERWISE NOTED.
3. EXIT SIGNS ARE TO BE INSTALLED IN ACCORDANCE WITH THE SIGN ORIENTATIONS SHOWN ON THE DRAWING TO INDICATE THE REQUIRED EGRESS PATH IN ACCORDANCE WITH BUILDING AND LOCAL AUTHORITY REQUIREMENTS.

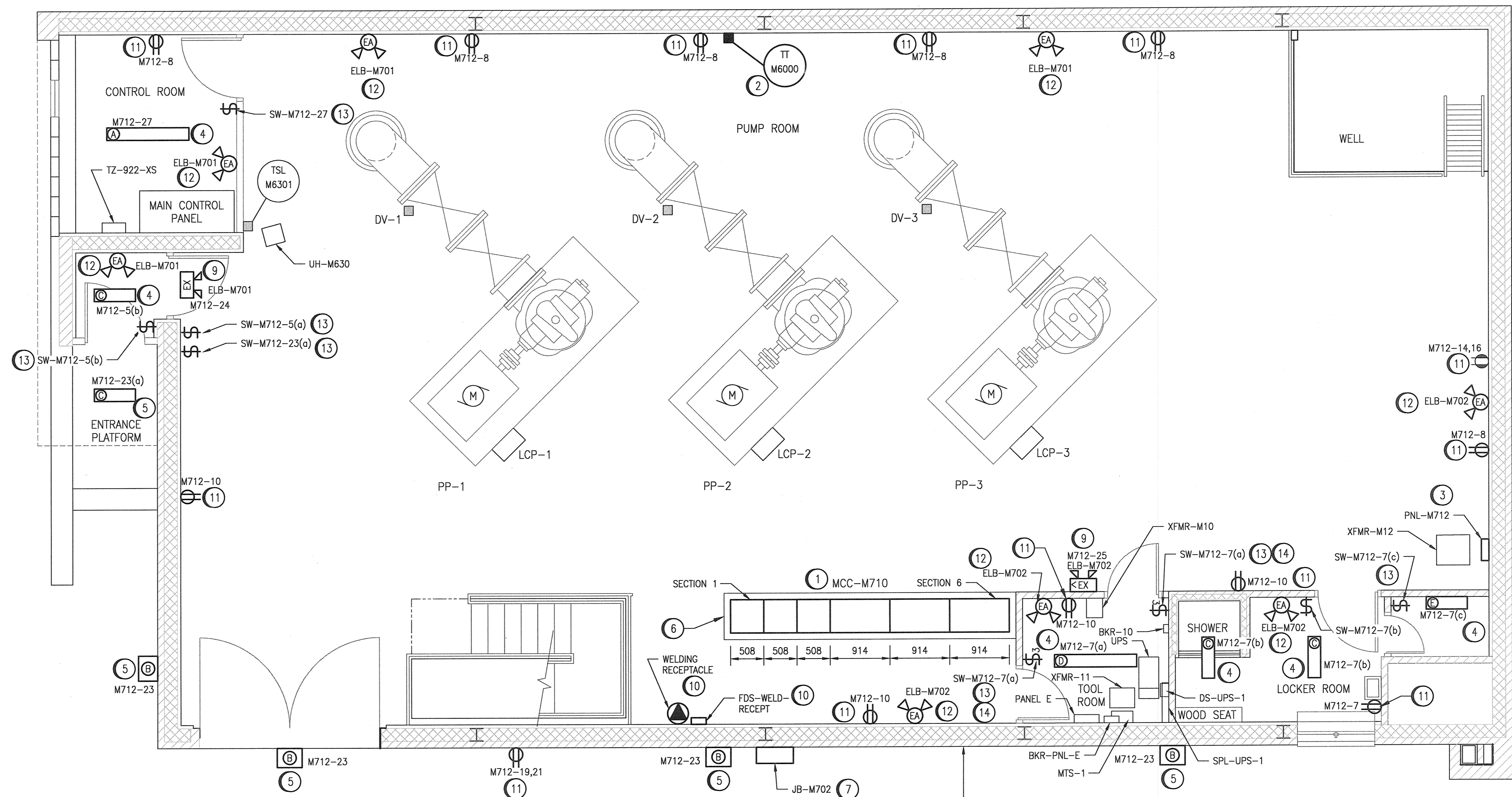

MAIN FLOOR PLAN
SCALE: 1 : 40

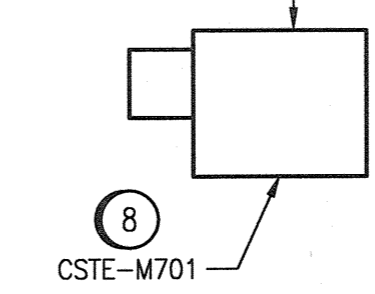

METRIC
WHOLE NUMBERS INDICATE MILLIMETRES
DECIMALIZED NUMBERS INDICATE METRES

0,0 0,4 0,8 1,6 2,4

1:40

APEGM
Certificate of Authorization
SNC-Lavalin Inc.
No. 4489

NO.	REVISIONS	DATE	DESIGN	CHECK
00	ISSUED FOR TENDER AND CONSTRUCTION	2019/10/18	SB	BC

		SNC-Lavalin Inc. 148 Nature Park Way Winnipeg, MB, Canada R3P 0X7 204-786-8080	
DESIGNED BY: S. BOGHOSIAN	CHECKED BY: B. CLEVEN	ISSUED FOR CONSTRUCTION BY: A. WEISS	DATE: 2019/02/01
DRAWN BY: J. GRAGASIN	APPROVED BY: D. BECKER	DATE: 2019/10/18	CONSULTANT NO.:

ENGINEER'S SEAL

PROVINCE OF MANITOBA
ELIMBAN
Member
34636
REGISTERED PROFESSIONAL ENGINEER

Oct 18 / 2019

THE CITY OF WINNIPEG
WATER AND WASTE DEPARTMENT

TACHE BOOSTER PUMPING STATION

ELECTRICAL EQUIPMENT PLAN
PUMP ROOM

CITY DRAWING NUMBER	SHEET	REV.	SIZE
1-0660M-E0013	001	00	A1

1-0660M-A0001	LOOP DIAGRAM, MAIN CONTROL TEMPERATURE TRANSMITTER, TT-M6000
1-0660M-E0017	PANEL LAYOUT, JB-M702, TEMPORARY GENERATOR CONNECTION
1-0660M-E0010	PLAN AND SECTIONS, TYPICAL HOUSEKEEPING PAD DETAILS
1-0660M-E0009	PANEL SCHEDULE AND DETAILS, PNL-M712
1-0660M-E0007	ELECTRICAL SINGLE LINE DIAGRAM, MCC-M710
DRAWING NUMBER	REFERENCE DRAWINGS