

**WATERMAIN RENEWAL TO BE COMPLETED IN 2018
BID OPPORTUNITY 134-2018**

STREET LIGHTING RENEWAL TO BE COMPLETED BY MANITOBA HYDRO

NOTE: These design documents are prepared solely for the use by the party with whom the design professional has entered into a contract and there are no representations of any kind made by the design professional to any party with whom the design professional has not entered into a contract.

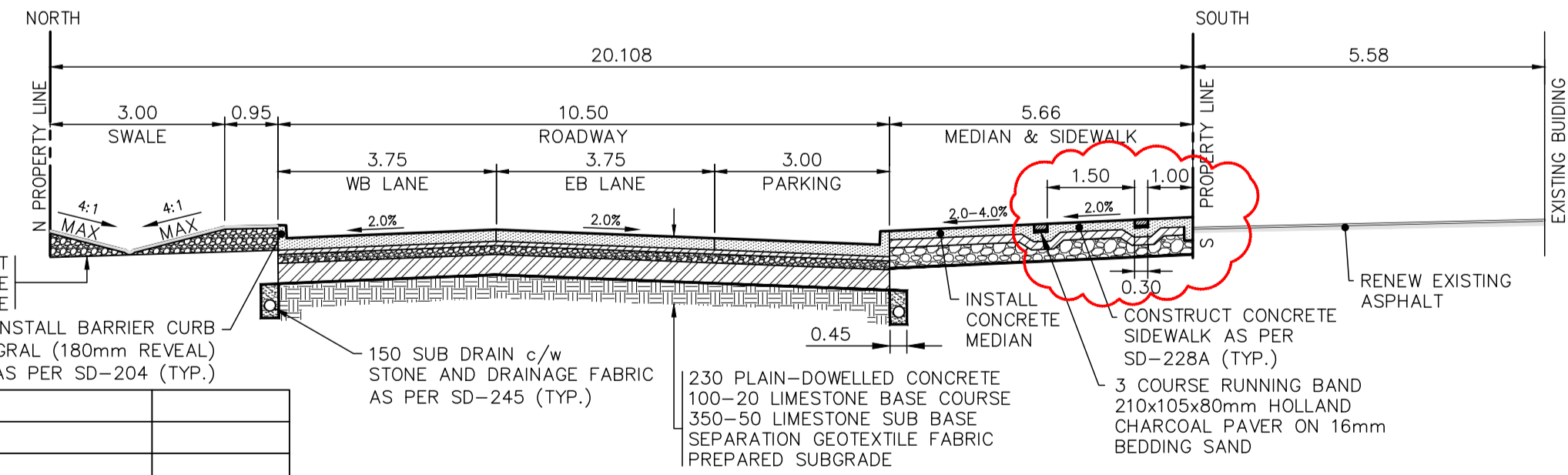

| EXISTING | PROPOSED | EXISTING | LEGEND-PLAN | PROPOSED | EXISTING | LEGEND-PROFILE | PROPOSED |
|----------|----------|----------|----------------------------------|----------|----------|----------------|----------|
| --- | --- | --- | SWALE GRADE | (31.255) | --- | --- | --- |
| --- | --- | --- | SLOPE | --- | --- | --- | --- |
| --- | --- | --- | DIRECTION FLOW | --- | --- | --- | --- |
| --- | --- | --- | HYDRO POLE & LIGHT STANDARD | --- | --- | --- | --- |
| --- | --- | --- | LIGHT STANDARD OR TRAFFIC SIGNAL | --- | --- | --- | --- |
| --- | --- | --- | GAS | --- | --- | --- | --- |
| --- | --- | --- | HYDRO POLE | --- | --- | --- | --- |
| --- | --- | --- | CURB RAMP | --- | --- | --- | --- |
| --- | --- | --- | DETECTABLE WARNING SURFACE TILE | --- | --- | --- | --- |
| --- | --- | --- | EDGE OF SIDEWALK | --- | --- | --- | --- |
| --- | --- | --- | FENCE | --- | --- | --- | --- |
| --- | --- | --- | PROPERTY LINE | --- | --- | --- | --- |
| --- | --- | --- | EDGE OF ASPHALT | --- | --- | --- | --- |
| --- | --- | --- | NORTH PROPERTY LINE | --- | --- | --- | --- |
| --- | --- | --- | EDGE OF CONCRETE | --- | --- | --- | --- |
| --- | --- | --- | SOUTH PROPERTY LINE | --- | --- | --- | --- |
| --- | --- | --- | MODIFIED BARRIER CURB | --- | --- | --- | --- |
| --- | --- | --- | BARRIER CURB | --- | --- | --- | --- |
| --- | --- | --- | ROADWAY CENTRELINE | --- | --- | --- | --- |
| --- | --- | --- | CONC SIDEWALK | --- | --- | --- | --- |
| --- | --- | --- | CONCRETE SLAB | --- | --- | --- | --- |
| --- | --- | --- | NORTH GUTTER | --- | --- | --- | --- |
| --- | --- | --- | ASPHALT OVERLAY | --- | --- | --- | --- |
| --- | --- | --- | SOUTH GUTTER | --- | --- | --- | --- |
| --- | --- | --- | NORTH SWALE | --- | --- | --- | --- |
| --- | --- | --- | BULLNOSE | --- | --- | --- | --- |
| --- | --- | --- | LEGEND-PLAN | --- | --- | --- | --- |
| --- | --- | --- | LEGEND-PROFILE | --- | --- | --- | --- |

| LOCATIONS APPROVED UNDERGROUND STRUCTURES | |
|---|-------|
| SIGNED BY: | DATE: |
| SUP UG STRUCTURES | |
| LOCATION OF UNDERGROUND STRUCTURES AS SHOWN ARE BASED ON THE BEST INFORMATION AVAILABLE BUT NO GUARANTEE IS GIVEN THAT ALL EXISTING UTILITIES ARE SHOWN OR THAT THE GIVEN LOCATIONS ARE EXACT CONFIRMATION OF EXISTENCE AND EXACT LOCATION OF ALL SERVICES MUST BE OBTAINED FROM THE INDIVIDUAL UTILITIES BEFORE PROCEEDING | |

| G.M. ELEV. | TOP OF TOP NUT ON FIRST HYDRANT EAST OF SLAW RECHUK BRIDGE ON THE SOUTH SIDE OF HIGGINS AVENUE 232.482 |
|------------|--|
| H | - |
| G | - |
| F | - |
| E | - |
| D | ISSUED FOR ADDENDUM 2018-06-11 DS |
| C | ISSUED FOR TENDER 2018-09-29 DS |
| B | ISSUED FOR UGS REVIEW 2018-04-26 DS |
| A | ISSUE FOR CLIENT REVIEW 2018-04-13 DS |
| NO. | REVISIONS |
| DATE | BY |
| 2018-02-15 | |

WSP Canada Group Limited
93 Lombard Ave, Suite 111
Winnipeg, MB R3B 3B1
T: 204.943.3178
F: 204.943.4948
www.wsp.com

DESIGNED BY: DS
CHECKED BY: TP
DRAWN BY: SB
APPROVED BY: VM
HOR. SCALE: 1:250
VERTICAL: 1:25
RELEASED FOR CONSTRUCTION: [DATE]

THE CITY OF WINNIPEG
PUBLIC WORKS DEPARTMENT
ENGINEERING SERVICES DIVISION

2018/2019 INDUSTRIAL STREETS
RENEWAL PROGRAM
HIGGINS AVENUE - HENRY AVE TO PRINCESS ST
PAVEMENT RECONSTRUCTION
STA. 4+95 TO STA. 6+40

Winnipeg

2018-02-15

17M-01932-00-C09

ENGINEERS SEAL: V.M. MAROTI, Member 30809, PROFESSIONAL ENGINEER

CONSULTANT ACAD DWG. NO. 17M-01932-00-C09

CITY DRAWING NUMBER: 09 OF 12
SHEET: 09 OF 12
BID NO. 85-2018

METRIC
WHOLE NUMBERS INDICATE MILLIMETRES
DECIMALIZED NUMBERS INDICATE METRES

ENGINEERS GEOSCIENTIST MANITOBA
Certificate of Authorization
WSP Canada Group Limited
No. 6657