

HARDWARE SCHEDULE

Provide all hardware for doors and elsewhere as called for on the drawings or otherwise required for the proper installation of the Work of the Bid Opportunity as selected by the City of Winnipeg and the Contract Administrator.

Set #1.0

3 Hinge	TA2314 NRP 4-1/2" X 4"	US32D MK
1 Mortise Deadlock	MS1850S Series Schoolhouse	628 AD
2 Mortise Cylinder	4036 w/ BEST cylinder to suit	626 AD/BE
1 Thumbturn	4086	628 AD
2 Full Height Door Pull	RM2230 MP	US32D RO
2 Actuator	Wikk Industries, 36" Narrow Ingress Switch	630 RF
1 Concealed O/H Stop	6-X36	630 NO
1 Door Operator	6020 D	689 NO
1 Threshold	171	PE
1 Weatherstrip and Sweep	By Door Supplier	00
1 Keyswitch	MKAN	SU

Note: Push & Pulls to be door height -12". Co-ordinate location of deadbolt to be sure it will not conflict with Push or Pull. Lock to be located at standard lock height. Exterior power door actuator to be mounted on bollard. Interior power door actuator to wall mounted. Wire actuators through MKAN key switch. Actuators to be turned off when door is locked. MKAN switch to be mounted on frame jamb.

Power for system to be provided by the auto operator's on board power supply. Power to run through MKAN switch. When switch is turned off, electric strike will be locked and actuators disabled.

Set #2.0

3 Hinge	TA2314 NRP 4-1/2" X 4"	US32D MK
1 Deadlatch	4902 Series	RC130 AD
1 Lever	4569 Series	626 BE
2 Mortise Cylinder	BEST to suit	630 HS
1 Electric Strike	5000-C LBM	US32D RO
2 Full Height Door Pull	RM2230 MP	US32D RO
2 Actuator	Wikk Industries, 36" Narrow Ingress Switch	630 RF
1 Concealed O/H Stop	6-X36	630 NO
1 Door Operator	6020 D	689 NO
1 Threshold	171	PE
1 Weatherstrip and Sweep	By Door Supplier	00
1 Logic Controller	CX-33	CA
1 Push to Lock Button	CM-400/8	CA
1 Keyswitch	MKAN	SU

Note: Push & Pulls to be door height -12". Co-ordinate location of deadbolt to be sure it will not conflict with Push or Pull. Lock to be located at standard lock height. Exterior power door actuator to be mounted on bollard. Interior power door actuator to wall mounted. Wire actuators through MKAN key switch. Actuators to be turned off when door is locked. MKAN switch to be mounted on frame jamb.

Power for system to be provided by the auto operator's on board power supply. Power to run through MKAN switch. When switch is turned off, electric strike will be locked and actuators disabled.

Norton 6020. Mode of Operation:

With power to system, electric strike to be unlocked. Door can be pulled open, or powered open by pressing actuator on exterior. Once inside washroom, pressing "push to lock" button will lock the electric strike and disable the exterior actuator. To exit, pressing inside actuator will release the electric strike and power open the door and reset the system, or door can be manually opened, also resetting the system. LBM switch strike to be used as door position switch.

Set #3.0

3 Hinge	TA2714 NRP 4-1/2" X 4"	US32D MK
1 Storeroom Lock	8206 LNL LC	US26D SA
1 Mortise Cylinder	BEST to suit	626 BE
1 Surface O/H Stop	10-X36	630 RF

Set #4.0

3 Hinge	TA2314 NRP 4-1/2" X 4"	US32D MK
1 Mortise Deadlock	MS1850S Series Schoolhouse	628 AD
1 Mortise Cylinder	4036 w/ BEST cylinder to suit	626 AD/BE
1 Thumbturn	4086	628 AD
2 Full Height Door Pull	RM2230 MP	US32D RO
2 Actuator	Wikk Industries, 36" Narrow Ingress Switch	630 RF
1 Standard Edge Lever Flush Bolt	6-X36	630 NO
1 Concealed O/H Stop	6-X36	630 NO
1 Door Operator	6020 D	689 NO
1 Weatherstrip and Sweep	By Door Supplier	00
1 Keyswitch	MKAN	SU

Note: Push & Pulls to be door height -12". Co-ordinate location of deadbolt to be sure it will not conflict with Push or Pull. Lock to be located at standard lock height. Actuators to be wall mounted to 2015 City of Winnipeg Accessibility Standards. Wire actuators through MKAN key switch. Actuators to be turned off when door is locked. MKAN switch to be mounted on frame jamb.

Coordinate flush bolt locking location with work at concrete floor.

Set #5.0

1 Pivot Set	H117-3/4 with Floor Plate	AA
1 Mortise Deadlock	MS1850S Series Schoolhouse	628 AD
1 Mortise Cylinder	4036 w/ BEST cylinder to suit	626 AD/BE
1 Thumbturn	4086	628 AD
2 Full Height Door Pull	RM2230 MP	US32D RO
1 Standard Edge Lever Flush Bolt	6-X36	630 NO
1 Weatherstrip and Sweep	By Door Supplier	00

Coordinate flush bolt locking location with work at concrete floor.

6 Hardware Schedule
A-200 NTS

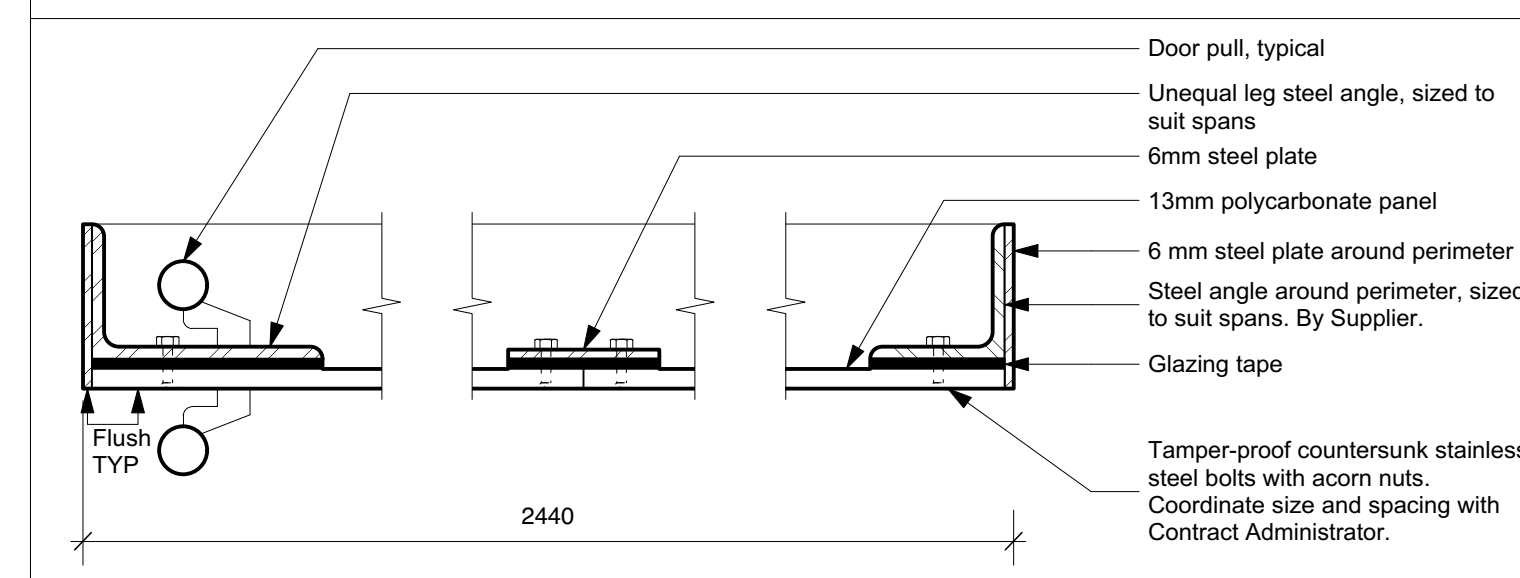
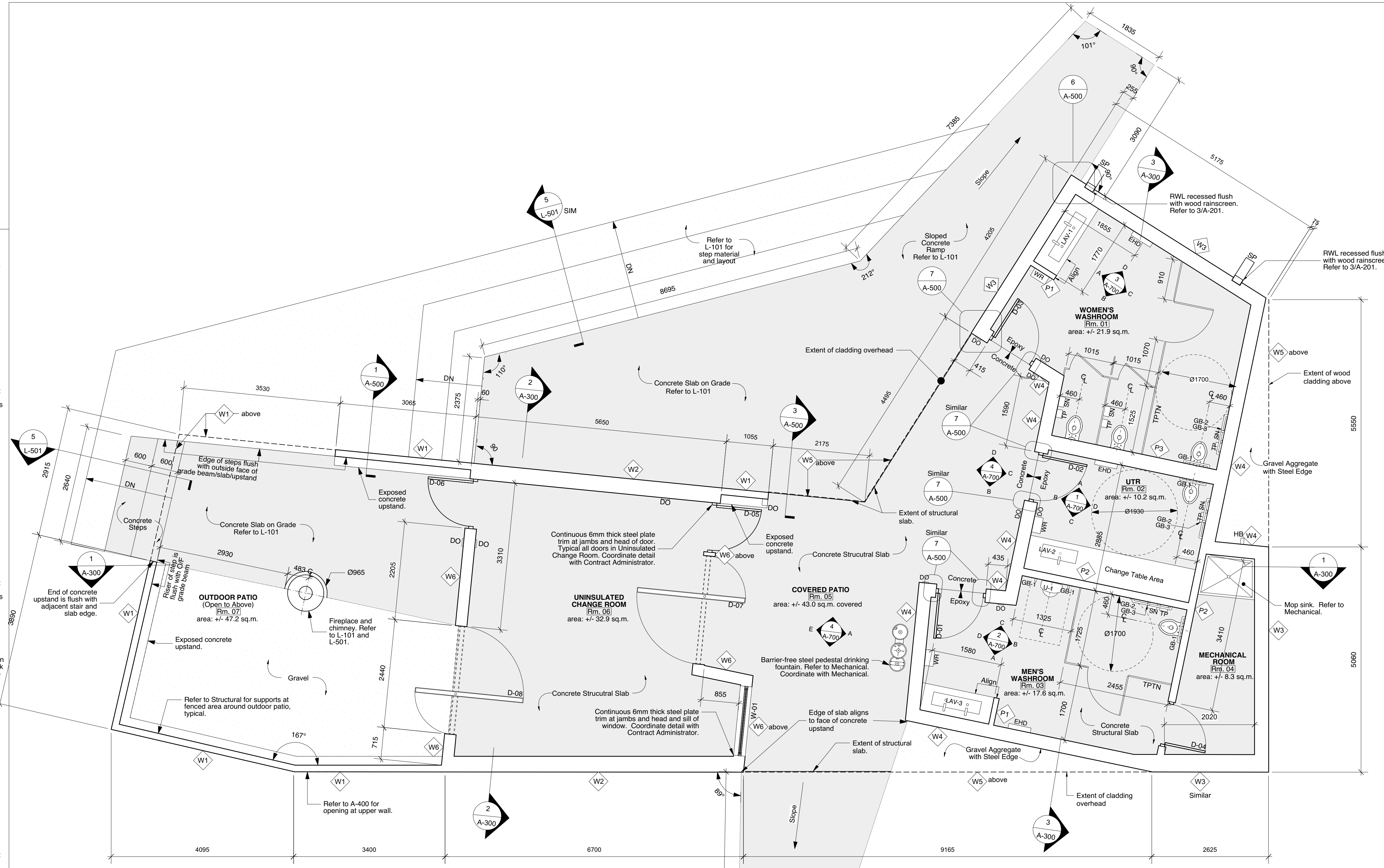

Shop Drawing Note:

- Contractor to provide engineered shop drawings for pivot doors for review by Contract Administrator.
- Contract Administrator to approve all pivot door hardware.
- Coordinate pivot door framing member sizing with Contract Administrator.

7 Pivot Door Detail
A-200 1:50

GENERAL NOTES

- All interior dimensions are from finish face to finish face. O/S face of sheathing aligns to O/S face of grade beam, typical.
- Dimensions from exterior walls to interior partitions are from exterior face of grade beam to face of interior finish.
- Wall types not dimensioned are to follow exterior face of grade beam dimensioned on Structural Drawing S-1.

CONSTRUCTION NOTES

- Custom stainless steel sink and counters at LAV-1, LAV-2 and LAV-3. Refer to S & G/A-700.
- Construct pivot doors from steel angle frame and steel plate, with welded connections, typical. Steel to receive paint finish. Coordinate hardware installation with Contract Administrator.
- Refer to L-101 and L-501 for edge conditions where different ground surfaces meet, typical.

1 Floor Plan
A-200 1:50

NO.	DOORS								FRAMES				NOTES	
	NOMINAL SIZE (Width x Height)	THICKNESS	FIRE RATING	TYPE	MATERIAL	CORE	FINISH	GLASS	HARDWARE	TYPE	MATERIAL	FINISH		FIRE RATING
MAIN FLOOR														
D-01	1015 x 2135	45	-	A	SS	INSUL	SS	-	Set #1.0	1	SS	-	-	Thermally broken frame, power door operator.
D-02	1015 x 2135	45	-	A	SS	INSUL	SS	-	Set #2.0	1	SS	-	-	Thermally broken frame, power door operator.
D-03	1015 x 2135	45	-	A	SS	INSUL	SS	-	Set #1.0	1	SS	-	-	Thermally broken frame, power door operator.
D-04	1015 x 2135	45	-	A	HM	HC	PNT	-	Set #3.0	1	HM	PNT	-	
D-05	1015 x 2135	45	-	B	SS	INSUL	SS	PC	Set #4.0	1	SS	-	-	Power door operator.
D-06	1015 x 2135	45	-	B	SS	INSUL	SS	PC	Set #4.0	1	SS	-	-	Power door operator.
D-07	2440 x 2135	45	-	C	STL	-	PNT	PC	Set #5.0	2	STL	PNT	-	Custom pivot door.
D-08	2440 x 2135	45	-	C	STL	-	PNT	PC	Set #5.0	2	STL	PNT	-	Custom pivot door.

2 Door Schedule
A-200

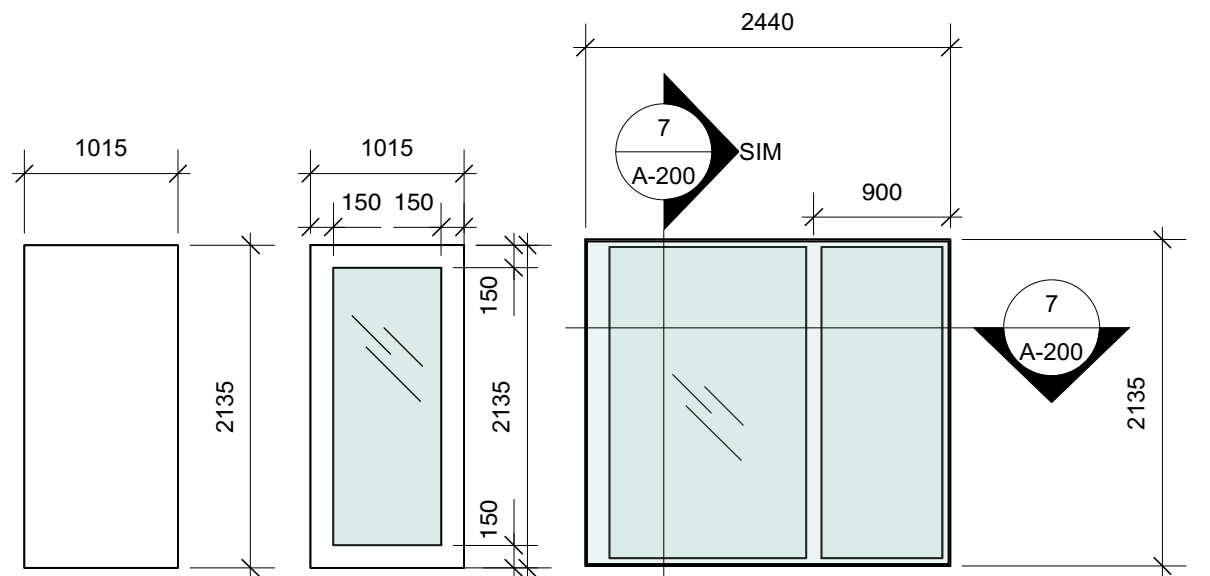

3 Door Types
A-200 1:50

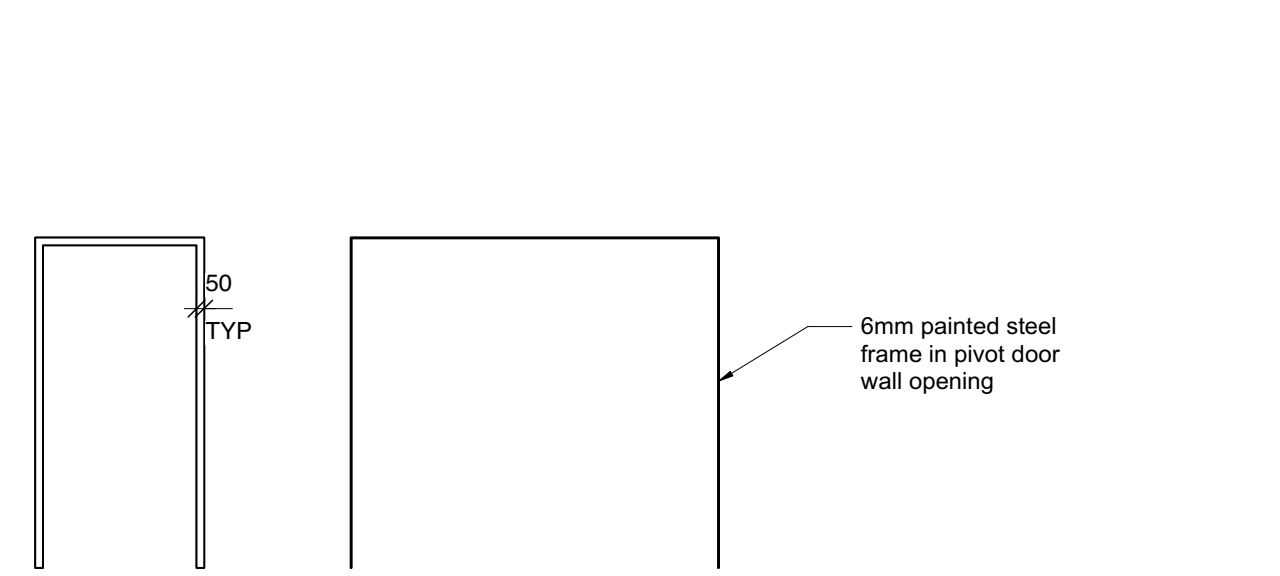

4 Frame Types
A-200 1:50

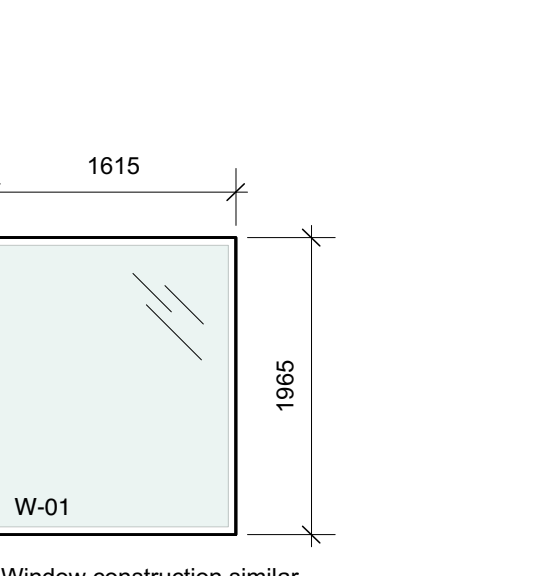

5 Window Schedule
A-200 1:50

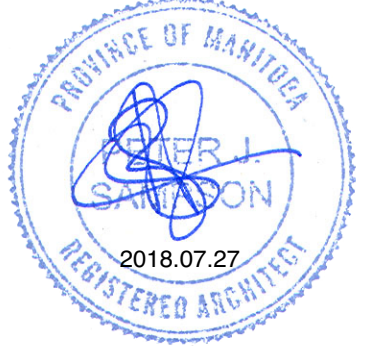
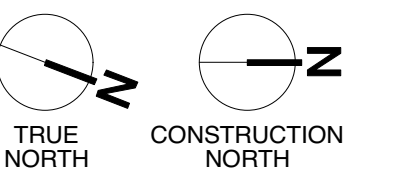

This drawing must not be scaled. The contractor shall verify all dimensions and other data on site prior to commencement of work. Discrepancies, errors, and omissions are to be reported to Public City Architecture Inc. prior to proceeding with the Work.

Drawings and specifications as instruments of service are the property of Public City Architecture Inc. the copyright in the same being reserved. No reproduction or revision to these drawings may be made without the permission of Public City Architecture Inc. and when made, must bear their name. All prints to be returned to Public City Architecture Inc. upon request.

Project
Crescent Drive Park Pavilion

Drawing
Floor Plan

Drawn By
DB
Scale
As Noted

Reviewed By
PS
Drawing No.
A-200

Date
2018.05.24

Project No.
1448