

EMPRESS STREET EAST

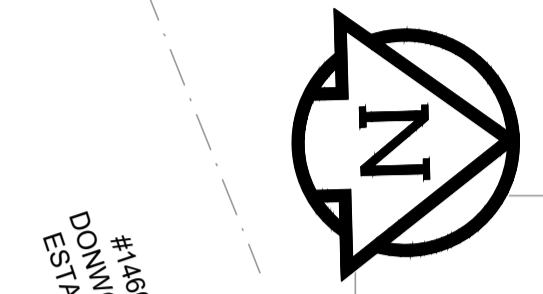

CANADIAN PACIFIC RAILWAY LARIVIERE SUBDIVISION

- NOTES**
1. ADJUST MH'S, CB RIMS, WV'S AND HYD'S TO NEW GRADES.
 2. CONTRACTOR TO REGRADE/RENEW EXIST SIDEWALKS TO LIMITS AS SHOWN. SIDEWALKS TO BE RENEWED WITH CONCRETE UNLESS NOTED OTHERWISE.
 3. CONTRACTOR TO TAKE PRECAUTIONARY STEPS AS OUTLINED IN THE SPECIFICATIONS TO PROTECT EXISTING TREES WITHIN THE LIMITS OF CONSTRUCTION FROM DAMAGE FROM CONSTRUCTION ACTIVITIES.
 4. MODIFIED BARRIER CURB TO BE CONSTRUCTED AT ALL INTERSECTION RADII, BACK LANE RADII AND BULLNOSES.
 5. CONTRACTOR TO CONFIRM THE LOCATION OF ALL UTILITIES/SERVICES IN THE FIELD PRIOR TO CONSTRUCTION.
 6. ADD 200.000m TO ABBREVIATED ELEVATIONS TO OBTAIN GEODETIC ELEVATIONS.
 7. CB SD-024 OFFSETS ARE DIMENSIONED TO BOC. CB SD-025 OFFSETS ARE DIMENSIONED OIC.
 8. ALL DIMENSIONS TO BACK OF CURB AND THEORETICAL BACK OF CURB.

REFERENCE LEGEND

- SEE SHEET 10 FOR PAVING
- SEE SHEETS 40 & 41 FOR PROFILES
- SEE SHEET 55 FOR CYCLE TRACK PROFILES
- SEE SHEET 60 FOR PATH PROFILES
- SEE SHEET 72 FOR LANDSCAPING

SECTION LEGEND

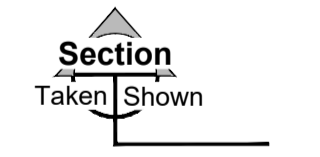

METRIC

WHOLE NUMBERS INDICATE MILLIMETRES
DECIMALIZED NUMBERS INDICATE METRES

---	GAS	○	MANHOLE	●	CONCRETE PAVEMENT	---	LOCATION APPROVED
- - -	MTS / PEDESTAL	□	CATCH BASIN / CATCH PIT	■	CONC SIDEWALK / MEDIAN	---	UNDERGROUND STRUCTURES
- - -	HYDRO / CABINET	△	CURB INLET WITH BOX	▲	ASPHALT PAVEMENT	---	DATE
- - -	CATV / FIBRE OPTIC	○	TREE	▲	PAVING STONE	---	COMMITTEE
- - -	TRAFFIC SIGNALS / PIT	⊕	TEST HOLE	▲	GRAVEL	---	NOTE:
- - -	LAND DRAINAGE SEWER	⊕	PROPERTY LINE	▲	RAMP CURB	---	LOCATION OF UNDERGROUND STRUCTURES
- - -	SANITARY/COMBINED SEWER	⊕	SURVEY BAR	▲	PLANING / REMOVAL	---	AS SHOWN ARE BASED ON THE BEST
- - -	CB LEAD / SSP / DCP	⊕	FENCE	▲		---	INFORMATION AVAILABLE BUT NO
- - -	WATER MAIN	⊕	BOC / EDGE OF PAVEMENT	▲		---	GUARANTEE IS GIVEN THAT ALL EXISTING
- - -	SUBDRAIN	⊕	ELEVATION (33.333)	▲		---	UTILITIES ARE SHOWN OR THAT THE GIVEN
- - -	DITCH	⊕	TRAFFIC SIGN	▲		---	LOCATIONS ARE EXACT. CONFIRMATION OF
- - -		⊕		▲		---	EXISTENCE AND EXACT LOCATION OF ALL
- - -		⊕		▲		---	SERVICES MUST BE OBTAINED FROM THE
- - -		⊕		▲		---	INDIVIDUAL UTILITIES BEFORE PROCEEDING
- - -		⊕		▲		---	WITH CONSTRUCTION.
---	EXISTING	---	EXISTING	---	EXISTING	---	
---	LEGEND - PLAN	---	LEGEND - PLAN	---	LEGEND - PLAN	---	
---	NEW	---	NEW	---	NEW	---	
---	LEGEND - PLAN	---	LEGEND - PLAN	---	LEGEND - PLAN	---	
---	NEW	---	NEW	---	NEW	---	

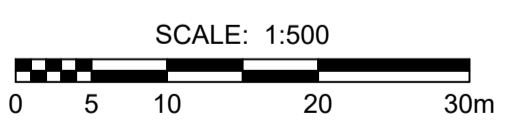

BID OPPORTUNITY No. 602-2018



DESIGNED BY	WRJ	CHECKED BY	RPB
DRAWN BY	DID	APPROVED BY	BWB
DATE	18/09/04	DATE	18/09/04
VERT SCALE	1:250	RELEASED FOR CONSTRUCTION	N/A
HOR SCALE	N/A	DATE	18/09/04

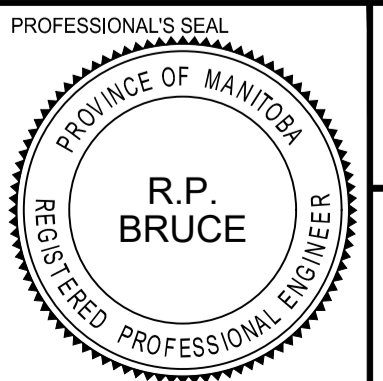

THE CITY OF WINNIPEG
PUBLIC WORKS DEPARTMENT
ENGINEERING DIVISION

CITY DRAWING NUMBER	P-3494-25
SHEET	25 OF 168
DRAWING No.	REV
	25 B

EMPRESS STREET PROJECT
PAVEMENT RECONSTRUCTION
GRADING
EMPRESS STREET EAST
STA 0+460.000 EG TO STA 0+590.000 EG

CONSULTANT FILE NAME
W160034-25-Empress-Recon-GR-25.dwg