

U:\1154\active\115418015\0300\_drawing\0302\_sheet\_files\03\_structural\18015\_s-101.dwg s-101  
2018/05/08 2:32 PM By: Rossnagel, km

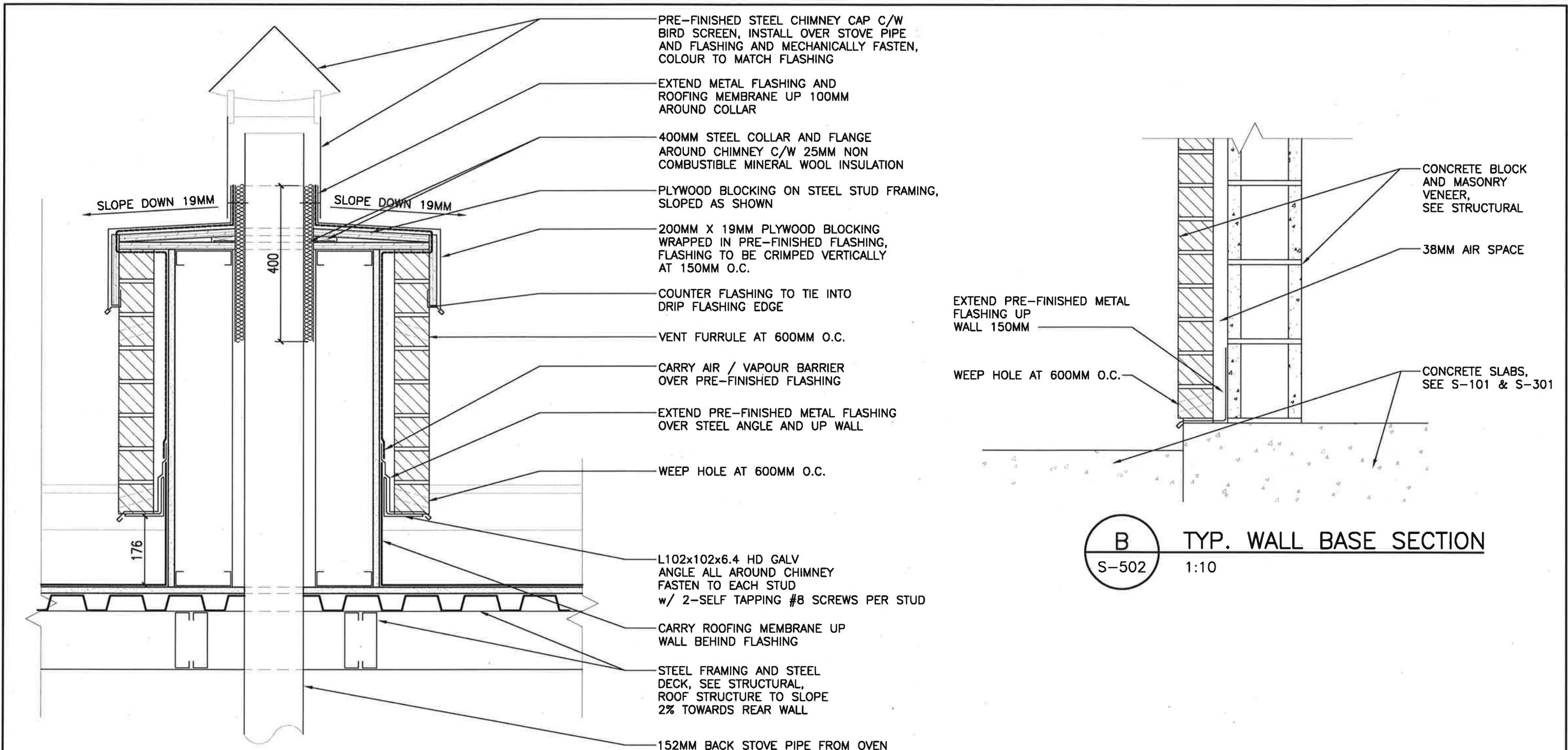

**A** TYP. CHIMNEY / ROOF SECTION

S-501 1:10 NOTE: CHIMNEY STACK TO BE 800MM SQUARE FROM FACE OF BRICK TO FACE OF BRICK

NOTE: ALL PRE-FINISHED FLASHING FOR ALL DETAILS TO BE STEEL

**B** TYP. WALL BASE SECTION

S-502 1:10

ORIGINAL SHEET - ISO 11x17 - v17.05

2018-05-08  
115418015

**Stantec**  
Stantec Consulting Ltd.  
Suite 500, 311 Portage Avenue  
Winnipeg MB Canada R3B 2B9  
Tel. 204.489.5900 Fax. 204.453.9012  
www.stantec.com

**ENGINEERS  
GEOSCIENTISTS  
MANITOBA**  
Certificate of Authorization  
Stantec Consulting Ltd.  
No. 1301

PROVINCE OF MANITOBA  
MAY 8 2018  
FRASER  
Member  
23402  
REGISTERED PROFESSIONAL ENGINEER

E				
D				
C				
B				
A	ISSUED FOR CONSTRUCTION	IR	BF	2018.05.07
	Issued	By	Appd.	YY.MM.DD

Client/Project  
CITY OF WINNIPEG PLANNING, PROPERTY & DEVELOPMENT  
GORD DONG PARK REDEVELOPMENT  
Winnipeg, Manitoba  
Figure No.  
S-501  
Title  
BUILDING DETAILS  
FOR COMMUNITY OVEN ENCLOSURE