

27 June 2018

186936-01-S-COM-S01.dwg

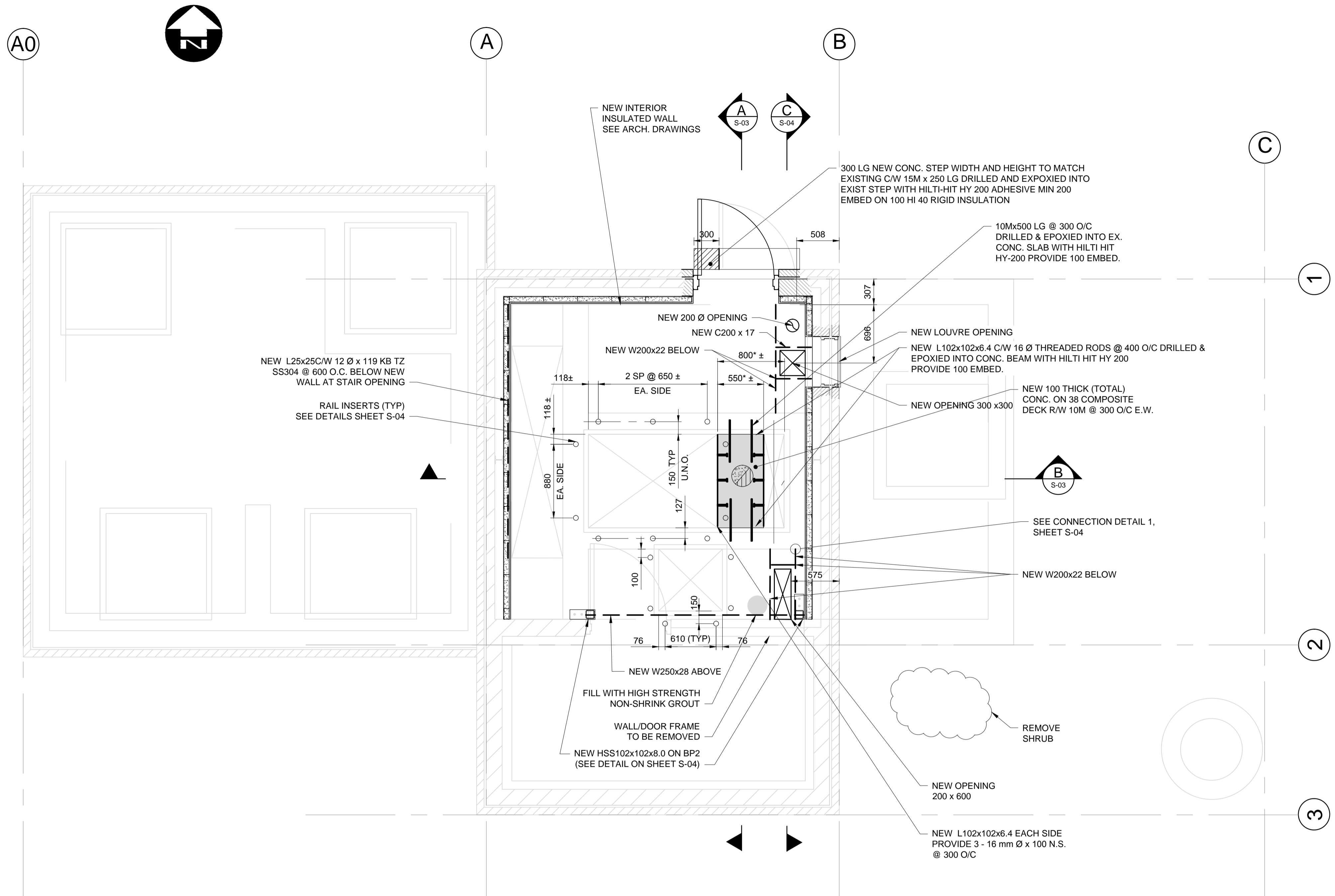

NOTE: \* DIMENSION TO CONFIRM SITE CONDITION

PLAN AT ENTRY LEVEL  
1:30

**NOTES:**

**GENERAL**

1. THE CONTRACTOR SHALL READ STRUCTURAL DRAWINGS IN CONJUNCTION WITH ARCHITECTURAL, MECHANICAL, ELECTRICAL DRAWINGS, SPECIFICATIONS, AND OTHER CONTRACT DOCUMENTS.
2. THE CONTRACTOR SHALL CHECK AND VERIFY ALL DIMENSIONS AND ELEVATIONS PRIOR TO COMMENCING WITH CONSTRUCTION WORK.
3. TEMPORARY SUPPORT AND BRACING FOR CONSTRUCTION IS THE RESPONSIBILITY OF THE CONTRACTOR U.N.O. ON DRAWING.
4. THE CONTRACTOR SHALL BE RESPONSIBLE FOR SAFEGUARDING AND PROTECTION OF THE EXISTING FACILITIES AND UTILITIES WHICH MAY BE AFFECTED BY THE WORK OF THIS CONTRACT.
5. ALL WORK SHALL CONFORM TO THE MOST RECENT MANITOBA BUILDING CODE AND THE ASSOCIATING NATIONAL BUILDING CODE.
6. DO NOT CONSTRUCT FROM THESE DRAWINGS UNLESS MARKED "ISSUED FOR CONSTRUCTION".
7. DO NOT SCALE FROM THE DRAWINGS.

**STRUCTURAL STEEL**

1. STRUCTURAL STEEL WORK SHALL CONFORM TO CSA S16-14.
2. ALL FABRICATION, ERECTION, AND WELDINGS SHALL BE IN ACCORDANCE WITH THE LATEST CODES AND STANDARDS.
3. ALL STRUCTURAL SHAPES SHALL CONFORM TO CSA G40.21-13 GRADE 350W.
4. ALL STRUCTURAL PLATES SHALL CONFORM TO CSA G40.21-13 GRADE 300W.
5. CONNECTION DETAILS NOT SHOWN ON DRAWINGS SHALL BE DESIGNED UNDER THE SUPERVISION OF AND STAMPED BY A PROFESSIONAL ENGINEER LICENSED IN THE PROVINCE WHERE THE PROJECT IS LOCATED.
6. UNLESS NOTED OTHERWISE, DESIGN ALL CONNECTIONS FOR NON-COMPOSITE BEAMS FOR 50% OF THE SHEAR RESISTANCE OF THE BEAM AND USE A MINIMUM OF 3-19 mm DIA BOLTS IN EACH BOLTED CONNECTION.
7. ALL STRUCTURAL STEEL AND CONNECTIONS, INCLUDING ANCHOR BOLTS EXPOSED TO ENVIRONMENT TO BE GALVANIZED.
8. THE CONTRACTOR SHALL PREPARE AND SUBMIT SHOP DRAWINGS PRIOR FOR ENGINEER IN RECORD TO REVIEW PRIOR TO FABRICATION.
9. THE CONTRACTOR SHALL ARRANGE FOR MATERIALS AND WORKMANSHIP TESTING BY AN INDEPENDENT INSPECTION FIRM.
10. WELDERS' CERTIFICATES; ORGANIZATION CERTIFIED BY THE CANADIAN WELDING BUREAU IN ACCORDANCE WITH CSA W47.1-09 (R2014).
11. ALL STRUCTURAL STEEL TO BE GALVANIZED TO CSA G164.2 ASTM A123/A123M-17.
12. SHOP GALVANIZING: HOT DIPPED GALVANIZING WITH A MINIMUM COATING OF 700 g/m<sup>2</sup>.
13. TOUCH UP DAMAGED GALVANIZED COMPONENTS WITH COLD GALVANIZING SPRAY.

**ALUMINUM CHECKER PLATE HATCH OPENING COVERS**

1. ALUMINUM TO BE 6061-T6 FOR STRUCTURAL APPLICATION
2. PANEL TO BE DESIGNED FOR UNIFORM DISTRIBUTED LOAD OF 4.8 KPA WITH MAXIMUM DEFLECTION OF 1 mm
3. PANEL TO BE DESIGNED FOR CONCENTRATED LOAD OF 10 kN APPLIED OVER AREA OF 25x25 mm AT ANY LOCATION WITH MAXIMUM DEFLECTION OF 2.54 mm.
4. LIFTING HANDLE TO BE RECESSED.

**CONCRETE SLAB CUT**

1. NO OVER SAW-CUT IS ALLOWED

**CONCRETE BEAM CORING**

1. NO CORING THROUGH CONCRETE BEAM MAIN REINFORCING IS ALLOWED.

**CAST-IN-PLACE CONCRETE**

1. CONC. MATERIAL, QUALITY, MIXING, PLACING, FORMWORK, AND OTHER CONSTRUCTION PRACTICES TO CONFORM TO CSA A23.1/A29.2.
2. ALL CONC. SHALL BE NORMAL WEIGHT CONC.
3. ADMIXTURES CONTAINING CALCIUM CHLORIDE ARE NOT PERMITTED.
4. CONC. STRENGTH AND MIX SPECIFICATIONS ARE AS FOLLOWS:

EXP. CLASS	SUPPLY AND USE	W/C RATIO	STRENGTH	CEMENT TYPE	SLUMP	MAX. AGG. SIZE	AIR ENTRAINMENT	MAX. FLY ASH CONTENT
N	CONC. TOPPING FOR INTERIOR FLOOR DECK	0.55	25 MPa @ 28 DAYS	GU	100 mm ± 20 mm	10 mm	NONE REQ.	20%
C1	EXT. CONC STEP	0.4	35 MPa @ 28 DAYS	GU	100 mm ± 20 mm	19 mm	5-8%	20%

5. DO NOT ADD WATER TO CONC. ON SITE UNLESS AUTHORIZED BY SUPPLIER.
6. PROTECT CONC. FROM ADVERSE WEATHER CONDITIONS.
7. WHEN THE AMBIENT TEMPERATURE IS AT OR ABOVE 25°C OR WHEN THERE IS A PROBABILITY OF THE AMBIENT TEMP. RISING TO OR ABOVE 25°C, HOT WEATHER REQUIREMENTS APPLY. MOIST CURE CONC. ONLY. CURING COMPOUND IS NOT PERMITTED.

NOT FOR CONSTRUCTION



DESIGNED BY NR		CHECKED BY MBL	
DRAWN BY DJB		APPROVED BY MH	
HOR. SCALE AS SHOWN		RELEASED FOR CONSTRUCTION	
VERTICAL AS SHOWN		DATE	
0	ISSUED FOR TENDER	06/29/18	NR
NO.	REVISIONS	DATE	BY
		JUNE 2018	

ENGINEER'S SEAL			
	DESIGNED BY NR DRAWN BY DJB HOR. SCALE AS SHOWN VERTICAL AS SHOWN	CHECKED BY MBL APPROVED BY MH RELEASED FOR CONSTRUCTION DATE	
CONSULTANT PROJECT NUMBER 18-6936	STRUCTURAL - ENTRY LEVEL PLAN AND STRUCTURAL NOTES		